

KDL-S40A12U
KDL-S32A12U
KDL-S26A12U
KDL-S23A12U

Quick Start Guide

Follow steps **1** through **6** to quickly set up the TV for use.
For more information, see the Operating Instructions supplied with this manual.

© 2005 Sony Corporation Printed in Spain

1 Checking the accessories

Remote RM-ED002 (1)



Size AA batteries (R06 type) (2)



Mains lead (1)



Bundling band (1) and screw (2)



2 Inserting batteries into the remote

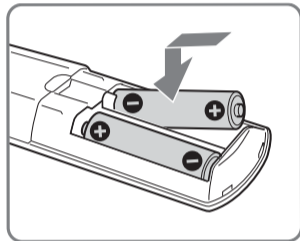
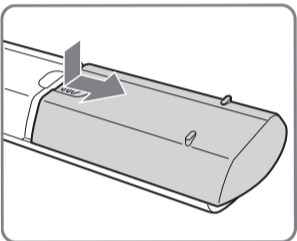

3 Connecting an aerial/VCR

1

Coaxial cable (not supplied)

Rear of the TV

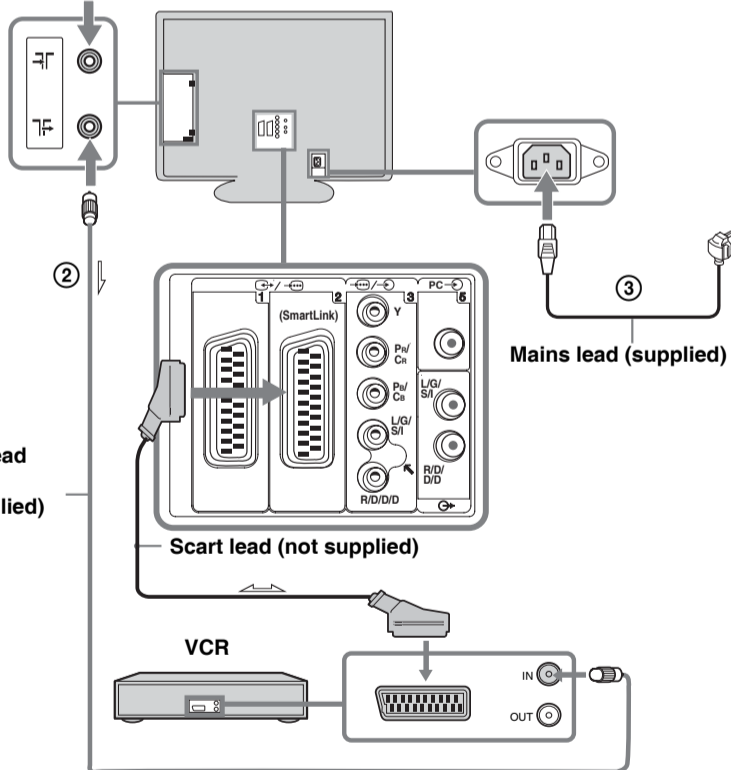

2

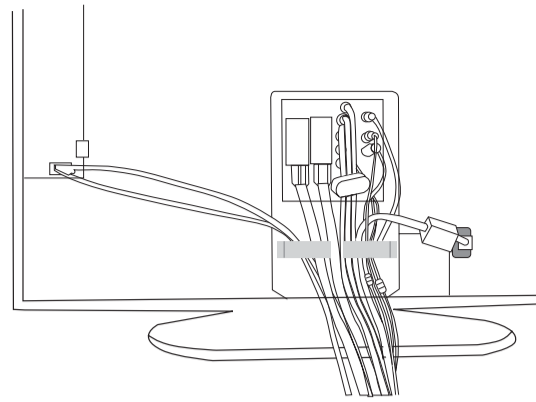

4

Preventing the TV from toppling over

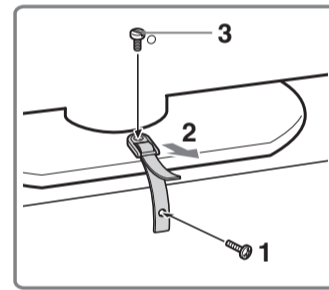
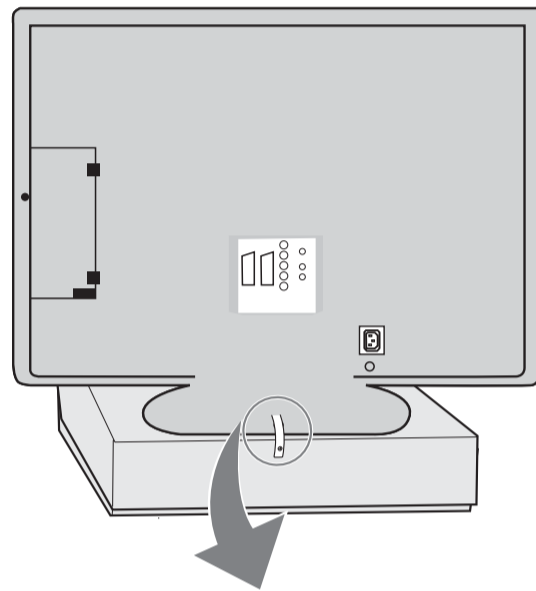

5

Switching on the TV

2

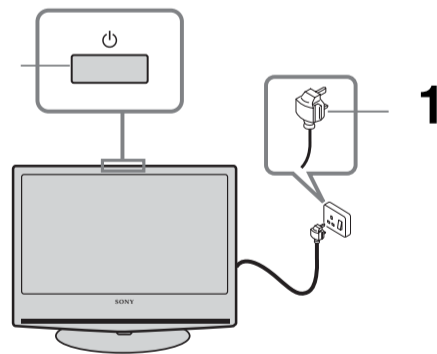

6

Auto-tuning the TV

1

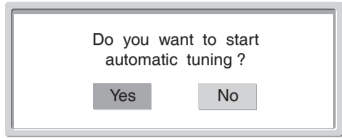

Select "Yes"

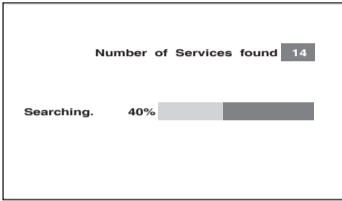

2

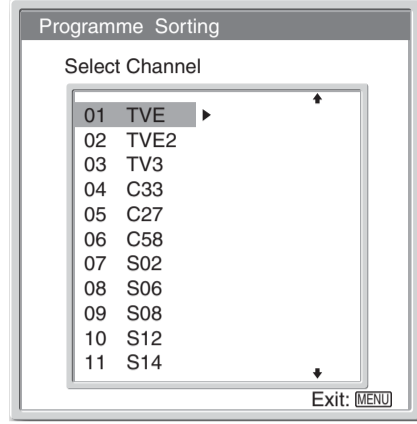

MENU



Exit



Your TV is now ready for use.

