

FM/MW/LW Cassette Car Stereo

Operating Instructions _____

GB

For installation and connections, see the supplied installation/connections manual.

XR-CA800

Welcome !

Thank you for purchasing this Sony Cassette Player. You can enjoy its various features even more with:

- Optional CD/MD units (both changers and players).^{*1}
- CD TEXT information (displayed when a CD TEXT disc^{*2} is played on a connected optional CD unit with the CD TEXT function).
- **Supplied controller accessories**
Rotary commander RM-X5S
Card remote commander RM-X116
- **Optional controller accessory**
Rotary commander RM-X4S

^{*1} *This unit works with Sony products only.*

^{*2} *A CD TEXT disc is an audio CD that includes information such as the disc name, artist name, and track names. This information is recorded on the disc.*

Table of Contents

Location of controls	4
Precautions	6
Notes on Cassettes	6

Getting Started

Resetting the unit	7
Detaching the front panel	7
Setting the clock	8

Cassette Player

Listening to a tape	9
Playing a tape in various modes	9

Radio

Storing stations automatically	
— Best Tuning Memory (BTM)	10
Receiving the stored stations	10
Storing only the desired stations	11
Tuning in a station through a list	
— List-up	11

RDS

Overview of RDS	12
Automatic retuning for best reception results	
— AF function	12
Receiving traffic announcements	
— TA/TP	13
Presetting RDS stations with AF and TA setting	14
Tuning in stations by programme type	
— PTY	14
Setting the clock automatically	
— CT	15

Other Functions

Using the rotary commander	16
Adjusting the sound characteristics	18
Quickly attenuating the sound	18
Changing the sound and display settings	
— Menu	18
Selecting the sound position	
— My Best sound Position (MBP)	19
Setting the equalizer	20

CD/MD Unit (optional)

Playing a CD or MD	21
Display items	21
Playing tracks repeatedly	
— Repeat Play	22
Playing tracks in random order	
— Shuffle Play	22
Labelling a CD	
— Disc Memo	22
Locating a disc by name	
— List-up	23
Selecting specific tracks for playback	
— Bank	24

Additional Information

Maintenance	25
Removing the unit	26
Specifications	27
Troubleshooting	28
Error displays	29

Location of controls

Card remote commander RM-X116

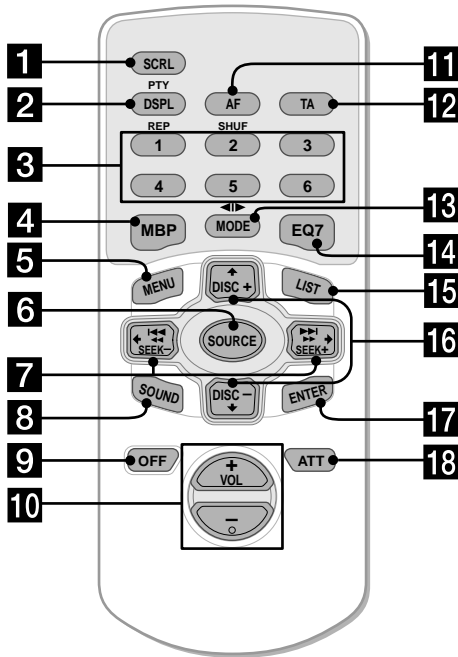

- 1** SCRL button 21
- 2** DSPL/PTY (display mode change/ programme type) button 12, 15, 21, 23
- 3** Number buttons
 - TAPE**
 - ① REP 9
 - RADIO** 10, 11, 13, 14
 - CD/MD**
 - ① REP 22
 - ② SHUF 22
- 4** MBP button 19
- 5** MENU button 8, 9, 10, 14, 15, 19, 20, 22, 23, 24
- 6** SOURCE (Power on/Tape/Radio/CD/ MD) button 9, 10, 11, 13, 20, 21, 23
- 7** SEEK buttons (-/+)

 - TAPE** 9
 - RADIO** 10, 11, 13
 - MENU** 8, 9, 15, 18, 19, 20, 24
 - CD/MD** 21, 22, 24

- 8** SOUND button 18, 19
- 9** OFF (Stop/Power off) button 5, 7, 9, 21

Refer to the pages listed for details.

- TAPE** : During tape playback
- RADIO** : During radio reception
- MENU** : During menu mode
- CD/MD** : During CD/MD playback (optional)

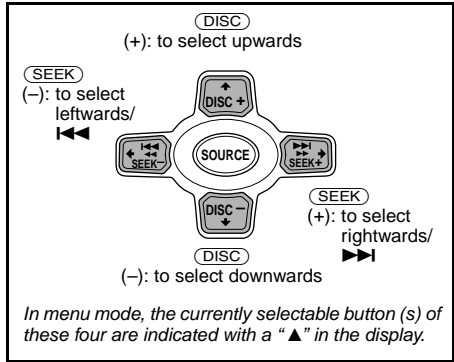

Tip

Refer to "Replacing the lithium battery" for details on how to replace the batteries (page 25).

- 10** VOL buttons (+/-) 13
- 11** AF button 12, 14
- 12** TA button 13, 14
- 13** MODE (◀▶) button
 - TAPE** 9
 - RADIO** 10, 11, 13
 - CD/MD** 21, 23
- 14** EQ7 button 20
- 15** LIST button
 - RADIO** 11
 - CD/MD** 23
- 16** DISC buttons (+/-)
 - RADIO** 10, 11, 15
 - MENU** 8, 9, 10, 14, 15, 19, 20, 22, 23, 24
 - CD/MD** 21, 22, 23
- 17** ENTER button
 - RADIO** 11, 14, 15
 - MENU** 8, 9, 10, 15, 19, 20, 22, 23, 24
 - CD/MD** 23, 24
- 18** ATT button 18

Main unit

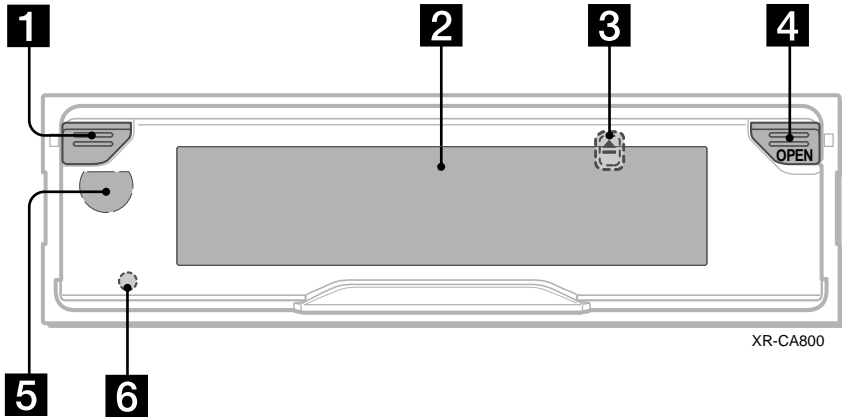

- 1 Power on/off button*** 7
- 2 Display window**
- 3 ▲ (eject) button** (located on the front side of the unit, behind the front panel) 9
- 4 OPEN button** 7, 9
- 5 Receptor for the card remote commander**
- 6 RESET button** (located on the front side of the unit, behind the front panel) 7

* Warning when installing in a car without an ACC (accessory) position on the ignition switch

After turning off the ignition, be sure to press the power on/off button on the unit (or **OFF** on the card remote commander or the rotary commander) for 2 seconds to turn off the clock display.

Otherwise, the clock display does not turn off and this causes battery drain.

To turn the unit on, press the power on/off button (**1**) on the unit.

Note

If the unit is turned off by pressing the power on/off button on the unit (or **OFF** on the card remote commander or the rotary commander) for 2 seconds, it cannot be operated with the card remote commander or the rotary commander unless the power on/off button on the unit is pressed, or a cassette is inserted to activate the unit first.

Precautions

- If your car was parked in direct sunlight, allow the unit to cool off before operating it.
- If no power is being supplied to the unit, check the connections first. If everything is in order, check the fuse.
- If no sound comes from the speakers of a two-speaker system, set the fader control to the centre position.
- When a tape is played back for a long period, the cassette may become warm because of the built-in power amplifier. However, this is not a sign of malfunction.

If you have any questions or problems concerning your unit that are not covered in this manual, please consult your nearest Sony dealer.

To maintain high quality sound

Be careful not to splash juice or other soft drinks onto the unit or tapes.



Notes on Cassettes

Cassette care

- Do not touch the tape surface of a cassette, as any dirt or dust will contaminate the heads.
- Keep cassettes away from equipment with built-in magnets such as speakers and amplifiers, as erasure or distortion on the recorded tape could occur.
- Do not expose cassettes to direct sunlight, extremely cold temperatures, or moisture.
- Slack in the tape may cause the tape to be caught in the machine. Before you insert the tape, use a pencil or similar object to turn the reel and take up any slack.

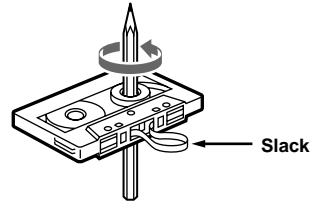

- Distorted cassettes and loose labels can cause problems when inserting or ejecting tapes. Remove or replace loose labels.



- The sound may become distorted while playing the cassette. The cassette player head should be cleaned after each 50 hours of use.

The use of cassettes longer than 90 minutes is not recommended except for long continuous play

The tape used for these cassettes is very thin and tends to stretch easily.

Frequent playing and stopping of these tapes may cause them to become entangled in the cassette deck mechanism.

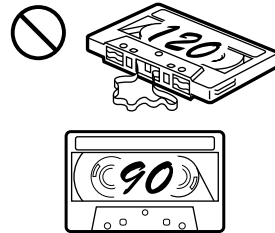

Getting Started

Resetting the unit

Before operating the unit for the first time or after replacing the car battery, you must reset the unit.

Remove the front panel and press the RESET button with a pointed object, such as a ballpoint pen.

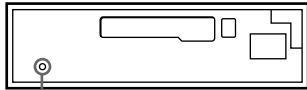

RESET button

Note

Pressing the RESET button will erase the clock setting and some stored contents.

Detaching the front panel

You can detach the front panel of this unit to protect the unit from being stolen.

Caution alarm

If you turn the ignition switch to the OFF position without removing the front panel, the caution alarm will beep for a few seconds.

If you connect an optional amplifier and do not use the built-in amplifier, the beep sound will be deactivated.

1 Press the power on/off button on the unit (or **OFF** on the card remote commander or the rotary commander).*

Tape playback or radio reception stops (the display remains on).

* If your car has no ACC position on the ignition switch, be sure to turn the unit off by pressing the power on/off button on the unit (or **OFF** on the card remote commander or the rotary commander) for 2 seconds to avoid car battery drain.

2 Press **OPEN**, then slide the front panel to the right, and gently pull out the left end of the front panel.

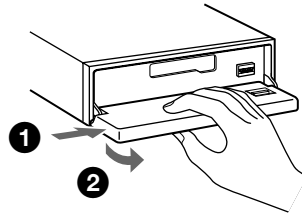

Notes

- If you detach the panel while the unit is still turned on, the power will turn off automatically to prevent the speakers from being damaged.
- Do not drop or put excessive pressure on the front panel and its display window.
- Do not subject the front panel to heat/high temperature or moisture. Avoid leaving it in parked cars or on dashboards/rear trays.

Tip

When carrying the front panel with you, use the supplied front panel case.

continue to next page →

Attaching the front panel

Place hole (A) of the front panel onto the spindle (B) on the unit, then lightly push the left side in.

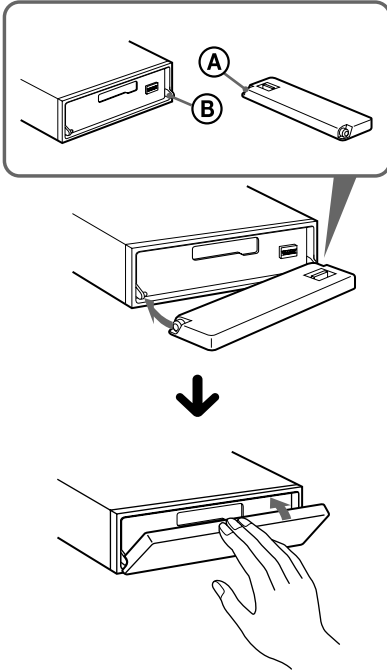

Note

Do not put anything on the inner surface of the front panel.

Setting the clock

The clock uses a 24-hour digital indication.

Example: To set the clock to 10:08

- 1 Press (MENU), then press either side of (DISC) repeatedly until "CLOCK" appears.



- 1 Press (ENTER).
The hour indication flashes.
- 2 Press either side of (DISC) to set the hour.
- 3 Press the (+) side of (SEEK).
The minute indication flashes.
- 4 Press either side of (DISC) to set the minute.

- 2 Press (ENTER).



The clock starts. After the clock setting is completed, the display returns to normal play mode.

Tips

- You can set the clock automatically with the RDS feature (page 15).
- When D.INFO mode is set to ON, the time is always displayed (page 18).

Cassette Player

Listening to a tape

- 1 Press **OPEN** and insert a cassette. Playback starts automatically.

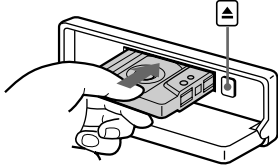

- 2 Close the front panel.

If a cassette is already inserted, press **SOURCE** repeatedly until “FORWARD” or “REVERSE” appears to start playback.

FORWARD: The side facing up is played.

REVERSE: The side facing down is played.

To	Press
Change the tape's playback direction	MODE (◀▶)
Stop playback	OFF
Eject the cassette	OPEN then ▲
Skip tracks – Automatic Music Sensor	SEEK (◀◀/▶▶) [once for each track]
Fast-forward/ reverse – Manual Search	SEEK (◀◀/▶▶) [hold to desired point]

Note

The AMS function may not work when:
– the blanks between tracks are shorter than 4 seconds.
– there is noise between tracks.
– there are long sections of low volume or quiet sections.

Playing a tape in various modes

You can play the tape in various modes:

- METAL lets you play a metal or CrO₂ tape.
- BL.SKIP (Blank Skip) skips blanks longer than 8 seconds.
- ATA (Automatic Tuner Activation) turns on the tuner automatically when fast-winding the tape.

- 1 During tape playback, press **MENU**.
- 2 Press either side of **DISC** repeatedly until the desired mode appears.
- 3 Press (+) side of **SEEK** to select “ON.”
Example: ATA mode

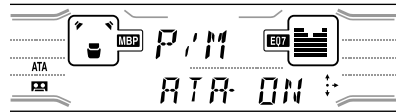

Play mode starts.

- 4 Press **ENTER**.

To return to normal playback mode, select “OFF” in step 3.

Playing tracks repeatedly

— Repeat Play

During playback, press **1** (**REP**) repeatedly until “REP-ON” in the display appears.

To return to normal playback mode, select “REP-OFF.”

Tip

During repeat playback, press **MODE**. “REP” disappears from the display and repeat mode is cancelled.

Radio

The unit can store up to 6 stations per band (FM1, FM2, FM3, MW, and LW).

Caution

When tuning in stations while driving, use Best Tuning Memory to prevent accidents.

Storing stations automatically

— Best Tuning Memory (BTM)

The unit selects the stations with the strongest signals within the selected band, and stores them in the order of their frequency.

- 1 Press **(SOURCE)** repeatedly to select the radio.
- 2 Press **(MODE)** repeatedly to select the band.
- 3 Press **(MENU)**, then press either side of **(DISC)** repeatedly until “BTM” appears.
- 4 Press **(ENTER)**.
A beep sounds when the setting is stored.

Notes

- If only a few stations can be received due to weak signals, some number buttons will retain their former settings.
- When a number is indicated in the display, the unit starts storing stations from the one currently displayed.

Receiving the stored stations

- 1 Press **(SOURCE)** repeatedly to select the radio.
- 2 Press **(MODE)** repeatedly to select the band.
- 3 Press the number button (**(1)** to **(6)**) on which the desired station is stored.

Tip

Press either side of **(DISC)** to receive the stations in the order they are stored in the memory (Preset Search function).

If preset tuning does not work

Press either side of **(SEEK)** to search for the station (automatic tuning).

Scanning stops when the unit receives a station. Repeat until the desired station is received.

Tips

- If automatic tuning stops too frequently, turn on the Local Seek to limit seek to stations with stronger signals (see “Changing the sound and display settings” on page 18).
- If you know the frequency of the station you want to listen to, press and hold either side of **(SEEK)** to locate the approximate frequency, then press **(SEEK)** repeatedly to fine adjust to the desired frequency (manual tuning).

If FM stereo reception is poor

Select monaural reception mode.

(see “Changing the sound and display settings” on page 18). The sound improves, but becomes monaural (“ST” disappears).

Storing only the desired stations

You can manually preset the desired stations on any chosen number button.

- 1 Press **(SOURCE)** repeatedly to select the radio.
- 2 Press **(MODE)** repeatedly to select the band.
- 3 Press either side of **(SEEK)** to tune in the station that you want to store.
- 4 Press the desired number button (**1** to **6**) for 2 seconds until “MEM” appears.

The number button indication appears in the display.

Note

If you try to store another station on the same number button, the previously stored station will be erased.

Tuning in a station through a list

— List-up

- 1 During radio reception, press **(LIST)** momentarily.

The frequency or the name assigned to the station currently tuned in flashes.



- 2 Press either side of **(DISC)** repeatedly until you find the desired station.

If no name is assigned to the selected station, the frequency appears in the display.

- 3 Press **(ENTER)** to tune in the desired station.

RDS

Overview of RDS

FM stations with Radio Data System (RDS) service send inaudible digital information along with the regular radio programme signal. For example, one of the following will be displayed upon receiving a station with RDS capability.

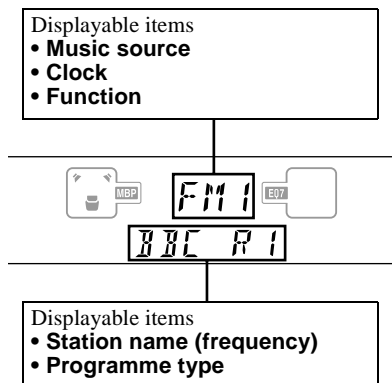

To	Press
Switch display item	(DSPL/PTY)

RDS services

RDS data offers you other conveniences, such as:

- **Automatic retuning** of a programme, helpful during long-distance drives. — AF → page 12
- Receiving **traffic announcements**, even when enjoying another programme/source. — TA → page 13
- Selecting stations by the **type of programme** it broadcasts. — PTY → page 14
- Automatic **clock time** setting. — CT → page 15

Notes

- Depending on the country or region, not all of the RDS functions are available.
- RDS may not work properly if the signal strength is weak or if the station you are tuned to is not transmitting RDS data.

Automatic retuning for best reception results

— AF function

The alternative frequencies (AF) function allows the radio to always tune into the area's strongest signal for the station you are listening to.

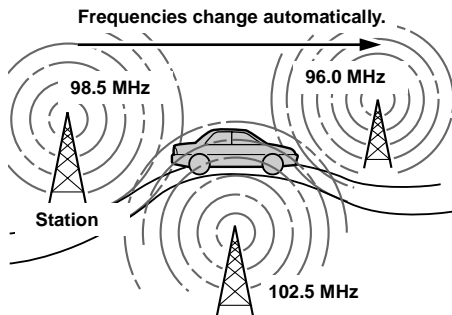

1 Select an FM station (page 10).

2 Press (AF) repeatedly until "AF-ON" appears.

The unit starts searching for an alternative frequency with a stronger signal in the same network.

If "NO AF" flashes, the currently tuned into station does not have an alternative frequency.

Note

When there is no alternative frequency in the area or when you do not need to search for one, turn the AF function off by selecting "AF-OFF."

For stations without alternative frequencies

Press either side of **(SEEK)** while the station name is flashing (within 8 seconds).

The unit starts searching for another frequency with the same PI (Programme Identification) data (“PI SEEK” appears).

If the unit cannot find the same PI, the unit returns to the previously selected frequency.

Staying with one regional programme

When AF function is on: this unit’s factory-set setting restricts reception to a specific region, so you won’t be switched to another regional station with a stronger frequency.

If you leave this regional programme’s reception area or would like to take advantage of the whole AF function, select “REG-OFF” from the MENU (page 19).

Note

This function does not work in the United Kingdom and in some other areas.

Local Link function (United Kingdom only)

This function enables you to select other local stations in the area, even if they are not stored on your number buttons.

- 1 Press a number button (**(1)** to **(6)**) that has a local station stored on it.
- 2 Within 5 seconds, press the number button of the local station again.
- 3 Repeat this procedure until the desired local station is received.

Receiving traffic announcements

— TA/TP

By activating the Traffic Announcement (TA) and Traffic Programme (TP), you can automatically tune in an FM station broadcasting traffic announcements. These settings function regardless of the current FM programme/source, CD/MD; the unit switches back to the original source when the bulletin is over.

Press **(TA)** repeatedly until “TA-ON” appears.

The unit starts searching for traffic information stations.

“TP” indicates reception of such stations, and “TA” flashes during an actual traffic announcement. The unit will continue searching for stations available with TP if “NO TP” is indicated.

To cancel all traffic announcements, select “TA-OFF.”

To	Press
Cancel current announcement	(TA)

Tip

*You can also cancel the current announcement by pressing **(SOURCE)** or **(MODE)**.*

Presetting the volume of traffic announcements

You can preset the volume level of the traffic announcements so you won’t miss hearing them.

- 1 Press either side of **(VOL) (+/-)** to adjust the desired volume level.
- 2 Press **(TA)** for 2 seconds.
“TA” appears and the setting is stored.

Receiving emergency announcements

If either AF or TA is on, the unit will switch to emergency announcements, if one comes in while listening to an FM station, a tape, or optional CD/MD.

Presetting RDS stations with AF and TA setting

When you preset RDS stations, the unit stores each station's AF/TA setting (on/off) as well as its frequency. You can select a different preset setting (for AF, TA, or both) for individual preset stations, or the same setting for all preset stations. If you preset stations with "AF-ON" the unit automatically stores stations with the strongest radio signal.

Presetting the same setting for all preset stations

- 1 Select an FM band (page 10).
- 2 Press **(AF)** and/or **(TA)** to select "AF-ON" and/or "TA-ON."
Note that selecting "AF-OFF" or "TA-OFF" stores not only RDS stations, but also non-RDS stations.
- 3 Press **(MENU)**, then press either side of **(DISC)** repeatedly until "BTM" appears.
- 4 Press **(ENTER)** until "BTM" flashes.

Presetting different settings for each preset station

- 1 Select an FM band, and tune in the desired station (page 11).
- 2 Press **(AF)** and/or **(TA)** to select "AF-ON" and/or "TA-ON."
- 3 Press the desired number button (**1** to **6**) until "MEM" appears.
Repeat from step 1 to preset other stations.

Tuning in stations by programme type

— PTY

You can tune in a station by selecting the type of programme you would like to listen to.

Programme types	Display
News	NEWS
Current Affairs	AFFAIRS
Information	INFO
Sports	SPORT
Education	EDUCATE
Drama	DRAMA
Culture	CULTURE
Science	SCIENCE
Varied	VARIED
Popular Music	POP M
Rock Music	ROCK M
Easy Listening	EASY M
Light Classical	LIGHT M
Classical	CLASSICS
Other Music Type	OTHER M
Weather	WEATHER
Finance	FINANCE
Children's Programmes	CHILDREN
Social Affairs	SOCIAL A
Religion	RELIGION
Phone In	PHONE IN
Travel	TRAVEL
Leisure	LEISURE
Jazz Music	JAZZ
Country Music	COUNTRY
National Music	NATION M
Oldies Music	OLDIES
Folk Music	FOLK M
Documentary	DOCUMENT

Note

You cannot use this function in some countries where no PTY (Programme Type selection) data is available.

- 1 Press **(DSPL/PTY)** during FM reception until “PTY” appears.



The current programme type name appears if the station is transmitting the PTY data. “-----” appears if the received station is not an RDS station, or if the RDS data is not received.

- 2 Press **(DISC)** repeatedly until the desired programme type appears.

The programme types appear in the order shown in the table.

“-----” appears if the programme type is not specified in the RDS data.

- 3 Press **(ENTER)**.

The unit starts searching for a station broadcasting the selected programme type.

Setting the clock automatically

— CT

The CT (Clock Time) data from the RDS transmission sets the clock automatically.

- 1 During radio reception, press **(MENU)**, then press either side of **(DISC)** repeatedly until “CT-OFF” appears.



- 2 Press the **(+)** side of **(SEEK)** repeatedly until “CT-ON” appears.

The clock is set.

- 3 Press **(ENTER)** to return to the normal display.

To cancel the CT function, select “CT-OFF” in step 2.

Notes

- The CT function may not work even though an RDS station is being received.
- There might be a difference between the time set by the CT function and the actual time.

Other Functions

You can also control the unit (and optional CD/MD units) with a rotary commander.
RM-X5S (supplied)/RM-X4S (optional)

Using the rotary commander

First, attach the appropriate label depending on how you want to mount the rotary commander. The rotary commander works by pressing buttons and/or rotating controls.

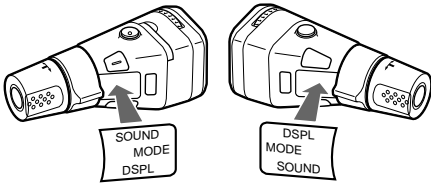

Inserting the supplied lithium battery (RM-X5S only)

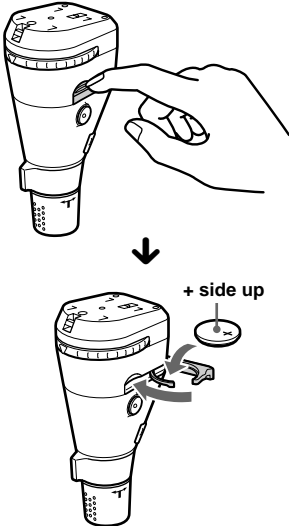

Tip
 For information on lithium battery, refer to "Notes on lithium battery" (page 25).

By pressing buttons

Turn the dial to change the direction of infrared rays. (RM-X5S only)

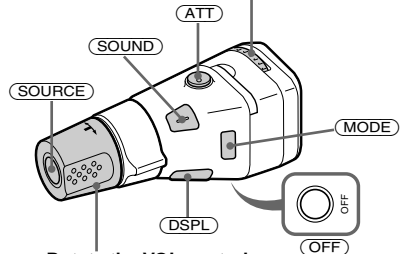

Press	To
SOURCE	Change source (radio/CD*1/MD*1/Tape)
MODE	Change operation (radio band/CD unit*1/MD unit*1/tape playback direction)
ATT	Attenuate sound
OFF *2	Stop playback or radio reception
SOUND	Adjust the sound menu
DSPL	Change the display item

*1 Only if the corresponding optional equipment is connected.
 *2 If your car has no ACC (accessory) position on the ignition key switch, be sure to press **OFF** for 2 seconds to turn off the clock indication after turning off the ignition.
 To turn the unit on, press the power on/off button on the unit.

By rotating the control

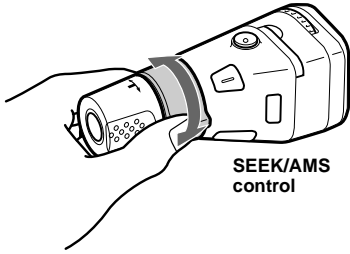

Rotate and release to:

- Locate the beginning of tracks on the tape.
- Tune in stations automatically.
- Skip tracks on the disc.*

Rotate, hold, and release to:

- Fast-wind the tape.
- Find a station manually.
- Fast-forward/reverse a track.*

Tip

To start playback while fast-winding the tape, press **(MODE)**.

By pushing in and rotating the control

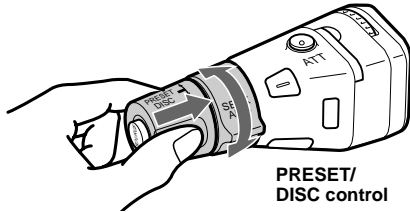

Push in and rotate the control to:

- Receive preset stations.
- Change the disc.*

* Only if the corresponding optional equipment is connected.

Changing the operative direction

The operative direction of controls is factory-set as shown below.

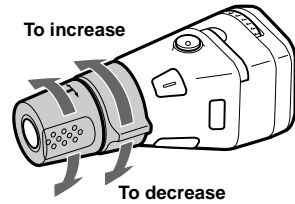

If you need to mount the rotary commander on the right hand side of the steering column, you can reverse the operative direction.

RM-X5S

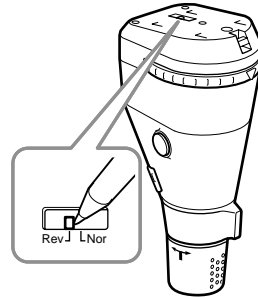

Set the Rev/Nor-select switch to "Rev."

RM-X4S

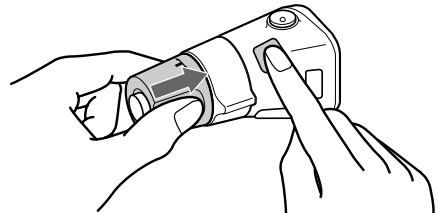

Press **(SOUND)** for 2 seconds while pushing the VOL control.

Adjusting the sound characteristics

You can adjust the bass, treble, balance, and fader.

The bass and treble levels can be stored independently for each source.

1 Select the item you want to adjust by pressing **(SOUND)** repeatedly.

Each time you press **(SOUND)**, the item changes as follows:

BAS (bass) → TRE (treble) → BAL (left-right) → FAD (front-rear)

2 Adjust the selected item by pressing either side of **(SEEK)**.

When adjusting with the rotary commander, press **(SOUND)** and rotate the VOL control.

Note

Adjust within 3 seconds after selecting the item.

Quickly attenuating the sound

(With the rotary commander or the card remote commander)

Press **(ATT)** on the rotary commander or card remote commander.

After “ATT-ON” momentarily appears, the “ATT” appears in the display.

To restore the previous volume level, press **(ATT)** again.

Tip

When the interface cable of a car telephone is connected to the ATT lead, the unit decreases the volume automatically when a telephone call comes in (Telephone ATT function).

Changing the sound and display settings

— Menu

The following items can be set:

SET (Set Up)

- CLOCK (page 8)
- CT (Clock Time) (page 15)
- BEEP — to turn the beeps on or off.

DSPL (Display)

- D.INFO (Dual Information) — to display the clock and the play mode at the same time (ON).
- M.DSPL (Motion Display) — to select the Motion Display mode from “1,” “2,” and “OFF.”
 - Select “1” to show decoration lines in the display and activate Demo display.
 - Select “2” to show decoration lines in the display and deactivate Demo display.
 - Select “OFF” to deactivate the Motion Display.
- A.SCRL (Auto Scroll)*
 - Select “ON” to scroll all automatically displayed names exceeding 8 characters.
 - When Auto scroll is set to off and the disc/track name is changed, the disc/track name does not scroll.

* When no CD or MD is playing, this item will not appear.

SND (Sound)

- LOUD (Loudness) — to enjoy bass and treble even at low volumes. The bass and treble will be reinforced.

P/M (Play Mode)

- LOCAL-ON/OFF (Local seek mode) (page 10)
 - Select “ON” to only tune into stations with stronger signals.
- MONO-ON/OFF (Monaural mode) (page 10)
 - Select “ON” to hear FM stereo broadcast in monaural. Select “OFF” to return to normal mode.
- REG-ON/OFF (Regional) (page 13)

1 Press **(MENU)**.

To set A.SCRL, press **(MENU)** during CD/MD Playback.

2 Press either side of **(DISC)** repeatedly until the desired item appears.

3 Press the **(+)** side of **(SEEK)** to select the desired setting (Example: ON or OFF).

4 Press **(ENTER)**.

After the mode setting is completed, the display returns to normal play mode.

Note

The displayed item will differ depending on the source.

Tip

You can easily switch among categories (“SET,” “DSPL,” “SND,” “P/M,” and “EDIT”) by pressing either side of **(DISC)** for 2 seconds.

Selecting the sound position

— My Best sound Position (MBP)

When you drive without passengers, you can enjoy the most comfortable sound environment with “My Best sound Position.”

“My Best sound Position” has two presets, which adjust the sound level of balance and fader. You can select one very easily with the MBP button.

Display window	Balance Level		Fader Level	
	Right	Left	Front	Rear
MBP-A	- 4dB	0	0	- 4dB
MBP-B	0	- 4dB	0	- 4dB
MBP-OFF	0	0	0	0

Press **(MBP)** repeatedly for the desired listening position.

The mode of “My Best sound Position” is shown in the display in order of the table.

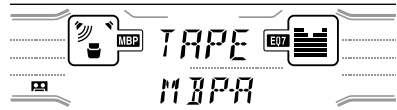

After one second, the display goes back to the normal playback mode.

If you want to adjust the sound level of balance and fader more precisely, you can do it using the **(SOUND)** button (see “Adjusting the sound characteristics” on page 18).

Notes

- When the BAL (balance) or FAD (fader) in “Adjusting the sound characteristics” (page 18) is adjusted, the MBP setting returns to OFF.
- When MBP is set to OFF, the BAL and FAD setting is activated.

Setting the equalizer

You can select an equalizer curve for seven music types (XPLOD, VOCAL, CLUB, JAZZ, NEW AGE, ROCK, CUSTOM, and OFF (equalizer OFF)).

You can store and adjust the equalizer settings for frequency and level.

Selecting the equalizer curve

1 Press **(SOURCE)** to select a source (radio, CD, MD, or tape).

2 Press **(EQ7)** repeatedly until the desired equalizer curve.

Each time you press **(EQ7)**, the item changes.



To cancel the equalizing effect, select "OFF." After 3 seconds, the display returns to the normal playback mode.

Adjusting the equalizer curve

1 Press **(MENU)**.

2 Press either side of **(DISC)** repeatedly until "EQ7 TUNE" appears, then press **(ENTER)**.

3 Press either side of **(SEEK)** to select the desired equalizer curve, then press **(ENTER)**.

Each time you press **(SEEK)**, the item changes.

4 Select the desired frequency and level.

1 Press either side of **(SEEK)** to select the desired frequency.

Each time you press **(SEEK)**, the frequency changes.

62 (Hz) ↔ 157 (Hz) ↔ 396 (Hz) ↔
1k (Hz) ↔ 2.5k (Hz) ↔ 6.3k (Hz) ↔
16k (Hz)

2 Press either side of **(DISC)** to adjust the desired volume level.

The volume level is adjustable by 1 dB steps from -10 dB to +10 dB.



To restore the factory-set equalizer curve, press **(ENTER)** for 2 seconds.

5 Press **(MENU)** twice.

When the effect setting is complete, the normal playback mode appears.

CD/MD Unit (optional)

This unit can control external CD/MD units. If you connect an optional CD unit with the CD TEXT function and the custom file function, the CD TEXT information will appear in the display when you play a CD TEXT disc.

Playing a CD or MD

- 1 Press **(SOURCE)** repeatedly to select "CD" or "MD."
- 2 Press **(MODE)** repeatedly until the desired unit appears.
CD/MD playback starts.

To	Press
Stop playback	(OFF)
Skip discs – Disc selection	(DISC) (+/-)
Skip tracks – Automatic Music Sensor	(SEEK) (◀◀/▶▶) [once for each track]
Fast-forward/ reverse – Manual Search	(SEEK) (◀◀/▶▶) [hold to desired point]

Display items

When the disc/track changes, any prerecorded title*1 of the new disc/track is automatically displayed (if the Auto Scroll function is set to "ON," names exceeding 8 characters will be scrolled (page 18)).

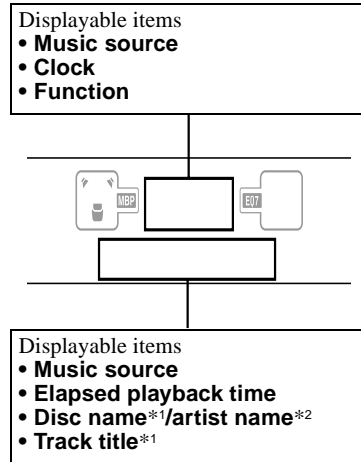

To	Press
Switch display item	(DSPL/PTY)
Scroll display item	(SCRL)

*1 "NO NAME" indicates there is no Disc Memo (page 22) or prerecorded name to display.

*2 Only for CD TEXT discs with the artist name.

Notes

- Some characters cannot be displayed.
- For some CD TEXT discs with very many characters, information may not scroll.
- This unit cannot display the artist name for each track of a CD TEXT disc.

Tip

When Auto scroll is set to OFF and the disc/track name is changed, the disc/track name does not scroll.

Playing tracks repeatedly

— Repeat Play

You can select:

- REP-1 — to repeat a track.
- REP-2 — to repeat a disc.

During playback, press (1) (REP) repeatedly until the desired setting appears in the display.

Repeat Play starts.

To return to normal play mode, select “REP-OFF.”

Playing tracks in random order

— Shuffle Play

You can select:

- SHUF-1 — to play the tracks on the current disc in random order.
- SHUF-2 — to play the tracks in the current optional CD (MD) unit in random order.
- SHUF-ALL* — to play all the tracks in all the connected CD (MD) units in random order.

* Available only when two or more optional CD/MD units are connected.

During playback, press (2) (SHUF) repeatedly until the desired setting appears in the display.

Shuffle Play starts.

To return to normal play mode, select “SHUF-OFF.”

Note

“SHUF-ALL” will not shuffle tracks between CD units and MD units.

Labelling a CD

— Disc Memo (For a CD unit with the CUSTOM FILE function)

You can label each disc with a custom name (Disc Memo). You can enter up to 8 characters for a disc. If you label a CD, you can locate the disc by name (page 23).

- 1 Start playing the disc you want to label.
- 2 Press (MENU), then press either side of (DISC) repeatedly until “NAMEEDIT” appears.
- 3 Press (ENTER).

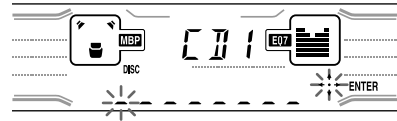

The unit will repeat the disc during the labelling procedure.

4 Enter the characters.

- 1 Press the (+)*1 side of (DISC) repeatedly to select the desired character.

A → B → C ... → 0 → 1 → 2 ... → + →
→ * ... → *_2 → A

*1 For reverse order, press the (–) side of (DISC).

*2 (blank space)

- 2 Press the (+) side of (SEEK) after locating the desired character.



If you press the (–) side of (SEEK), you can move back to the left.

- 3 Repeat steps 1 and 2 to enter the entire name.
- 5 To return to normal CD play mode, press (ENTER).

Tips

- Simply overwrite or enter “_” to correct or erase a name.
- There is another way to start labelling a CD: Press (LIST) for 2 seconds instead of performing steps 2 and 3. You can also complete the operation by pressing (LIST) for 2 seconds instead of step 5.
- You can label CDs on a unit without the CUSTOM FILE function if that unit is connected along with a CD unit that has the function. The Disc Memo will be stored in the memory of the CD unit with the CUSTOM FILE function.

Note

REP-1/shuffle play is suspended until the Name Edit is complete.

Viewing the Disc Memo

As a display item, the Disc Memo always takes priority over any original CD TEXT information.

To	Press
View	(DSPL/PTY) during CD/CD TEXT disc playback

Tip

To find out about other items that can be displayed, see page 21.

Erasing the Disc Memo

- 1 Press (SOURCE) repeatedly to select “CD.”**
- 2 Press (MODE) repeatedly to select the CD unit storing the Disc Memo.**
- 3 Press (MENU), then press either side of (DISC) repeatedly until “NAME DEL” appears.**
- 4 Press (ENTER).**
The stored names will appear in order from the earliest entered.
- 5 Press either side of (DISC) repeatedly to select the disc name you want to erase.**
The stored names will appear from the earliest ones entered.
- 6 Press (ENTER) for 2 seconds.**
The name is erased.
Repeat steps 5 and 6 if you want to erase other names.
- 7 Press (MENU) twice.**
The unit returns to normal CD play mode.

Notes

- When the Disc Memo for a CD TEXT disc is erased, the original CD TEXT information is displayed.
- If you cannot find the Disc Memo you want to erase, try selecting a different CD unit in step 2.

Locating a disc by name

— List-up (For a CD unit with the CD TEXT/CUSTOM FILE function, or an MD unit)

You can use this function for discs that have been assigned custom names*1 or for CD TEXT discs*2.

*1 Locating a disc by its custom name: when you assign a name for a CD (page 22) or an MD.

*2 Locating discs by the CD TEXT information: when you play a CD TEXT disc on a CD unit with the CD TEXT function.

1 Press (LIST).

The name assigned to the current disc appears in the display.

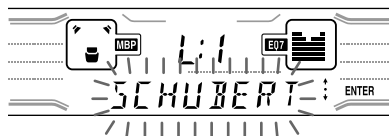

2 Press either side of (DISC) repeatedly until you find the desired disc.

3 Press (ENTER) to play the disc.

Note

Some letters cannot be displayed (exception: Disc Memo).

Selecting specific tracks for playback

— Bank (For a CD unit with the CUSTOM FILE function)

If you label the disc, you can set the unit to skip or play the tracks of your choice.

- 1 Start playing the disc you want to label.
- 2 Press **(MENU)**, then press either side of **(DISC)** repeatedly until “BANK SEL” appears.
- 3 Press **(ENTER)**.

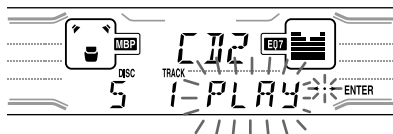

4 Label the tracks.

- 1 Press either side of **(SEEK)** repeatedly to select the track you want to label.
 - 2 Press **(ENTER)** repeatedly to select “PLAY” or “SKIP.”
- 5 Repeat step 4 to set “PLAY” or “SKIP” for all the tracks.
- 6 Press **(MENU)** twice.
The unit returns to normal CD play mode.

Notes

- You can set “PLAY” and “SKIP” for up to 24 tracks.
- You cannot set “SKIP” for all the tracks on a CD.

Playing specific tracks only

You can select:

- “BANK-ON” — to play the tracks with the “PLAY” setting.
- “BANK-INV” (Inverse) — to play the tracks with the “SKIP” setting.

- 1 During playback, press **(MENU)**, then press either side of **(DISC)** repeatedly until “BANK-ON,” “BANK-INV,” or “BANK-OFF” appears.
- 2 Press the **(+)** side of **(SEEK)** repeatedly until the desired setting appears.



3 Press **(ENTER)**.

Playback starts from the track following the current one.

To return to normal play mode, select “BANK-OFF” in step 2.

Additional Information

Maintenance

Fuse replacement

When replacing the fuse, be sure to use one matching the amperage rating stated on the original fuse. If the fuse blows, check the power connection and replace the fuse. If the fuse blows again after replacement, there may be an internal malfunction. In such a case, consult your nearest Sony dealer.

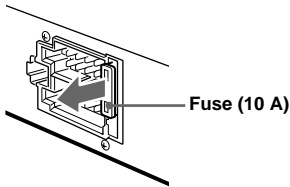

Warning

Never use a fuse with an amperage rating exceeding the one supplied with the unit as this could damage the unit.

Cleaning the connectors

The unit may not function properly if the connectors between the unit and the front panel are not clean. In order to prevent this, detach the front panel (page 7) and clean the connectors with a cotton swab dipped in alcohol. Do not apply too much force. Otherwise, the connectors may be damaged.

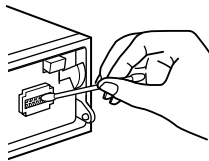

Main unit

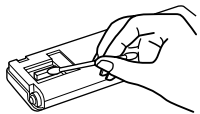

Back of the front panel

Notes

- For safety, turn off the ignition before cleaning the connectors, and remove the key from the ignition switch.
- Never touch the connectors directly with your fingers or with any metal device.

Replacing the lithium battery

Under normal conditions, batteries will last approximately 1 year. (The service life may be shorter, depending on the conditions of use). When the battery becomes weak, the range of the card remote commander becomes shorter. Replace the battery with a new CR2025 lithium battery.

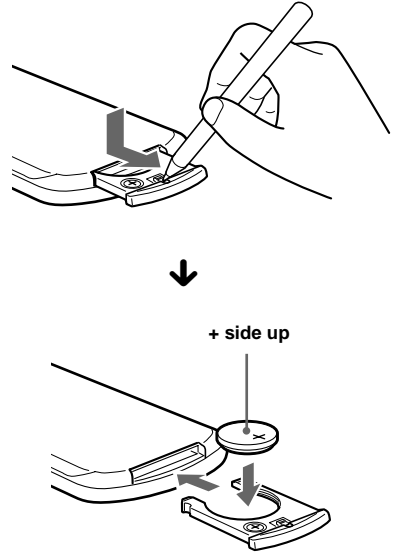

Notes on lithium battery

- Keep the lithium battery out of the reach of children. Should the battery be swallowed, immediately consult a doctor.
- Wipe the battery with a dry cloth to assure a good contact.
- Be sure to observe the correct polarity when installing the battery.
- Do not hold the battery with metallic tweezers, otherwise a short-circuit may occur.

WARNING

Battery may explode if mistreated. Do not recharge, disassemble, or dispose of in fire.

Removing the unit

1 Remove the front cover

- 1 Detach the front panel (page 7).
- 2 Press the clip inside the front cover with a thin screwdriver.

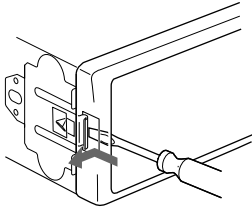

- 3 Repeat step 2 for the other side.

2 Remove the unit

- 1 Use a thin screwdriver to push in the clip on the left side of the unit, then pull out the left side of the unit until the catch clears the mounting.

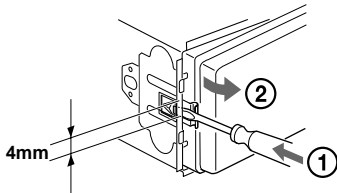

- 2 Repeat step 1 for the right side.
- 3 Slide the unit out of its mounting.

Specifications

Cassette Player section

Tape track	4-track 2-channel stereo
Wow and flutter	0.08 % (WRMS)
Frequency response	30 – 18,000 Hz
Signal-to-noise ratio	

Cassette type

TYPE II, IV	61 dB
TYPE I	58 dB

Tuner section

FM

Tuning range	87.5 – 108.0 MHz
Aerial terminal	External aerial connector
Intermediate frequency	10.7 MHz/450 kHz
Usable sensitivity	8 dBf
Selectivity	75 dB at 400 kHz
Signal-to-noise ratio	66 dB (stereo), 72 dB (mono)
Harmonic distortion at 1 kHz	0.6 % (stereo), 0.3 % (mono)
Separation	35 dB at 1 kHz
Frequency response	30 – 15,000 Hz

MW/LW

Tuning range	MW: 531 – 1,602 kHz LW: 153 – 279 kHz
Aerial terminal	External aerial connector
Intermediate frequency	10.7 MHz/450 kHz
Sensitivity	MW: 30 μ V LW: 40 μ V

Power amplifier section

Outputs	Speaker outputs (sure seal connectors)
Speaker impedance	4 – 8 ohms
Maximum power output	50 W \times 4 (at 4 ohms)

General

Outputs	Audio outputs (Rear) Power aerial relay control lead Power amplifier control lead Telephone ATT control lead BUS control input connector BUS audio input connector Remote controller input connector Aerial input connector
Inputs	Bass \pm 8 dB at 100 Hz Treble \pm 8 dB at 10 kHz 100 Hz +8 dB 10 kHz +2 dB
Tone controls	
Loudness	
Power requirements	12 V DC car battery (negative earth)
Dimensions	Approx. 178 \times 50 \times 176 mm (w/h/d)
Mounting dimensions	Approx. 182 \times 53 \times 161 mm (w/h/d)
Mass	Approx. 1.2 kg
Supplied accessories	Parts for installation and connections (1 set) Front panel case (1) Rotary commander RM-X5S Card remote commander RM-X116
Optional accessories	BUS cable (supplied with an RCA pin cord) RC-61 (1 m), RC-62 (2 m) Rotary commander RM-X4S
Optional equipment	CD changer (10 discs) CDX-848X, CDX-646 MD changer (6 discs) MDX-65 Source selector XA-C30

Note

This unit cannot be connected to a digital preamplifier or an equalizer.

Design and specifications are subject to change without notice.

Troubleshooting

The following checklist will help you remedy problems you may encounter with your unit. Before going through the checklist below, check the connection and operating procedures.

General

No sound.

- Rotate the volume control dial clockwise to adjust the volume.
- Cancel the ATT function.
- Set the fader control to the centre position for a 2-speaker system.

The contents of the memory have been erased.

- The RESET button has been pressed.
→ Store again into the memory.
- The power cord or battery has been disconnected.
- The power connecting cord is not connected properly.

No beep sound.

The beep sound is cancelled (page 18).

Indications disappear from/do not appear in the display.

- The clock display disappears if you press **(OFF)** for 2 seconds.
→ Press the power on/off button on the unit to display the clock.
- Remove the front panel and clean the connectors. See “Cleaning the connectors” (page 25) for details.

Stored stations and correct time are erased. The fuse has blown.

Makes noise when the ignition key is in the ON, ACC, or OFF position.

The leads are not matched correctly with the car’s accessory power connector.

No power is being supplied to the unit.

- Check the connection. If everything is in order, check the fuse.
- The car does not have an ACC position.
→ Press the power on/off button on the unit.

The power is continuously supplied to the unit.

The car does not have an ACC position.

The power aerial does not extend.

The power aerial does not have a relay box.

Tape playback

The sound is distorted.

The tape head is contaminated.
→ Clean the head with a commercially available dry-tape cleaning cassette.

The AMS does not operate correctly.

- There is noise in the space between tracks.
- A blank space is too short (less than 4 seconds).
- A long pause, or a passage of low frequencies or very low sound level is treated as a blank space.

Radio reception

Preset tuning is not possible.

- Store the correct frequency in the memory.
- The broadcast signal is too weak.

The stations cannot be received.

The sound is hampered by noises.

- Connect a power aerial control lead (blue) or accessory power supply lead (red) to the power supply lead of a car’s aerial booster. (Only when your car has built-in FM/MW/LW aerial in the rear/side glass).
- Check the connection of the car aerial.
- The auto aerial will not go up.
→ Check the connection of the power aerial control lead.
- Check the frequency.

Automatic tuning is not possible.

- The local seek mode is set to “ON.”
→ Set the local seek mode to “OFF” (page 19).
- The broadcast signal is too weak.
→ Perform manual tuning.

The “ST” indication flashes.

- Tune in the frequency accurately.
- The broadcast signal is too weak.
→ Set to the monaural reception mode (page 19).

A programme broadcast in stereo is heard in monaural.

The unit is in monaural reception mode.
→ Cancel monaural reception mode (page 19).

RDS

The SEEK starts after a few seconds of listening.

The station is non-TP or has weak signal.

→ Press (AF) or (TA) repeatedly until “AF-OFF” or “TA-OFF” appears.

No traffic announcements.

- Activate “TA.”
- The station does not broadcast any traffic announcements despite being TP.
→ Tune in another station.

PTY displays “-----.”

- The current station is not an RDS station.
- RDS data has not been received.
- The station does not specify the programme type.

CD/MD playback

The sound skips.

Dirty or defective disc.

Error displays

(when an optional CD/MD unit is connected)

Error displays

The following indications will flash for about 5 seconds, and an alarm sound will be heard.

NO MAG

The disc magazine is not inserted in the CD/MD unit.

→ Insert the magazine in the CD/MD unit.

NO DISC

No disc is inserted in the CD/MD unit.

→ Insert discs in the CD/MD unit.

ERROR*1

- A CD is dirty or inserted upside down.*2
→ Clean or insert the CD correctly.
- An MD does not playback because of some problem.*2
→ Insert another MD.
- A CD/MD cannot play because of some problem.
→ Insert another CD/MD.

BLANK*1

No tracks have been recorded on an MD.*2

→ Play an MD with recorded tracks on it.

RESET

The CD/MD unit cannot be operated because of some problem.

→ Press the RESET button on the unit.

NOT READY

The lid of the MD unit is open or the MDs are not inserted properly.

→ Close the lid or insert the MDs properly.

HI TEMP

The ambient temperature is more than 50°C.

→ Wait until the temperature goes down below 50°C.

*1 When an error occurs during playback of a CD or MD, the disc number of the CD or MD does not appear in the display.

*2 The disc number of the disc causing the error appears in the display.

If these solutions do not help improve the situation, consult your nearest Sony dealer.