



Printed using VOC (Volatile Organic Compound)-free vegetable oil based ink.

# Radio Cassette Player

## Operating Instructions

Mode d'emploi (au verso)

使用说明书（反面）



## WM-FX488

Sony Corporation ©2002 Printed in Malaysia

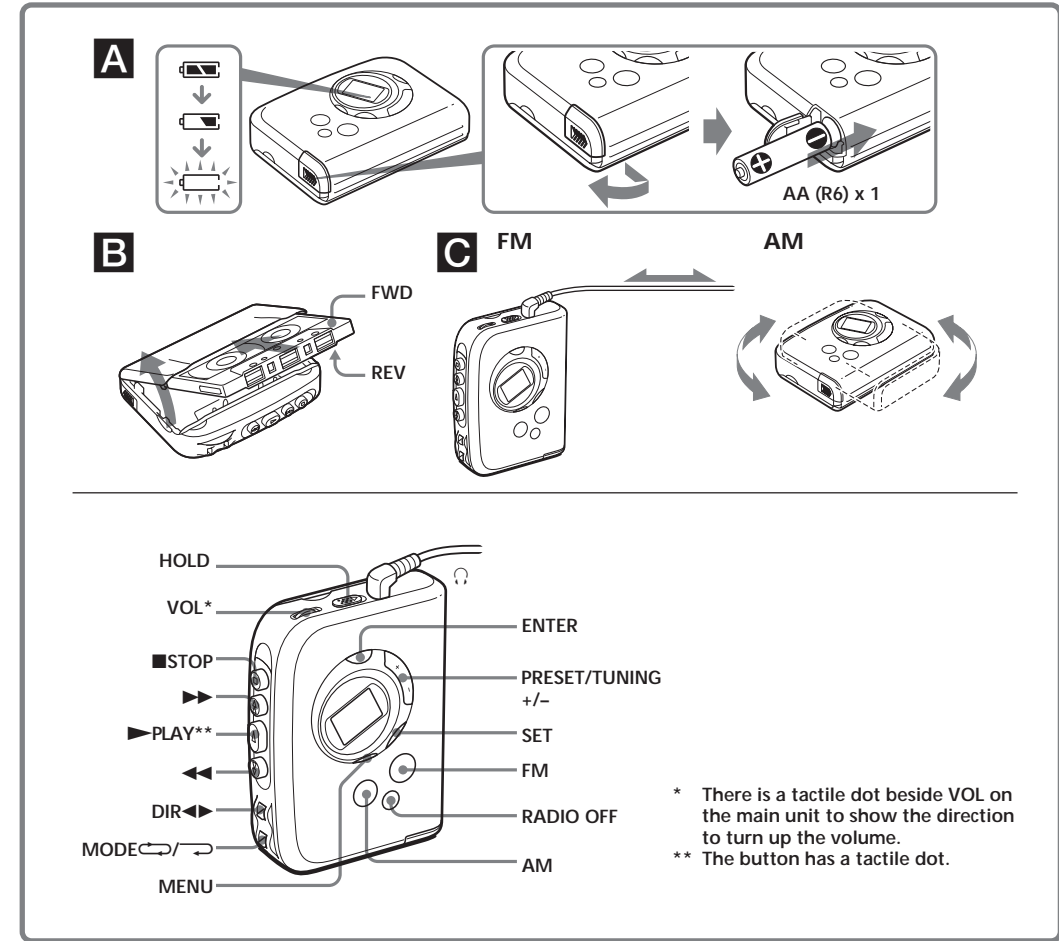

### English

## Preparations

### To Insert Battery **A**

- Slide open the battery compartment lid, and insert one R6 (size AA) dry battery with correct polarity.

Replace the battery with new one when " " flashes in the display.

## Playing a Tape

- Insert a cassette. **B**
- Press **►PLAY**.  
Adjust the volume with VOL.

To	Press
Stop playback	<b>■STOP</b>
Wind rapidly*	<b>►►</b> or <b>◄◄</b>

\* If you leave the unit after the tape has been wound or rewind, the battery will be consumed rapidly. Be sure to press **■STOP**.

### Note

- Do not open the cassette holder while the tape is running.

### To select playback mode

Switch MODE to select the desired mode.

To play	Select
Both sides repeatedly	
Both sides once from the side facing the cassette holder (FWD)	

### To select the tape direction

Switch DIR◄► to select the desired direction.

## Listening to the Radio

- If the HOLD function is turned on, set the HOLD switch in the opposite direction of the **▷** mark to unlock the controls. Make sure that the tape has stopped completely.

- Press FM or AM to select the desired band and to turn on the radio.

- Press PRESET/TUNING +/- to tune in to the desired station.

If the signal is strong, you can scan for stations. Press MENU repeatedly to set the cursor in the display to TUNE MODE and press SET to display "MANUAL". Then hold down PRESET/TUNING +/- for a few seconds.

### To turn off the radio

Press RADIO OFF.

### To improve broadcast reception **C**

- For FM:** Extend the headphones/earphones cord (antenna). If the reception is still not good, press MENU repeatedly to set the cursor in the display to FM MODE. Then press SET to switch between "LOCAL" and none (DX), or "MONO" and none (stereo) for best reception.
- For AM:** Reorient the unit itself.

## Presetting Radio Stations

You can preset up to 40 stations.

For Canada and Central/South America: 30 for FM and 10 for AM.

For other countries: 35 for FM and 5 for AM.

### Presetting Automatically Scanned Stations

- Press FM or AM.
- Press and hold ENTER for more than 3 seconds.  
Preset number 1 will flash in the display and the Walkman starts scanning the stations from the lower frequencies and stops for about 4 seconds when a station is received.
- If you wish to preset the currently received station, press ENTER while the preset number is flashing.  
The received station is preset on preset number 1 and the unit starts scanning for the next receivable station.
- Repeat step 3 until all receivable stations are preset.

### To stop scanning

Press RADIO OFF. The radio is turned off at the same time.

### Notes

- If stations are already stored, the newly preset stations replace the old ones when the above procedure is completed.
- If stations cannot be preset automatically, preset them manually.

### Presetting Stations Manually

- Press FM or AM.
- Press ENTER.

The frequency digits will flash in the display.

- While the frequency digits are flashing, tune in to a station you wish to store using PRESET/TUNING +/- and press ENTER.

The first available preset number will flash in the display.

- While the preset number is flashing, select the preset number you want using PRESET/TUNING +/- and press ENTER.

### Notes

- If you cannot complete step 3 or 4 while the indicators are flashing, repeat from step 2.
- If a station is already stored, the new station replaces the old one.

### Playing the preset radio stations

- Press FM or AM.
- Press MENU repeatedly to set the cursor in the display to TUNE MODE. Then press SET to display "PRESET".
- Press PRESET/TUNING +/-.

### To cancel a stored station

- Follow the procedure above and in step 3, select the station you want to cancel and then press ENTER. The frequency digits will flash in the display.
- Press and hold PRESET/TUNING +/- until "----" is displayed. Press ENTER while "----" is flashing. A preset number will flash in the display.
- Press PRESET/TUNING +/- repeatedly to select the preset number you want to cancel and press ENTER.

### Scanning the preset radio stations—DAPS (Digital Auto Preset Scanning)

- Press FM or AM to select the desired band and to turn on the radio.
- Press and hold FM or AM pressed in step 1 for 2 seconds or more.

The preset stations of the selected band will be played for about 5 seconds each. (During DAPS the indicators in the display flash.)

- Press FM or AM again to select the station while the desired preset station is being played.

### Notes

- If there are no stations stored, the DAPS function does not work.
- Until a station is selected in step 3, the DAPS function turned on in step 2 will continue.
- In step 2 or 3, if you select a band which you did not select in step 1 by pressing FM or AM, the newly selected band will be played normally.

## Using Other Functions

### Locking the controls

Set the HOLD switch in the direction of the **▷** mark to lock the controls.

The HOLD function only locks the radio operation buttons, MENU button, SET button, PRESET/TUNING +/- button and ENTER button.

### Emphasizing bass sound

Press MENU repeatedly to set the cursor to MB (mega bass) in the display. Then, press SET to turn MB on. With each press, the indications change as follows.

MB (mega bass) : emphasizes bass sound  
No message: off (normal)

### Notes

- If the sound is distorted with the mode "MB", turn down the volume or select normal mode.
- Bass emphasis may not show great effect if the volume is turned up too high.

### Protecting your hearing—AVLS (Automatic Volume Limiter System)

Press MENU repeatedly to set the cursor to AVLS in the display. Then press SET to show "". The maximum volume is kept down to protect your ears.

## Precautions

### On batteries

- Do not carry dry batteries with coins or other metallic objects. It can generate heat if the positive and negative terminals of the batteries are accidentally contacted by a metallic object.
- When you are not going to use your Walkman for a long time, remove the battery to prevent damage from battery leakage and corrosion.

### On handling

- Do not leave the unit in a location near heat sources, or in a place subject to direct sunlight, excessive dust or sand, moisture, rain, mechanical shock, or in a car with its windows closed.
- We do not recommend the use of tape longer than 90 minutes. They are very thin and tend to be stretched easily. This may cause malfunction of the unit or sound deterioration.
- The LCD display may become hard to see or slow down when using the unit at high temperatures (above 40°C/104°F) or at low temperatures (below 0°C/32°F). At room temperature, the display will return to its normal operating condition.
- If the unit has not been used for a long time, set it in the playback mode to warm it up for a few minutes before you start using it again.

### On headphones/earphones

#### Road safety

Do not use headphones/earphones while driving, cycling, or operating any motorized vehicle. It may create a traffic hazard and is illegal in some areas. It can also be potentially dangerous to play your headphones/earphones at high volume while walking, especially at pedestrian crossings. You should exercise extreme caution or discontinue use in potentially hazardous situations.

### Preventing hearing damage

Do not use headphones/earphones at high volume. Hearing experts advise against continuous, loud and extended play. If you experience a ringing in your ears, reduce the volume or discontinue use.

### Caring for others

Keep the volume at a moderate level. This will allow you to hear outside sounds and to be considerate to the people around you.

### On maintenance

- Clean the tape head and tape path using a cotton swab and commercially available cleaning solvent after every 10 hours of use.
- To clean the exterior, use a soft cloth slightly moistened in water. Do not use alcohol, benzine or thinner.
- Clean the headphones/earphones plugs periodically.

## Specifications

- Frequency range**  
FM: 87.5 - 108 MHz  
AM: 530 - 1 710 kHz (North, Central and South America)  
531 - 1 602 kHz (Other countries)
- Power requirements**  
1.5V DC, battery R6 (size AA) x 1
- Dimensions (w/h/d)**  
Approx. 83.6 x 112.0 x 28.3 mm (3 ¼ x 4 ½ x 1 ⅓ inches)  
excl. projecting parts and controls
- Mass**  
Approx. 138 g (4.9 oz) (main unit only)
- Supplied accessories**  
Stereo headphones or Stereo earphones (1)  
Carrying case with belt clip or Carrying pouch (1)

Design and specifications are subject to change without notice.

#### Battery life\* (approximate hours)

	Sony alkaline LR6 (SG)**	Sony R6P (SR)
Tape playback	35	9
Radio reception	40	14

\* Measured value by the standard of JEITA (Japan Electronics and Information Technology Industries Association). (Using a Sony HF series cassette tape)

\*\*When using a Sony LR6(SG) "STAMINA" alkaline dry battery (produced in Japan).

### Note

- The battery life may be shorter depending on the operating condition, the surrounding temperature and battery type.

