

Micro HI-FI Component System

Operating Instructions
CMT-BX20/BX10



© 2008 Sony Corporation

Printed in China

<http://www.sony.net/>

Except for customers in the U.S.A. and Canada

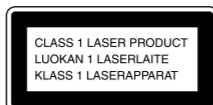

This appliance is classified as a CLASS 1 LASER product. For Southeast Asian, Indian, South African and Hong Kong models, this marking is located on the bottom exterior. For other models, this marking is located on the rear exterior.

Note on DualDiscs

A DualDisc is a two sided disc product which mates DVD recorded material on one side with digital audio material on the other side. However, since the audio material side does not conform to the Compact Disc (CD) standard, playback on this product is not guaranteed.

Music discs encoded with copyright protection technologies

This product is designed to playback discs that conform to the Compact Disc (CD) standard. Recently, various music discs encoded with copyright protection technologies are marketed by some record companies. Please be aware that among those discs, there are some that do not conform to the CD standard and may not be playable by this product.

MPEG Layer-3 audio coding technology and patents licensed from Fraunhofer IIS and Thomson.

WARNING

To reduce the risk of fire, do not cover the ventilation opening of the apparatus with newspapers, tablecloths, curtains, etc.

Do not place the naked flame sources such as lighted candles on the apparatus.

To reduce the risk of fire or electric shock, do not expose this apparatus to dripping or splashing, and do not place objects filled with liquids, such as vases, on the apparatus. Do not install the appliance in a confined space, such as a bookcase or built-in cabinet.

As the main plug is used to disconnect the unit from the mains, connect the unit to an easily accessible AC outlet. Should you notice an abnormality in the unit, disconnect the main plug from the AC outlet immediately.

Do not expose batteries or apparatus with battery-installed to excessive heat such as sunshine, fire or the like.

Southeast Asian, Indian, South African and Latin American models only except for the Mexican and Argentine models

The nameplate is located on the bottom exterior.

CAUTION

The use of optical instruments with this product will increase eye hazard.

Hooking up the system securely

Antennas

Find a location and an orientation that provide good reception, and then set up the antenna. Keep the antennas away from the speaker cords and the power cord to avoid picking up noise.

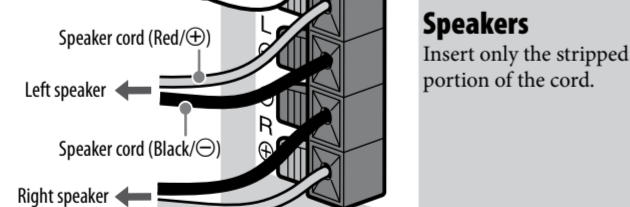
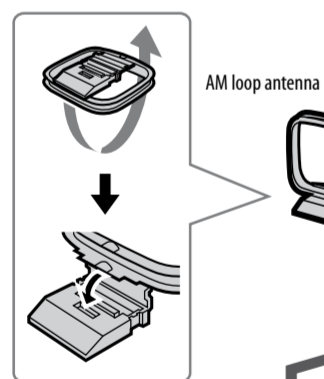

Speakers
Insert only the stripped portion of the cord.



Power

For models with a voltage selector, set VOLTAGE SELECTOR to the local power line voltage.

Connect the power cord to a wall socket. If the plug does not fit the wall socket, detach the supplied plug adaptor (only for models equipped with an adaptor).

When carrying this system

- 1 Remove a disc to protect the CD mechanism.
- 2 Press CD [7] to select the CD function.
- 3 Hold down VOL + [13] and DSGX [15] on the unit, and press [4] on the unit until "STANDBY" appears.
- 4 After "LOCK" appears, unplug the power cord.

Basic Operations

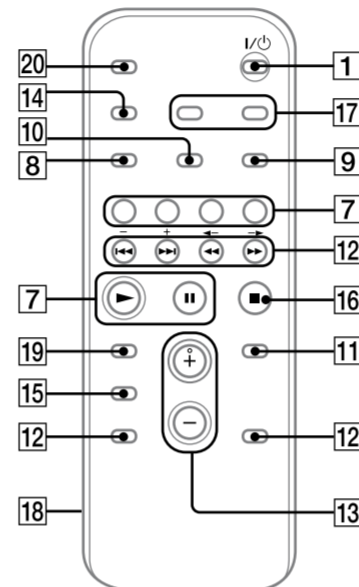
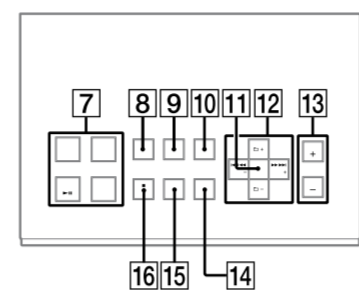
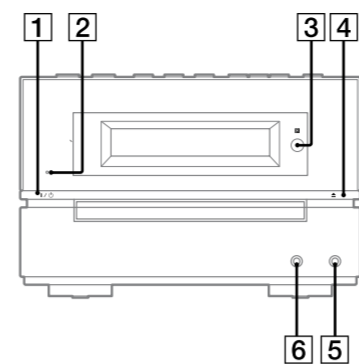

Adjusting the sound

To adjust the volume

Press VOLUME +/- (or VOL +/- on the unit) [13].

To add a sound effect

To	Press
Generate a more dynamic sound (Dynamic Sound Generator X-tra)	DSGX [15] on the unit.
Set the sound effect	EQ [15] repeatedly to select "BASS" or "TREBLE," and then press +/- [12] repeatedly to adjust the level.

Playing a CD/MP3 disc

- 1 Select the CD function.
Press CD [7].

- 2 Place a disc.
Press [4] (open/close) [4] on the unit, and place a disc with the label side up on the disc tray.



To close the disc tray, press [4] (open/close) [4] on the unit.
Do not force the disc tray closed with your finger, as this may damage the unit.

- 3 Start playback.
Press [7] (play) (or CD [7] (play/pause) on the unit) [7].

To

To	Press
Pause playback	[7] (pause) (or CD [7] (play/pause) on the unit) [7]. To resume play, press the button again.
Stop playback	[16] (stop) (or [16]/CANCEL on the unit) [16].
Select a folder on an MP3 disc	[12] +/- (select folder) [12].
Select a track or file	[12] << [12] / >> [12] (go back/go forward) [12].
Find a point in a track or file	Hold down [12] <<< [12] / >>> [12] (rewind/fast forward) [12] during playback, and release the button at the desired point.
Select Repeat Play	REPEAT [9] repeatedly until "REP" or "REP1" appears.

To change the play mode

Press PLAY MODE [10] repeatedly while the player is stopped. You can select normal play ("□") for all MP3 files in the folder on the disc, shuffle play ("SHUF" or "□ SHUF*"), or program play ("PGM").
* When playing a CD-DA disc, [10] (SHUF) Play performs the same operation as normal (shuffle) play.

Notes on Repeat Play

- All tracks or files on a disc are played repeatedly up to five times.
- "REP1" indicates that a single track or file is repeated until you stop it.

Notes on playing MP3 discs

- Do not save other types of tracks or files or unnecessary folders on a disc that has MP3 files.
- Folders that have no MP3 files are skipped.
- MP3 files are played back in the order that they are recorded onto the disc.
- The system can only play MP3 files that have a file extension of ".MP3".
- If there are files on the disc that have the ".MP3" file extension, but that are not MP3 files, the unit may produce noise or may malfunction.
- The maximum number of:
 - folders is 255 (including the root folder).
 - MP3 files is 511.
 - MP3 files and folders that can be contained on a single disc is 512.
 - folder levels (the tree structure of files) is 8.
- Compatibility with all MP3 encoding/writing software, recording device, and recording media cannot be guaranteed. Incompatible MP3 discs may produce noise or interrupted audio or may not play at all.

Notes on playing multisession discs

- If the disc begins with a CD-DA (or MP3) session, it is recognized as a CD-DA (or MP3) disc, and other sessions are not played back.
- A disc with a mixed CD format is recognized as a CD-DA (audio) disc.

This manual mainly explains operations using the remote, but the same operations can also be performed using the buttons on the unit having the same or similar names.

Before using the system

To use the remote

Slide and remove the battery compartment lid [18], and insert the two supplied R6 (size AA) batteries, [18] side first, matching the polarities shown below.

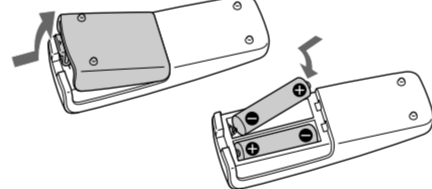

Notes on using the remote

- With normal use, the batteries should last for about six months.
- Do not mix an old battery with a new one or mix different types of batteries.
- If you do not use the remote for a long period of time, remove the batteries to avoid damage from battery leakage and corrosion.

To set the clock

Use buttons on the remote to set the clock.

- 1 Turn on the system.
Press I/O (power) [1].

- 2 Select the clock set mode.
Press CLOCK/TIMER SET [17]. If the current mode appears on the display, press [12] <<< [12] / >>> [12] repeatedly to select "CLOCK SET?" and then press ENTER [11].

- 3 Set the time.
Press [12] <<< [12] / >>> [12] repeatedly to set the hour, and then press ENTER [11]. Use the same procedure to set the minutes.

The clock settings are lost when you disconnect the power cord or if a power failure occurs.

To display the clock when the system is off, press DISPLAY [14]. The clock is displayed for about 8 seconds.

Selecting a music source

Press the following buttons (or press FUNCTION [7] repeatedly).

To select	Press
CD	CD [7].
Tuner	TUNER/BAND [7].
Component (connected using an audio cord)	AUDIO IN [7].

Listening to the radio

- 1 Select "FM" or "AM."
Press TUNER/BAND [7] repeatedly.
- 2 Select the tuning mode.
Press TUNING MODE [10] repeatedly until "AUTO" appears.
- 3 Tune in the desired station.
Press +/- (or TUNE +/- on the unit) [12]. Scanning stops automatically when a station is tuned in, and then "TUNED" and "STEREO" (for stereo programs only) appear.

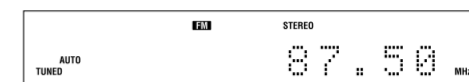

To stop automatic scanning

Press [16] (stop) (or [16]/CANCEL on the unit) [16].

To tune in a station with a weak signal

If "TUNED" does not appear and the scanning does not stop, press TUNING MODE [10] repeatedly until "AUTO" and "PRESET" disappear, and then press +/- (or TUNE +/- on the unit) [12] repeatedly to tune in the desired station.

To reduce static noise on a weak FM stereo station

Press FM MODE [9] repeatedly until "MONO" appears to turn off stereo reception.

Changing the display

To	Press
Change information on the display ¹⁾	DISPLAY [14] repeatedly when the system is on.
Check the clock when the system is off	DISPLAY [14] when the system is off ²⁾ . The clock is displayed for 8 seconds.

¹⁾ For example, you can view CD/MP3 disc information, such as:

- track or file number during normal play.
- track or file name ("♪") during normal play.
- artist name ("♪") during normal play.
- album or folder name ("□") during normal play.
- total playing time while the player is stopped.

²⁾ The STANDBY indicator [2] on the unit lights up when the system is off.

Notes on the display information

- Characters that cannot be displayed appear as "_".
- The following are not displayed:
 - total playing time for a CD-DA disc depending on the play mode.
 - total playing time and remaining playing time for an MP3 disc.
- The following are not displayed correctly:
 - folder and file names that do not follow either ISO9660 Level 1, Level 2 or Joliet in the expansion format.
- The following is displayed:
 - ID3 tag information for MP3 files when ID3 version 1 and version 2 tags are used (up to 62 characters).

Using optional audio components

To connect an optional headphones

Connect headphones to the PHONES jack [6] on the unit.

To connect an optional component

Connect additional audio component to the AUDIO IN jack [5] on the unit using an audio analog cord (not supplied). Turn down the volume on the system, and then select the AUDIO IN function.

