

DIGITAL MEDIA PORT Adapter

Operating Instructions

TDM-iP10 (M)

DIGITAL MEDIA PORT

© 2008 Sony Corporation

Printed in China

<http://www.sony.net/>

WARNING



Disposal of Old Electrical & Electronic Equipment (Applicable in the European Union and other European countries with separate collection systems)

This symbol on the product or on its packaging indicates that this product shall not be treated as household waste. Instead it shall be handed over to the applicable collection point for the recycling of electrical and electronic equipment. By ensuring this product is disposed of correctly, you will help prevent potential negative consequences for the environment and human health, which could otherwise be caused by inappropriate waste handling of this product. The recycling of materials will help to conserve natural resources. For more detailed information about recycling of this product, please contact your local Civic Office, your household waste disposal service or the shop where you purchased the product.

On copyrights

- iPod is a trademark of Apple Inc., registered in the U.S. and other countries.
- All other trademarks and registered trademarks are of their respective holders. In this manual, ™ and ® marks are not specified.

Getting Started

List of parts locations

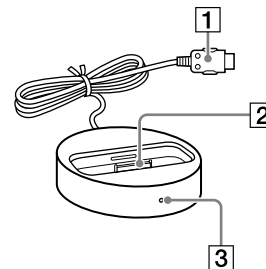

- 1 DIGITAL MEDIA PORT cable
- 2 iPod connector
- 3 Power indicator: Lights up in green while the power is supplied.

To connect/disconnect the unit

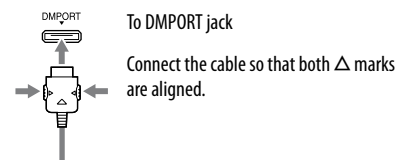

To remove the DIGITAL MEDIA PORT cable from the DMPORT jack, press both side buttons.

Connecting

- 1 Connect the DIGITAL MEDIA PORT cable of this unit to the DMPORT jack of an AV system. Make sure the AV system is turned off before connecting.
- 2 Turn on the AV system with a DMPORT jack connected to this unit, and select the DMPORT function.

Disconnecting

Before disconnecting, turn off the AV system.

To put the iPod into the unit's connector

- 1 Choose the iPod Dock Adapter that fits your iPod.
- 2 Insert the Dock Adapter into the unit.

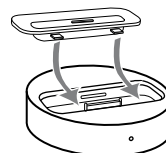

Note

The iPod Dock Adapter is not supplied with this unit.

- 3 Put the iPod into the unit's connector.

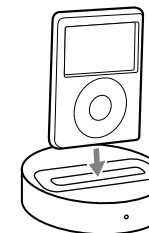

Notes

- When placing or removing the iPod, handle the iPod in the same angle as that of the iPod connector on this unit and do not twist or sway the iPod to prevent connector damage.
- Do not carry the unit with an iPod set on the connector. Doing so may cause a malfunction.
- When placing or removing the iPod, brace the unit with one hand and take care not to press the controls of the iPod by mistake.

To use the unit as a battery charger

You can use the unit as a battery charger. While the POWER indicator lights up, the battery is charging. The charging status appears in the iPod display. For details, see the user's guide of your iPod.

To remove the iPod Dock Adapter

To remove the iPod Dock Adapter, pull it up with your fingernail or a flat object using the slot inside the adapter.

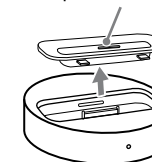

Note

The iPod Dock Adapter is not supplied with this unit.

Controlling the iPod

Performing basic operations

You can operate your iPod by its control buttons, the control buttons of a connected AV system with a DIGITAL MEDIA PORT interface, and the remote supplied with the AV system.

Notes

- To use an iPod, refer to the user's guide of your iPod.
- Before disconnecting the iPod, pause playback.

Basic Operations

The following operations are available with the AV system or the remote.

Press	To
▶	Start play.
⏸/■	Pause play.
↑/↓	Works much like running your thumb around the Click Wheel on the iPod counterclockwise (clockwise).
→/⊕/ENTER	Works much like the center button on the iPod.
⏮/▶▶	Press and release to skip to the next (previous) song/video or chapter of audiobook/podcast. Hold down to fast-rewind (fast-forward).
⏪/▶▶	Fast- forward (fast- rewind) play.
←/MENU/ Ⓜ DISPLAY/ RETURN/TOOL MENU	Works much like the Menu button on the iPod.
VOLUME +/-	Adjusts the volume level.

Notes

- Point the remote at the AV system.
- Depending on the connected AV system, the operation or buttons may differ. Refer to the AV system's operating instructions.
- While playing video, you cannot use ⏮/▶▶. You can fast-rewind (fast-forward) by holding down ⏮/▶▶.
- To change the volume level, use the volume controls on the connected AV system or the remote. The volume level does not change even if adjusted on the iPod.
- It may take time to start playback depending on the contents.

Additional Information

Troubleshooting

Should you encounter a problem with your unit, find your problem in the troubleshooting checklist below and take the indicated corrective action. If the problem persists, contact your Sony dealer. Note that if service personnel changes some parts during repair, these parts may be retained. When bringing the system in for repairs, be sure to bring in the entire system. This product is a system product, and the entire system is needed to determine the location requiring repair.

The remote does not function.

- Remove any obstacles.
- Point the remote at the AV system's sensor.
- The distance between the remote and the AV system is too far.
- Replace the battery.
- Make sure the iPod* is securely connected.
- Select the DMPORT function on the AV system.
- Turn on and off the AV system.

Video/photo image from the iPod does not appear on the TV screen.

- The unit does not support video output. Even if your iPod has video/photo capability, you cannot view video or photo content on the TV or other video devices.

There is no sound.

- Check the connections.
- Make sure the unit is securely connected.
- Make sure the iPod* is securely connected.
- Make sure the iPod* is playing music.
- It may take time to start playback depending on the contents.

There is severe hum or noise.

- Move the unit away from the source of noise.

The sound is distorted.

- Reduce the volume of the connected AV system.
- Set the "EQ" setting of the iPod to "Off" or "Flat".

* See "Compatible iPod models".

Precautions

On safety

Should any solid object or liquid fall into the system, unplug the system and have it checked by qualified personnel before operating it any further.

On placement

- Do not place the unit in an inclined position.
- Do not place the unit in locations where it is;
 - Extremely hot or cold
 - Dusty or dirty
 - Very humid
 - Subject to vibrations
 - Subject to direct sunlight.
- Use caution when placing the unit on surfaces that have been specially treated (with wax, oil, polish, etc.) as staining or discoloration of the surface may result.

On heat buildup

- Although the unit heats up during operation, this is not a malfunction.
- Place the unit in a location with adequate ventilation to prevent heat buildup in the unit.

If you have any questions or problems concerning your unit, please consult your nearest Sony dealer.

Cleaning the unit

Clean the unit with a soft cloth slightly moistened with mild detergent solution. Do not use any type of abrasive pad, scouring powder or solvent such as thinner, benzine or alcohol.

Specifications

General

Power requirements: DC IN: 5 V, 600 mA (via DIGITAL MEDIA PORT)
Dimensions: Approx. φ 80 × 22(h) mm
Cable length: 0.6 m

Design and specifications are subject to change without notice.

Compatible iPod models

The compatible iPod models are as follows. Make sure your iPod is updated to the latest firmware version.

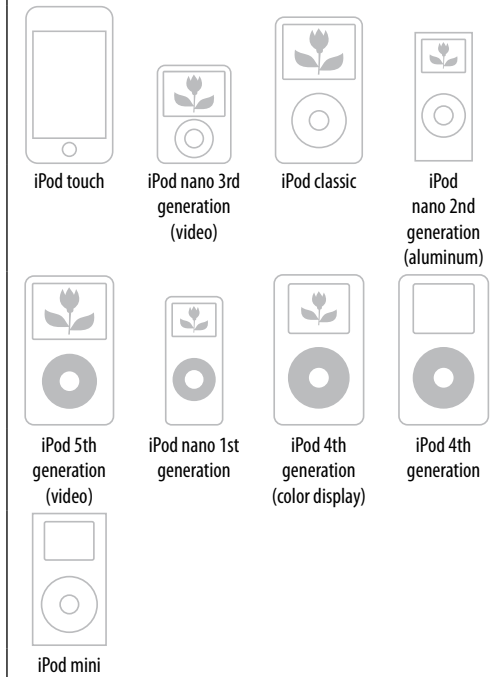

Notes

- This unit is designed for iPod only. You can not connect any other portable audio players.
- Sony cannot accept responsibility in the event that data recorded to iPod is lost or damaged when using an iPod connected to this unit.
- This product has been designed specifically to work with iPod and has been certified to meet Apple performance standards.
- TDM-iP10 (M) is not compatible with iPhone.