

## Choosing Power Sources

### Rear Panel

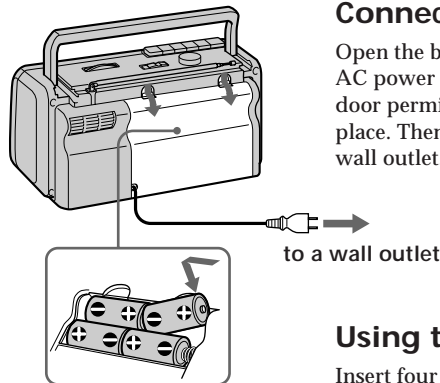

### Connecting the AC power cord.

Open the battery compartment and take out the AC power cord. An opening in the compartment door permits AC operation with the door in its place. Then, connect the AC power cord to the wall outlet.

to a wall outlet

### Using the player on batteries.

Insert four size D (R20) batteries (not supplied) into the battery compartment.

### Note

Replace the batteries when the OPR/BATT indicator dims or when the player stops operating. Replace all the batteries with new ones.

## Specifications

- **Frequency range** FM: 87.6-108MHz/AM: 530-1,710kHz
- **Antennas** FM: Telescope antenna/AM: Built-in ferrite bar
- **Recording system** 2-track, mono
- **Frequency response** 100-8,000Hz
- **Speakers** Full-range: 7.7cm (3<sup>1</sup>/<sub>8</sub> inches) dia x 1
- **Power output** 0.9W (at 10% harmonic distortion in DC operation)
- **Battery life**

#### FM recording

Sony R20P : Approx. 24 hours

Sony LR20 alkaline : Approx. 55 hours

#### Playback

Sony R20P : Approx. 20 hours

Sony LR20 alkaline : Approx. 50 hours

- **Power requirements** 220V AC, 60Hz/6V DC, four size D (R20) batteries
- **Power consumption** AC5W
- **Dimensions** Approx. 272 x 130 x 121.5 mm(w/h/d) (10<sup>3</sup>/<sub>4</sub> x 5<sup>1</sup>/<sub>8</sub> x 4<sup>7</sup>/<sub>8</sub> inches) incl. projecting parts and controls)
- **Mass** Approx. 1.7kg (3lb 12oz) (incl. batteries)

Design and specifications are subject to change without notice.

## Troubleshooting

### There is no audio.

- Connect the AC power cord securely.
- Insert the batteries properly.
- Replace all the batteries if they are weak.
- Adjust the volume.
- Set FUNCTION to the position you want to operate.

### Cassette cannot be inserted.

- Insert the cassette properly.
- Press **▲■** to release **◀**.

### The **●** button does not function.

- No cassette is in the tape compartment.
- Make sure the safety tab on the cassette is in place.

### Poor playback, recording or erasing quality.

- Dirty heads. Clean the illustrated portions with a cleaning swab slightly moistened with cleaning fluid or alcohol.
- Demagnetize the heads and all metal parts in the tape path with a commercially available tape head demagnetizer.

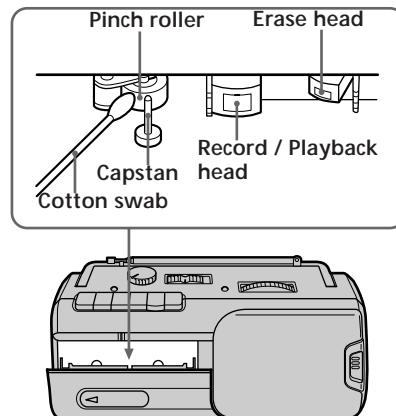

## Precautions

### On safety/power sources

- Should any solid object or liquid fall into the player, unplug the player, and have it checked by qualified personnel before operating it any further.
- Unplug the player from the wall outlet when it is not to be used for an extended period of time.
- For battery operation, use four size D (R20) batteries.
- When the batteries are not to be used, remove them to avoid damage that can be caused by battery leakage or corrosion.
- The nameplate indicating operating voltage, power consumption, etc. is located at the bottom.

### On placement/operation

- Do not leave the player in a location near heat sources, or in a place subject to direct sunlight, excessive dust or mechanical shock.
- Do not place anything within 10 mm of the rear side of the unit. The ventilation holes must be unobstructed for the player to operate properly and to prolong the life of its components.
- Since a strong magnet is used for the speakers, keep personal credit cards using magnetic coding or spring-wound watches away from the player to prevent possible damage from the magnet.
- Do not lift the handle when the telescopic antenna is extended.
- If the player has not been used for a long time, set it in the playback mode to warm it up for a few minutes before inserting a cassette.

### Notes on cassettes

- Break off the cassette tab from side A or B to prevent accidental recording. If you want to reuse the tape for recording, cover the broken tab with adhesive tape.
- The use of a cassette with more than 90 minutes of play time is not recommended except for long, continuous recording or playback.

If you have questions or problems concerning your player, please consult your nearest Sony dealer.

# Radio Cassette-Corder

## Operating Instructions

### CFM-12

©1995 by Sony Corporation Printed in Philippines

## WARNING

To prevent fire or shock hazard, do not expose the player to rain or moisture.

To avoid electrical shock, do not open the cabinet. Refer servicing to qualified personnel only.

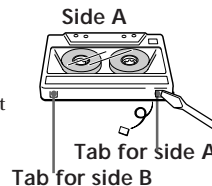

## Location and controls

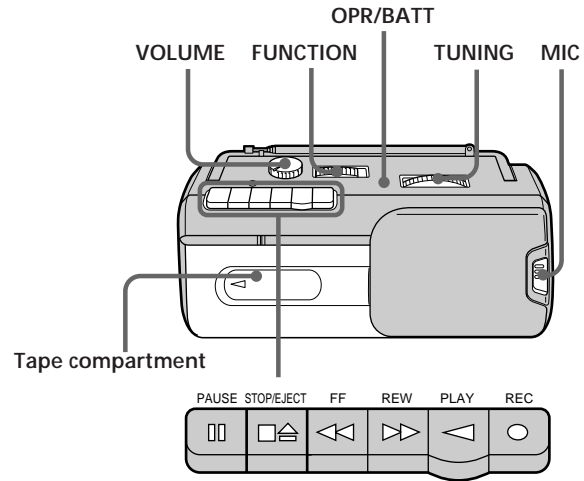

## Listening to the radio

- 1 Set FUNCTION to the band you want.
- 2 Tune in the station you want.

### To turn off the radio

Set FUNCTION to TAPE/RADIO OFF.

### To improve broadcast reception

Reorient the antenna for FM. Reorient the player itself for AM.

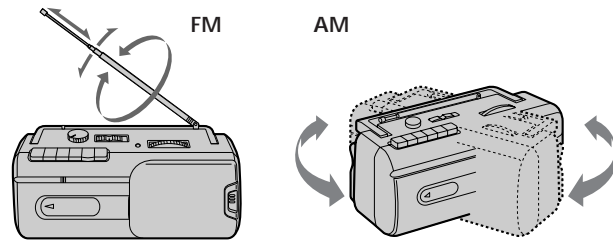

### Tip

For the best results, move the player away from the TV.

Use TYPE I (normal) tape only.

## Playing a tape

- 1 Set FUNCTION to TAPE/RADIO OFF.
- 2 Insert a recorded tape.
 

With the side you want to play on facing forward.
- 3 Press ◀ PLAY.

To	Press
Stop playback	■▲ When the tape reaches the end, the playback stops.
Fast-forward or rewind the tape	▶▶ or ◀◀
Pause playback	Press the button again to resume playing.
Eject the cassette	■▲

### When the tape reaches the end

The depressed button ◀◀, ▶▶ or ◀PLAY is released automatically (Auto shut-off function).

Use TYPE I (normal) tape only.

## Recording

- 1 To record from the radio  
Tune in the station you want.  
To record from the built-in microphone  
Set FUNCTION to TAPE/RADIO OFF.
- 2 Insert a blank tape.
 

With the side you want to record on facing forward.
- 3 Press ● REC.

To	Press
Stop recording	■▲ When the tape reaches the end, the recording stops.
Pause recording	Press the button again to resume recording.

### Tips

- For the best results, use the AC power source.
- Adjusting the volume will not affect the recording level.