

You are cautioned that any changes or modifications not expressly approved in this manual could void your authority to operate this equipment.

FM/AM Radio

Operating Instructions

ICF-18

Sony Corporation © 1997

Printed in China



Before You Begin

Thank you for choosing the Sony FM/AM Radio ! The FM/AM Radio will give you many hours of reliable service and listening pleasure. Before operating the Radio, please read these instructions thoroughly and retain them for future reference.

Features

- High power output radio.
- Long battery life with two R20 batteries.
- Easy to carry with the supplied carrying strap.

Precautions

- Do not open the unit. Refer servicing to qualified personnel only.
- Operate the unit only on 3 V DC with two size D (R20) batteries.
- Avoid exposure to temperature extremes, direct sunlight, moisture, sand, dust, or mechanical shock. Never leave in a car parked in the sun.
- Should any solid object or liquid fall into the unit, remove the batteries, and have the unit checked by qualified personnel before operating it any further.
- Since a strong magnet is used for the speaker, keep personal credit cards using magnetic coding or spring-wound watches away from the unit to prevent possible damage from the magnet.
- To clean the casing, use a soft cloth dampened with a mild detergent solution. Never use abrasive cleaners or chemical solvents, as they may mar the casing.
- In vehicles or in buildings, radio reception may be difficult or noisy. Try listening near a window.

If you have any questions or problem concerning your unit , please consult the nearest Sony dealer.

Specifications

Frequency range
 FM: 87.5 - 108.0 MHz
 AM: 530 - 1605 kHz

Speaker
 Approx. 9.2 cm dia.

Power output
 300 mW (max.)

Output
 Ⓞ jack (minijack)

Power requirements
 3 V DC, two size D (R20) batteries

Dimensions
 Approx. 204 × 131.5 × 73.2 mm
 (8 x 5 3/16 x 2 7/8 in.) (w/h/d)

incl. projecting parts and controls

Mass
 Approx. 694 g (1lb 8 oz) incl. batteries

Accessory supplied
 Carrying strap (1)

Design and specifications are subject to change without notice.

WARRANTY

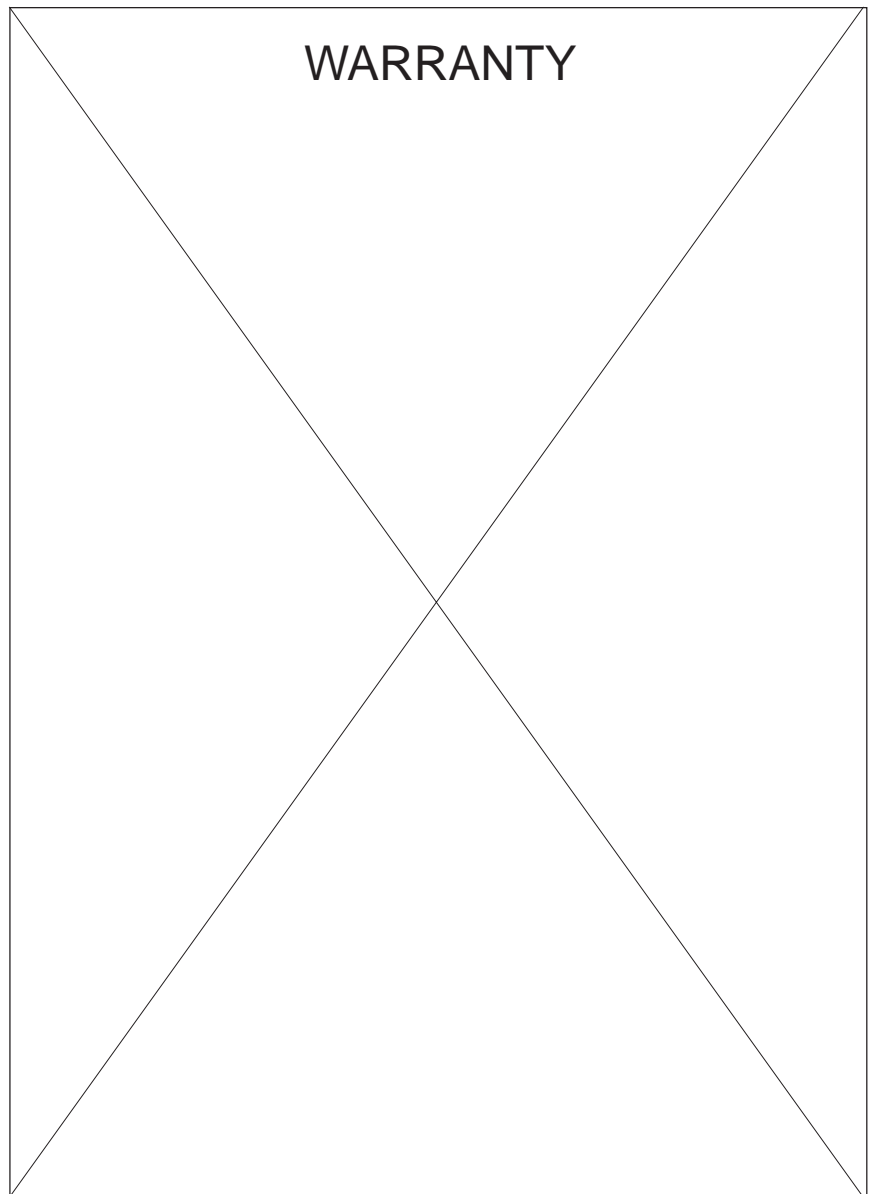

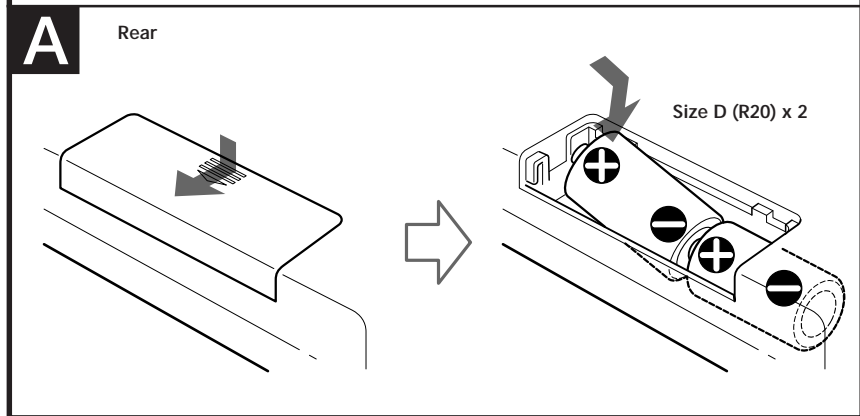
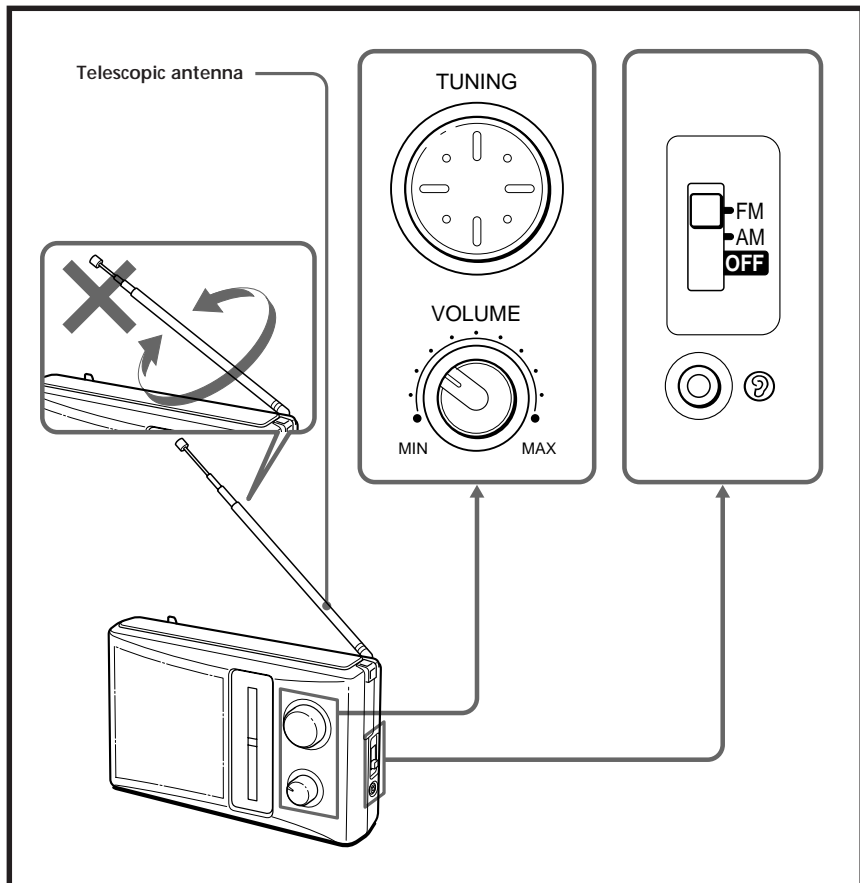

Installing the Batteries (see fig. A)

- 1 Open the lid of the battery case at the rear of the radio.
- 2 Insert the batteries (not supplied) with correct polarity.
- 3 Close the lid.

Battery life

Using Sony batteries size D (R20):

FM: Approx. 200 hours

AM: Approx. 220 hours

Replacing the batteries

When the sound becomes weak or distorted, replace all the batteries with new ones.

Notes on batteries

- Do not charge the dry batteries.
- Do not carry the batteries with coins or other metallic objects. It can generate heat if the positive and negative terminals of the batteries are accidentally contacted by a metallic object.
- When you are not going to use the unit for a long time, remove the batteries to avoid damage from battery leakage and corrosion.

Playing the Radio

- 1 Set FM/AM/OFF to FM or AM.



- 2 Tune in a station using TUNING.

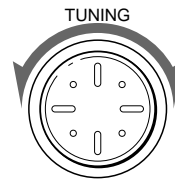

- 3 Adjust the volume using VOLUME.

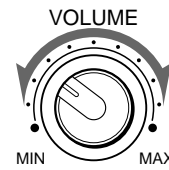

- To turn off the radio, set FM/AM/OFF to OFF.
- To improve radio reception
FM: Extend the telescopic antenna and adjust the length and the angle for best reception.

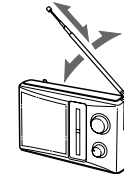

- AM: Rotate the unit horizontally for optimum reception. A ferrite bar is built in the unit.

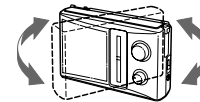

- For private listening, connect an earphone (not supplied) to the Ⓣ jack.

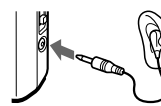

- When an earphone is connected to the Ⓣ jack, the sound will not emit through the speaker.

Attaching the Supplied Carrying Strap

When you carry the unit, use the supplied carrying strap.

Pass the strap under the bar on each side of the radio.

Pass the strap through the buckle.

