

FM Stereo/AM Radio

Operating Instructions

SRF-S83

Sony Corporation © 2000

Operation

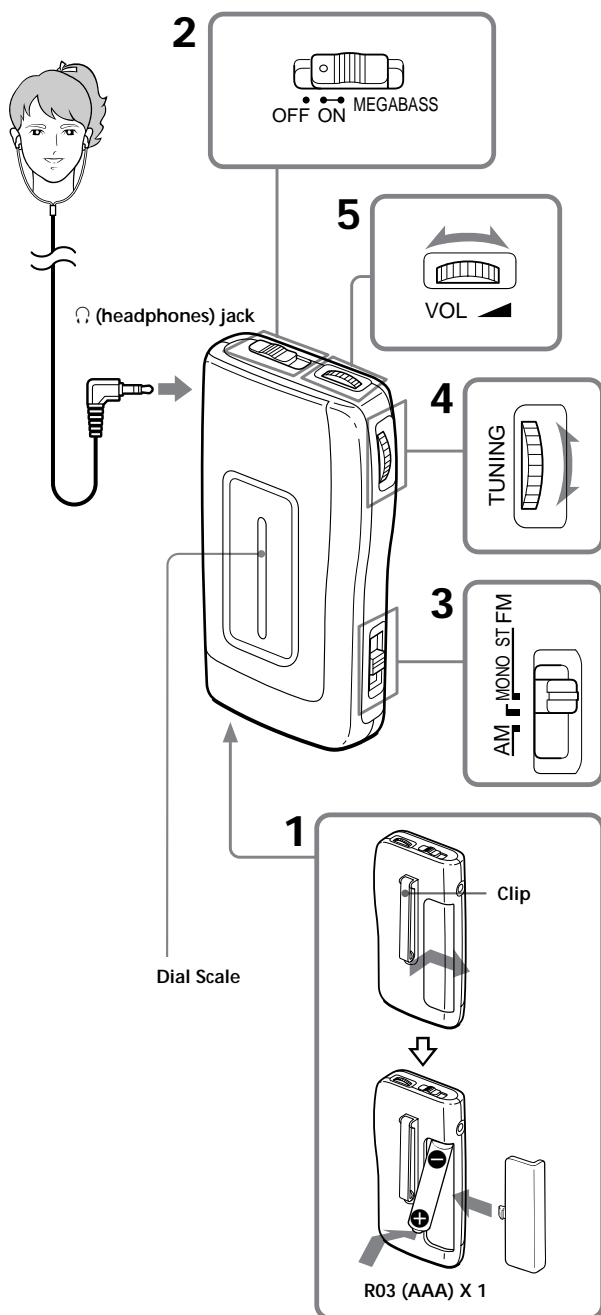

Before operating the unit, please read this manual thoroughly and retain it for future reference.

Precautions

- Avoid exposure to temperature extreme, direct sunlight, moisture, sand, dust, or mechanical shock. Never leave the unit in a car parked in the sun.
- In vehicles or in buildings, radio reception may be difficult or noisy. Try listening near a window.
- If there is lightning when you are using this unit, take off the headphones immediately.

Notes on Headphones

Road safety

Do not use headphones while driving, cycling, or operating any motorized vehicle. It may create a traffic hazard and is illegal in some areas. It can also be potentially dangerous to play your headsets at high volume while walking, especially at pedestrian crossings. You should exercise extreme caution or discontinue use in potentially hazardous situations.

Preventing hearing damage

Avoid using headphones at high volume. Hearing experts advise against continuous, loud and extended play. If you experience a ringing in your ears, reduce volume or discontinue use.

Caring for others

Keep the volume at a moderate level. This will allow you to hear outside sounds and to be considerate to the people around you.

Operation

- 1 Insert a battery.
- 2 Set the ON/OFF switch to ON to turn on the radio.
- 3 Select the band.
FM mode
ST (stereo): for FM stereo reception, normally set the ST/MONO switch to ST.
MONO (monaural): when the FM reception is poor, set it to MONO.
AM: for AM reception.
- 4 Tune in the desired station.
- 5 Adjust the volume.

After listening, set the ON/OFF switch to OFF.

To improve the reception

FM: Extend the headphones cord fully. If functions as an FM antenna.
AM: The ferrite bar antenna is built into the unit. Rotate the unit horizontally for optimum reception.

To Enjoy Powerful Bass Sound

Set the MEGA BASS selector to ON to emphasize bass sound.

Notes on a Battery

When the sound gets distorted or unstable, replace the battery with new one. For battery life, see "Specifications".

To avoid damage from battery leakage and corrosion

Remove the battery when you do not use the unit for a long time.

Specifications

Frequency range FM: 87.5 - 108 MHz AM: 526.5 - 1 606.5 kHz (Italy)/530 - 1 605 kHz (Other countries) Intermediate frequency FM: 1st 28.4 MHz 2nd: 150 kHz AM: 55 kHz Power output 3.6 mW + 3.6 mW (at 10 % harmonic distortion) Output Headphones jack (stereo minijack) load impedance 16 Ω Power requirements 1.5 V DC, one R03 (size AAA) battery Battery life FM: 38 hours AM: 46 hours with Sony alkaline LR03 (size AAA) battery /FM: 16 hours AM: 21 hours with Sony R03 (size AAA) battery Dimensions Approx. 42.5 x 80 x 16.5 mm (w/h/d) not incl. projecting parts and controls Mass Approx. 59 g incl. a battery and headphones Accessories supplied Stereo headphones (1)

Design and specifications are subject to change without notice.

