



4-136-137-11(1)

# Quick Setup Guide

DAV-HDX285

## 1 Connecting the speakers

Connect the speaker cords to match the color of the SPEAKER jacks of the unit.

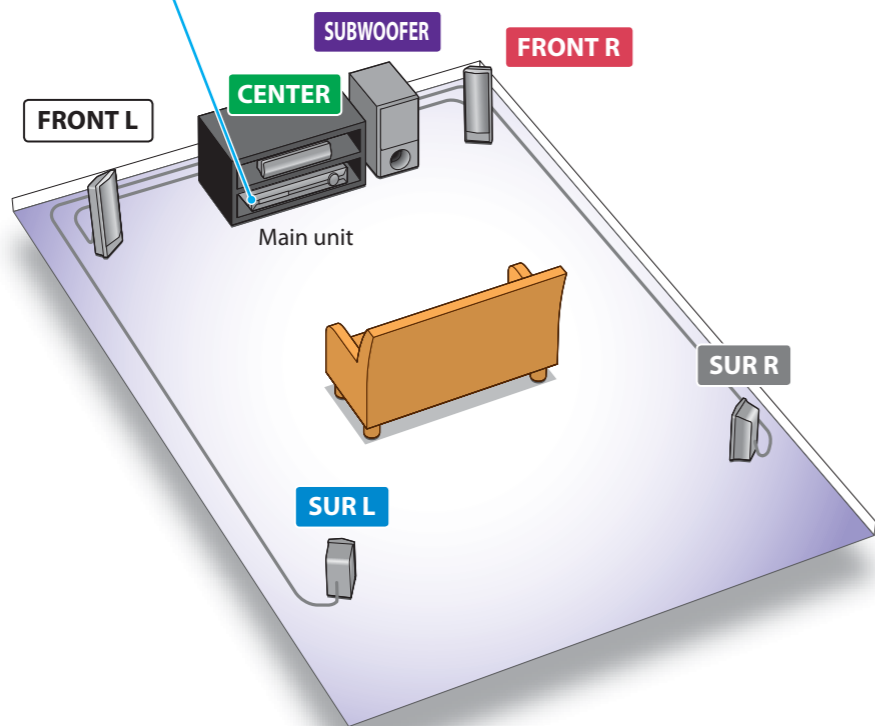
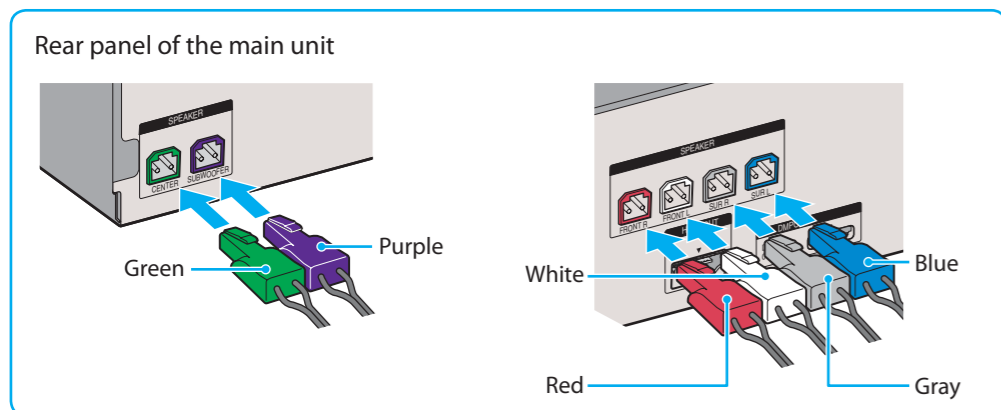

To connect speaker cords to the speaker

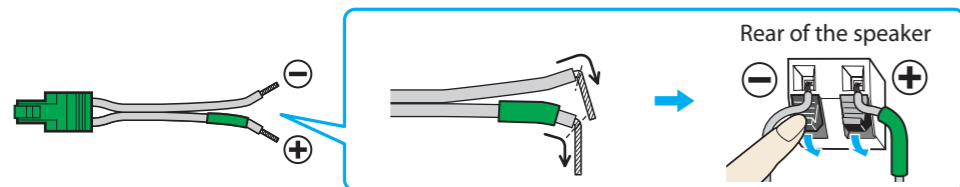

## 2 Connecting the TV

Depending on the jacks on your TV, select the video and audio connection method.

### Video connection method

#### Method 1

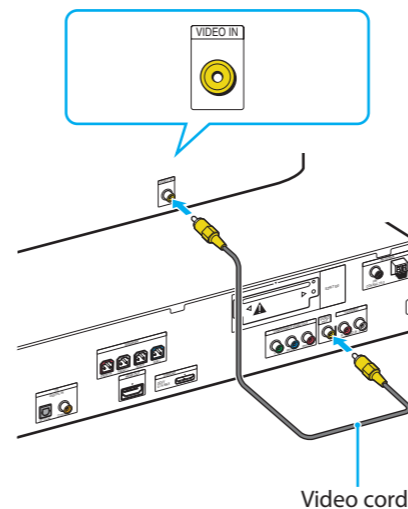

#### Method 2

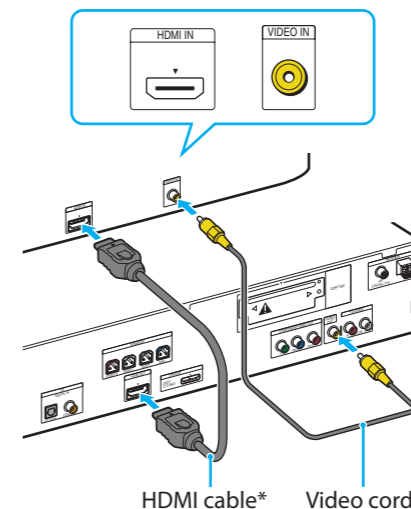

#### Method 3

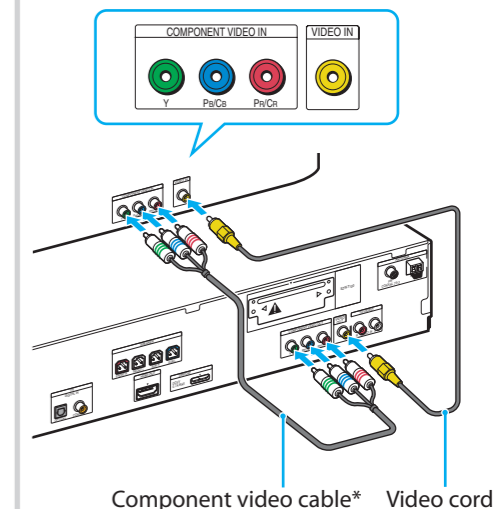

\*Not supplied

### Audio connection method

#### Method 1

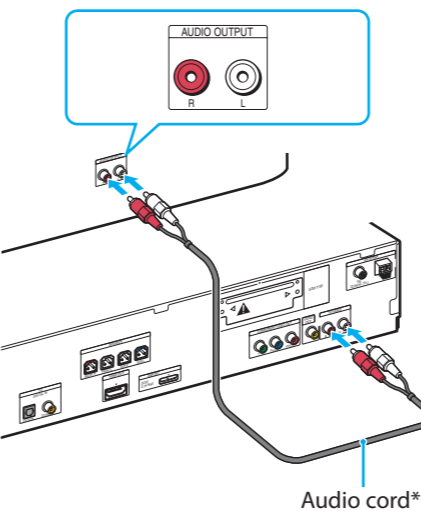

#### Method 2

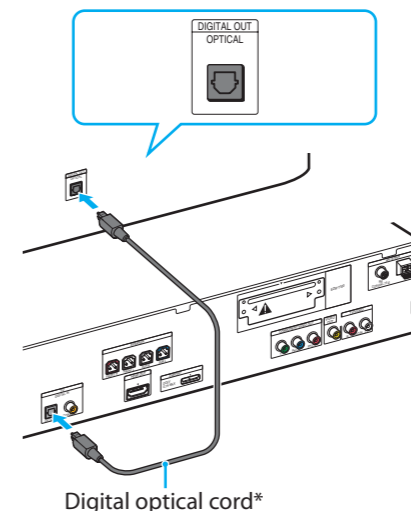

#### Method 3

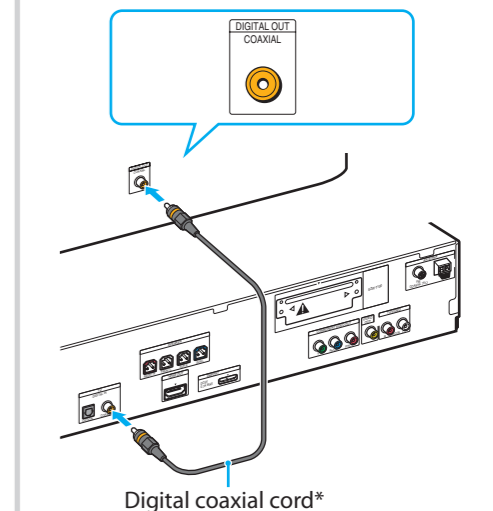

\*Not supplied

# 3 Performing the Quick Setup

Note

Do not insert a disc before performing the Quick Setup.

## 1 Connect the AC power cord.

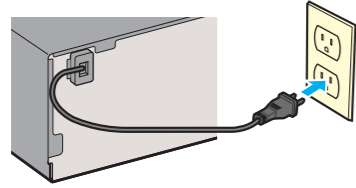

## 2 Turn on the power of the main unit and TV.

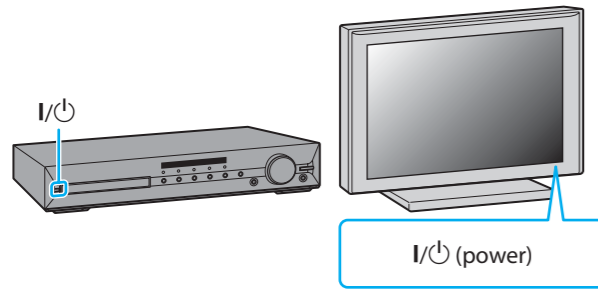

## 3 Switch the input selector on your TV to display "SONY Home Theatre System."

## 4 Set each following item, using ←/↑/↓/→ and +.

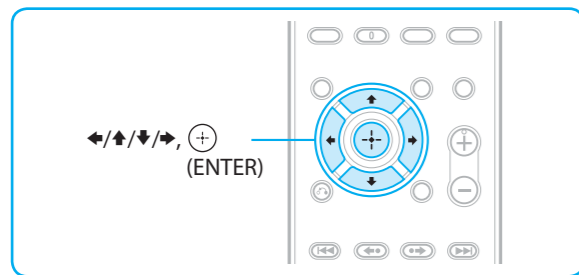

Note

Displayed items vary depending on the area.



Select an on-screen language.

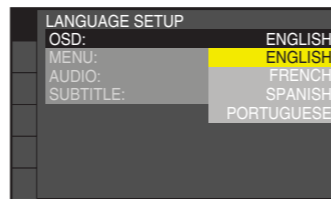

Select the aspect ratio of the connected TV.

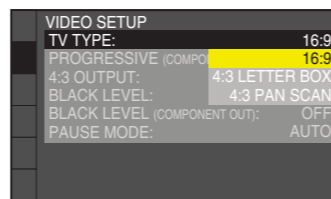

Select [ON] when you connect the main unit and the TV with an HDMI cable.

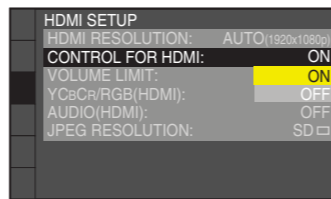

Select the speaker formation.

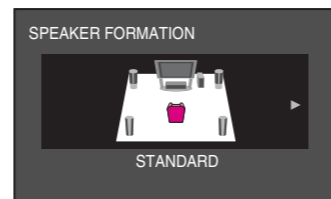

Connect the calibration mic and set it at the listening position.

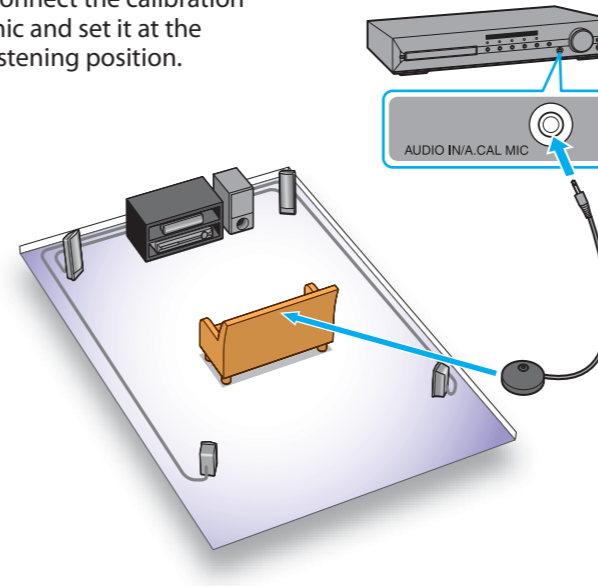

Select [YES] to perform [AUTO CALIBRATION].

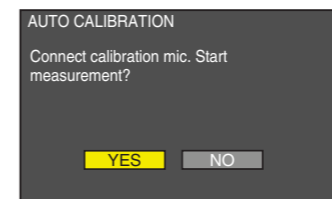

Select [YES] to save the measurement results.

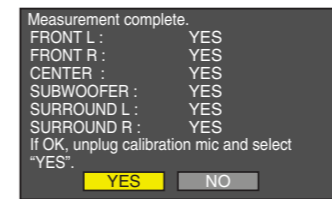

# Listening to TV sound from all speakers

## 1 Press FUNCTION +/- to display "TV/VIDEO."

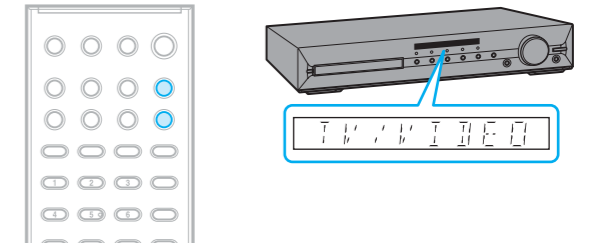

## 2 Press SYSTEM MENU.

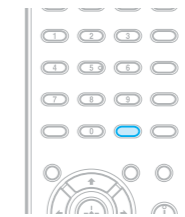

## 3 Press ↑/↓ to display "DEC. MODE," then press +.

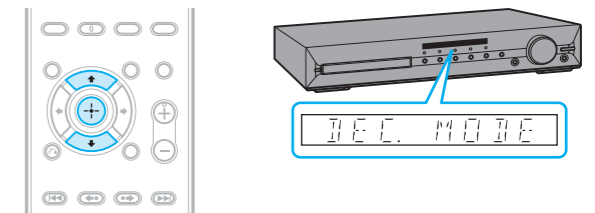

## 4 Press ↑/↓ to display "PRO LOGIC," then press +.

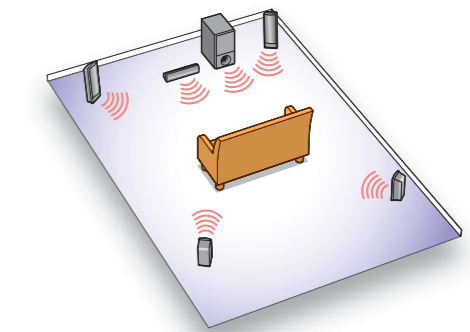
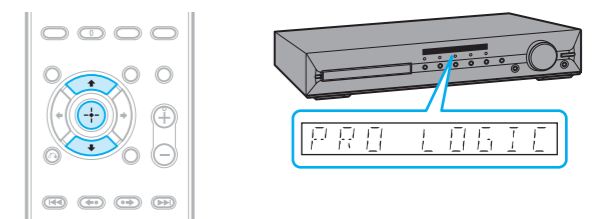

## 5 Press SYSTEM MENU to exit the menu.