



4-136-142-11(1)

Quick Setup Guide

DAV-HDX585

1 Connecting the speakers

Connect the speaker cords to match the color of the **SPEAKER** jacks of the unit.

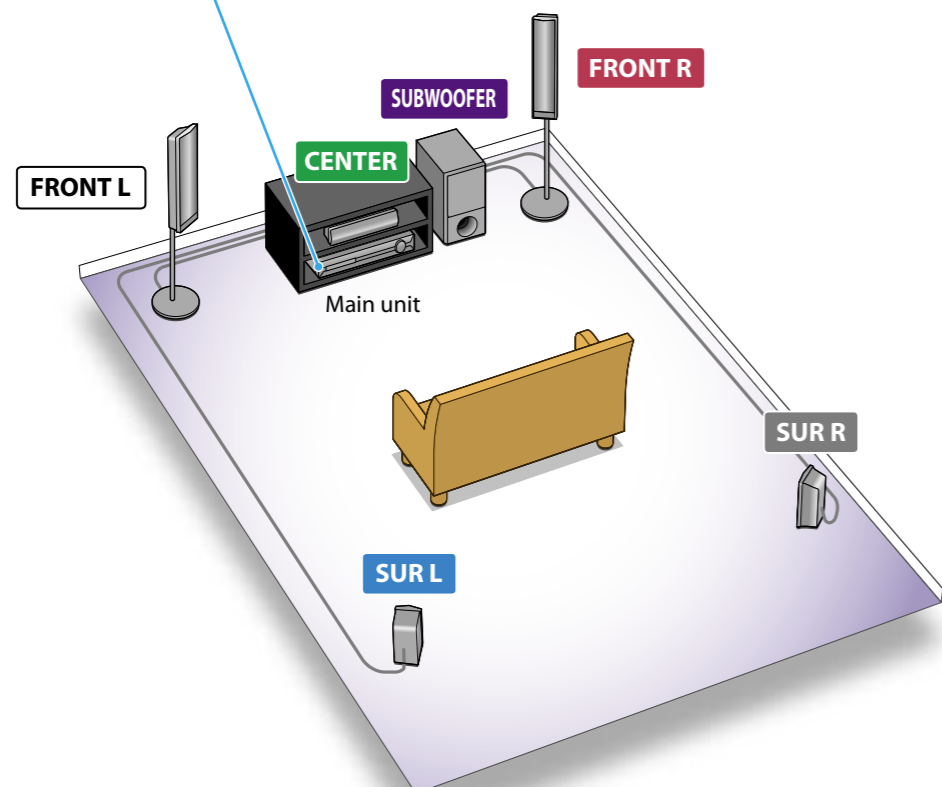
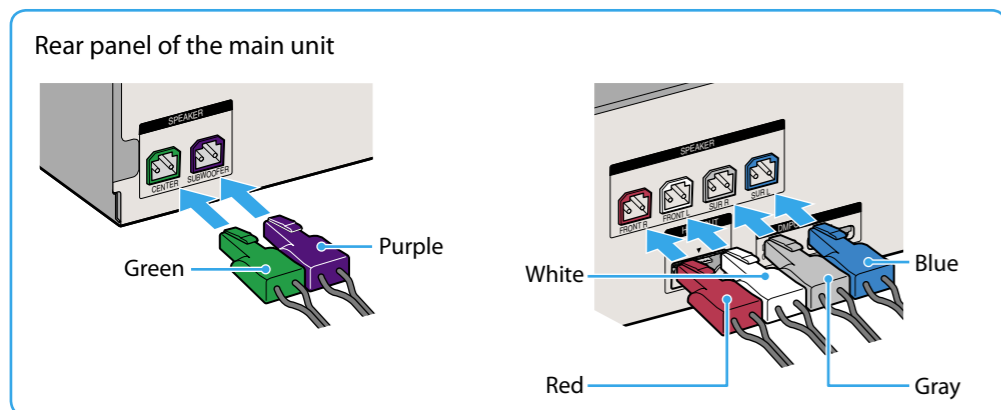

To connect speaker cords to the speaker

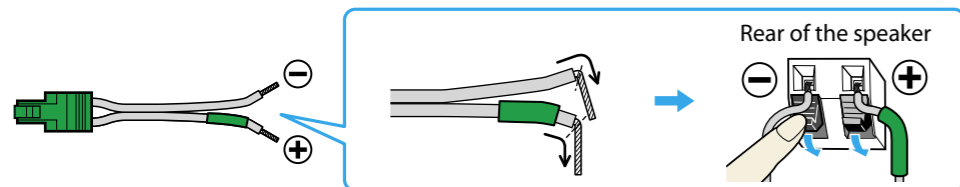

2 Connecting the TV

Depending on the jacks on your TV, select the video and audio connection method.

Video connection method

Method 1

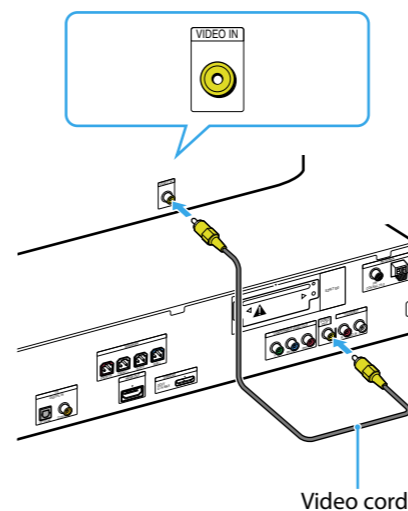

Method 2

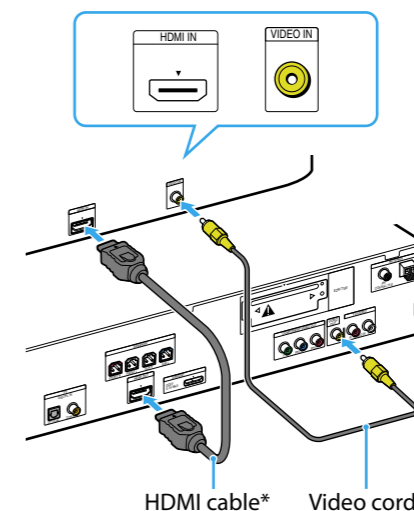

Method 3

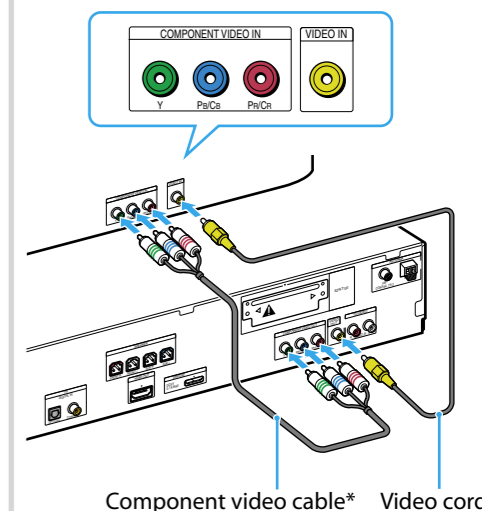

*Not supplied

Audio connection method

Method 1

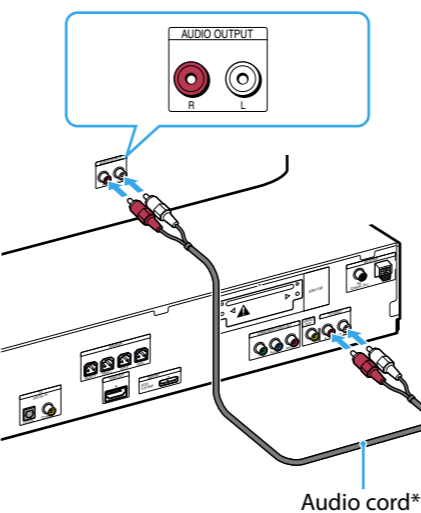

Method 2

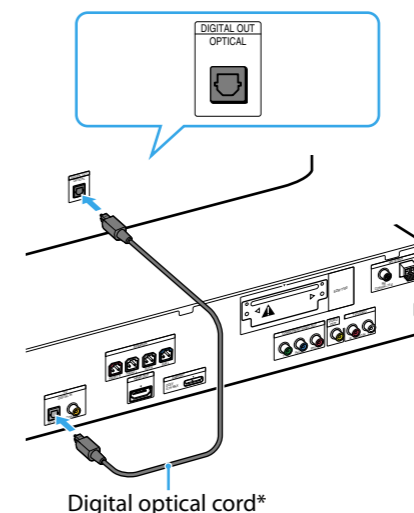

Method 3

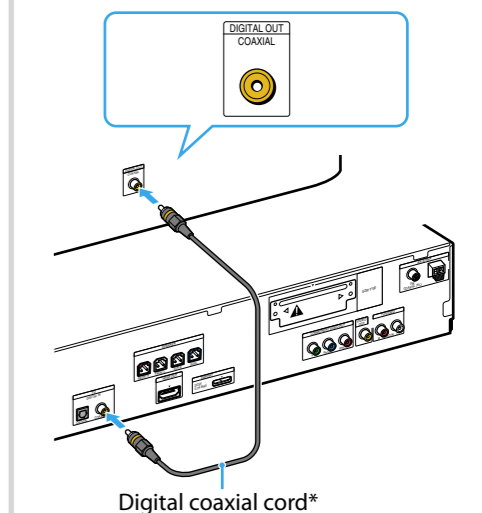

*Not supplied

3 Performing the Quick Setup

Note

Do not insert a disc before performing the Quick Setup.

1 Connect the AC power cord.

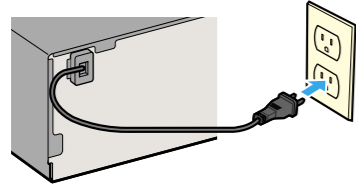

2 Turn on the power of the main unit and TV.

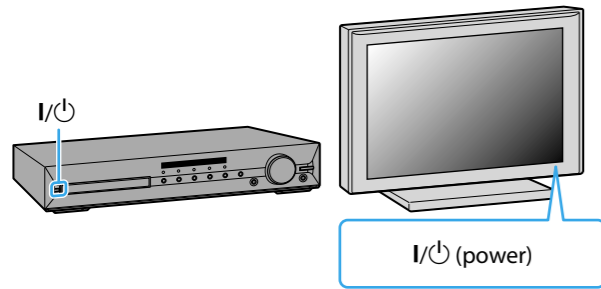

3 Switch the input selector on your TV to display "SONY Home Theatre System."

4 Set each following item, using ←/↑/↓/→ and +.

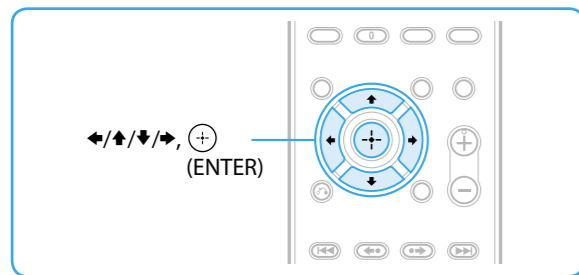

Note

Displayed items vary depending on the area.



Select an on-screen language.

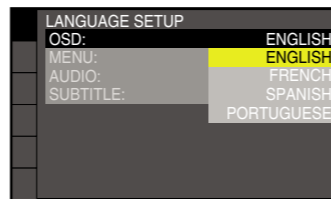

Select the aspect ratio of the connected TV.

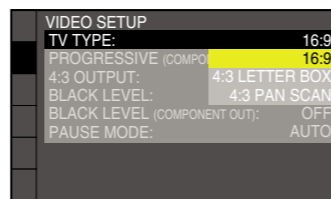

Select [ON] when you connect the main unit and the TV with an HDMI cable.

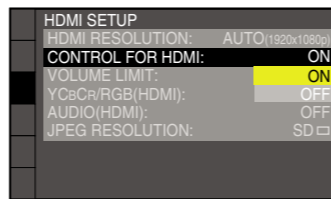

Select the speaker formation.

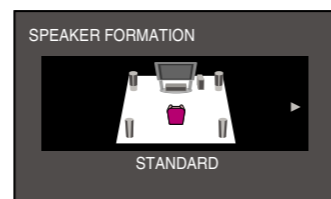

Connect the calibration mic and set it at the listening position.

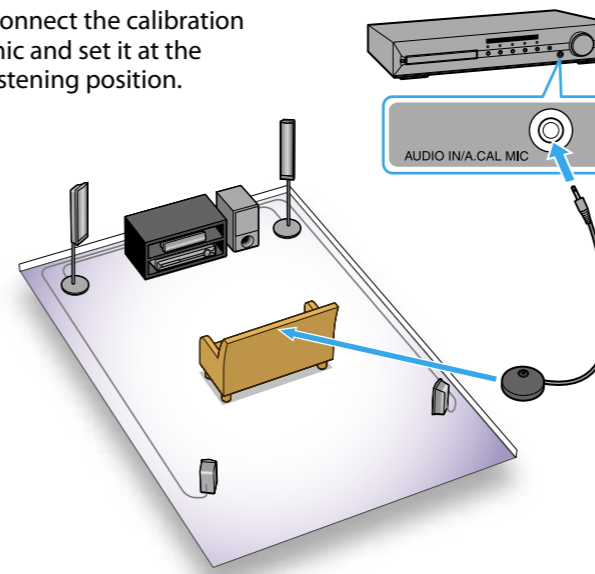

Select [YES] to perform [AUTO CALIBRATION].

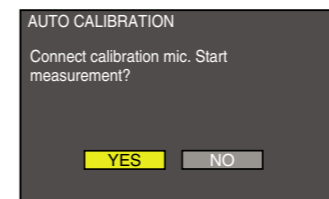

Select [YES] to save the measurement results.

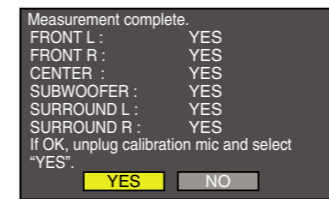

Listening to TV sound from all speakers

1 Press FUNCTION +/- to display "TV/VIDEO."

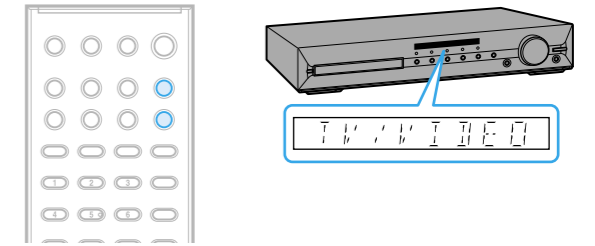

2 Press SYSTEM MENU.

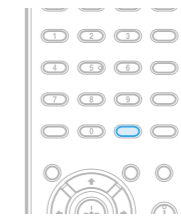

3 Press ↑/↓ to display "DEC. MODE," then press +.

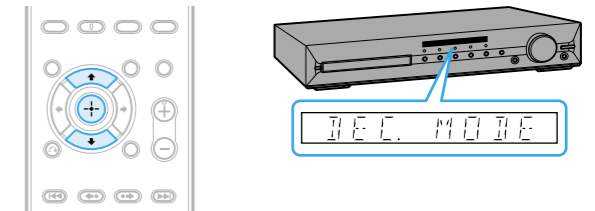

4 Press ↑/↓ to display "PRO LOGIC," then press +.

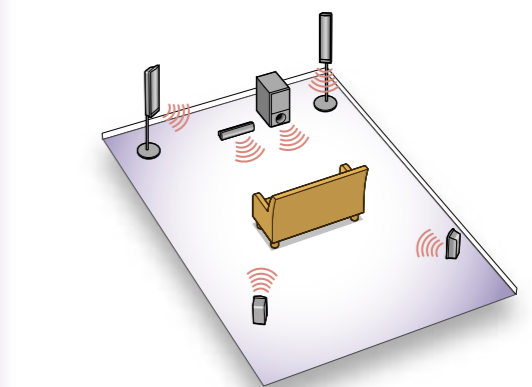
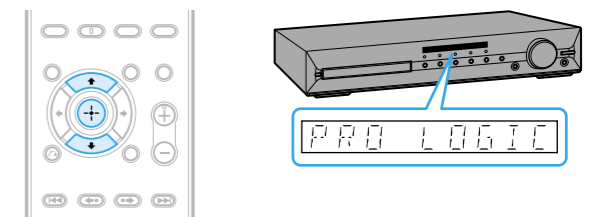

5 Press SYSTEM MENU to exit the menu.