



4-142-220-11(1)

## Quick Setup Guide

DAV-HDX287WC

### 1 Connecting the speakers

Connect the speaker cords to match the color of the SPEAKER jacks of the unit.

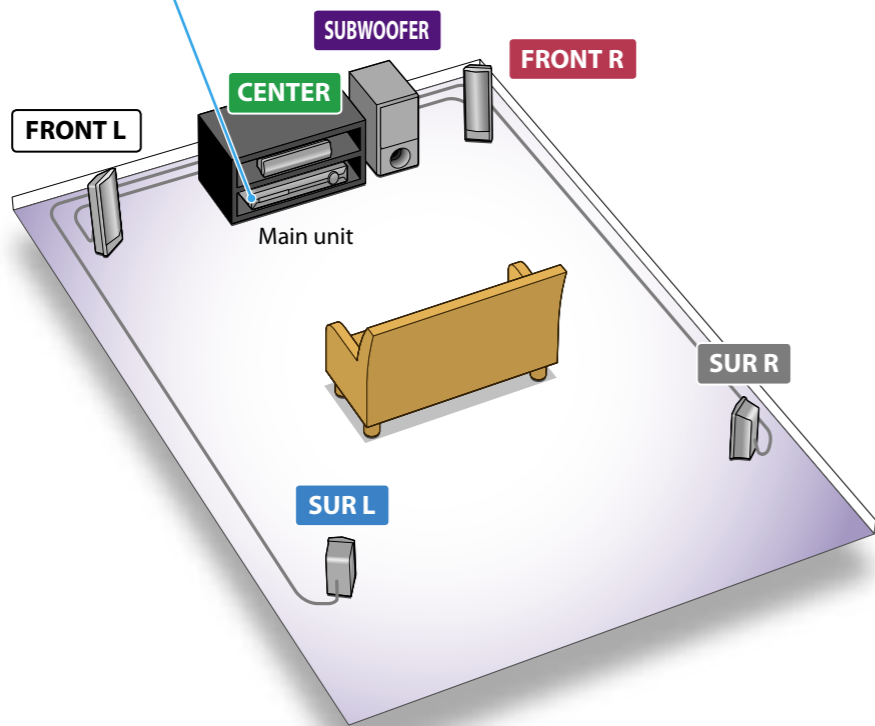
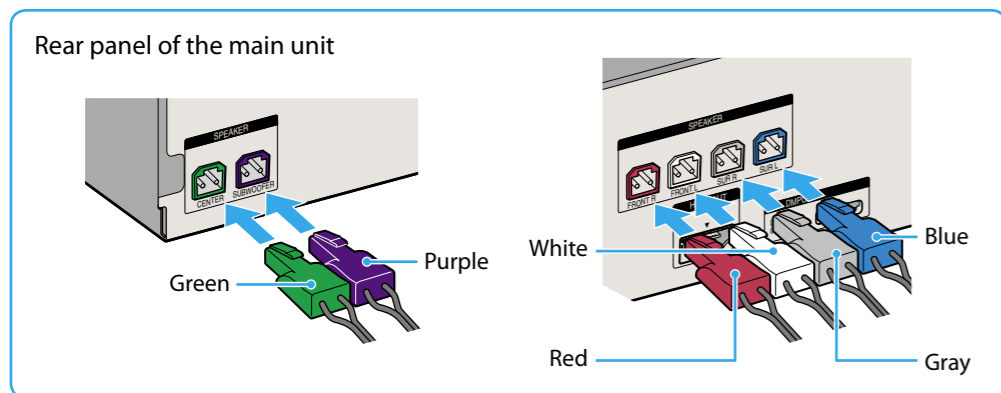

To connect speaker cords to the speaker

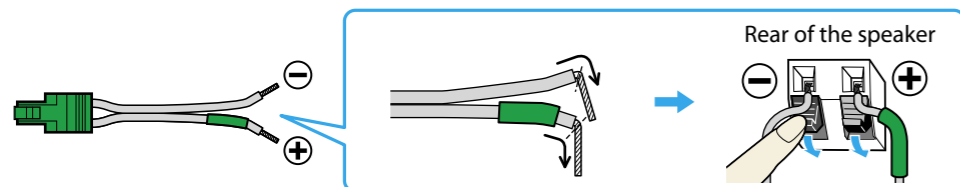

### 2 Connecting the TV

Depending on the jacks on your TV, select the video and audio connection method.

#### Video connection method

##### Method 1

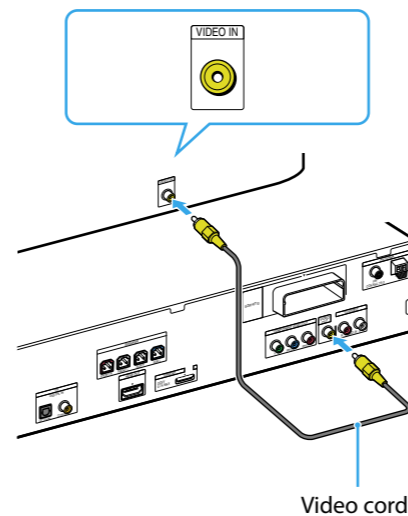

##### Method 2

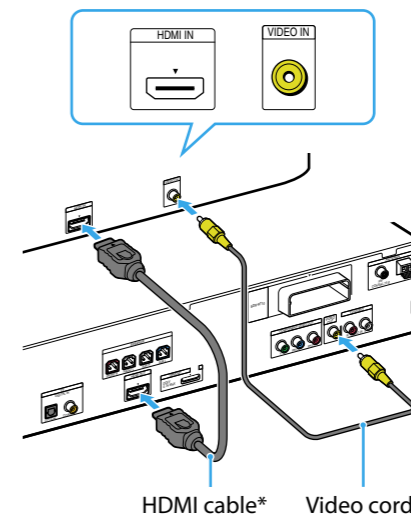

##### Method 3

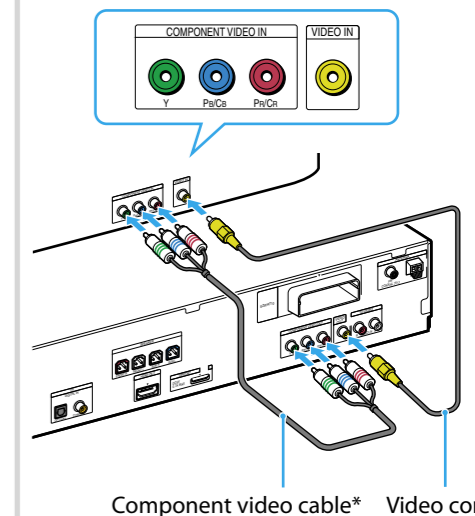

\*Not supplied

#### Audio connection method

##### Method 1

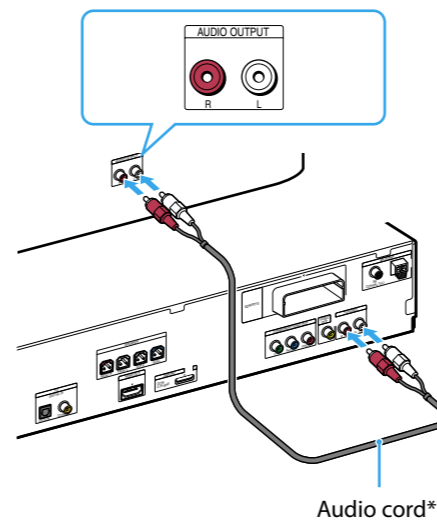

##### Method 2

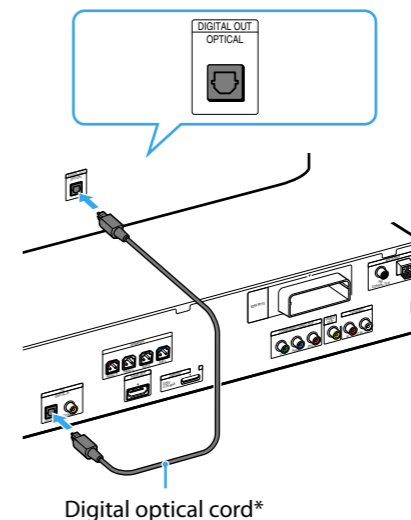

##### Method 3

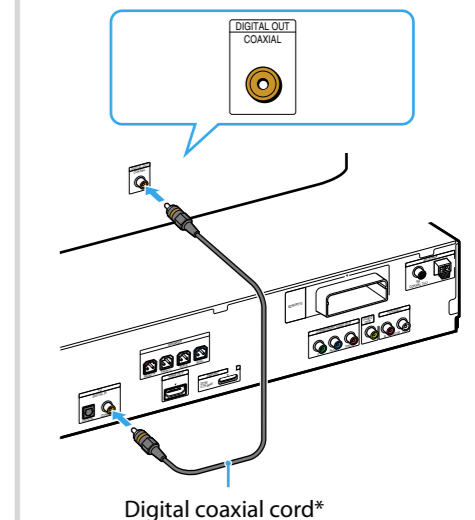

\*Not supplied

### 3 Enabling wireless transmission

#### 1 Insert the wireless transceiver.

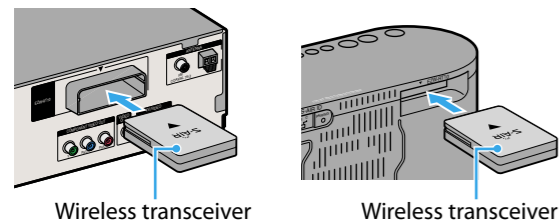

#### 2 Set the S-AIR ID switch to "A."

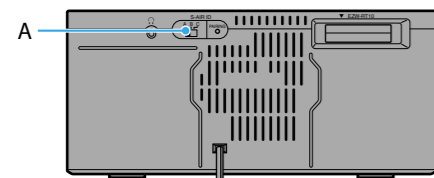

#### 3 Connect the AC power cord.

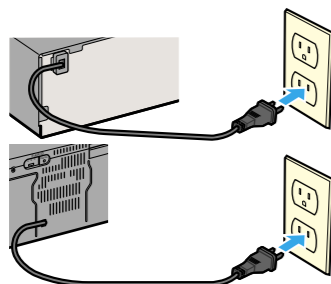

#### 4 Turn on the power of the main unit, the S-AIR receiver, and the TV.

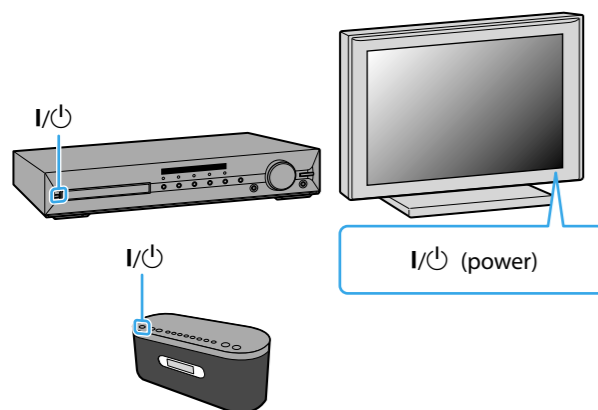

### 4 Performing the Quick Setup

**Note**  
Do not insert a disc before performing the Quick Setup.

- 1 Switch the input selector on your TV to display "SONY Home Theatre System."
- 2 Set each following item, using  $\leftarrow/\rightarrow/\uparrow/\downarrow$  and  $\oplus$ .

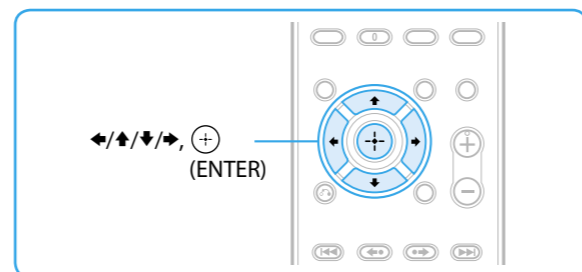

**Note**  
Displayed items vary depending on the area.



Select an on-screen language.

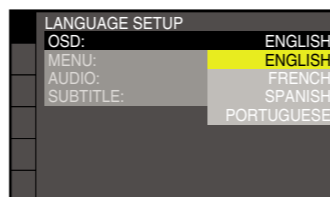

Select the aspect ratio of the connected TV.

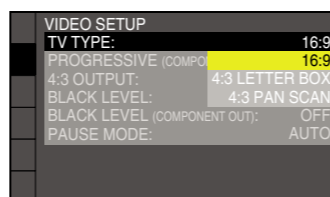

Select [ON] when you connect the main unit and the TV with an HDMI cable.

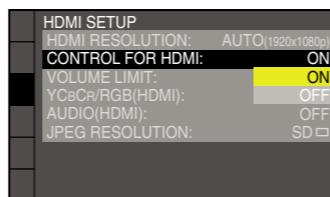

Select the speaker formation.

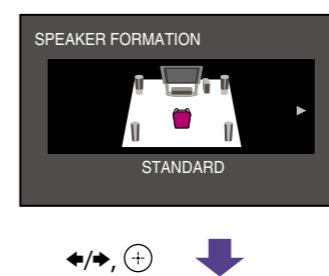

Connect the calibration mic and set it at the listening position.

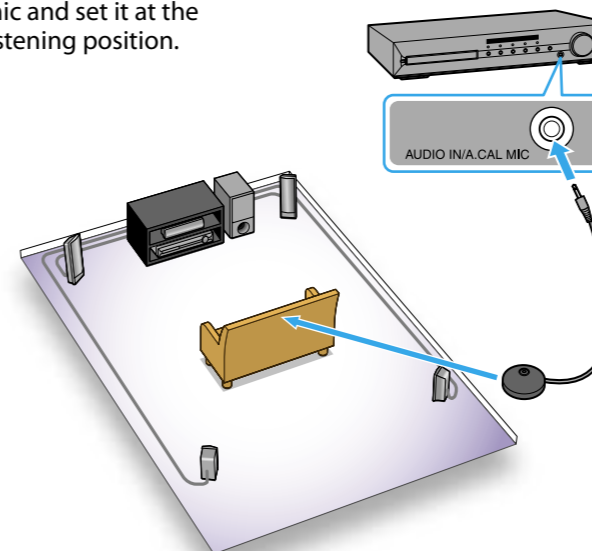

Select [YES] to perform [AUTO CALIBRATION].

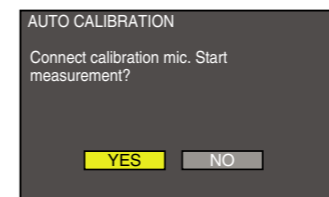

Select [YES] to save the measurement results.

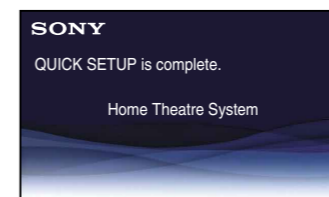
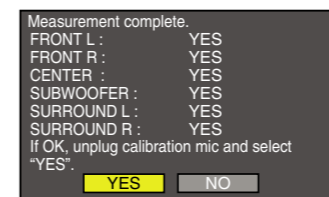

### Listening to TV sound from all speakers

#### 1 Press FUNCTION +/- to display "TV/VIDEO."

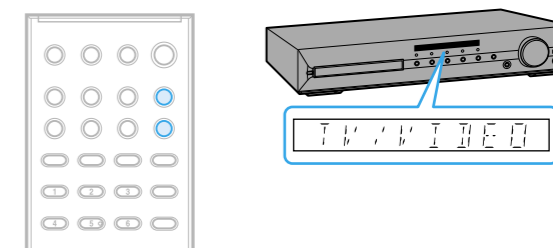

#### 2 Press SYSTEM MENU.

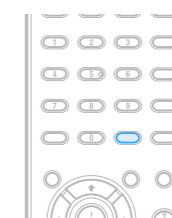

#### 3 Press $\uparrow/\downarrow$ to display "DEC. MODE," then press $\oplus$ .

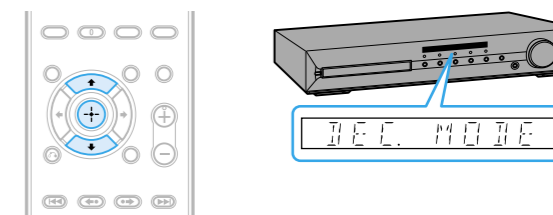

#### 4 Press $\uparrow/\downarrow$ to display "PRO LOGIC," then press $\oplus$ .

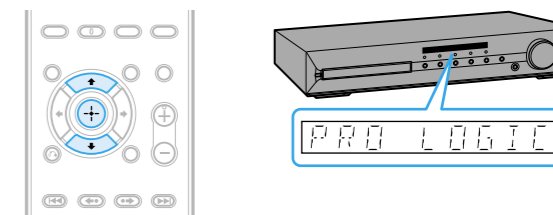

#### 5 Press SYSTEM MENU to exit the menu.

