

WARNING

To reduce the risk of fire or electric shock, do not expose this apparatus to rain or moisture.

To reduce the risk of fire, do not cover the ventilation of the apparatus with newspapers, tablecloths, curtains, etc. And do not place lighted candles on the apparatus. To reduce the risk of fire or electric shock, do not expose this apparatus to dripping or splashing, and do not place objects filled with liquids, such as vases, on the apparatus.

Do not install the appliance in a confined space, such as a bookcase or built-in cabinet.

As the main plug is used to disconnect the unit from the mains, connect the unit to an easily accessible AC outlet. Should you notice an abnormality in the unit, disconnect the main plug from the AC outlet immediately.

Notice for customers: the following information is only applicable to equipment sold in countries applying EU directives
The manufacturer of this product is Sony Corporation, 1-7-1 Konan, Minato-ku, Tokyo, 108-0075 Japan. The Authorized Representative for EMC and product safety is Sony Deutschland GmbH, Hedelfinger Strasse 61, 70327 Stuttgart, Germany. For any service or guarantee matters, please refer to the addresses given in separate service or guarantee documents.

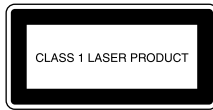

WARNING

- Danger of explosion if battery is incorrectly replaced. Replace only with the same or equivalent type.
- Replace the battery for the clock backup with a Sony CR2032 lithium battery, and the battery for the remote commander with a Sony CR2025 lithium battery. Use of another battery may present a risk of fire or explosion.
- Battery may explode if mistreated. Do not recharge, disassemble or dispose of in fire.
- Do not expose the batteries (battery pack or batteries installed) to excessive heat such as sunshine, fire or the like for a long time.
- Dispose of used battery promptly. Keep away from children.

“CAUTION-CLASS 1M INVISIBLE LASER RADIATION WHEN OPEN AND INTERLOCKS DEFEATED DO NOT VIEW DIRECTLY WITH OPTICAL INSTRUMENTS”

Features

- Brightness control (High/Mid/Low)
- Supplied audio cable for digital music players
- Built-in CD player with CD-R/RW playback function
- FM/AM 2-band digital tuner
- 30 Station Presets (20 FM, 10 AM)
- Automatic Time/Daylight Saving Time Setting
- No Power No Problem alarm system to keep the clock and the alarm operating during a power interruption with a CR2032 battery installed
- Extendable Snooze time from 10 to 60 min

Precautions

- Play the unit on the power source specified in “Specifications”.
- To disconnect the AC power cord (mains lead), pull it out by the plug, not the cord.
- The unit is not disconnected from the AC power source (mains) as long as it is connected to the wall outlet, even if the player itself has been turned off.
- The nameplate and important information concerning safety are located on the bottom exterior.
- Since a strong magnet is used for the speaker, keep personal credit cards using magnetic coding or spring-wound watches away from the unit to prevent possible damage from the magnet.
- Do not leave the unit in a location near a heat source such as a radiator or airduct, or in a place subject to direct sunlight, excessive dust, mechanical vibration, or shock.
- Allow adequate air circulation to prevent internal heat build-up. Do not place the unit on a surface (a rug, a blanket, etc.) or near materials (a curtain) which might block the ventilation holes.

- Should any solid object or liquid fall into the unit, unplug the unit and have it checked by qualified personnel before operating it any further.
- To clean the casing, use a soft cloth dampened with a mild detergent solution.
- Never touch the wire of the external FM aerial during a thunderstorm. Furthermore, immediately disconnect the AC power cord from the radio.

NOTES ON LITHIUM BATTERY

- Wipe the battery with a dry cloth to assure a good contact.
- Be sure to observe the correct polarity when installing the battery.
- Do not hold the battery with metallic tweezers, otherwise a short-circuit may occur.



Disposal of Old Electrical & Electronic Equipment (Applicable in the European Union and other European countries with separate collection systems)

This symbol on the product or on its packaging indicates that this product shall not be treated as household waste. Instead it shall be handed over to the applicable collection point for the recycling of electrical and electronic equipment. By ensuring this product is disposed of correctly, you will help prevent potential negative consequences for the environment and human health, which could otherwise be caused by inappropriate waste handling of this product. The recycling of materials will help to conserve natural resources. For more detailed information about recycling of this product, please contact your local Civic Office, your household waste disposal service or the shop where you purchased the product.



Disposal of waste batteries (applicable in the European Union and other European countries with separate collection systems)

This symbol on the battery or on the packaging indicates that the battery provided with this product shall not be treated as household waste. On certain batteries this symbol might be used in combination with a chemical symbol. The chemical symbols for mercury (Hg) or lead (Pb) are added if the battery contains more than 0.0005% mercury or 0.004% lead. By ensuring these batteries are disposed of correctly, you will help prevent potentially negative consequences for the environment and human health which could otherwise be caused by inappropriate waste handling of the battery. The recycling of the materials will help to conserve natural resources.

In case of products that for safety, performance or data integrity reasons require a permanent connection with an incorporated battery, this battery should be replaced by qualified service staff only. To ensure that the battery will be treated properly, hand over the product at end-of-life to the applicable collection point for the recycling of electrical and electronic equipment.

For all other batteries, please view the section on how to remove the battery from the product safely. Hand the battery over to the applicable collection point for the recycling of waste batteries.

For more detailed information about recycling of this product or battery, please contact your local Civic Office, your household waste disposal service or the shop where you purchased the product.

If you have any questions or problems concerning your unit, please consult your nearest Sony dealer.

Troubleshooting

Should any problem persist after you have made the following checks, consult your nearest Sony dealer.

The clock flashes “0:00” due to a power interruption.

- The battery is low. Replace the battery. Remove the old battery and install a new one.

The CD, radio, iPod or buzzer alarm does not sound at the preset alarm time.

- Check that “ALARM A” or “ALARM B” is properly displayed.

The CD, radio or alarm of iPod is activated but no sound comes on at the preset alarm time.

- Has **VOLUME** been adjusted?
- The **CD player does not operate.**
- Did you close the CD compartment lid?
- Did you insert the disc correctly? The disc should be inserted with the label side up.
- Dusty or defective disc — Clean the disc with an optional cleaning cloth. Wipe the disc from the center out.
- Take out the CD and leave the CD compartment open for about an hour to allow condensation to evaporate.

There is no sound from the iPod.

- Make sure the iPod is securely connected.
- Adjust the **VOLUME**.

The iPod cannot be operated with this unit.

- Make sure the iPod is securely connected.
- The **iPod cannot be charged.**
- Make sure the iPod is securely connected.

When daylight saving time begins, the clock does not employ the daylight saving time automatically.

- Make sure the clock is set correctly.
- Press and hold **CLOCK** and **BRIGHTNESS/TIME ZONE** simultaneously for at least two seconds to employ the DST function.

Specifications

CD player section

System
Compact disc digital audio system

Laser diode properties
Emission duration: Continuous
Laser output: Less than 44.6 μW (This output is the value measurement at a distance of 200 mm from the objective lens surface on the optical pick-up block with 7 mm aperture.)

Number of channels
2

Frequency response
20 - 20 000 Hz +1/-2 dB

Wow and flutter
Below measurable limit

Section for iPod
DC out: 5V
MAX: 500mA (AC only)

Band	Frequency	Channel step
FM	87.5 – 108 MHz	0.05 MHz
AM	531 – 1 611 kHz	9 kHz
	530 – 1 610 kHz	10 kHz

General

Time display
24-hour system

Speaker
Approx. 3.8 cm (1 1/2 inches) dia. 20 Ω

Input
AUDIO IN jack (ø 3.5 mm stereo minijack)

Power output
1 W + 1 W (at 10% harmonic distortion)

Power requirements
230 V AC, 50 Hz

For clock back up: 3 VDC one CR2032 battery

Dimensions
Approx. 145 x 156.8 x 115.8 mm (w/h/d)

(5 3/4 x 6 1/4 x 4 5/8 inches) not including projecting parts and controls

Mass
Approx. 1.3 kg (2 lb 13 oz) including power supply unit

Supplied accessories
Remote commander (1)

AM loop aerial (1)

Audio connecting cable (1)

Universal Dock Adapter for iPhone (1)

Universal Dock Adapter for iPhone 3GS & iPhone 3G (1)

Universal Dock Adapter for iPhone 4S & iPhone 4 (1)

Design and specifications are subject to change without notice.

Compatible iPod/iPhone models

Compatible iPod/iPhone models are as follows. Update your iPod/iPhone to use the latest software before you use it.

- iPod touch (4th generation)
- iPod touch (3rd generation)
- iPod touch (2nd generation)
- iPod touch (1st generation)
- iPod nano (6th generation)*
- iPod nano (5th generation)
- iPod nano (4th generation)
- iPod nano (3rd generation)
- iPod nano (2nd generation)
- iPod nano (1st generation)
- iPod with video
- iPod with color display
- iPod with click wheel
- iPod classic
- iPod mini
- iPhone 4S
- iPhone 4
- iPhone 3GS
- iPhone 3G
- iPhone

* The iPod nano (6th generation) cannot be controlled by the remote when the command of “MENU,” “▲,” “◆,” and “ENTER” is pressed.

Notes

- In these Operating Instructions, “iPod” is used as a general reference to functions of iPod on the iPod and iPhone, unless otherwise specified by the text or illustrations.
- The connector of the unit is for sole use for iPod. When you use devices that do not match with the connector, connect to the **AUDIO IN** terminal of this unit with the supplied audio connecting cable.
- Sony cannot accept responsibility in the event that data recorded to iPod is lost or damaged when using an iPod connected to this unit.

Connecting the aerial

To connect the AM loop aerial

The shape and the length of the aerial is designed to receive AM signals. Do not dismantle or roll up the aerial.

- 1 Remove only the loop part from the plastic stand.
- 2 Set up the AM loop aerial.

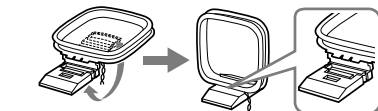

- 3 Connect the cords to the AM aerial terminals.

Cord (A) or cord (B) can be connected to either terminal.

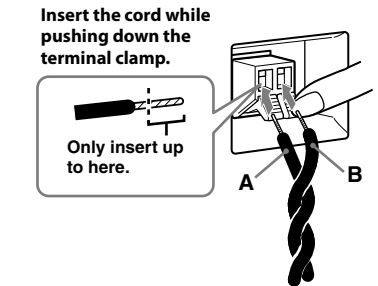

- 4 Make sure the AM loop aerial is connected firmly by pulling softly.

Adjusting the AM loop aerial

Find a place and an orientation that provide good reception.

- Do not place the AM loop aerial near the unit or other AV equipment, as noise may result.

Tip
Adjust the direction of the AM loop aerial for best AM broadcast sound.

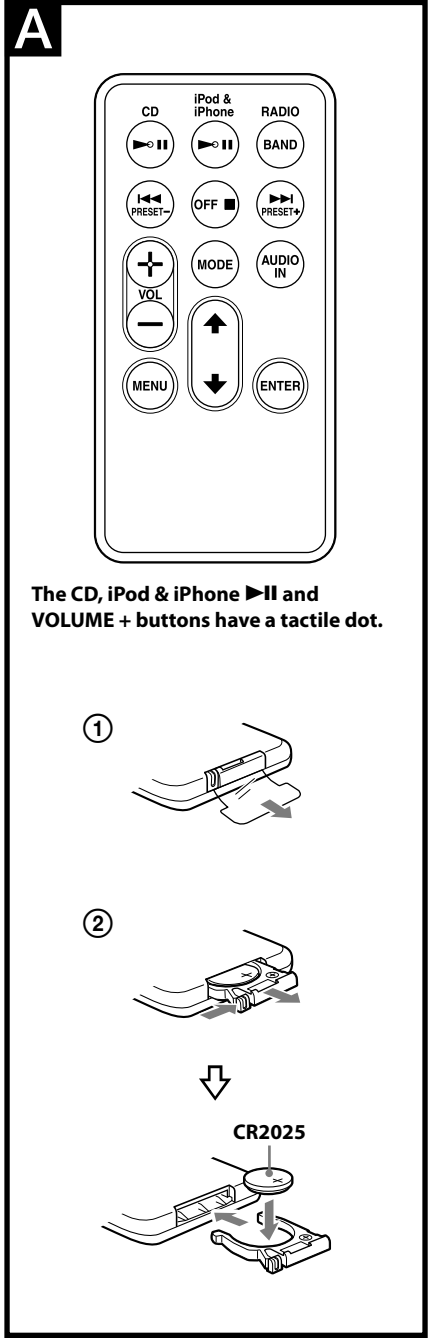

The CD, iPod & iPhone ►|| and VOLUME + buttons have a tactile dot.



- 3 Push the exhausted battery out from the bottom of the battery holder and insert a new battery with the + side facing up. (See Fig. B-3)

- 4 Insert the battery holder back into the unit and secure it with the screw. (See Fig. B-4)

- 5 Press **CD, iPod&iPhone, RADIO BAND, AUDIO IN** or **SNOOZE/DATE/SLEEP OFF** to turn “☺” off in the display.

If the time in the display is incorrect after the battery is changed (Reset)

Press the Reset button with a pointed device. The Reset button is in the small hole located in the battery compartment.

Note

When you replace the battery, do not disconnect the plug from the AC outlet. Otherwise, the calendar, current time, alarm and station presets will be erased.

Battery Warning

If the unit is to be left unplugged for a long time, remove the battery to avoid undue battery discharge and damage to the unit from battery leakage.

WARNING

There is a danger of explosion if the battery is incorrectly replaced. Replace only with the same or equivalent type recommended by the equipment manufacturer.

If the battery compartment lid comes off

The battery compartment lid is designed to come off when opened with excessive force. To put it back on, see the illustration.

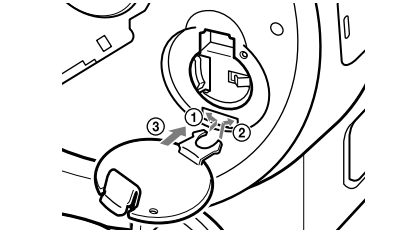

- 1 Insert the left hook of the lid into the left hole in the unit.
- 2 Insert the right hook into the right hole.
- 3 Confirm the lid is securely attached.

Preparing the remote commander

Before using the card remote commander for the first time, remove the insulation film. (See Fig. A-1)

When to replace the battery

With normal use, the battery (CR2025) should last for about six months. When the remote commander no longer operates the unit, replace the battery with a new one. (See Fig. A-2)

Notes

- Do not charge the battery.
- When you are not going to use the remote commander for a long time, remove the battery to avoid any damage caused by leakage and corrosion.

About the backup battery

To keep good time, this unit contains one CR2032 battery inside of the unit as a backup power source.

The battery keeps the clock operating in the event of a power interruption.

Note for customers in Europe

The clock is preset at the factory, and its memory is powered by the preinstalled Sony CR2032 battery. If the “0:00” appears in the display when the unit is connected to AC outlet for the first time, the battery may be weak. In this case, consult a Sony dealer. The preinstalled CR2032 battery is considered part of the product, and is covered by the warranty. You are required to show “Note for customers in Europe” (in this instruction) to a Sony dealer in order to validate the warranty for this product.

Knowing when to replace the battery

When the battery becomes weak, “☺” appears in the display.

If a power interruption occurs while the battery is weak, the current time and alarm will be erased. Replace the battery with a Sony CR2032 lithium battery. Use of another battery may cause a fire or explosion.

Note

If “0:00” flashes in the display when the unit is connected to AC outlet for the first time, the battery may be weak. In this case, consult your Sony dealer.

Replacing the battery

- 1 Open the CD compartment lid. (See Fig. B-1)
- 2 Keep the AC plug connected to the AC outlet and use a screwdriver to remove the screw that secures the battery holder at the bottom of the unit. (See Fig. B-2)

DREAM MACHINE

Dream Machine is a trademark of Sony Corporation.



No Power No Problem is a trademark of Sony Corporation.

©2008 Sony Corporation Printed in China

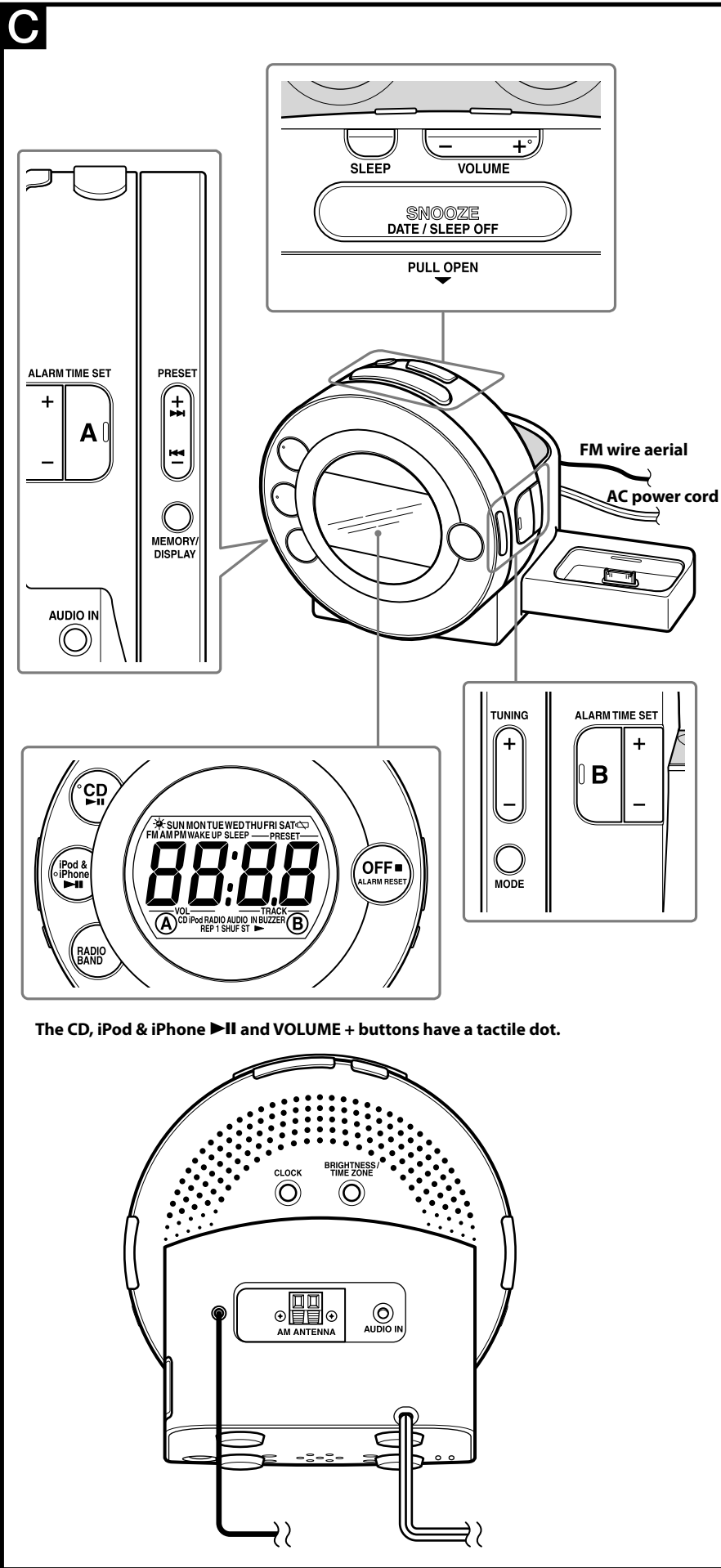

Setting the clock for the first time

This unit is preset to the current date and time at the factory, and is powered by the back up battery. All you need to do the first time is just plug it in and select your time zone.

- 1 Plug in the unit. The current CET (Central European Time) appears in the display.
- 2 Press and hold **BRIGHTNESS/TIME ZONE** for at least 2 seconds. Area number "1" flashes in the display.

Area number	Time zone
1 (default setting)	Central European Time/ Central European Summer Time
2	Eastern European Time/ Eastern European Summer Time
0	Western European Time/ Western European Summer Time

Press **BRIGHTNESS/TIME ZONE** to set.

Note

Though the clock is correctly set at the factory, discrepancies may arise during transport or storage. If necessary, set the clock to the correct time by referring to "Setting the clock manually".

When daylight saving time (summer time) begins

This model automatically adjusts for daylight saving time (summer time).

"*" is displayed from the beginning of daylight saving time (summer time) and disappears at the end of the daylight saving time (summer time) automatically.

The summer time adjustment is based on GMT (Greenwich Mean Time).

Area number 0:

- Daylight saving time (summer time) begins at: 1:00 AM on the final Sunday of March.
- Standard time begins at: 2:00 AM on the final Sunday of October.

Area number 1:

- Daylight saving time (summer time) begins at: 2:00 AM on the final Sunday of March.
- Standard time begins at: 3:00 AM on the final Sunday of October.

Area number 2:

- Daylight saving time (summer time) begins at: 3:00 AM on the final Sunday of March.
- Standard time begins at: 4:00 AM on the final Sunday of October.

To cancel Automatic DST/Summer Time adjustment during the daylight saving time (summer time) period

The Automatic DST/Summer Time adjustment can be cancelled. Press and hold **CLOCK** and **BRIGHTNESS/TIME ZONE** at the same time while the clock is displayed.

"Auto → OFF" appears in the display to show that Automatic DST/Summer Time adjustment has been cancelled. The display returns to the clock.

- The change timing of Automatic DST/Summer Time adjustment employed by the unit (see above) is subjected to variation by circumstances and the law in each country/region. In such a case, cancel the Automatic DST/Summer Time adjustment and set the DST display manually as necessary. Customers living in a country/region that does not use the daylight saving time (summer time) must cancel Automatic DST/Summer Time adjustment before using the unit.

- To activate Automatic DST/Summer Time adjustment again, press and hold **CLOCK** and **BRIGHTNESS/TIME ZONE** at the same time. "Auto → ON" appears in the display to show that Automatic DST/Summer Time adjustment has been activated. The display returns to the clock.

Setting the clock manually

- 1 Plug in the unit.
- 2 Press and hold **CLOCK** for at least 2 seconds. The year starts to flash in the display.
- 3 Press **ALARM TIME SET +** or **-** repeatedly to set the year.
- 4 Press **CLOCK**.
- 5 Repeat steps **3** and **4** to set the month, the day, hour, and minute, and then press **CLOCK**. And the seconds start incrementing from zero.

Notes

- If you do not press a button for about 1 minute while setting the clock, the clock setting will be cancelled.
- A calendar is installed in this unit. When the date is set, a day of the week is automatically displayed. SUN = Sunday, MON = Monday, TUE = Tuesday, WED = Wednesday, THU = Thursday, FRI = Friday, SAT = Saturday

To display the year and date

Press **SNOOZE/DATE/SLEEP OFF** once for the date, and within about 3 seconds press it again for the year. The display shows the date or year for about 3 seconds and then changes back to the current time.

Setting the brightness of the display

Three levels of brightness are available by pressing **BRIGHTNESS/TIME ZONE**.

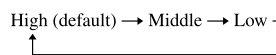

Playing a CD

An 8 cm (3-inch) CD can be played without an adaptor.

- 1 Open the CD compartment lid and insert a disc. After placing the disc, close the lid.

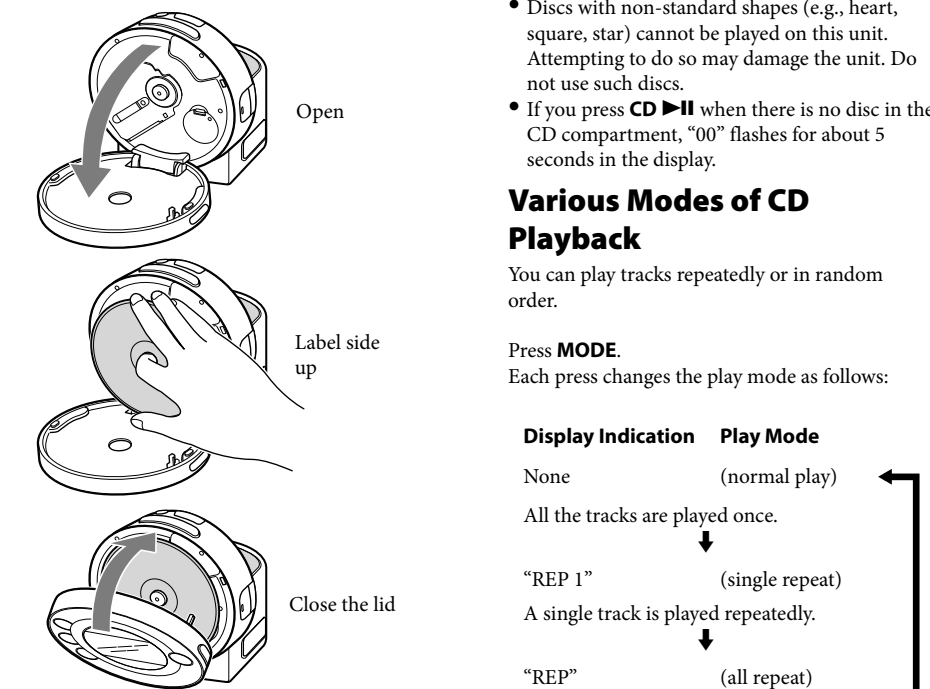

- 2 Press **CD ►II**. "CD ►" appears in the display to indicate the CD is playing.
- 3 Press **VOLUME +** or **-** repeatedly to adjust the volume.

To	Press
Pause	CD ►II
Resume play after pause	CD ►II again
Cue to the beginning of the current track (AMS*)	◀◀**
Cue to the next track (AMS*)	▶▶**
Go back at high speed	Hold down ◀◀
Go forward at high speed	Hold down ▶▶
Locate a previous track (AMS*)	◀◀ repeatedly**
Locate a succeeding track (AMS*)	▶▶ repeatedly**
Stop play	■

* AMS = Automatic Music Sensor

**These operations are possible during both play and pause.

About CD-Rs/CD-RWs

This unit is compatible with CD-Rs/CD-RWs but playback capability may vary depending on the quality of the disc, the recording device and application software.

Music discs encoded with copyright protection technologies

This product is designed to play back discs that conform to the Compact Disc (CD) standard. Recently, various music discs encoded with copyright protection technologies are marketed by some record companies. Please be aware that among those discs, there are some that do not conform to the CD standard and may not be playable by this product.

To handle compact discs

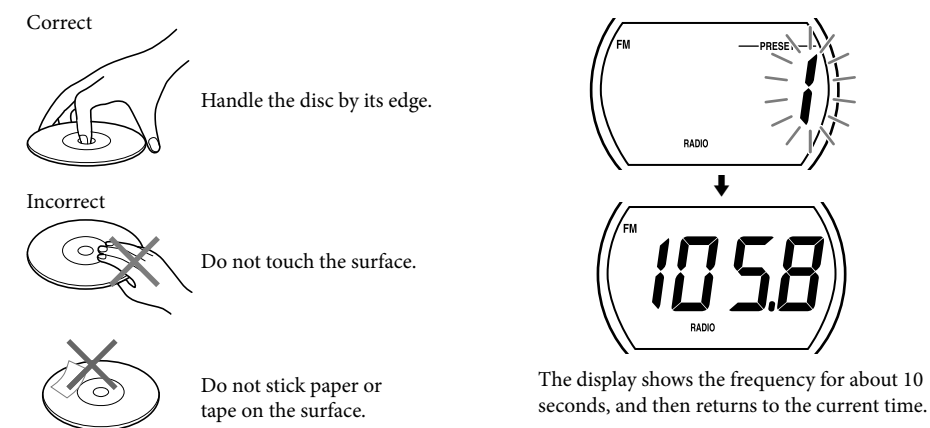

Note on DualDiscs

A DualDisc is a two sided disc product which mates DVD recorded material on one side with digital audio material on the other side. However, since the audio material side does not conform to the Compact Disc (CD) standard, playback on this product is not guaranteed.

Notes

- Discs with non-standard shapes (e.g., heart, square, star) cannot be played on this unit. Attempting to do so may damage the unit. Do not use such discs.
- If you press **CD ►II** when there is no disc in the CD compartment, "00" flashes for about 5 seconds in the display.

Various Modes of CD Playback

You can play tracks repeatedly or in random order.

Press **MODE**.

Each press changes the play mode as follows:

Display Indication	Play Mode
None	(normal play)
All the tracks are played once.	↓
"REP 1"	(single repeat)
A single track is played repeatedly.	↓
"REP"	(all repeat)
All the tracks are played repeatedly.	↓
"SHUF"	(shuffle play)
All the tracks are played once in random order.	↓
"REP SHUF"	(shuffle repeat)
All the tracks are played repeatedly in random order.	

Playing the radio

–Manual tuning

- 1 Press **RADIO BAND** to turn on the radio and select the AM or FM band.
- 2 Press **TUNING +** or **-** to tune in to a desired frequency.
- 3 Adjust the volume using **VOLUME +** or **-**.

The frequency display is raised or lowered by a step of 0.1 MHz. (Example: Frequency 88.05 MHz is displayed as "88.0 MHz".)

–Preset tuning

You can preset 20 stations for FM and 10 stations for AM.

Presetting a station

- 1 Follow steps 1 and 2 in "Manual tuning" to tune the frequency you wish to preset.
- 2 Hold down **MEMORY/DISPLAY** for at least 2 seconds.
- 3 Press **PRESET +** or **-** to select the preset number, then press **MEMORY/DISPLAY**. The frequency is stored with the selected preset number.

Example: The following display appears when you preset FM 105.8 MHz to preset number 1 for FM.

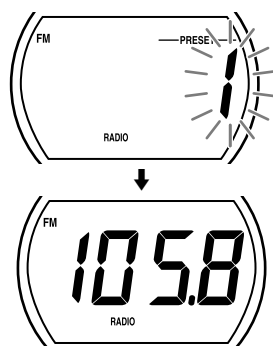

The display shows the frequency for about 10 seconds, and then returns to the current time.

To preset another station, repeat these steps.

Note

If you try to store another station with the same preset number, the previously stored station will be replaced.

–Auto preset tuning

- 1 Press **RADIO BAND** to turn on the radio and select the AM or FM band.
- 2 Press and hold **RADIO BAND** until "Auto" appears in the display.
- 3 Press **MEMORY/DISPLAY**. The unit automatically presets the available channels in order.

Tuning in to a station

- 1 Press **RADIO BAND** to turn on the radio and select the AM or FM band.
- 2 Press **PRESET +** or **-** to select the desired preset number.
- 3 Adjust the volume using **VOLUME +** or **-**.

Changing the AM tuning interval

The AM tuning interval differs depending on areas. Change the interval if necessary. Press and hold **RADIO BAND**, **ALARM A** and **BRIGHTNESS/TIME ZONE** together for more than 2 seconds.

The AM tuning interval will be changed. Note that when the interval is changed, the AM preset stations will be cleared.

Improving the reception

FM: Extend the FM wire aerial fully to increase reception sensitivity.

AM: Connect the supplied AM loop aerial to the unit. Rotate the aerial horizontally for optimum reception.

Tip

If the FM broadcast is noisy, press **MODE** to turn off "ST" in the display. The radio becomes clearer although the sound becomes monaural.

Notes on radio reception

- Keep digital music players or mobile phones away from the AM loop aerial or the FM aerial, as this may lead to interference of reception.
- When you are listening to the radio with an iPhone connected to the unit, interference with radio reception may occur.
- When you are listening to the radio while charging an iPod, interference with radio reception may occur.

Playing an iPod

You can enjoy audio from iPod by connecting to this unit. To use an iPod, refer to the user's guide of your iPod.

Notes

- When inserting an iPod into the unit, be sure to use the universal dock adapter supplied with your iPod or commercially available from Apple Inc.
- If you are using an iPhone 4S, iPhone 4, iPhone 3GS, iPhone 3G or iPhone, attach the supplied universal dock adapter for iPhone 4S, iPhone 4, iPhone 3GS, iPhone 3G or iPhone before connecting. The adapter number, (12), (15) or (19), is shown on the underside of the supplied universal dock adapters. (12) is for the iPhone, (15) is for the iPhone 3GS & iPhone 3G and (19) is for the iPhone 4S & iPhone 4. Check the adapter number before use.
- The connector of the unit is exclusively for use with iPod. When you use a device that does not match the connector, connect it to the **AUDIO IN** terminal of this unit with the supplied audio connecting cable.
- Sony cannot accept responsibility in the event that data recorded on an iPod is lost or damaged when using an iPod connected to this unit.
- For details of environmental conditions for operating your iPod, check the website of Apple Inc.

- 1 Push **OPEN** to slide out the Docking Tray.
- 2 Attach the correct universal dock adapter to the connector of the unit, and place the iPod/iPhone to the connector.
- 3 Press **iPod & iPhone ►II**. The iPod begins to play automatically. You can operate the connected iPod by this unit or the buttons on iPod.

- 4 Adjust the volume using **VOLUME +** or **-**.

To	Press
Turn off the iPod	OFF , or press and hold iPod & iPhone ►II
Pause playback	iPod & iPhone ►II To resume play, press it again.
Go to the next track	▶▶I
Go back to the previous track	◀◀I
Locate a point while listening to the sound	▶▶I (forward) or ◀◀I (backward) while playing and hold it until you find the point.
Locate a point while observing the display	▶▶I (forward) or ◀◀I (backward) in pause and hold it until you find the point.
Go back to the previous menu	MENU**
Select a menu item or a track for playback	♦/♦♦
Execute the selected menu or begin playback	ENTER**

* During playback, this operation goes back to the beginning of the current track. To go back to the previous track, press twice.

**These operations are available only when using the supplied remote commander.

Notes

- When placing or removing the iPod, hold the iPod at the same angle as that of the connector on this unit and do not twist or bend the iPod to prevent connector damage.
- Do not carry the unit with an iPod set on the connector. Doing so may cause a malfunction.
- When placing or removing the iPod, brace the unit with one hand and take care not to press the controls of the iPod by mistake.
- Before disconnecting the iPod, pause playback.

To use the unit as a battery charger

You can use the unit as a battery charger.

The charging begins when the iPod is placed on the connector.

The charging status appears in the display of iPod. For details, see the user's guide of your iPod.

On copyrights

iPhone, iPod, iPod classic, iPod nano, and iPod touch are trademarks of Apple Inc., registered in the U.S. and other countries. "Made for iPod," and "Made for iPhone" mean that an electronic accessory has been designed to connect specifically to iPod or iPhone, respectively, and has been certified by the developer to meet Apple performance standards. Apple is not responsible for the operation of this device or its compliance with safety and regulatory standards. Please note that the use of this accessory with iPod or iPhone may affect wireless performance.

Setting the alarm

This CD clock radio is equipped with 4 alarm modes—CD, iPod, radio and buzzer. Before setting the alarm, make sure to set the clock (see "Setting the clock for the first time").

To Set the alarm

- 1 Press and hold **ALARM TIME SET A** or **B** for at least 2 seconds. "WAKE UP" appears and the hour flashes in display.
- 2 Press **ALARM TIME SET +** or **-** repeatedly until the desired hour appears. To set the hour rapidly, hold down **ALARM TIME SET +** or **-**.
- 3 Press **ALARM TIME SET A** or **B**. The minute flashes.
- 4 Repeat step 2 to set the minute.
- 5 Press **ALARM TIME SET A** or **B**. The days of the week blink.

- 6 Repeat step 2 to set the days of the week. You can select the days from the following three options: Every day: SUN MON TUE WED THU FRI SAT Week day: MON TUE WED THU FRI Week end: SUN SAT
- 7 Press **ALARM TIME SET A** or **B**. The alarm mode setting is entered.
- 8 Press **ALARM TIME SET +** or **-** repeatedly until the desired alarm mode flashes. You can choose one mode among "CD", "iPod", "RADIO" and "BUZZER". Set the alarm mode as follows: – CD: see "[A] Setting the CD alarm". – iPod: see "[B] Setting the alarm for iPod". – RADIO: see "[C] Setting the radio alarm". – BUZZER: see "[D] Setting the buzzer alarm".

[A] Setting the CD alarm

For the CD alarm, the track you specified as the wake-up track is played first. (If the CD play mode is set to "SHUFFLE" or "SHUFFLE REP", all the tracks will be played in random order.)

- 1 Perform steps 1 to 8 in "To set the alarm".
- 2 Press **ALARM TIME SET A** or **B** to select "CD" alarm mode. "VOL" and "TRCK" appear in the display.
- 3 Press **ALARM TIME SET +** or **-** to adjust the volume.
- 4 Press **ALARM TIME SET A** or **B**. Track number flashes.
- 5 Press **ALARM TIME SET +** or **-** to select the desired track number.
- 6 Press **ALARM TIME SET A** or **B**. The setting is entered. When "A" or "B" does not appear in the display, press **ALARM TIME SET A** or **B** again. The CD will play at the set time.

Note

If the CD alarm does not operate because a disc error occurred, there is no disc, or the CD compartment lid is open, the buzzer alarm will operate instead.

[B] Setting the alarm for iPod

- 1 Perform steps 1 to 8 in "To set the alarm".
- 2 Press **ALARM TIME SET A** or **B** to select alarm mode for "iPod". "VOL" appears in the display.
- 3 Press **ALARM TIME SET +** or **-** to adjust the volume.
- 4 Press **ALARM TIME SET A** or **B**. The setting is entered. When "A" or "B" does not appear with "iPod" in the display, press **ALARM TIME SET A** or **B** again. The iPod will sound at the set time.

When using iPod touch/iPhone

- To use music stored in an iPod touch/iPhone to wake up, put the iPod touch/iPhone to the unit first, follow the steps above to set alarm time, and then select the music function.
- If you set the alarm for iPod while iPod touch/iPhone music is playing, and then turn the unit power off, when the alarm time comes on, the alarm music will start.
- Even if the alarm setting for iPod is complete, if you turn the power of iPod touch/iPhone off before inserting the iPod touch/iPhone into the unit, the alarm for iPod will not work.

[C] Setting the radio alarm

- 1 Perform steps 1 to 8 in "To set the alarm".
- 2 Press **ALARM TIME SET A** or **B** to select "RADIO" alarm mode. "VOL" and "PRESET" appears in the display.
- 3 Press **ALARM TIME SET +** or **-** to adjust the volume.
- 4 Press **ALARM TIME SET A** or **B**. Band ("FM" or "AM") flashes.
- 5 Press **ALARM TIME SET +** or **-** to select the desired band. "–" is the last station received.
- 6 Press **ALARM TIME SET A** or **B**. Preset number flashes.

- 7 Press **ALARM TIME SET +** or **-** to select the desired preset number. The setting is entered. When "A" or "B" does not appear with "RADIO" in the display, press **ALARM TIME SET A** or **B** again. The radio will turn on at the set time.

[D] Setting the Buzzer Alarm

- 1 Perform steps 1 to 8 in "To set the alarm".
- 2 Press **ALARM TIME SET A** or **B** to select "BUZZER" alarm mode. The setting is entered. When "A" or "B" does not appear in the display, press **ALARM TIME SET A** or **B** again. The buzzer will sound at the set time.

Note

The volume cannot be set for the buzzer alarm.

To confirm an alarm setting

Press **ALARM/TIME SET +** or **-**. The setting will be displayed for 4 seconds.

To change an alarm setting

Press and hold **ALARM/TIME SET +** more than 2 seconds to move the alarm time forwards. Press and hold **ALARM/TIME SET -** more than 2 seconds to move the alarm time backwards. When you release the button, the changed time will be displayed for 2 seconds. To change the alarm time again, press **ALARM/TIME SET +** or **-** within these 2 seconds, otherwise the setting change will be fixed as displayed.

To doze for a few more minutes

Press **SNOOZE/DATE/SLEEP OFF**. The sound turns off but will automatically come on again after about 10 minutes. You can change the snooze time by pressing **SNOOZE/DATE/SLEEP OFF** repeatedly within 3 seconds. The maximum length of the snooze time is 60 minutes.

To stop the alarm

The alarm will sound again at the same time the next day. Press **OFF/ALARM RESET** to turn off the alarm.

To deactivate the alarm

Press **ALARM/TIME SET A** or **B** to turn off the **ALARM A** or **B** indicator from the display.

Notes on alarm in the event of a power interruption

- When the alarm sound is set to RADIO, CD, or iPod, it will change to "BUZZER" automatically.
- If the backup battery is exhausted, the alarm will not work in the event of power interruption. Replace the battery periodically.

Setting the sleep timer

You can fall asleep to the sound using the built-in sleep timer that turns off the unit automatically after a preset duration.

- 1 Press **SLEEP** while the unit is turned on. SLEEP appears in the display.
- 2 Press **SLEEP** to set the sleep timer duration. Each time you press **SLEEP**, the duration of minutes changes as follows: 90 → 60 → 30 → 15
← OFF ←

The display returns to clock mode four seconds after you have finished setting the duration setting and released **SLEEP**, and then the sleep timer starts. The unit will play for the duration you set, and then shut off.

To turn off the unit before the preset time

Press **SNOOZE/DATE/SLEEP OFF** or **OFF/ALARM RESET**.

To change the sleep timer setting

You can press **SLEEP** repeatedly to select the desired sleep timer setting even after the sleep timer has been activated.

To deactivate the sleep timer

Press **SLEEP** repeatedly to set the sleep timer to "OFF" in step 2.

Connecting external equipment

To listen to sound

- 1 Connect the **AUDIO IN** jack of the unit to the line out jack or headphone jack of the external equipment using the audio connecting cable (supplied).

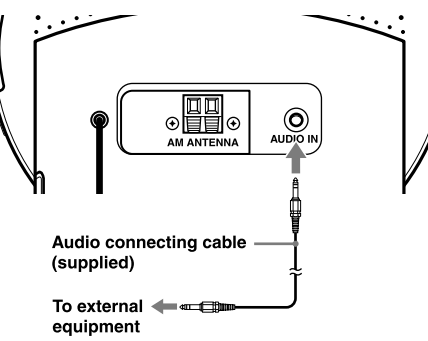

- 2 Press **AUDIO IN** to display "AUDIO IN".
- 3 Play the equipment connected to the **AUDIO IN** jack.
- 4 Adjust the volume using **VOLUME +** or **-**.

To return to the radio

Press **RADIO BAND**. The frequency is shown in the display.

To return to the CD

Press **CD ►II**.

To return to the iPod

Press **iPod & iPhone ►II**.

To