

# Built-in Battery USB AC Charger

Operating Instructions

使用説明書

تعليمات التشغيل

## AC-UP100



\* 4 2 7 7 9 5 6 4 1 \* (1)

© 2011 Sony Corporation Printed in China

http://www.sony.net/

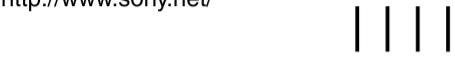

### A

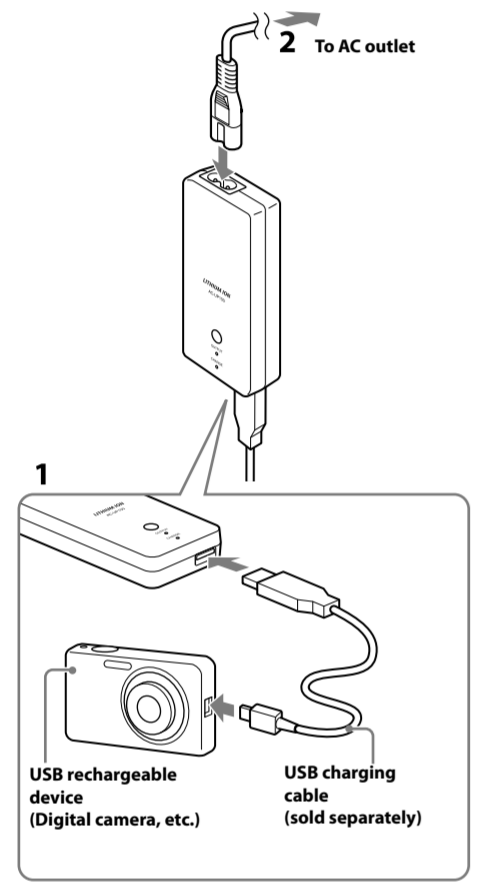

### B

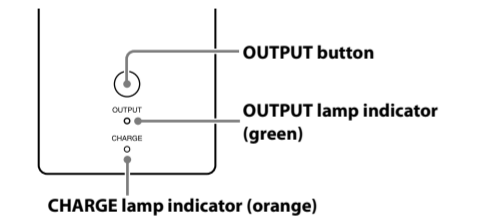

## English

Before operating the unit, please read this manual thoroughly and retain it for future reference.

## WARNING



**Disposal of Old Electrical & Electronic Equipment (Applicable in the European Union and other European countries with separate collection systems)**

This symbol on the product or on its packaging indicates that this product shall not be treated as household waste. Instead it shall be handed over to the applicable collection point for the recycling of electrical and electronic equipment. By ensuring this product is disposed of correctly, you will help prevent potential negative consequences for the environment and human health, which could otherwise be caused by inappropriate waste handling of this product. The recycling of materials will help to conserve natural resources. For more detailed information about recycling of this product, please contact your local Civic Office, your household waste disposal service or the shop where you purchased the product.



**Disposal of waste batteries (applicable in the European Union and other European countries with separate collection systems)**

This symbol on the battery or on the packaging indicates that the battery provided with this product shall not be treated as household waste. On certain batteries this symbol might be used in combination with a chemical symbol. The chemical symbols for mercury (Hg) or lead (Pb) are added if the battery contains more than 0.0005% mercury or 0.004% lead. By ensuring these batteries are disposed of correctly, you will help prevent potentially negative consequences for the environment and human health which could otherwise be caused by inappropriate waste handling of the battery. The recycling of the materials will help to conserve natural resources.

In case of products that for safety, performance or data integrity reasons require a permanent connection with an incorporated battery, this battery should be replaced by qualified service staff only.

To ensure that the battery will be treated properly, hand over the product at end-of-life to the applicable collection point for the recycling of electrical and electronic equipment. For all other batteries, please view the section on how to remove the battery from the product safely. Hand the battery over to the applicable collection point for the recycling of waste batteries.

For more detailed information about recycling of this product or battery, please contact your local Civic Office, your household waste disposal service or the shop where you purchased the product.

**Notice for customers: the following information is only applicable to equipment sold in countries applying EU directives**

The manufacturer of this product is Sony Corporation, 1-7-1 Konan Minato-ku Tokyo, 108-0075 Japan. The Authorized Representative for EMC and product safety is Sony Deutschland GmbH, Hedelfinger Strasse 61, 70327 Stuttgart, Germany. For any service or guarantee matters please refer to the addresses given in separate service or guarantee documents.

## Precautions

### On safety

The nameplate indicating operating voltage, power consumption, etc., is located on the rear exterior. As the main plug of AC adaptor is used to disconnect the AC adaptor from the mains, connect it to an easily accessible AC outlet. Should you notice an abnormality in it, disconnect it from the AC outlet immediately.

- Before operating the unit, be sure that the operating voltage of the unit is identical with that of your local power supply.
- The unit is not disconnected from the AC power source (mains) as long as it is connected to the wall outlet, even if the unit itself has been turned off.
- Unplug the AC power cord from the wall outlet if unit is not to be used for an extended period of time. To disconnect the AC power cord, grasp the plug. Never pull the cord itself.
- Should any liquid or solid object fall into the unit, unplug the unit and have the unit checked by qualified personnel before operating it any further.
- To avoid electrical shock, do not open the unit. Refer servicing to qualified personnel only.

### Installation

Do not install the AC adaptor in a confined space, such as a bookcase or built-in cabinet.

Do not place the AC adaptor in a location where it is:

- Subject to extreme high temperature. (E.g., in a car with its windows closed.)
- Subject to direct sunlight or near a heat source.
- Subject to mechanical vibration or shock.
- Subject to a magnetic field. (E.g., near a magnet, speaker, or TV.)
- Subject to excessive dust.

### Operation

- Make sure the current and voltage of the unit matches that of the outlet.
- For safety, if the input current is too high, the unit will automatically shut down.
- Do not connect this unit to a radio or equipment with a radio tuner as it may cause noise.
- To prevent damage, be careful not to drop or otherwise cause a mechanical shock to the unit.
- After using, disconnect the unit from the wall outlet and the equipment.
- Disconnect the unit from the AC outlet by pulling on the unit. Do not pull on the USB cable (sold separately).
- To avoid short-circuiting, do not allow the terminal of the unit to touch any foreign metal object.
- Use in ambient temperature between 0 °C - 40 °C.

### Cleaning

- Clean the unit with a soft, dry cloth. If the unit is very dirty, wipe it off with a soft cloth lightly moistened with a mild detergent solution, and then wipe with a soft dry cloth.
- Do not use any type of solvent such as alcohol, thinner, or benzine as it may damage the finish of the unit.
- If you use any chemical cleaner, observe the instructions provided with the product.
- If the exterior of the unit is splashed with any type of solvent such as insecticide, or remains in contact for a long time with rubber or vinyl, the finish of the exterior may be damaged.

## Features

- This unit can recharge USB rechargeable “Cyber-shot” digital cameras, “Handycam” camcorders and “Bloggie” touch cameras. To recharge a portable device, prepare a cable for connection of the device.
- This unit includes a built-in battery, which allows you to recharge a portable device while on the go without an AC outlet.
- This unit includes a large capacity (2,000 mAh) rechargeable lithium-ion battery.
- This unit can be connected to an AC outlet to be used as a USB AC charger.

\*“Cyber-shot”, “Handycam” and “Bloggie” are registered trademarks or trademarks of Sony Corporation.

## How to Use

### To recharge this unit and a portable device

You can plug this unit into an AC outlet to recharge this unit and a portable device (see fig. **A**).

- 1 Connect a portable device to this unit.**
- 2 Connect the AC power cord to the unit, and plug into an AC outlet.** The CHARGE lamp indicator lights orange and recharging of this unit starts (see fig. **B**). After the built-in battery of this unit is fully charged, the CHARGE lamp indicator (orange) goes out and the OUTPUT lamp indicator (green) lights up, and recharging of the portable device will automatically start.
- 3 After recharging of the portable device is completed, unplug this unit and disconnect the portable device from this unit.**

### Hints

- It takes about 3.5 hours to recharge the built-in battery of this unit from flat to full.
- Check the battery status of the portable device by its own battery status indicator.
- If the CHARGE lamp indicator flashes (slowly or rapidly), see “Troubleshooting.”

### To supply power to a portable device while on the go

You can charge the built-in battery of this unit in advance to supply power to a portable device while on the go.

- 1 Recharge this unit before you go out.**
- 2 Connect a portable device to this unit.**
- 3 Press the OUTPUT button (see fig. **B**).** The OUTPUT lamp indicator lights green and this unit begins supplying power to the portable device.

### Hints

- If the built-in battery of this unit becomes low, the OUTPUT lamp indicator flashes (about once a second).
- When this unit is not plugged into an AC outlet, it does not stop supplying power even after the portable device is fully charged. After you are finished supplying power, press the OUTPUT button, ensure that the OUTPUT lamp indicator goes out, and then disconnect the portable device from this unit.

### To begin to recharge a portable device immediately

If there is no need to recharge the built-in battery, you can recharge a portable device.

- 1 Connect a portable device to this unit, and then plug this unit into an AC outlet.** The CHARGE lamp indicator lights orange.
- 2 Press the OUTPUT button (see fig. **B**).** The OUTPUT lamp indicator lights green and this unit begins to supply power to the portable device.

## Useful feature

### To recharge a portable device for about 3 hours, and then recharge this unit

You can supply power to a portable device for about 3 hours and then begin to recharge this unit automatically.

- 1 Connect a portable device to this unit, and then plug this unit into an AC outlet.** The CHARGE lamp indicator lights orange.
- 2 Press the OUTPUT button.** The OUTPUT lamp indicator lights green.
- 3 Press and hold the OUTPUT button for about 2 seconds.** The OUTPUT lamp indicator flashes slowly. After about 3 hours, this unit will automatically stop supplying power to the portable device and begin to recharge this unit itself. The CHARGE lamp indicator will light orange.\*

\* After recharging of the built-in battery is completed, this unit will automatically restart to supply power to the portable device.

### Notes

- The USB connector of this product is output only. Do not connect to the USB ports of computers, etc. Doing so may cause a malfunction.
- The time that the Built-in Battery USB AC Charger can supply power to a portable device varies depending on its remaining power, as well the storage conditions and the portable device.
- Some USB rechargeable devices cannot be used with this device. Also, some devices may not be operable during recharge. Make sure that your portable device’s charging specification meets the power rating of 5 V / 500 mA.
- When you use a portable device with this product, attach the battery pack of the portable device. Not doing so may cause loss of data or damage by abnormal power shutdown.
- It is cautioned that some portable devices incur sudden loss of input memory with or without a battery charger (for details, refer to the user manual supplied with the portable device). Before using this product, be sure to back up the input memory. Sony is not liable for loss of input memory.

## Using your AC charger abroad

You can use your AC charger in any country or area that uses 100 V to 240 V AC, 50/60 Hz, by connecting a plug adaptor. If the country you visit employs a different shaped socket, use the correct plug adaptor.

Please consult your nearest travel bureau for the type of the plug adaptor needed in your travels.

## Charging time

Built-in battery	Charging time
3.6 V	
Nominal capacity 2,065 mAh	Approx. 3.5 hours
Rated capacity 1,970 mAh	

## Supply Time

Rated output	Supply Time
5 V/500 mA	Approx. 110 minutes

Supply time varies depending on the remaining power, storage condition and portable device.

## Specifications

Input voltage	100 V – 240 V, 50 Hz/60 Hz
Rated output voltage	DC 5.0 V
Rated output current	500 mA
Operating temperature	0 °C to 40 °C
Built-in battery nominal (rated) capacity	2,065 mAh (1,970 mAh)
Built-in battery charging time	Approx. 3.5 hours
Battery duration	Approx. 110 minutes (output DC 5 V / 500 mA)
Dimensions	Approx. 50 mm × 111 mm × 22 mm (Approx. 2 in × 4 3/8 in × 7/8 in) (w/h/d) (Projecting parts not included)
Mass	Approx. 125 g (4.4 oz)
Included items	AC Adaptor (AC-UP100) (1) AC Power cord (mains lead) (1) Set of printed documentation

Design and specifications are subject to change without notice.

## Troubleshooting

### The CHARGE Lamp indicator does not turn on.

**There is a bad connection with the plug.**

→Clean the plug with a dry cloth.

→Connect it to another AC outlet.

### Both the CHARGE lamp indicator and OUTPUT lamp indicator flash slowly.

**You are using this unit at an extremely high or low temperature.**

→Use this unit at a temperature between 0 °C and 40 °C (10 °C to 30 °C recommended).

### The OUTPUT lamp indicator flashes when supplying power.

**The built-in battery of this unit is low.**

→Charge this unit.

### This unit cannot supply power to the portable device or the OUTPUT Lamp indicator does not turn on.

**The USB charging cable is not properly connected to this unit.**

→Connect the USB charging cable properly.

**Remaining battery is low.**

→Charge this unit.

**The portable device is not in charging mode.**

→Check that the portable device is in the charging mode.

→Depending on the specification of your portable device, certain operations may be required to recharge it. For details about recharging operations, refer to the operating instructions supplied with the device.

### The supply time to the portable device is short.

**A terminal on the portable device or the USB connector on this unit is dirty.**

→Clean it with a dry cloth.

**This unit has reached the end of its service life or is defective.**

→When the supply time is extremely short, even when this unit is fully charged (its service life varies depending on use), purchase a new product.

→If it is defective, contact your Sony dealer or authorized Sony service facility.

**Remaining battery is low.**

→Charge this unit.

### You cannot connect the USB charging cable.

**You may have connected a different type cable.**

→Use the correct USB charging cable.

**The USB charging cable is not connected properly.**

→Connect the USB charging cable properly.

**Some dust, etc., may be in the USB connector.**

→Remove them.

### The CHARGE lamp indicator flashes rapidly.

→In the following situations, the CHARGE lamp indicator may flash rapidly\* the first time charging is performed.

If this occurs, unplug this unit from the AC outlet to stop recharging, and then plug it again to restart recharging.

\* 3 times in a second (approx.)

- This unit has not been used for a long time.

- A portable device has been left connected to this unit for a long time.

- This unit has just been purchased.

If the CHARGE lamp indicator continues to flash rapidly after unplugging and plugging, there may be a malfunction in this unit. Stop use and contact your Sony dealer or authorized Sony service facility.

Contact your Sony dealer or authorized Sony service facility for any further questions.

