

FM/AM Clock Radio

Operating Instructions
Manual de instrucciones (En el reverso)



©2014 Sony Corporation Printed in China

http://www.sony.net/

[CF-C1P]

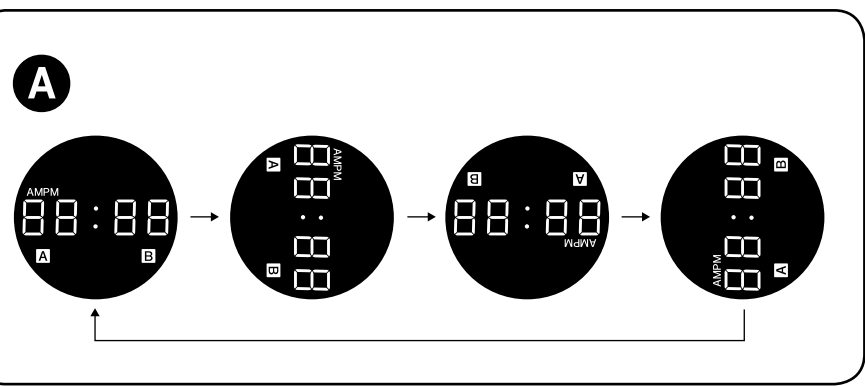
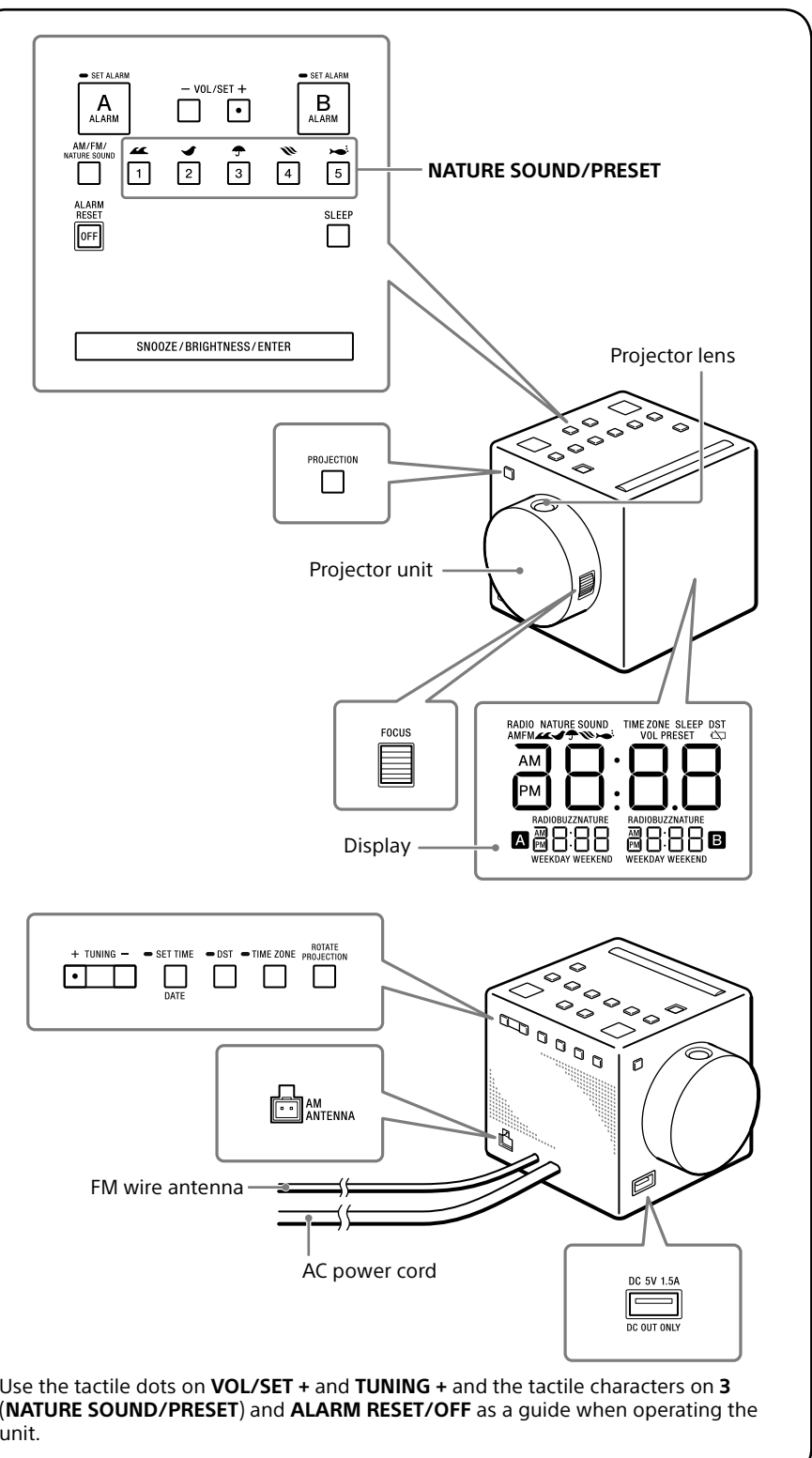

English

Before operating the unit, please read this guide thoroughly and retain it for future reference.

For customers in Europe
Register now for free updates at:
www.sony-europe.com/myproducts

WARNING
Do not ingest the battery, Chemical Burn Hazard.

This product contains a coin/button cell battery. If the coin/button cell battery is swallowed, it can cause severe internal burns in just 2 hours and can lead to death.

Keep new and used batteries away from children.
If the battery compartment does not close securely, stop using the product and keep it away from children.

If you think batteries might have been swallowed or placed inside any part of the body, seek immediate medical attention.

Hereby, Sony Corporation declares that this equipment is in compliance with Directive 2014/53/EU.
The full text of the EU declaration of conformity is available at the following internet address:
<http://www.compliance.sony.de/>

Do not expose batteries or apparatus with battery-installed to excessive heat such as sunshine, fire or the like.

The nameplate and important information concerning safety are located on the bottom exterior.

CAUTION
Danger of explosion if battery is incorrectly replaced. Replace only with the same type.

This symbol is intended to alert the user to the presence of important operating and maintenance (servicing) instructions in the literature accompanying the appliance.

Notice for customers: the following information is only applicable to equipment sold in countries applying EU directives.
This product has been manufactured by or on behalf of Sony Corporation, 1-7-1 Konan Minato-ku Tokyo, 108-0075 Japan. Inquiries related to product compliance based on European Union legislation shall be addressed to the authorized representative, Sony Belgium, bijkantoor van Sony Europe Limited, Da Vincilaan 7-D1, 1935 Zaventem, Belgium. For any service or guarantee matters, please refer to the addresses provided in the separate service or guarantee documents.

CE
The validity of the CE marking is restricted to only those countries where it is legally enforced, mainly in the countries EEA (European Economic Area).

NOTES ON LITHIUM BATTERY
Dispose of used battery promptly. Keep the lithium battery out of the reach of children. Should the battery be swallowed, immediately consult a doctor.

Wipe the battery with a dry cloth to assure a good contact.
Be sure to observe the correct polarity when installing the battery.
Do not hold the battery with metallic tweezers, otherwise a short-circuit may occur.
Do not expose the battery to excessive heat such as direct sunlight, fire or the like.

If you have any questions or problems concerning your unit, please consult your nearest Sony dealer.

Getting Started

Connecting the AM loop antenna

The shape and the length of the antenna is designed to receive AM signals. Do not dismantle or roll up the antenna.

- 1 Raise the plastic stand and fit the antenna into the slot of the stand.

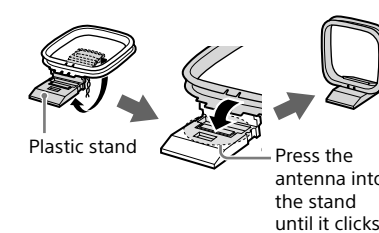

- 2 Insert the AM antenna connector into the AM ANTENNA jack on the unit.

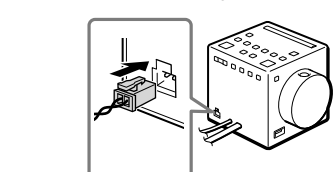

To remove the AM loop antenna

Push and hold down the tab of the antenna terminal clamp, and remove the AM loop antenna.

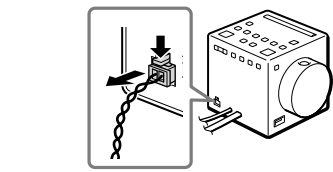

Connecting to an AC power source

Connect the AC power cord to a wall outlet.

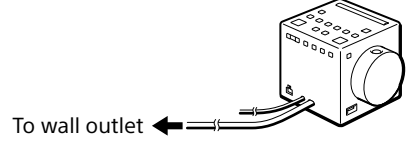

To wall outlet

"day and month" (about 2 seconds) → "year" (about 2 seconds) → "current CET (Central European Time) or current WET (Western European Time)" appears on the display in turn. (This unit is preset to the current CET (except for UK model) or the current WET (for UK model) at the factory, and is powered by the back-up battery.)

Setting the clock

All you need to do to set the clock for the first time is select your time zone.

Except for UK model
The unit is set to the current CET (Central European Time) as a default. If you live in the Central European Time zone, you do not need to perform this operation. If you want to change the Automatic DST/summer time adjustment settings, refer to "About Automatic DST/summer time adjustment."

For UK model
The unit is set to the current WET (Western European Time) as a default. If you live in the Western European Time zone, you do not need to perform this operation. If you want to change the Automatic DST/summer time adjustment settings, refer to "About Automatic DST/summer time adjustment."

- 1 Press and hold **TIME ZONE** for more than 2 seconds. Area number "1:00" or "0:00" appears on the display.
- 2 Press **VOL/SET** + or - repeatedly to select a number as follows:

Area number	Time zone	Automatic DST/summer time adjustment
"0:00"	Western European Time (GMT+0:00)	
"1:00"	Central European Time (GMT+1:00)	Initial setting: On
"2:00"	Eastern European Time (GMT+2:00)	

Area number	Time zone	Automatic DST/summer time adjustment
"0:00"	Western European Time (GMT+0:00)	
"1:00"	Central European Time (GMT+1:00)	Initial setting: On
"2:00"	Eastern European Time (GMT+2:00)	
"4:00"	Gulf Standard Time (GMT+4:00)	Initial setting: Off
"8:00"	Hong Kong Time (GMT+8:00)	

- 3 Press **SNOOZE/BRIGHTNESS/ENTER** to set.
- If you live in a country/region other than these time zones**
Refer to "Setting the clock manually" to set the correct time.

Note
• During shipment and your first use, a clock error may occur. In this case, refer to "Setting the clock manually" to set the correct time.

About Automatic DST/summer time adjustment

This unit is equipped with a DST/summer time adjustment function. When this function is turned on, the unit automatically adjusts for daylight saving time (summer time). "DST" automatically appears on the display at the beginning of daylight saving time (summer time), and disappears at the end of daylight saving time (summer time). The Automatic DST/summer time adjustment is based on GMT (Greenwich Mean Time).

- Area number "0:00":**
- Daylight saving time (summer time) begins at 1:00 AM on the final Sunday of March.
 - Standard time begins at 2:00 AM on the final Sunday of October.
- Area number "1:00":**
- Daylight saving time (summer time) begins at 2:00 AM on the final Sunday of March.
 - Standard time begins at 3:00 AM on the final Sunday of October.
- Area number "2:00":**
- Daylight saving time (summer time) begins at 3:00 AM on the final Sunday of March.
 - Standard time begins at 4:00 AM on the final Sunday of October.
- Area number "4:00" (for UK model):**
- Daylight saving time (summer time) begins at 2:00 AM on the final Sunday of March.
 - Standard time begins at 3:00 AM on the final Sunday of October.
- Area number "8:00" (for UK model):**
- Daylight saving time (summer time) begins at 2:00 AM on the final Sunday of March.
 - Standard time begins at 3:00 AM on the final Sunday of October.

Note
• The implementation of DST/summer time and its beginning/ending date and time are subject to circumstances and laws in each country/region. Should this interfere with the desired adjustment, cancel the Automatic DST/summer time adjustment and set the clock manually as necessary. Customers living in a country/region that does not use daylight saving time (summer time) should cancel the Automatic DST/summer time adjustment before using the unit.

Switching the Automatic DST/summer time adjustment function on or off
You can turn the Automatic DST/summer time adjustment function on or off.
Press and hold **DST** for more than 2 seconds.
The display will show "Aut → On" (Automatic DST/summer time adjustment is turned on) or "Aut → Off" (Automatic DST/summer time adjustment is turned off).

Operations

Setting the clock manually

To change the clock setting manually, operate the unit as follows.

- 1 Press and hold **SET TIME/DATE** for more than 2 seconds. The year will start to flash on the display.
- 2 Press **VOL/SET** + or - repeatedly to select the year, and then press **SNOOZE/BRIGHTNESS/ENTER**.
- 3 Repeat step 2 to set the month, day and time. After setting the time, a beep will sound.

Notes
• If you do not press any button for about 1 minute while setting the clock, clock setting mode will be cancelled.
• A 100-year calendar (2013 - 2112) is installed in the system.

To change the time format

You can choose between the 24-hour system (default) or the 12-hour system to display the time.

Press and hold **ALARM RESET/OFF** and **SNOOZE/BRIGHTNESS/ENTER** for about 3 seconds.

The time format toggles between the 24-hour system ("0:00" = midnight) and the 12-hour system ("AM 12:00" = midnight).

To display the date and year

Press **SET TIME/DATE** once to display the day and month, and press again to display the year. To return to the current time display, press **SET TIME/DATE** once again; or after a few seconds the clock display will return automatically.

When daylight saving time (summer time) begins/ends while Automatic DST/summer time adjustment is set to off

Change the clock setting manually if you have canceled the Automatic DST/summer time adjustment.

Using the projector

The projector function allows you to display the clock and the currently used alarm icons on a nearby wall or ceiling at a range of 0.5 m - 4 m.

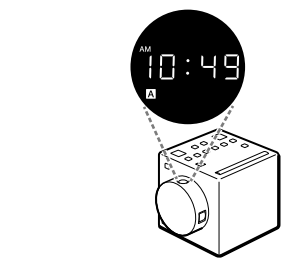

- 1 Rotate the projector unit to point the projector lens in the desired direction.
- 2 Press **PROJECTION**.
- 3 Turn **FOCUS** to adjust the focus. To turn off the projector, press **PROJECTION** again.

To rotate the projection view

Press **ROTATE PROJECTION** repeatedly. Each time you press **ROTATE PROJECTION**, the projector view rotates as Fig. ⑥.

- Notes**
- Do not stare into the lens directly.
 - The projector function cannot be used unless the clock has been set.
 - Certain walls and ceilings may not display the projection properly.
 - The projector unit can be rotated 90° forward or backward from the upward position, and clicks when returned to the upward position.
 - If the projector unit is rotated beyond its limits, it may be damaged.
 - The projector will automatically turn off after 16 hours.

Listening to the radio

- 1 Press **AM/FM/NATURE SOUND** repeatedly to select the desired band (AM or FM).
 - 2 Press **TUNING** + or - to tune to the desired station. If you press and hold **TUNING** + or -, scanning starts. Scanning pauses when a station is found, and restarts after a few seconds. To stop scanning, press **TUNING** + or - (or **SNOOZE/BRIGHTNESS/ENTER**).
 - 3 Press **VOL/SET** + or - to adjust the volume. To turn off the radio, press **ALARM RESET/OFF**.
- Note**
• The FM frequency display is accurate to within 0.1 MHz. For example, frequencies 88.00 MHz and 88.05 MHz will both be displayed as "88.0 MHz."

To preset radio stations

- You can preset 5 stations for FM and 5 stations for AM.
- 1 Tune to the station you wish to preset.
 - 2 Press and hold the desired **NATURE SOUND/PRESET** (1 to 5) until you hear a beep.



Example: The following display appears when you preset FM 105.7 MHz to preset number 3 for FM.

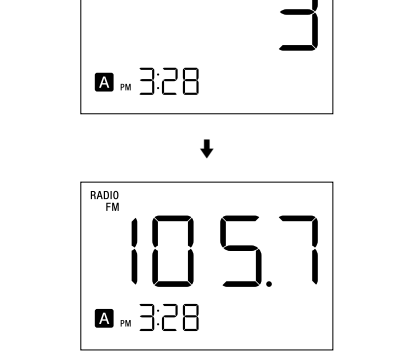

The display shows the frequency for a few seconds and then changes back to the current time.
To change the preset station, tune to the desired station and press and hold the **NATURE SOUND/PRESET** (1 to 5) until you hear a beep.

- Note**
• If you try to store another station with the same preset number, the previously stored station will be replaced.

To tune to a preset station

- 1 Press **AM/FM/NATURE SOUND** repeatedly to select the desired band (AM or FM).
- 2 Press **NATURE SOUND/PRESET** (1 to 5) where the desired station is stored.
- 3 Press **VOL/SET** + or - to adjust the volume.

Note
• If no station has been preset yet, "Non" appears on the display. Then the unit returns to the same state as in step 1.

Selecting a Nature Sound

This unit includes 5 types of Nature Sounds: Sea Waves, Birds, Rain, Brook, and Under the Sea.

- 1 Press **AM/FM/NATURE SOUND** repeatedly to select the Nature Sound.
- 2 Press the desired **NATURE SOUND/PRESET** (1 to 5).

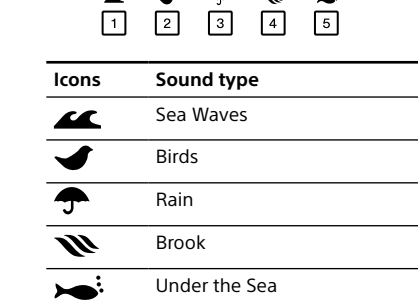

To turn off the Nature Sound, press **ALARM RESET/OFF**.

Note
• When other functions are in use, Nature Sounds are not available.

Setting the alarm

The dual alarm function allows you to set two alarm programs (ALARM A and ALARM B). The alarm time can be set for each program and the alarm sound can be selected from "RADIO" (radio), "BUZZ" (buzzer), or "NATURE" (Nature Sound).

- Before setting the alarm**
- Make sure to set the clock. (See "Setting the clock manually.")
 - To set the radio alarm, first preset your favorite station. (See "To preset radio stations.")

- 1 Press and hold **SET ALARM/ALARM A** (or **B**) for more than 2 seconds. While setting the alarm, "A" (or "B") flashes on the display.
- 2 Press **VOL/SET** + or - to select the desired hour, and press **SNOOZE/BRIGHTNESS/ENTER**.

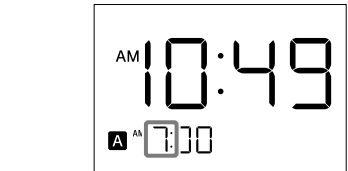

- 3 Press **VOL/SET** + or - to select the desired minute, and press **SNOOZE/BRIGHTNESS/ENTER**.
- 4 Press **VOL/SET** + or - to select the desired alarm period ("WEEKDAY," "WEEKEND," or every day*), and press **SNOOZE/BRIGHTNESS/ENTER**.

* In the case of every day, both "WEEKDAY" and "WEEKEND" are displayed.

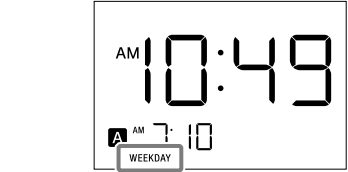

- 5 Press **VOL/SET** + or - to select the desired alarm mode ("RADIO," "BUZZ," or "NATURE"), and press **SNOOZE/BRIGHTNESS/ENTER**.

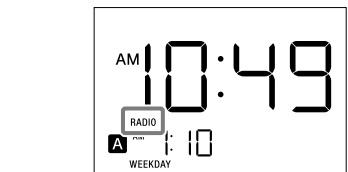

When selecting "RADIO"
Proceed to "A" Setting the radio alarm."

When selecting "BUZZ"
The setting is complete. The buzzer will sound at the set time, gradually increasing in volume. ("A" (or "B") flashes on the display.)

When selecting "NATURE"
Proceed to "B" Setting the Nature Sound alarm."

- 6 Press **VOL/SET** + or - to select the AM band or FM band, and press **SNOOZE/BRIGHTNESS/ENTER**.



- 7 Press **VOL/SET** + or - (or **NATURE SOUND/PRESET** (1 to 5)) to select the preset number of desired station, and press **SNOOZE/BRIGHTNESS/ENTER**.

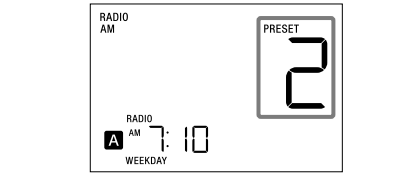

If no station has been preset yet
The preset number and "Non" appear on the display alternately. In this case, the buzzer will sound at the set time.

- 8 Press **VOL/SET** + or - to adjust the volume, and press **SNOOZE/BRIGHTNESS/ENTER**.

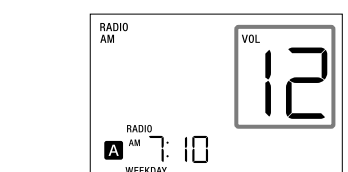

The setting is complete. The radio will turn on at the set time, gradually increasing in volume. ("A" (or "B") flashes on the display.)

Setting the Nature Sound alarm

- 6 Press **VOL/SET** + or - (or **NATURE SOUND/PRESET** (1 to 5)) to select the desired Nature Sound, and press **SNOOZE/BRIGHTNESS/ENTER**.

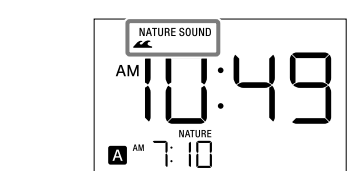

- 7 Press **VOL/SET** + or - to adjust the volume, and press **SNOOZE/BRIGHTNESS/ENTER**.

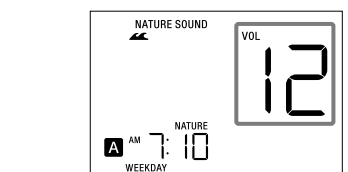

The setting is complete. The Nature Sound will sound at the set time, gradually increasing in volume. ("A" (or "B") flashes on the display.)

To stop the alarm

Press **ALARM RESET/OFF** to turn off the alarm.
The alarm will sound again at the same time the next weekday or the next weekend.

To doze for a few more minutes
Press **SNOOZE/BRIGHTNESS/ENTER**. The sound turns off, but will automatically come on again after about 10 minutes. Each time you press **SNOOZE/BRIGHTNESS/ENTER**, the snooze time changes as follows:

10 → 20 → 30 → 40 → 50 → 60
The display shows the snooze time for a few seconds and returns to show the current time. ("A" (or "B") flashes on the display.)

To deactivate the alarm

Press **SET ALARM/ALARM A** (or **B**). "A" (or "B") disappears from the display.

To change an alarm setting
Set the alarm again.

Tips

- When the alarm setting is complete, the alarm time setting is displayed.
 - If you press and hold **SNOOZE/BRIGHTNESS/ENTER** for more than 2 seconds while setting the alarm, the alarm setting is immediately complete.
- Notes**
- If a second alarm sounds during a first (or the snooze function is active), the second alarm takes priority.
 - If the same alarm time is set for both **ALARM A** and **ALARM B**, **ALARM A** takes priority.
 - If no operation is performed while the alarm is sounding, the alarm will stop after about 60 minutes.
 - When Automatic DST/summer time adjustment is set, the alarm sounds as follows:
 - If the alarm is set to a time that is skipped as a result of daylight saving time starting, the alarm will sound when daylight saving time is applied.
 - If the alarm is set to a time that is doubled as a result of daylight saving time ending, the alarm will sound twice.

Notes on the alarm in the event of a power interruption

In the event of a power interruption, the alarm functions work until the battery is fully discharged. But certain functions may be affected as follows:

- The display will disappear.
- If the alarm sound is set to "RADIO" or "NATURE," the buzzer will sound.
- If a power interruption occurs while the alarm is sounding, the buzzer will sound.
- If **ALARM RESET/OFF** is not pressed, the alarm will sound for about 5 minutes.
- If "cc" appears on the display, the alarm will not sound in the event of a power interruption. Replace the battery if "cc" appears.
- The snooze function will not work.
- During a power interruption, the alarm will sound only once at the set time.

Setting the sleep timer

You can fall asleep to the radio or Nature Sound using the sleep timer, which turns off the radio or Nature Sound automatically after a preset duration.

Press **SLEEP** while the radio or Nature Sound is playing.
"SLEEP" appears on the display.
Each time you press **SLEEP**, the duration (in minutes) changes on the display as follows:

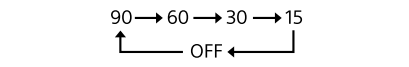

The radio or Nature Sound will play for the duration you set, then shut off. To deactivate the sleep timer, press **SLEEP** repeatedly to set the sleep timer to "OFF."

To turn off the radio or Nature Sound before the preset time

Press **ALARM RESET/OFF**.

To use both the sleep timer and alarm

You can fall asleep to the radio or Nature Sound and also be awakened by the alarm at the preset time.
Set the alarm, then set the sleep timer.

Tip
• When you press **SLEEP** while the sleep timer is activated, the remaining time appears on the display.

Note
• When the alarm is set to sound during the sleep timer duration, the sleep timer will be deactivated automatically when the alarm sounds.

Setting the brightness of the display

Three levels of brightness are available. Press **SNOOZE/BRIGHTNESS/ENTER**. Each time you press **SNOOZE/BRIGHTNESS/ENTER**, the brightness of the display changes as follows:

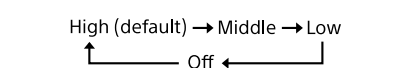

Tip
• You can also set the brightness of the display to off by pressing and holding **SNOOZE/BRIGHTNESS/ENTER**.

Notes
• When the alarm is sounding or the snooze function is active, the brightness of the display cannot be changed.
• Even if the brightness is set to off, the display lights at a low brightness level when the alarm sounds.

Charging a smartphone

You can charge a smartphone by connecting it to the unit using a USB cable (not supplied).

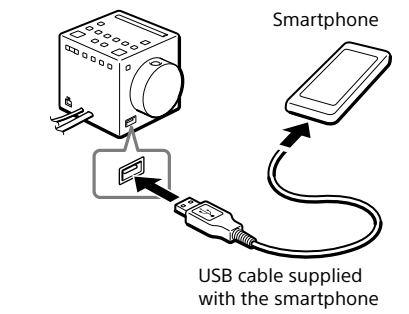

Notes
• There is no guarantee that this unit can be used to charge all products that can be charged via USB.
• This unit does not support power feeds greater than 5 V/1.5 A.
• Check the charge status on the smartphone.
• If a warning tone sounds, remove the smartphone from the unit.
• The reception sensitivity on the radio may worsen when charging a smartphone via USB.

General information

About the battery as a backup power source

This unit contains a CR2032 battery as a backup power source to keep the clock and the alarm operating during a power interruption. (No Power No Problem system)



When to replace the battery

When the battery is discharged, "cc" appears on the display.
If a power interruption occurs while the battery is discharged, the current time and alarm will be erased.

Note for customers in Europe
• The clock is preset at the factory, and its memory is powered by the preinstalled CR2032 battery. If the "0:00" flashes on the display when the unit is connected to AC outlet for the first time, the battery may be discharged. In this case, consult a Sony dealer. The preinstalled CR2032 battery is considered part of the product, and is covered by the warranty. You are required to show "Note for customers in Europe" (in this instruction) to a Sony dealer in order to validate the warranty for this product.

Replacing the backup battery

- 1 Keep the AC plug connected to the wall outlet, then open the battery compartment on the bottom of the unit.

