

SONY®

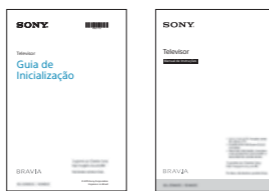

Televisor

Guia de Inicialização

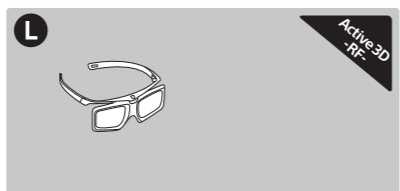
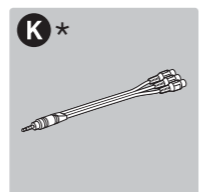
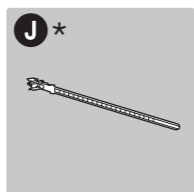
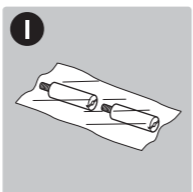
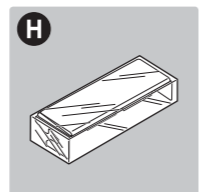
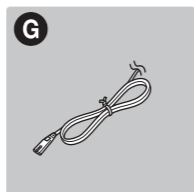
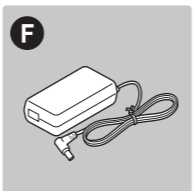
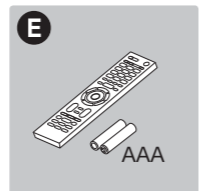
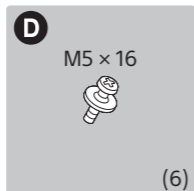
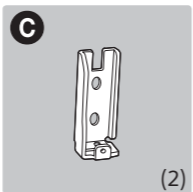
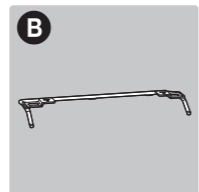
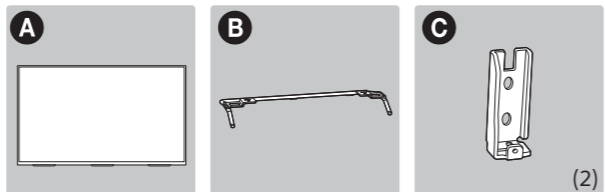

* Somente para determinadas regiões/países/modelos de TV.

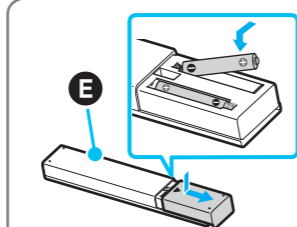

1

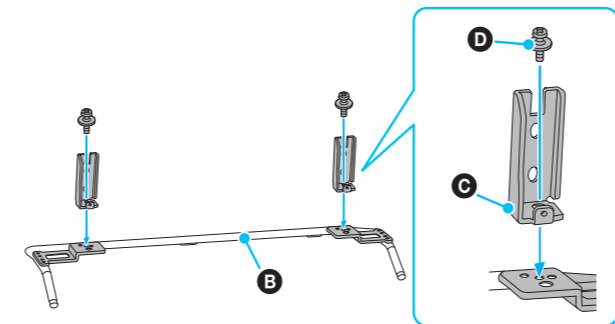

2

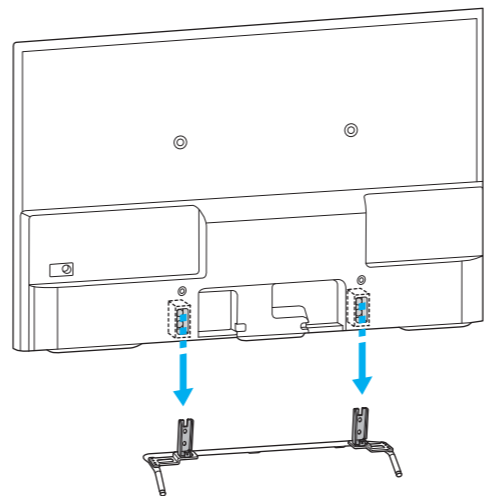

3

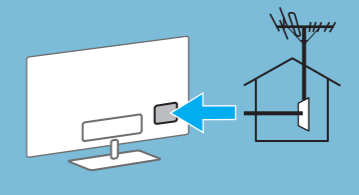
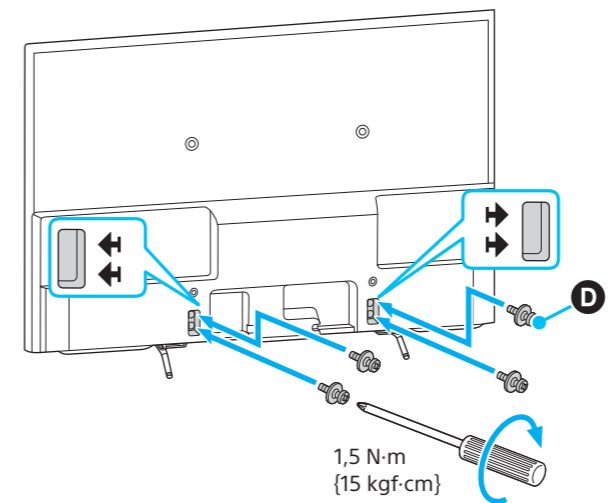

A

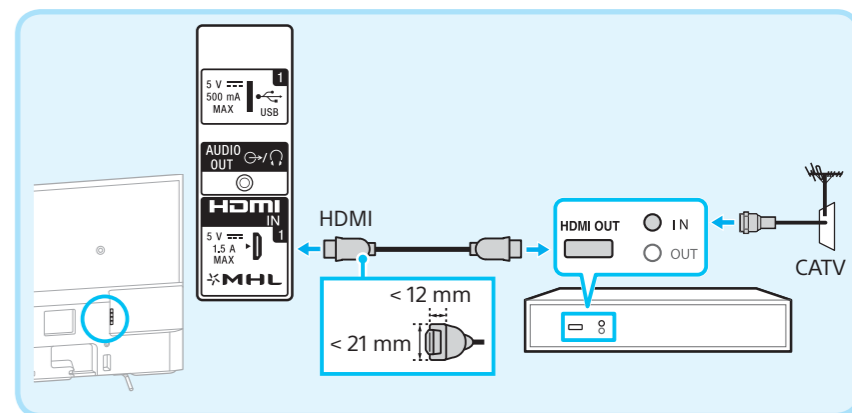

B

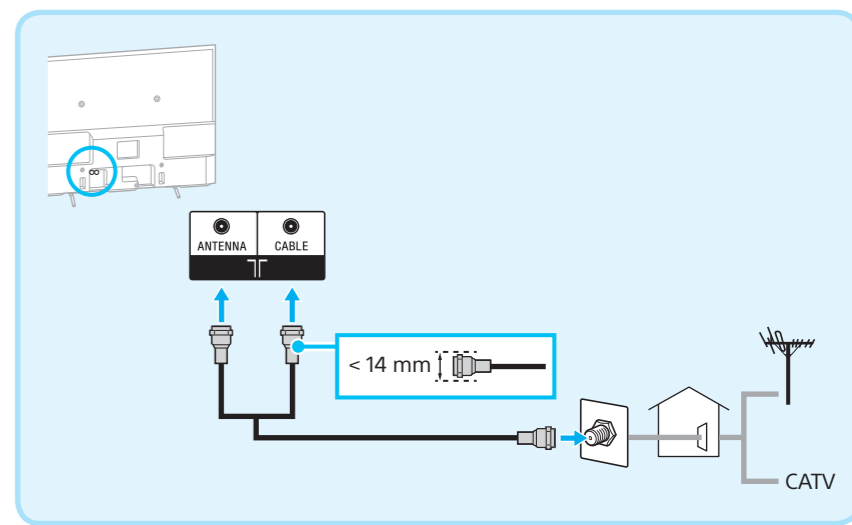

BRAVIA

Suporte ao Cliente Sony
<http://esupport.sony.com/BR/>

Não devolva o produto à loja

© 2015 Sony Corporation
Impresso no Brasil

KDL-55W805C / 50W805C

Consulte "Informações de segurança" no Manual de Instruções antes de transportar a TV.

Conexões Consulte "Conexão da TV" no Manual de Instruções para informações de conexão adicional.

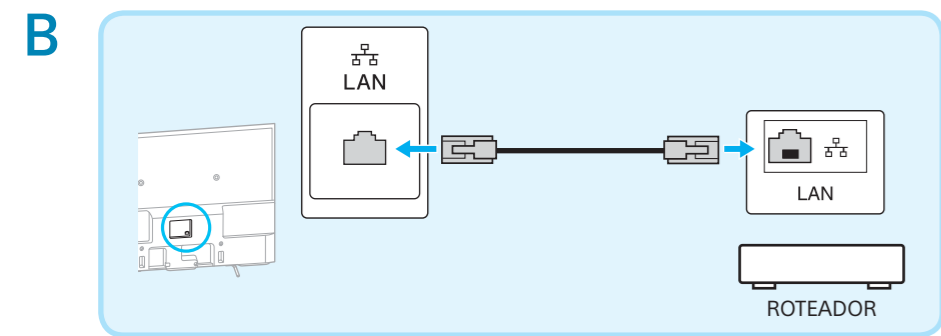
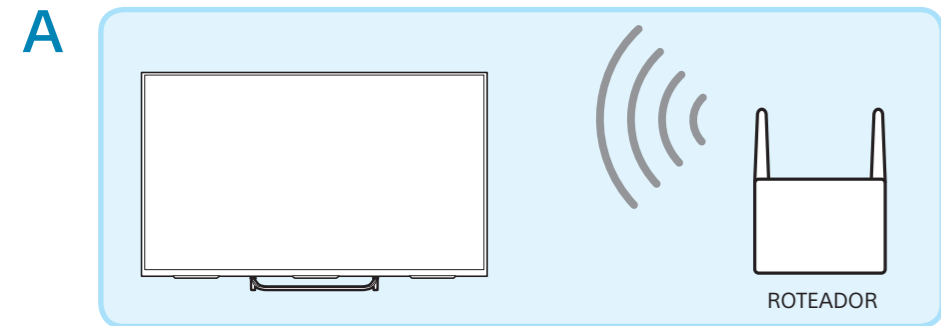

Conexão de Internet sem fio (A), com fio (use cabo de LAN categoria 7) (B). Consulte o manual fornecido com o roteador para informações sobre configurações do roteador.

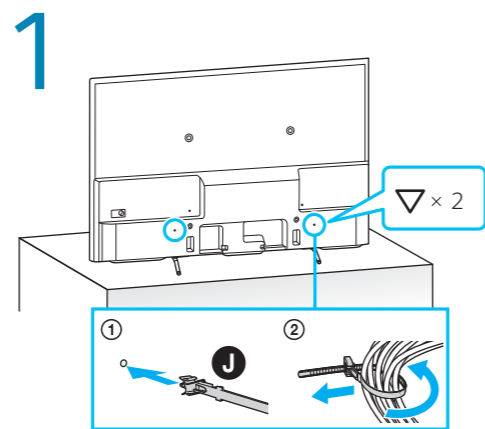

Não agrupe o cabo de alimentação CA junto com outros cabos.

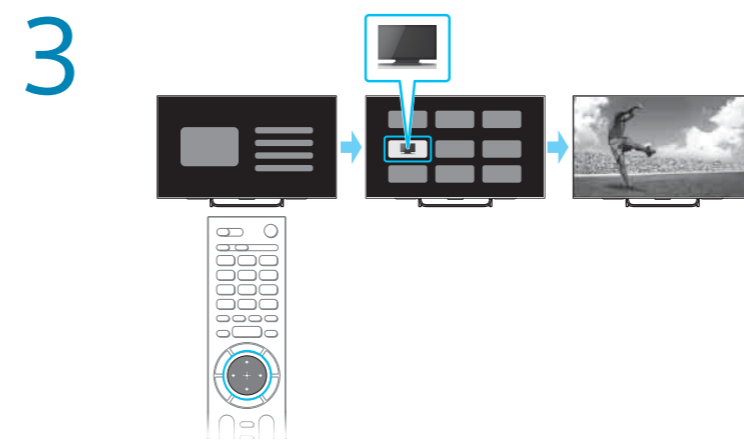
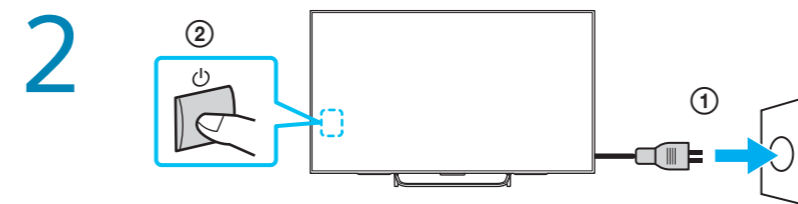
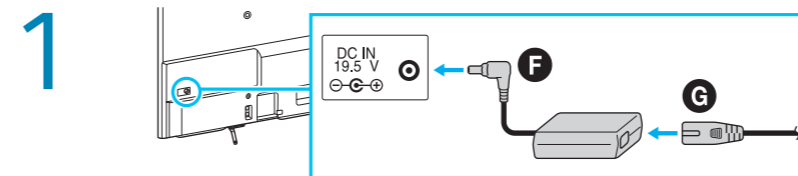
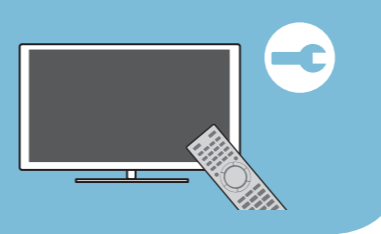

Ligue a TV e realize a configuração inicial.

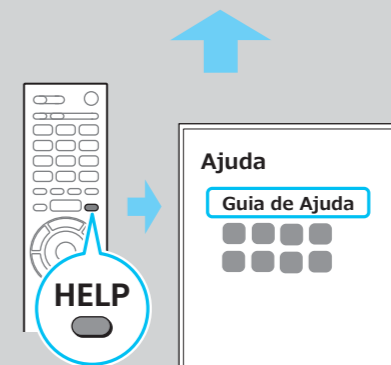

http://rd1.sony.net/help/tv/cusltn1/h_us/

Guia de Ajuda : informações sobre como usar os recursos da TV. Disponível na TV e na web.



http://rd1.sony.net/help/tv/cusltn2/h_us/

Guia de Instalação do Android TV:
Disponível na página de suporte.