



4-565-121-61(1)

Sound Bar

Startup Guide 入門指南

HT-CT380/CT780

GB
CT

Supplied accessories 提供的附件

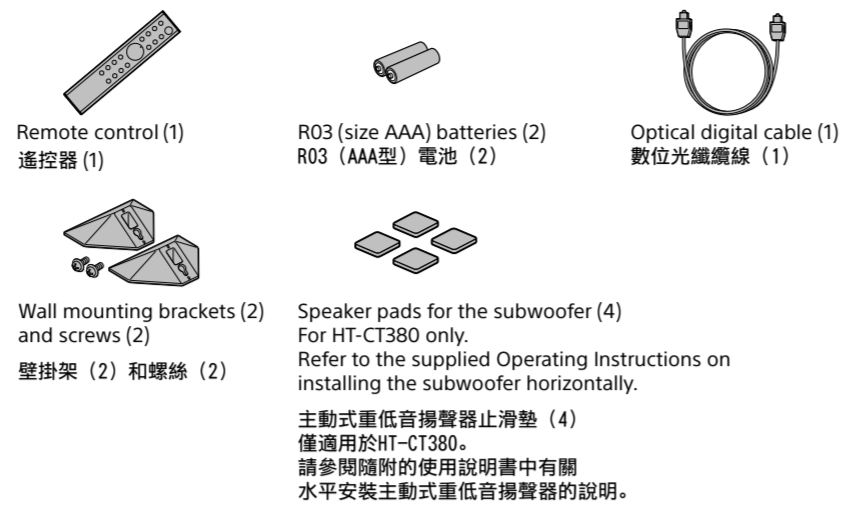

To mount the Bar Speaker on a wall
Refer to the supplied Operating Instructions.
將主動式揚聲器系統安裝到牆上
請參閱隨附的使用說明書。

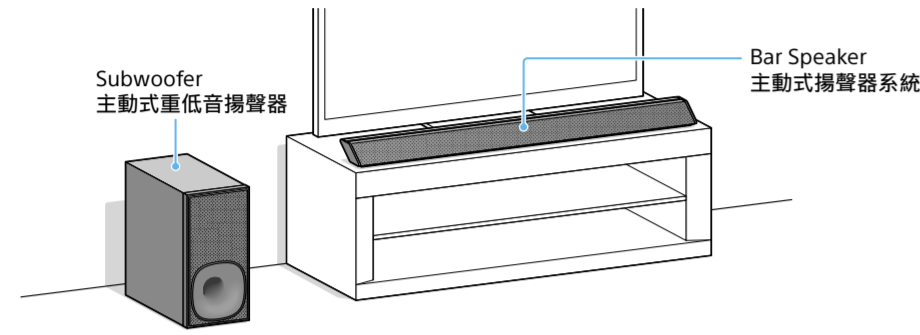

1 Connecting 連接

Connecting with a TV 連接 TV

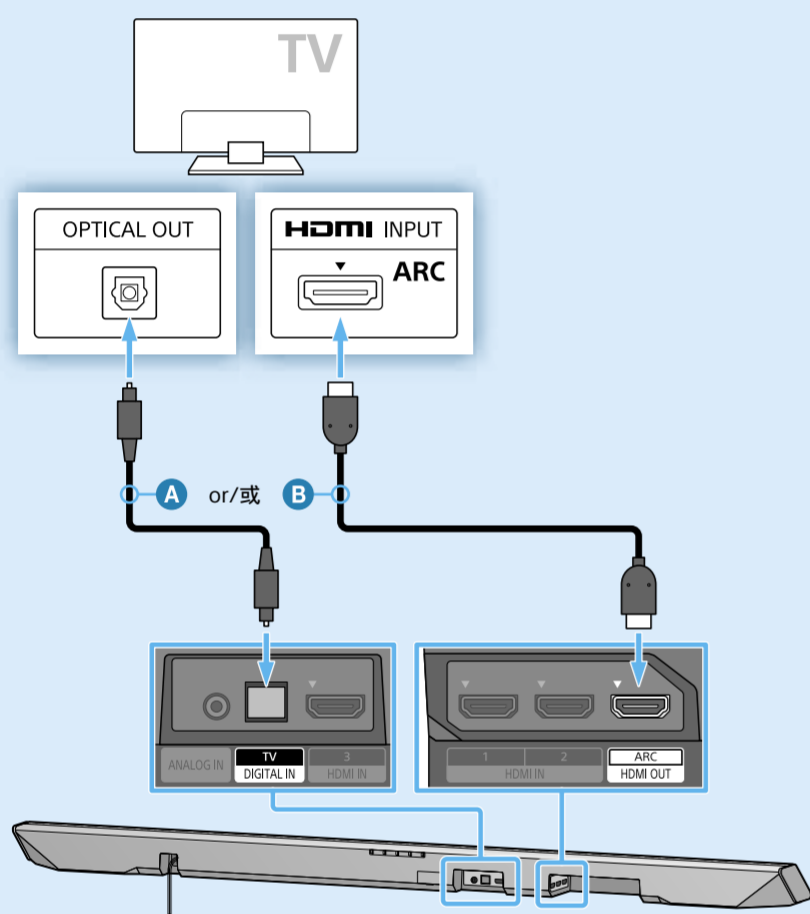

- A Optical digital cable (supplied)
- B HDMI cable (High Speed type, not supplied)
- A 數位光纖纜線 (提供)
- B HDMI 電纜 (高速類型, 未提供)

If the TV is not equipped with an optical audio output jack, connect an HDMI cable (B) (High Speed type, not supplied) to the HDMI input jack with "ARC" printed on it. If the HDMI input jack with "ARC" printed on it of the TV is connected with another device, disconnect that device from the TV and connect it to an HDMI IN jack (HDMI IN 1/2/3) on the Bar Speaker.

如果 TV 未配備光纖音訊輸出插孔, 請將 HDMI 電纜 (B) (高速類型, 未提供) 連接到印有 "ARC" 的 HDMI 輸入插孔。
如果 TV 上印有 "ARC" 的 HDMI 輸入插孔已連接其他裝置, 請將該裝置從 TV 上拆下, 然後將它連接到主動式揚聲器系統的 HDMI IN 插孔 (HDMI IN 1/2/3)。

Connecting with other devices 與其他裝置連接

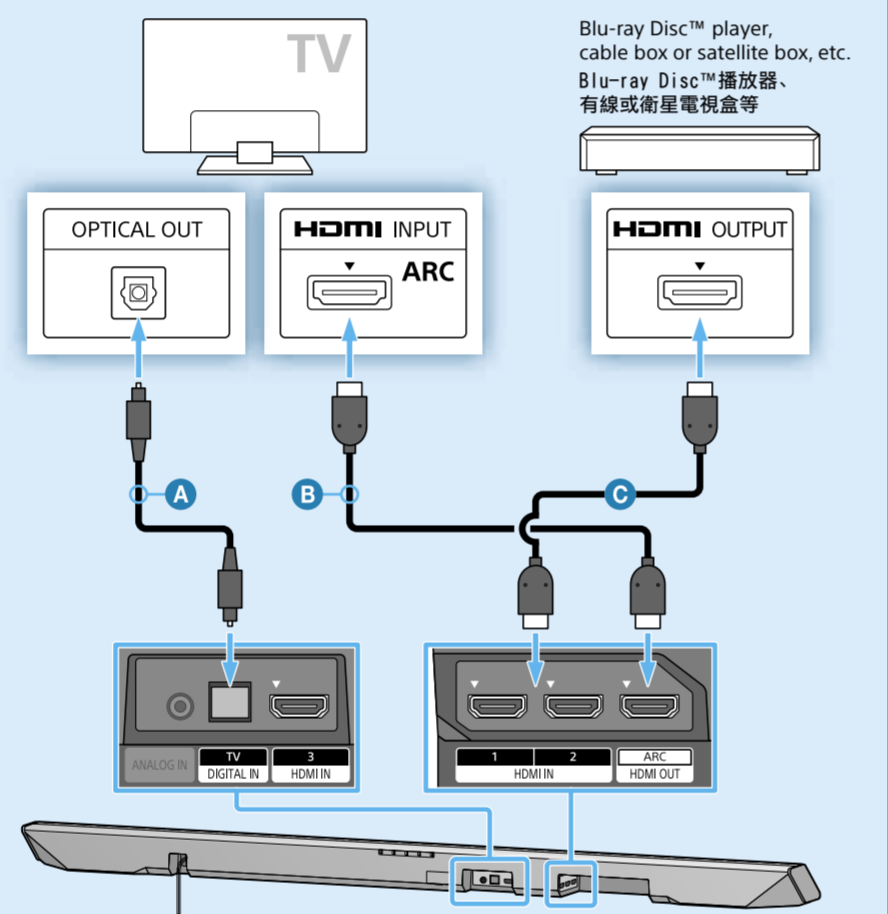

- A Optical digital cable (supplied)
- B HDMI cable (High Speed type, not supplied)
- C HDMI cable (High Speed type, not supplied)
- A 數位光纖纜線 (提供)
- B HDMI 電纜 (高速類型, 未提供)
- C HDMI 電纜 (高速類型, 未提供)

This is a connection for enjoying surround sound more effectively. If the HDMI input jack on the TV does not have "ARC" printed on it, connect the optical digital cable (A) in addition to an HDMI cable (B) (High Speed type, not supplied). If other devices are connected to the TV, disconnect their HDMI cables (C) (High Speed type, not supplied) from the HDMI input jacks (HDMI IN 1/2/3) on the Bar Speaker.

此連線可更有效地享受環繞聲。
如果 TV 上的 HDMI 輸入插孔沒有印有 "ARC", 請連接數位光纖纜線 (A), 再加上 HDMI 電纜 (B) (高速類型, 未提供)。
如果其他裝置連接到 TV, 請將其 HDMI 電纜 (C) (高速類型, 未提供) 從 TV 的 HDMI 輸入插孔拆下, 然後連接到主動式揚聲器系統的 HDMI IN 插孔 (HDMI IN 1/2/3)。

Tip/提示 (HT-CT780 only/僅適用於 HT-CT780)

- To enjoy copyright-protected 4K content, connect the HDCP 2.2-compatible HDMI jack. For details, refer to "Viewing Copyright-protected 4K Content" in the supplied Operating Instructions.
- 若要觀賞有版權保護的 4K 內容, 請連接 HDCP 2.2 相容的 HDMI 插孔。詳細資訊, 請參閱隨附使用說明書中的 "檢視有版權保護的 4K 內容"。

Note/註

- When you use an HDMI cable only, connect it to the HDMI jack with "ARC" printed on it on both the TV and the Bar Speaker. Otherwise, TV sound is not output.
- 當您僅使用 HDMI 電纜時, 請將電纜連接到 TV 與主動式揚聲器系統上印有 "ARC" 的 HDMI 插孔。否則, 不會輸出 TV 聲音。

2 Setting up the remote control 設定遙控器



3 Turning on the system 開啟系統

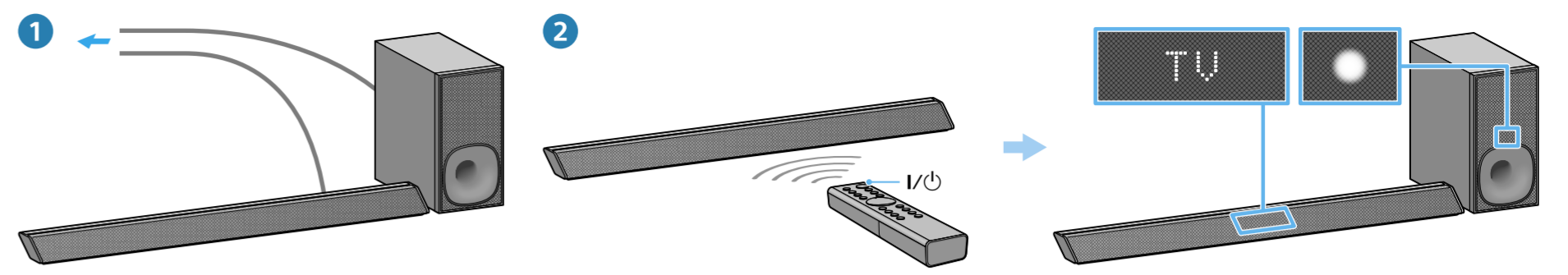

- 1 Connect the AC power cords (mains leads). The display lights up.
- 2 Press the I/O (on/standby) button. Confirm that the on/standby indicator of the subwoofer is lit in green. When the indicator turns on, wireless connection of the Bar Speaker and the subwoofer is completed. If it does not turn on, the wireless transmission is not activated. Refer to "Subwoofer wireless sound" of "Troubleshooting" in the supplied Operating Instructions.

- 1 接上交流電源線。顯示幕會亮起。
- 2 按下 I/O (開/待機) 按鈕。確認主動式重低音揚聲器的開/待機指示燈亮綠燈。指示燈亮起時, 代表完成主動式揚聲器系統和主動式重低音揚聲器的無線連線。若指示燈未亮起, 代表無線傳輸未啟動。請參閱隨附使用說明書中 "疑難排除" 的 "主動式重低音揚聲器無線聲音"。

4 Listening to the sound 聆聽聲音

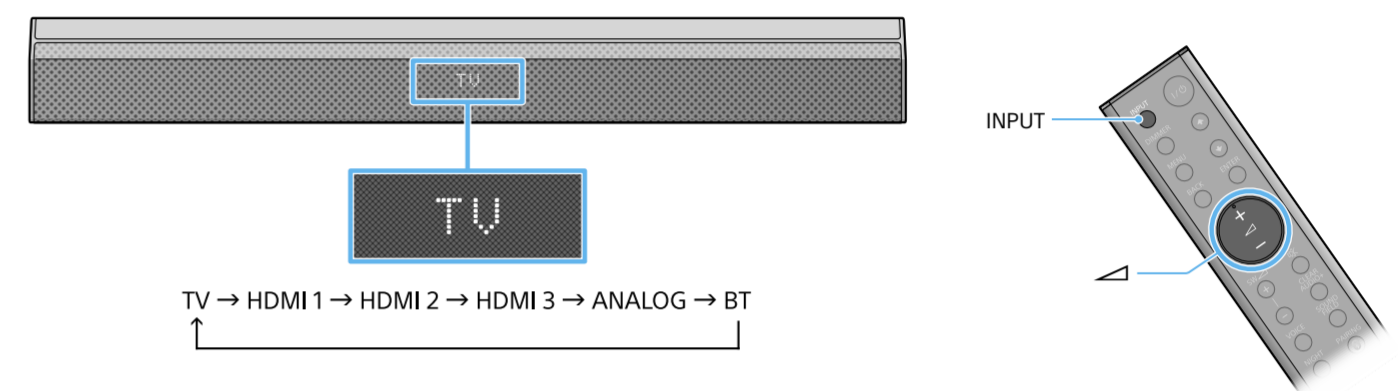

Press the INPUT button repeatedly until the desired input device is indicated on the display. Then, press the \triangleleft (volume) button to adjust the volume.

重複按下 INPUT 按鈕, 直到顯示幕上指出所需的輸入裝置為止。然後按下 \triangleleft (音量) 按鈕調整音量。

Setup completed! Enjoy! Please see the supplied Operating Instructions about the sound mode, and other functions.

設定完成! 盡情享受! 請參閱隨附使用說明書中有關聲音模式與其他功能的說明。



Listening to music from a BLUETOOTH device 從 BLUETOOTH 裝置聆聽音樂

When registering a BLUETOOTH device 登錄 BLUETOOTH 裝置時

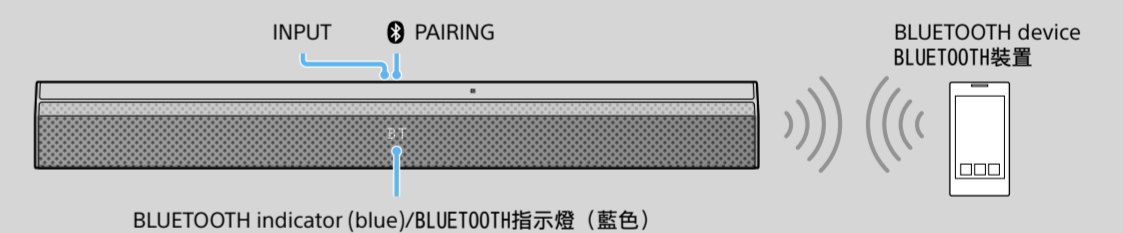

To pair the system with a BLUETOOTH device (Pairing)

- 1 Press PAIRING on the Bar Speaker. The BLUETOOTH indicator flashes quickly () during BLUETOOTH pairing.
- 2 Turn on the BLUETOOTH function on the BLUETOOTH device, search for devices and select this system (HT-CT380 or HT-CT780). If a Passkey is requested, enter "0000."
- 3 Make sure that the BLUETOOTH indicator lights up (). Connection has been established.

配對本系統與 BLUETOOTH 裝置 (配對)

- 1 按下主動式揚聲器系統上的 PAIRING。BLUETOOTH 配對時, BLUETOOTH 指示燈會快速閃爍 ()。
- 2 開啟 BLUETOOTH 裝置上的 BLUETOOTH 功能, 搜尋裝置並選擇此系統 (HT-CT380 或 HT-CT780)。如需密碼金鑰, 請輸入 "0000"。
- 3 確定 BLUETOOTH 指示燈亮起 ()。已建立連線。

To listen to music of the registered device

- 1 Press INPUT repeatedly to display [BT]. The BLUETOOTH indicator flashes () during attempting BLUETOOTH pairing.
- 2 On the BLUETOOTH device, select this system (HT-CT380 or HT-CT780).
- 3 Make sure that the BLUETOOTH indicator lights up (). Connection has been established.
- 4 Start playback on the BLUETOOTH device.

聆聽已登記裝置的音樂

- 1 重複按下 INPUT 以顯示 [BT]。嘗試進行 BLUETOOTH 配對時, BLUETOOTH 指示燈會快速閃爍 ()。
- 2 在 BLUETOOTH 裝置上選擇此系統 (HT-CT380 或 HT-CT780)。
- 3 確定 BLUETOOTH 指示燈亮起 ()。已建立連線。
- 4 開始在 BLUETOOTH 裝置上播放。

When using one-touch connection (NFC) 使用觸控連接功能時 (NFC)

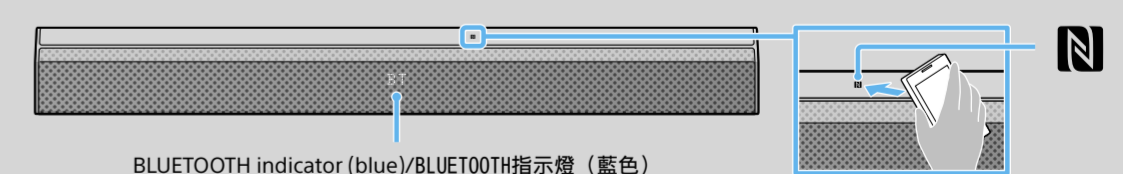

- 1 Download, install, and start the "NFC Easy Connect" app on your smartphone.
- 2 Touch the N mark of the Bar Speaker with the smartphone.
- 3 Make sure that the BLUETOOTH indicator lights up (). Connection has been established.



- 1 在智慧型手機上下載、安裝和啟動 "NFC 快速連線" 應用程式。
- 2 以智慧型手機觸碰主動式揚聲器系統的 N 字標示。
- 3 確定 BLUETOOTH 指示燈亮起 ()。已建立連線。



A dedicated App for this model is available on both Google Play™ and App Store.

Search for "SongPal" and download the free App to find out more about the convenient features.

可到 Google Play™ 與 App Store 取得此型號專用的應用程式。搜尋 "SongPal", 然後下載這個免費的應用程式, 瞭解它有哪些便利的功能。