

SONY

4-595-528-61(1)

©2016 Sony Corporation Printed in Vietnam

http://www.sony.net/

English

WARNING

To reduce the risk of electrical shock, do not open the cabinet. Refer servicing to qualified personnel only.

Do not install the appliance in a confined space, such as a bookcase or built-in cabinet.

Do not expose the batteries (battery pack or batteries installed) to excessive heat such as sunshine, fire or the like for a long time.

Do not dismantle, open or shred secondary cells or batteries. In the event of a cell leaking, do not allow the liquid to come in contact with the skin or eyes. If contact has been made, wash the affected area with copious amounts of water and seek medical advice.

Secondary cells and batteries need to be charged before use. Always refer to the manufacturer’s instructions or equipment manual for proper charging instructions.

After extended periods of storage, it may be necessary to charge and discharge the cells or batteries several times to obtain maximum performance.

Dispose of properly.

The Bluetooth® word mark and logos are registered trademarks owned by Bluetooth SIG, Inc. and any use of such marks by Sony Corporation is under license.

The N-Mark is a trademark or registered trademark of NFC Forum, Inc. in the United States and in other countries.

Microsoft, Windows and Windows Vista are registered trademarks or trademarks of Microsoft Corporation in the United States and/or other countries.

Mac and Mac OS are trademarks of Apple Inc., registered in the U.S. and other countries.

iPhone is a trademark of Apple Inc., registered in the U.S. and other countries.

Other trademarks and trade names are those of their respective owners.

Reference Guide US

Guía de referencia ES

Guia de Referência PT

Reference Guide US

Guía de referencia ES

Guia de Referência PT

Reference Guide US

Guía de referencia ES

Guia de Referência PT

Reference Guide US

Guía de referencia ES

Guia de Referência PT

Reference Guide US

Guía de referencia ES

Guia de Referência PT

Reference Guide US

Guía de referencia ES

Guia de Referência PT

Reference Guide US

Guía de referencia ES

Guia de Referência PT

Reference Guide US

Guía de referencia ES

Guia de Referência PT

Reference Guide US

Guía de referencia ES

Guia de Referência PT

Reference Guide US

Guía de referencia ES

Guia de Referência PT

Reference Guide US

Guía de referencia ES

Guia de Referência PT

Reference Guide US

Guía de referencia ES

Guia de Referência PT

Reference Guide US

Guía de referencia ES

Guia de Referência PT

Reference Guide US

Guía de referencia ES

Guia de Referência PT

Reference Guide US

Guía de referencia ES

Guia de Referência PT

Reference Guide US

Guía de referencia ES

Guia de Referência PT

Reference Guide US

Guía de referencia ES

Guia de Referência PT

Reference Guide US

Guía de referencia ES

Guia de Referência PT

Reference Guide US

Guía de referencia ES

Guia de Referência PT

Reference Guide US

Guía de referencia ES

Guia de Referência PT

Reference Guide US

Guía de referencia ES

Guia de Referência PT

Reference Guide US

Guía de referencia ES

Guia de Referência PT

Reference Guide US

Guía de referencia ES

Guia de Referência PT

Reference Guide US

Guía de referencia ES

Guia de Referência PT

Reference Guide US

Guía de referencia ES

Guia de Referência PT

– A device using 2.4 GHz frequency, such as a Wi-Fi device, cordless telephone, or microwave oven, is in use near this unit.

- Because BLUETOOTH devices and Wi-Fi (IEEE802.11b/g/n) use the same frequency (2.4 GHz), microwave interference may occur resulting in noise or audio dropout or communications being disabled if this unit is used near a Wi-Fi device. In such a case, perform the following.
 - Use this unit at least 10 m (30 feet) away from the Wi-Fi device.
 - If this unit is used within 10 m (30 feet) of a Wi-Fi device, turn off the Wi-Fi device.
 - Install this unit and the BLUETOOTH device as near to each other as possible.
- Microwaves emitting from a BLUETOOTH device may affect the operation of electronic medical devices. Turn off this unit and other BLUETOOTH devices in the following locations, as it may cause an accident:
 - where inflammable gas is present, in a hospital, or a petrol station
 - near automatic doors or a fire alarm

- Do not use the unit on an airplane. Radio waves may affect instruments, causing an accident due to malfunction.
- Due to the characteristic of BLUETOOTH wireless technology, the sound played on this unit is slightly delayed from the sound played on the BLUETOOTH device during talking on the telephone or listening to the music.

- This unit supports security capabilities that comply with the BLUETOOTH standard to provide a secure connection when the BLUETOOTH wireless technology is used, but security may not be enough depending on the setting. Be careful when communicating using BLUETOOTH wireless technology.

- We do not take any responsibility for the leakage of information during BLUETOOTH communications.

- Connection with all BLUETOOTH devices cannot be guaranteed.

- A device featuring BLUETOOTH function is required to conform to the BLUETOOTH standard specified by Bluetooth SIG, Inc. and be authenticated.

- Even if the connected device conforms to the above mentioned BLUETOOTH standard, some devices may not be connected or work correctly, depending on the features or specifications of the device.

- While talking on the phone hands free, noise may occur, depending on the device or communication environment.

- Depending on the device to be connected, it may require some time to start communications.

On the use of calling apps for smartphones and computers

- This unit supports normal incoming calls only. Calling apps for smartphones and computers are not supported.

If sound skips frequently during playback

- The situation may be improved by changing the wireless playback quality settings or fixing the wireless playback mode to SBC on the transmitting device. For details, refer to the operating instructions supplied with the transmitting device.

On charging the unit

- This unit can be charged using USB only. Personal computer with USB port is required for charging.

- This unit cannot be turned on, nor can the BLUETOOTH function be used, during charging.

- If you do not use the unit for a long time, the rechargeable battery may not be able to keep sufficient charge. The battery will be able to keep a charge properly after repeatedly discharging and charging several times.

- If you store the unit for a long time, charge the battery once every half year to prevent over-discharge.

- If the length of time you can use the unit became extremely short, the rechargeable battery should be replaced with a new one. Please contact your nearest Sony dealer for a battery replacement.

Note on static electricity

- Static electricity accumulated in the body may cause mild tingling in your ears. To minimize the effect, wear clothes made from natural materials.

If the unit does not operate properly

- Reset the unit.

- Connect the headset to a booted computer using the supplied micro-USB cable, then press the ⏻ button and ⏻ button simultaneously. The unit will be reset. Pairing information is not deleted.

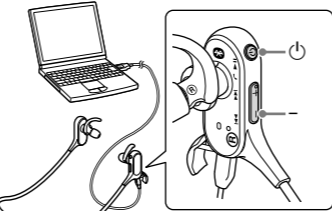

- If the problem persists even after the resetting operation above, initialize the unit as follows. Disconnect the micro-USB cable from the micro-USB port, turn off the unit, then hold down the ⏻ and ⏻ buttons simultaneously for more than 7 seconds. The indicator (blue) flashes 4 times, and the unit is reset to the factory settings. All pairing information is deleted.

- After the unit is initialized, it may not connect to your iPhone or computer. In this case, delete the pairing information of the unit from the iPhone or computer, and then pair them again.

Water resistance performance

The water resistance specifications¹⁾ of this unit are equivalent to IPX4²⁾ in IEC 60529 “Degrees of protection against ingress of water (IP Code)”, which specifies the degree of protection provided against the entry of water. However, the unit cannot be used in water. Unless the unit is used correctly, water may get into the unit and cause fire, electrocution, or malfunctions. Note the following cautions carefully and use the unit correctly.

Liquids that the water resistance performance specifications apply to

Applicable: Fresh water, tap water, perspiration

Not applicable: Liquids other than those above (examples: soapy water, detergent water, water with bath agents, shampoo, hot spring water, pool water, seawater, etc.)

- Make sure that the micro-USB port cover is closed securely when you use the unit.

- IPX4 (degree of protection against splashing water): Protected against water splashing from any direction.

Water resistance performance of the unit is based on Sony measurements under the conditions described above. Note that malfunctions as a result of water immersion caused by misuse by the customer are not covered by the warranty.

To maintain water resistance performance

Note the following cautions carefully and use the unit correctly.

- Do not drop the unit or expose it to mechanical shock. Doing so may deform or damage the unit, resulting in deterioration of water resistance performance.

- Do not put the unit in water or use it in a humid place such as a bathroom.

- The micro-USB port cover is important for maintaining water resistance performance. Make sure the micro-USB port cover is closed securely when you use the unit. If the cover has any foreign objects on it or is not completely closed, water resistance performance cannot be maintained. In addition, water may get into the unit and cause malfunctions.

- Do not splash water forcibly against the cylindrical part from which sound is emitted. Doing so may deteriorate the water resistance performance of the unit.

- Wipe off with a soft dry cloth any water that gets on the unit. If water remains in the earbud holes, the sound may seem low or not be audible at all. In this case, remove the earbuds, face the sound conduit downward, and shake the sound conduit a couple of times.

- Do not leave the unit with water on it in cold places as the water may freeze. In order to avoid malfunctions, make sure that you wipe off water after use.

Others

- Do not place this unit in a place exposed to humidity, dust, soot or steam, or subject to direct sunlight. Do not leave the unit in a car for a long time. It may cause a malfunction.

- Using the BLUETOOTH device may not function on mobile phones, depending on radio wave conditions and location where the equipment is being used.

- Listening with this unit at high volume may affect your hearing.

- For traffic safety, do not use this unit while driving or cycling.

- Do not use the unit in places where it would be dangerous if you are unable to hear ambient sound, such as at railroad crossings, train station platforms, and construction sites.

- Do not put weight or pressure on this unit as it may cause the unit to deform during long storage.

- Do not subject the unit to excessive shock.

- Clean the unit with a soft dry cloth.

- If you experience discomfort after using the unit, stop using the unit immediately.

- The earpads may deteriorate due to longterm storage or use.

- If you have any questions or problems concerning this unit that are not covered in this manual, please consult your nearest Sony dealer.

Optional replacement earbuds and arc supporters can be ordered from your nearest Sony dealer.

Optional replacement earbuds and arc supporters can be ordered from your nearest Sony dealer.

Optional replacement earbuds and arc supporters can be ordered from your nearest Sony dealer.

Optional replacement earbuds and arc supporters can be ordered from your nearest Sony dealer.

Optional replacement earbuds and arc supporters can be ordered from your nearest Sony dealer.

Optional replacement earbuds and arc supporters can be ordered from your nearest Sony dealer.

Optional replacement earbuds and arc supporters can be ordered from your nearest Sony dealer.

Optional replacement earbuds and arc supporters can be ordered from your nearest Sony dealer.

Optional replacement earbuds and arc supporters can be ordered from your nearest Sony dealer.

Optional replacement earbuds and arc supporters can be ordered from your nearest Sony dealer.

Optional replacement earbuds and arc supporters can be ordered from your nearest Sony dealer.

Optional replacement earbuds and arc supporters can be ordered from your nearest Sony dealer.

Optional replacement earbuds and arc supporters can be ordered from your nearest Sony dealer.

Optional replacement earbuds and arc supporters can be ordered from your nearest Sony dealer.

Optional replacement earbuds and arc supporters can be ordered from your nearest Sony dealer.

Optional replacement earbuds and arc supporters can be ordered from your nearest Sony dealer.

Optional replacement earbuds and arc supporters can be ordered from your nearest Sony dealer.

Optional replacement earbuds and arc supporters can be ordered from your nearest Sony dealer.

Optional replacement earbuds and arc supporters can be ordered from your nearest Sony dealer.

Optional replacement earbuds and arc supporters can be ordered from your nearest Sony dealer.

Optional replacement earbuds and arc supporters can be ordered from your nearest Sony dealer.

Optional replacement earbuds and arc supporters can be ordered from your nearest Sony dealer.

Optional replacement earbuds and arc supporters can be ordered from your nearest Sony dealer.

Optional replacement earbuds and arc supporters can be ordered from your nearest Sony dealer.

Optional replacement earbuds and arc supporters can be ordered from your nearest Sony dealer.

Optional replacement earbuds and arc supporters can be ordered from your nearest Sony dealer.

Optional replacement earbuds and arc supporters can be ordered from your nearest Sony dealer.

Optional replacement earbuds and arc supporters can be ordered from your nearest Sony dealer.

Optional replacement earbuds and arc supporters can be ordered from your nearest Sony dealer.

Optional replacement earbuds and arc supporters can be ordered from your nearest Sony dealer.

Optional replacement earbuds and arc supporters can be ordered from your nearest Sony dealer.

Optional replacement earbuds and arc supporters can be ordered from your nearest Sony dealer.

Optional replacement earbuds and arc supporters can be ordered from your nearest Sony dealer.

Optional replacement earbuds and arc supporters can be ordered from your nearest Sony dealer.

Optional replacement earbuds and arc supporters can be ordered from your nearest Sony dealer.

Optional replacement earbuds and arc supporters can be ordered from your nearest Sony dealer.

Optional replacement earbuds and arc supporters can be ordered from your nearest Sony dealer.

Optional replacement earbuds and arc supporters can be ordered from your nearest Sony dealer.

Optional replacement earbuds and arc supporters can be ordered from your nearest Sony dealer.

Optional replacement earbuds and arc supporters can be ordered from your nearest Sony dealer.

Optional replacement earbuds and arc supporters can be ordered from your nearest Sony dealer.

Optional replacement earbuds and arc supporters can be ordered from your nearest Sony dealer.

Optional replacement earbuds and arc supporters can be ordered from your nearest Sony dealer.

Optional replacement earbuds and arc supporters can be ordered from your nearest Sony dealer.

Optional replacement earbuds and arc supporters can be ordered from your nearest Sony dealer.

Optional replacement earbuds and arc supporters can be ordered from your nearest Sony dealer.

Optional replacement earbuds and arc supporters can be ordered from your nearest Sony dealer.

Optional replacement earbuds and arc supporters can be ordered from your nearest Sony dealer.

Optional replacement earbuds and arc supporters can be ordered from your nearest Sony dealer.

Optional replacement earbuds and arc supporters can be ordered from your nearest Sony dealer.

Optional replacement earbuds and arc supporters can be ordered from your nearest Sony dealer.

Optional replacement earbuds and arc supporters can be ordered from your nearest Sony dealer.

Optional replacement earbuds and arc supporters can be ordered from your nearest Sony dealer.

Optional replacement earbuds and arc supporters can be ordered from your nearest Sony dealer.

Optional replacement earbuds and arc supporters can be ordered from your nearest Sony dealer.

Optional replacement earbuds and arc supporters can be ordered from your nearest Sony dealer.

Optional replacement earbuds and arc supporters can be ordered from your nearest Sony dealer.

Optional replacement earbuds and arc supporters can be ordered from your nearest Sony dealer.

Optional replacement earbuds and arc supporters can be ordered from your nearest Sony dealer.

Optional replacement earbuds and arc supporters can be ordered from your nearest Sony dealer.

Optional replacement earbuds and arc supporters can be ordered from your nearest Sony dealer.

Optional replacement earbuds and arc supporters can be ordered from your nearest Sony dealer.

Receiver

Type: Closed, Dynamic

Driver unit: 12 mm

Frequency response: 4 Hz - 24,000 Hz

Microphone

Type: Electret condenser

Directivity: Omni directional

Effective frequency range: 50 Hz - 8,000 Hz

System requirements for battery charge using USB

Personal Computer with pre-installed with any of the following operating systems and USB port:

Operating Systems

(when using Windows)

Windows® 10 Home / Windows® 10 Pro

Windows® 8.1 / Windows® 8.1 Pro

Windows® 8 / Windows® 8 Pro

Windows® 7

Home Basic / Home Premium / Professional / Ultimate

Windows Vista® (Service Pack 2 or later)

