

Home Theatre System
Startup Guide

HT-S500RF

To set up the remote control



What's in the box

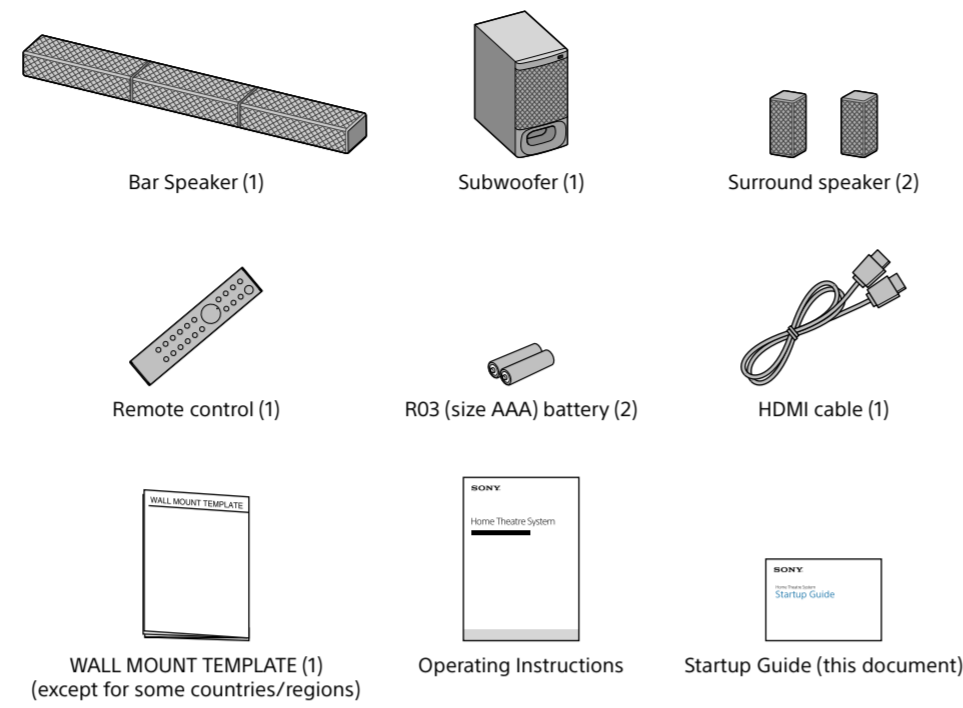

1 Deciding the installation position

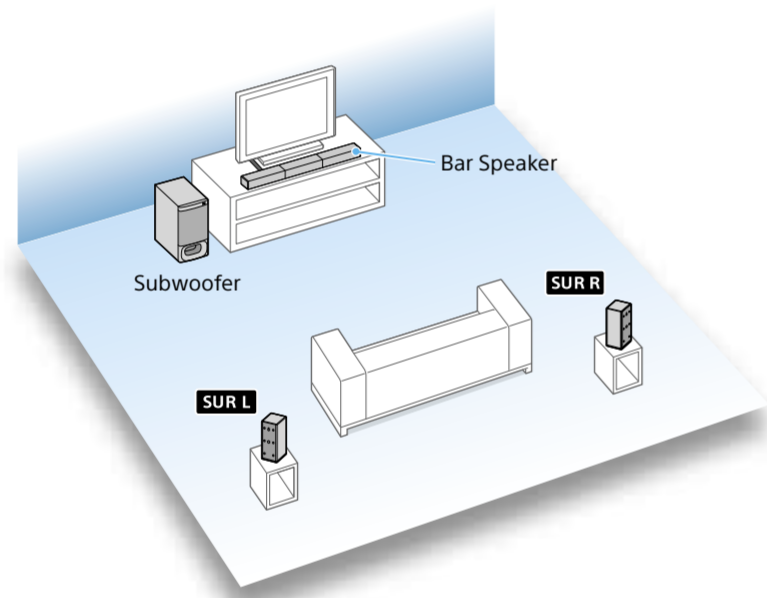

To mount the Bar Speaker and the surround speakers on a wall
For details, refer to the Operating Instructions (separate document).

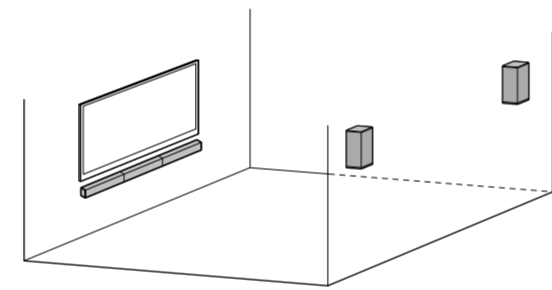

Note
Place the subwoofer 5 cm or more away from a TV rack, walls, etc.

2 Connecting the speakers

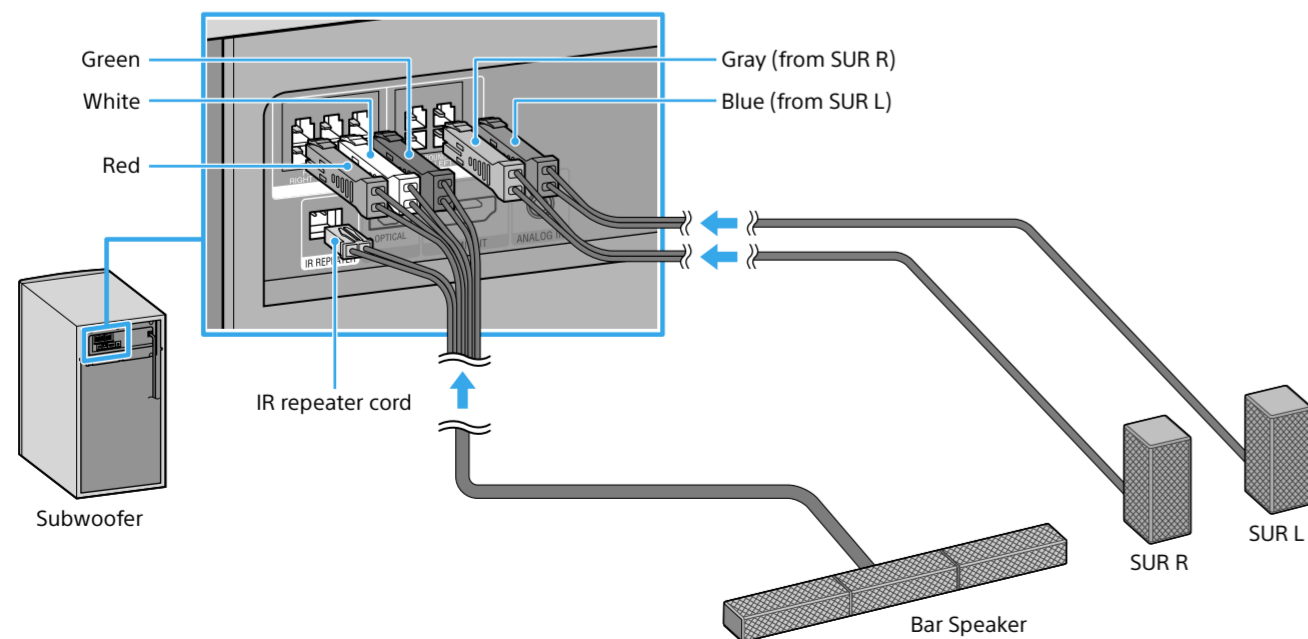

Note
Connect the speaker cords to the matching color of the SPEAKERS jacks on the rear panel of the subwoofer.

3 Connecting with a TV

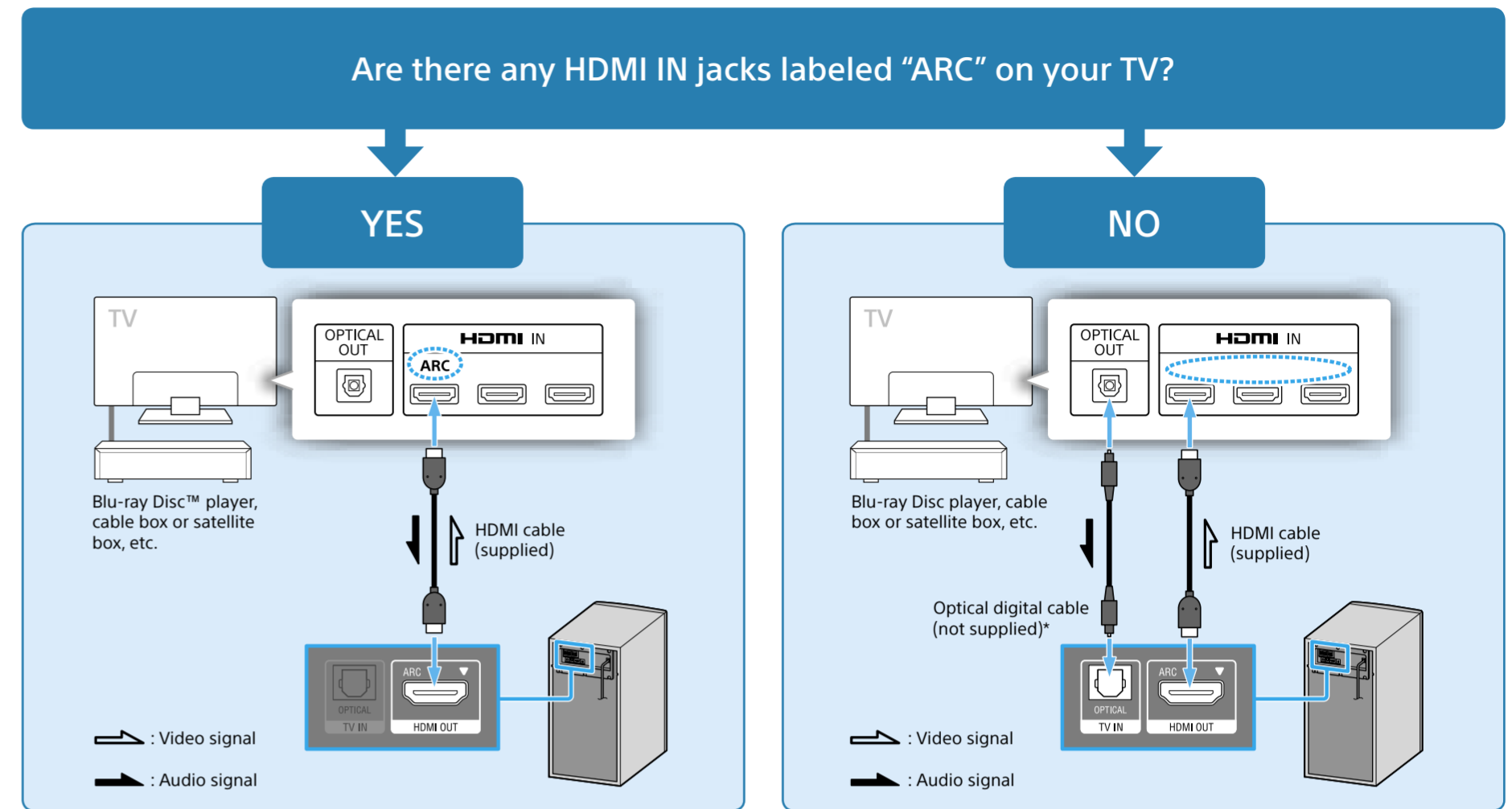

* If your TV does not support the ARC (Audio Return Channel) function, connect an optical digital cable (not supplied) to listen to the TV sound.

4 Turning on the system

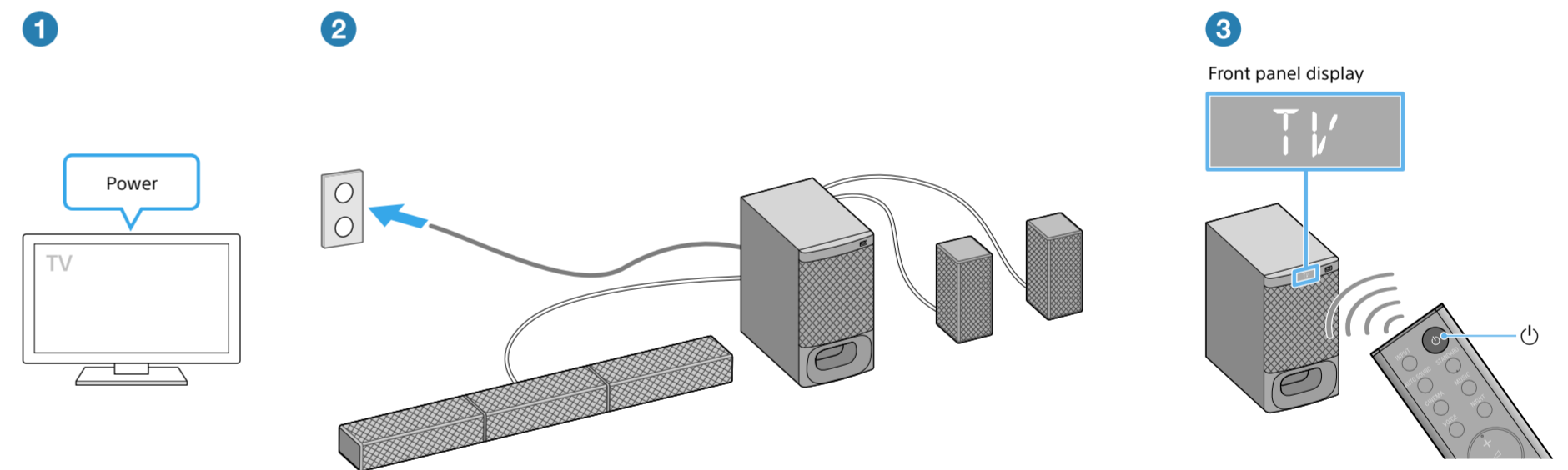

- 1 Turn on the TV.
- 2 Connect the AC power cord (mains lead) of the subwoofer to the wall outlet (mains).
- 3 Press (power) on the remote control of the system. The front panel display lights up.

5 Listening to the sound



- 1 Press INPUT repeatedly until the input source you want appears in the front panel display. To listen to TV audio, make sure that "TV" is displayed in the front panel display, then select the program you want using the TV remote control. When "TV" is not displayed in the front panel display, press INPUT on the remote control of the system to select the TV input.
- 2 Press to adjust the system volume and press SW to adjust the subwoofer volume.

Note
Depending on the order in which you turn on the TV and the system, the system may enter muting mode. In this case, turn on the TV first, then the system.