

Television

# Setup Guide

Téléviseur digital a color con pantalla de cristal líquido  
 Téléviseur  
 Televisor

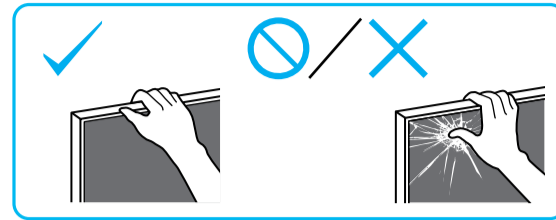
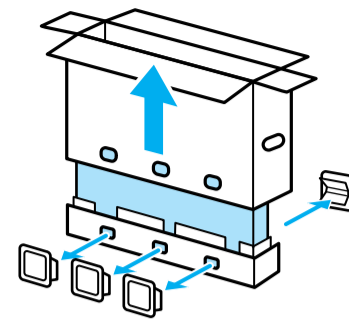

**1**

\*1

85 x 6  
 75 x 4

85  
 75

**2**

**3**

85  
 75

CB  
 CC  
 CD  
 CC1  
 CA

①\*1  
 ②  
 ③

x 6

**4**

**5**

①  
 SB2  
 ②  
 M5L12  
 ③  
 CD

①  
 SB1  
 ②  
 M5L12  
 ③  
 CD

**6**

85  
 85

①  
 SB1  
 ②  
 M5L12  
 CD

①  
 SB2  
 ②  
 M5L12  
 CD

\*1 Only on limited region/country/TV model. / Uniquement pour certaines régions/pays/modèles de téléviseurs. / Solo en regiones/paises limitados/Modelo de TV. / Somente para determinadas regiões/paises/modelos de TV.



7

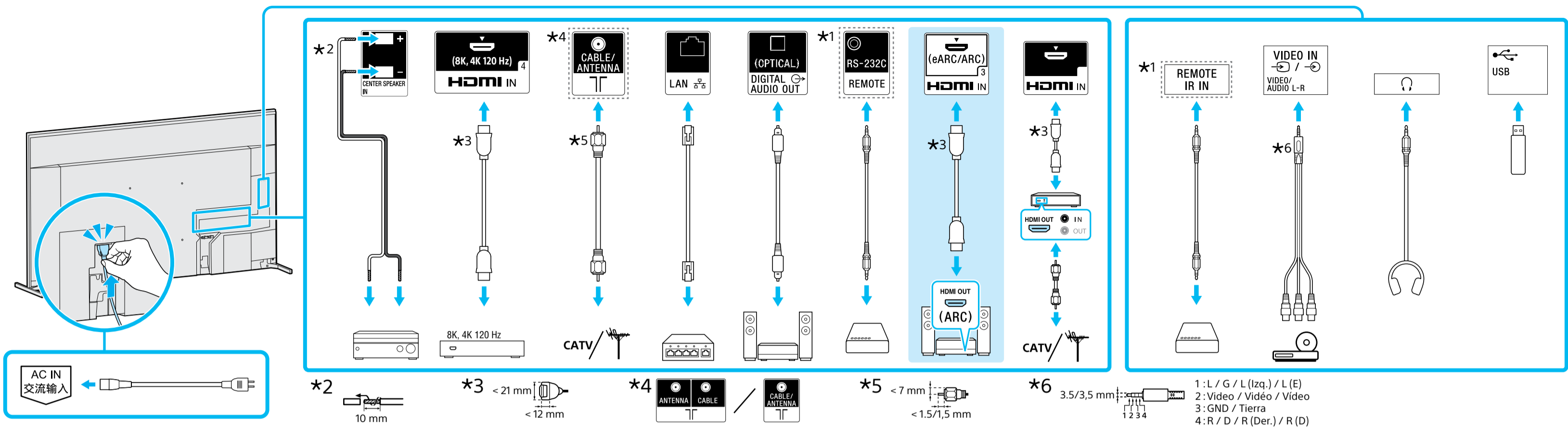

8

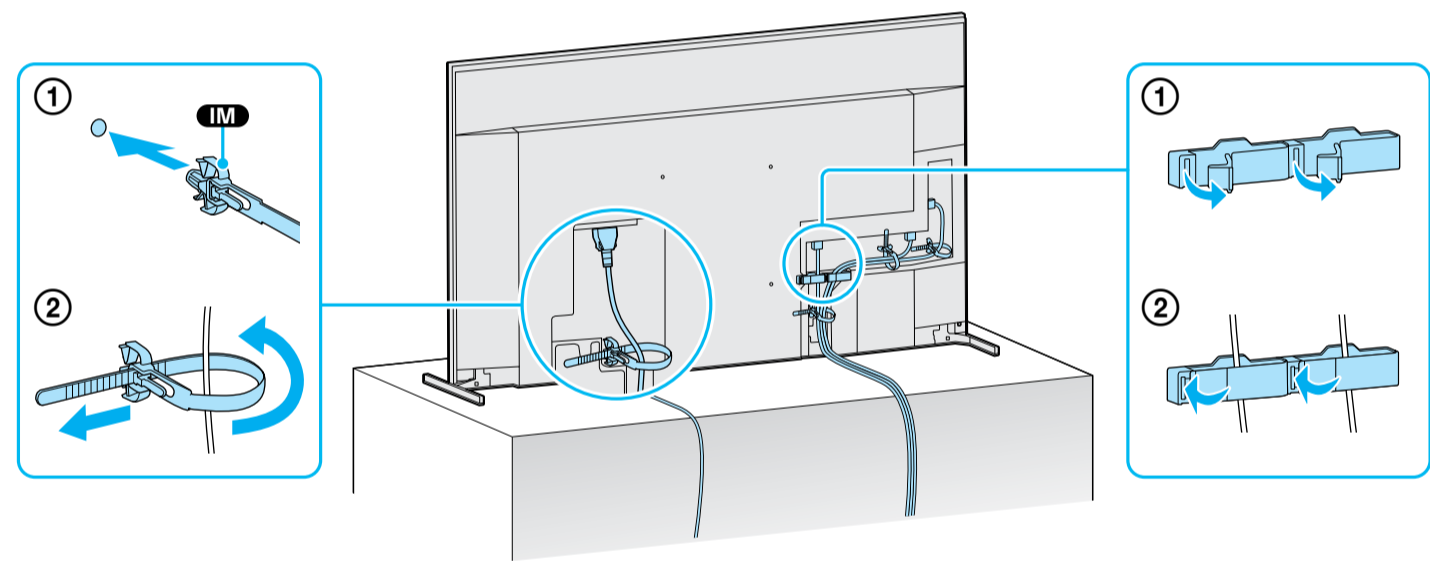

9

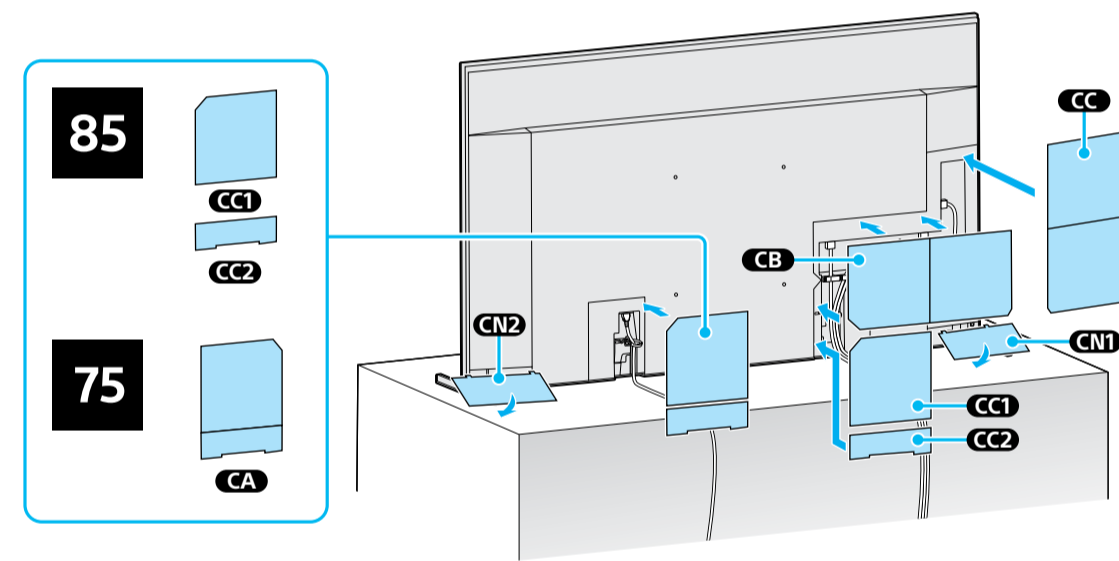

10

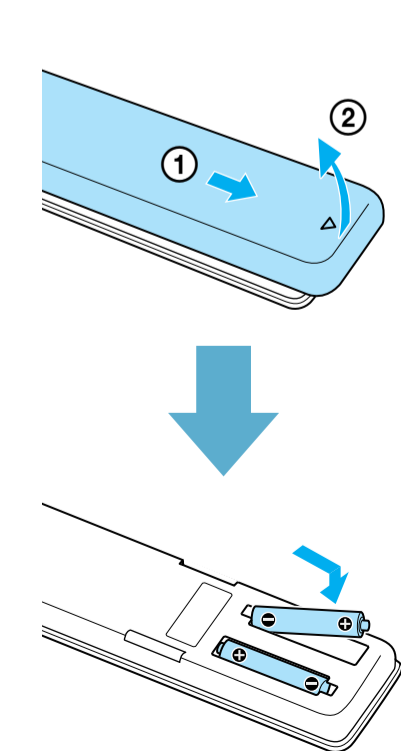

11

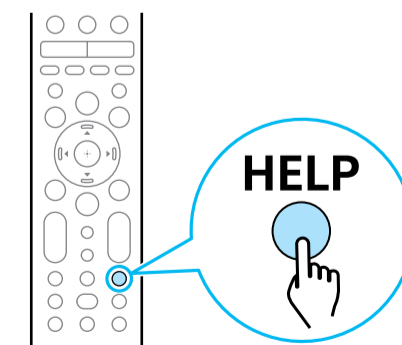
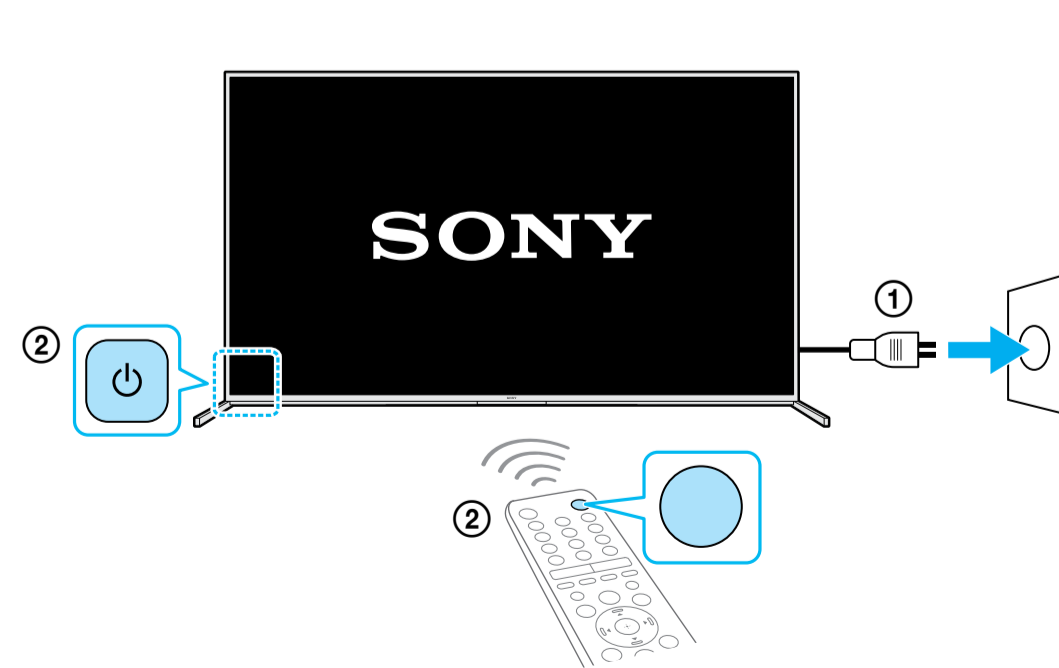

Help / Aide / Ayuda / Ajuda



<http://www.sony.net/tv-how-to-videos>

Tips / Conseils / Consejos / Dicas