

KD-75X80L / 65X80L / 55X80L / 50X80L / 43X80L

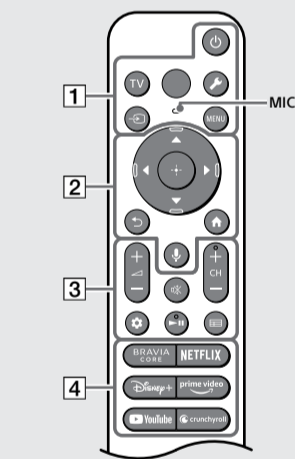
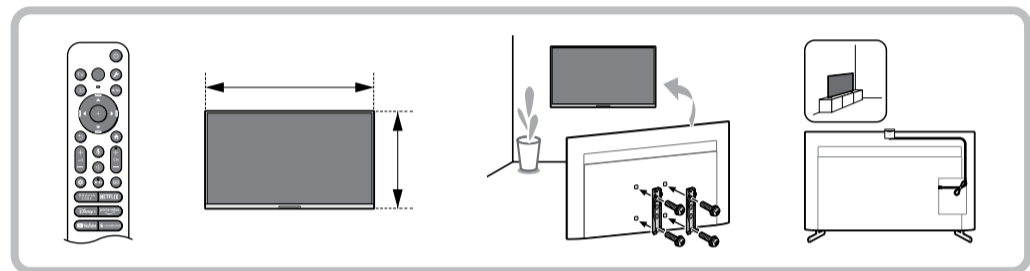

EN
The remote control shape, layout, availability and function of remote control buttons may vary depending on your region/country/TV model/TV settings.*1

- 1 (Power)**
TV: Display TV channel list or switch to input.
Quick settings: Display Quick Settings.
Input select: Display and select the input source, etc.
MENU (Control menu): Display the Control menu.
- 2 (Navigation)**
On screen menu navigation and selection.
Back: Return to previous screen.
Home: Return to Home screen.
Google Assistant / Microphone: Use Google Assistant*2*3 or voice search*3.
- 3 (Volume)**
Mute: Mute the TV.
CH +/- (Channel): Display Channel.
Dashboard: Display Dashboard.
Guide: Display the digital programme guide.
- 4 App buttons**

*1 For other remote control models, refer to the online Help Guide for details.
*2 Only for limited region/country/model/language.
*3 Google Assistant or voice search requires an Internet connection.
*4 Accessibility shortcut is available by pressing and holding Mute.

- CT**
遙控器外形、按鈕的佈局、可用性與功能視您的國家/區域/電視機型號或設定而可能略有不同。*1
- 1 (電源)**
TV: 顯示電視機頻道清單或切換為輸入。
快捷設定: 顯示快捷設定。
輸入選擇: 顯示並選擇輸入來源等。
MENU (控制選單): 顯示控制選單。
 - 2 (導航)**
在螢幕選單導航和選擇上。
返回: 返回上一頁。
主選單: 顯示主選單。
Google 助理 / 麥克風: 使用 Google 助理*2*3 或語音搜尋*3。
 - 3 (音量)**
靜音: 靜音電視。
CH +/- (頻道): 顯示資訊主頁。
Dashboard: 顯示資訊主頁。
指南: 顯示數位節目指南。
 - 4 應用按鈕**

*1 有關其他遙控器型號，請參閱線上說明指南以獲取詳情。
*2 僅限用於有限區域/國家/型號/語言。
*3 使用 Google 助理或語音搜尋需要網際網路連線。
*4 按住靜音 (靜音) 可使用輔助使用快捷鍵。

EN
Note
• Instructions about "Installing the TV to the Wall" are included within this TV's instruction manual.
• Read the supplied safety documentation for additional safety information.
Location of the identification label
Labels for the TV Model No. and Power Supply rating are located on the rear of the TV.

This television is designed for use in Hong Kong and ensured the usage in Hong Kong only.

Installing the TV to the Wall
Using the optional Wall-Mount Bracket (SU-WL850 or SU-WL450)* (not supplied)

To Customers:
For product protection and safety reasons, Sony strongly recommends that installation of your TV be performed by Sony dealers or licensed contractors. Do not attempt to install it yourself.
To Sony Dealers and Contractors:
Provide full attention to safety during the installation, periodic maintenance and examination of this product.

Wall-Mount Bracket Installation Information
For instructions on Wall-Mount Bracket installation, see the Installation Information (Wall-Mount Bracket) on the product page for your TV model. <https://www.sony-asia.com/support>
• Follow the instruction guide provided with the Wall-Mount Bracket for your model. Sufficient expertise is required in installing this TV, especially to determine the strength of the wall for withstanding the TV's weight.
• Sony is not liable for any damage or injury caused by mishandling or improper installation.
• Only qualified service personnel should carry out wall-mount installations.
• For safety reasons, it is strongly recommended that you use Sony accessories, including:
— Wall-Mount Bracket SU-WL850
— Wall-Mount Bracket SU-WL450
• Be sure to use the screws supplied with the Wall-Mount Bracket when attaching the Wall-Mount Bracket to the TV set. The supplied screws are designed as indicated by illustration when measured from the attaching surface of the Wall-Mount Bracket.
The diameter and length of the screws differ depending on the Wall-Mount Bracket model. Use of screws other than those supplied may result in internal damage to the TV set or cause it to fall, etc.
• Be sure to store the unused screws and Table-Top Stand in a safe place until you are ready to attach the Table-Top Stand. Keep the screws away from small children.
* Only for limited region/country/model.

Troubleshooting
General troubleshooting for issues like: black screen, no sound, frozen picture, TV does not respond, or network is lost, do the following steps.
1 Restart your TV by pressing the power button on the remote control for about five seconds. The TV will restart. If the TV does not recover, try unplugging the AC power cord (mains lead) then press the power button on the TV and release it. Wait for two minutes, and plug in the AC power cord (mains lead). Or, press the power button on the TV for about 40 seconds until the TV turns off.
2 Refer to the Help menu shown below.

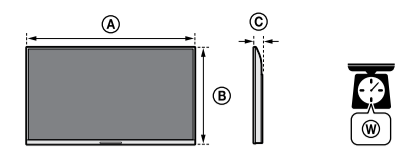

	(mm/毫米)*1			(kg/千克)*1
	(A)	(B)	(C)	(W)
KD-75X80L	1675	962	73	32.2
KD-65X80L	1452	836	72	21.7
KD-55X80L	1233	713	72	15.9
KD-50X80L	1119	649	70	12.4
KD-43X80L	964	563	69	10.1

*1 (Approx. / 大約)

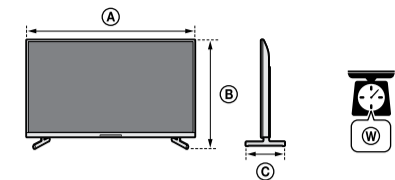

	(mm/毫米)*1			(kg/千克)*1
	(A)	(B)	(C)	(W)
KD-75X80L	1675	1036	399	33.7
KD-65X80L	1452	908	336	22.8
KD-55X80L	1233	785	336	17
KD-50X80L	1119	716	284	13.1
KD-43X80L	964	630	284	10.8

*1 (Approx. / 大約)

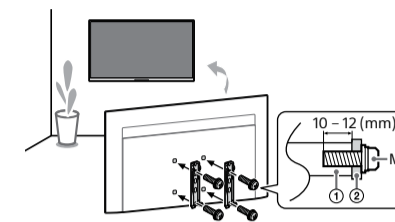

- Wall-Mount Attachment (VS) / 壁掛連接件 (VS)
- Wall-Mount Bracket / 壁掛式支架

(mm) / (毫米)

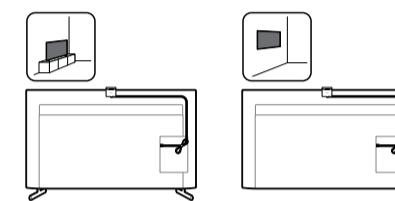

Optional Camera and Microphone Unit (not supplied) Cable Management / 選購的攝影機與麥克風組件 (無附帶) 線材管理

- Connect your TV to the Internet and perform a software update. Sony recommends you to keep your TV software updated. Software updates provide new features and performance improvements.
- Visit Sony support website (information provided at the end of the supplied safety documentation).

When you plug in the TV, the TV may not be able to turn on for a while even if you press the power button on the remote control or the TV.
It takes time to initialize the system. Wait for about one minute, then operate it again.

- The remote control does not function.
 - Replace the batteries.
- The parental lock password has been forgotten.
 - Enter 9999 for the PIN and enter the new PIN.

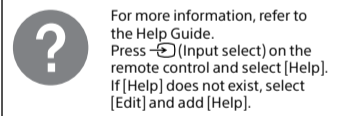

Specifications

System
Panel system
LCD (Liquid Crystal Display) Panel, LED Backlight
TV system
Analogue: I, D/K, B/G, M
Digital: DTMB
Colour system
PAL/SECAM/NTSC3.58/NTSC4.43
Channel coverage
Analogue: UHF/VHF/Cable
Digital: UHF
Sound output (W)
10 + 10
Wireless technology
Protocol IEEE 802.11a/b/g/n/ac
Bluetooth® Version 4.2
Input/Output jacks
Antenna (aerial)/cable
75 ohm external terminal for VHF/UHF
HDMI IN 1/2/3/4 (HDCP 2.3-compatible)
Video:
4096 x 2160p (50, 60 Hz)*1*2, 4096 x 2160p (24 Hz)*1, 3840 x 2160p (50, 60 Hz)*2, 3840 x 2160p (24, 25, 30 Hz), 1080p (24, 30, 50, 60 Hz), 1080i (50, 60 Hz), 720p (24, 30, 50, 60 Hz), 576p, 480p, PC Formats*3
Audio:
In eARC (Enhanced Audio Return Channel) mode Refer to the online Help Guide for details.
Except eARC mode
5.1 channel linear PCM: 32/44.1/48/88.2/96/176.4/192 kHz 16/20/24 bits, Dolby Audio, Dolby Atmos, DTS
eARC/ARC (Enhanced Audio Return Channel/ Audio Return Channel) (HDMI IN 3 only)*4
In eARC mode
Refer to the online Help Guide for details.
In ARC mode
Two channel linear PCM: 48 kHz 16 bits, Dolby Audio, Dolby Atmos, DTS
DIGITAL AUDIO OUT (OPTICAL)
Digital optical jack (Two channel linear PCM: 48 kHz 16 bits, Dolby Audio, DTS)
USB 1, 2
USB port 1 supports High Speed USB (USB 2.0)
USB port 2 supports Super Speed USB (USB 3.2 Gen 1)
LAN
10BASE-T/100BASE-TX connector (Depending on the operating environment of the network, connection speed may differ. The communication rate and quality are not guaranteed.)

Power and others
Power requirements
220 V - 240 V AC, 50 Hz
Screen size (measured diagonally) (Approx.) (inches/cm)
KD-75X80L: 75 / 189.3
KD-65X80L: 65 / 163.9
KD-55X80L: 55 / 138.8
KD-50X80L: 50 / 125.7
KD-43X80L: 43 / 108.0
Power consumption
Indicated on the rear of the TV
Standby power consumption** (W)
0.5
Display resolution (horizontal x vertical) (pixels)
3840 x 2160
Output rating
500 mA (for USB 1), 900 mA (for USB 2)
Others
Optional accessories
Wall-Mount Bracket: SU-WL850 (except KD-50X80L / 43X80L), SU-WL450
Camera and Microphone Unit: CMU-BC1
Operating temperature
0 °C - 40 °C
Operating humidity
10% - 80% RH (non-condensing)

- When 4096 x 2160p is input and [Wide mode] is set to [Normal], the resolution is displayed as 3840 x 2160p. To display 4096 x 2160p, set [Wide mode] setting to [Full 1] or [Full 2].
- Refer to the on screen menu to set [HDMI signal format].
- Refer to the online Help Guide for details.
- Connect your audio system to the HDMI IN 3 to route TV audio to your audio system.
- Specified standby power is reached after the TV finishes necessary internal processes.
- Standby power consumption will increase when your TV is connected to the network.

Note
• Optional accessories availability depends on countries/region/TV model/stock.
• Design and specifications are subject to change without notice.
• Subscriptions for services and applications may be required and additional terms, conditions and/or charges may apply when using Google Assistant.
• Power consumption will increase when the built-in MIC is enabled as it is always listening.
• Visit Sony website for more information on product specifications.

Trademark Information
Dolby, Dolby Vision, Dolby Atmos, Dolby Audio, and the double-D symbol are trademarks of Dolby Laboratories Licensing Corporation. Manufactured under license from Dolby Laboratories. Confidential unpublished works. Copyright © 1992-2022 Dolby Laboratories. All rights reserved.
Gracenote, the Gracenote logo and logotype, "Powered by Gracenote" logo are either registered trademarks or trademarks of Gracenote, Inc. in the United States and/or other countries.
For DTS patents, see <http://patents.dts.com>. Manufactured under license from DTS, Inc. DTS, Digital Surround, and the DTS logo are registered trademarks or trademarks of DTS, Inc. in the United States and other countries. © 2020 DTS, Inc. ALL RIGHTS RESERVED.
TUXERA is a registered trademark of Tuxera Inc. in the US and other countries.

CT
註
• 有關“將電視機安裝在牆上”的指示已包含在這台電視機的使用說明書。
• 有關其他安全資訊，請閱讀隨附的安全檔案。
識別標籤的位置
電視機型號和電源等級的標籤位於電視機背面。
本電視設計在香港使用，只保證能在香港使用。

將電視機安裝在牆上
使用選購的壁掛式支架 (SU-WL850 或 SU-WL450)* (非附帶)

致客戶:
出於產品保護及安全原因，Sony 強烈建議由 Sony 經銷商或授權的承包商安裝電視機。請勿嘗試自行安裝電視機。

致 Sony 經銷商和承包商:
安裝、定期維護及檢查本產品時，請充分注意安全。
壁掛式支架安裝資訊
有關壁掛式支架安裝的說明，請參閱您的電視機型號的產品頁上的安裝資訊 (壁掛式支架)。
<https://www.sony-asia.com/support>

- 請遵循適合您的型號的壁掛式支架隨附的使用說明手冊。安裝本電視機須具備充足的專業知識，確定牆壁是否能夠承受電視重量時為如此。
- 對於因錯誤操作或安裝不當引致的任何損害，Sony 概不負責。
- 僅可由合格的維修人員執行掛架安裝。
- 為了安全起見，強烈建議您使用 Sony 配件，包括：
 - 壁掛式支架 SU-WL850
 - 壁掛式支架 SU-WL450
- 將壁掛式支架安裝於電視機上時，務必使用隨附於壁掛式支架的螺絲。隨附螺絲如插圖所示設計從壁掛式支架安裝表面量起。螺絲的直徑和長度會因為壁掛式支架的型號而有所不同。使用隨附螺絲以外的螺絲可能會造成電視機內部損壞或者掉落等等。
- 務必將未使用的螺絲及桌面底座存放於安全位置，直到您已準備好連接桌面底座。請將螺絲存放在兒童接觸不到的位置。

* 僅限用於有限區域/國家/型號。

故障排除
以下問題的一般故障排除：黑螢幕、沒有聲音、凍結畫面、電視機沒有反應或網路丟失，請依照以下步驟操作。

- 按遙控器上的電源按鈕大約五秒重新啟動電視機。電視機將重新啟動。如果電視機未恢復正常，請嘗試拔下 AC 電源線，然後按電視機上的電源按鈕再鬆開此按鈕。等候兩分鐘，隨後插入 AC 電源線。或者按電視機上的電源按鈕約四十秒，直到電視機關閉。
- 請參閱如下所示的說明選單。
- 將電視機連接至網路，然後執行軟件更新。Sony 建議您不斷更新您的電視機軟件。軟件更新將提供新功能 and 效能改善。
- 造訪 Sony 支援網站 (提供的資訊在隨附安全文檔末尾)。

在插入電視機時，即使按遙控器或電視機上的電源按鈕，電視機也可能在一定時間不能開機。
系統初始化需要一定時間。等待大約一分鐘，然後再次操作。

遙控器無效。
• 更換電池。
忘記家長鎖定的密碼。
• PIN 碼輸入 9999，然後輸入新的 PIN 碼。

 ?	有關更多資訊，請參閱說明指南。按遙控器上的 ↻ （輸入選擇），選擇 [說明] 。如果 [說明] 不存在，請選擇 [編輯] 並添加 [說明] 。
--	--

規格

系統

面板系統
LCD（液晶顯示）面板，LED 背光源

電視系統

模塊：I, D/K, B/G, M

數位：DTMB

彩色系統

PAL/SECAM/NTSC3.58/NTSC4.43

頻道涵蓋範圍

模塊：UHF/VHF/齣線

數位：UHF

聲音輸出（瓦）

10 + 10

無線技術

IEEE 802.11a/b/g/n/ac 協議

藍牙® 版本 4.2

輸入／輸出插孔

天線／纜線

VHF/UHF 的 75 歐姆外接端子

HDMI IN 1/2/3/4（HDCP 2.3 相容）

視訊：

4096 × 2160p（50, 60 Hz）^{a1a2}，4096 × 2160p（24 Hz）^{a1}，3840 × 2160p（50, 60 Hz）^{a2}，3840 × 2160p（24, 25, 30 Hz），1080p（24, 30, 50, 60 Hz），1080i（50, 60 Hz），720p（24, 30, 50, 60 Hz），576p，480p，PC 格式^{a3}

音訊：

在 eARC（Enhanced Audio Return Channel）模式下

有關詳情，請參閱線上說明指南。

eARC 模式除外

5.1 聲道線性 PCM: 32/44.1/48/88.2/96/176.4/192 kHz 16/20/24 位元，Dolby Audio，Dolby

Atmos，DTS

eARC/ARC（Enhanced Audio Return Channel/Audio Return Channel）（僅限 HDMI IN 3）^{a4}

在 eARC 模式下

有關詳情，請參閱線上說明指南。

在 ARC 模式下

兩聲道線性 PCM: 48 kHz 16 位元，Dolby Audio，Dolby Atmos，DTS

↻ ↻ DIGITAL AUDIO OUT（OPTICAL）

數位光纖插孔（兩聲道線性 PCM: 48 kHz

16 位元，Dolby Audio，DTS）

↶ 1、↷ 2

USB 連接埠 1 支援高速 USB（USB 2.0）

USB 連接埠 2 支援超快速 USB（USB 3.2 Gen 1）

LAN

10BASE-T/100BASE-TX 接頭（視網絡的作業環境而定，連線速度可能不同。不保證通訊率和通訊品質。）

電源和其他規格

電源需求

220 V ~ 240 V AC，50 Hz

螢幕尺寸（對角測量）（大約）（英寸／厘米）

KD-75X80L: 75 ／ 189.3

KD-65X80L: 65 ／ 163.9

KD-55X80L: 55 ／ 138.8

KD-50X80L: 50 ／ 125.7

KD-43X80L: 43 ／ 108.0

耗電量

見電視機背面

待機耗電量^{a5a6}（瓦）

0.5

顯示解析度（水平 × 垂直）（畫素）

3840 × 2160

輸出率

500 mA（對於 USB 1），900 mA（對於 USB 2）

其他

適用的配件

壁掛式支架：SU-WL850（KD-50X80L ／ 43X80L 除外），SU-WL450

攝影機與麥克風組件：CMU-BC1

作業溫度

0 °C – 40 °C

操作溫度

10% – 80% 相對濕度（非冷凝）

x1 當輸入 4096 × 2160p 且 [寬螢幕模式] 設為 [正常模式] 時，解析度將顯示為 3840 × 2160p。要顯示 4096 × 2160p，請將 [寬螢幕模式] 設定設為 [全螢幕模式 1] 或 [全螢幕模式 2]。

x2 請參閱螢幕選單設定 [HDMI 訊號格式]。

x3 有關詳情，請參閱線上說明指南。

x4 將音訊系統連接至 HDMI IN 3 以傳送電視機音訊至音訊系統。

x5 電視機完成所需的內部處理后，達到規定的待機功率。

x6 當您的電視機連接至網絡時，待機耗電量將有所增加。

註

- 選購配件的供應視國家／區域／電視機型號／存貨而定。
- 設計與規格可能變更而不事先通知。
- 使用 Google 助理時，可能需要訂購服務和應用程式，並可能新增適用的條款、條件和／或費用。
- 內建麥克風啟用，一直在聆聽時，耗電量會增加。
- 請造訪 Sony 網站以獲取更多有關產品規格的更多資訊。

商標資訊

- Dolby、杜比、Dolby Vision、Dolby Atmos、Dolby Audio、和雙 D 符號是杜比實驗室特許公司的商標。本產品經過杜比實驗室的許可而製造。未公佈的機密作品。版權所有 © 1992-2022 杜比實驗室。保留所有權利。
- Gracenote、Gracenote 標誌和標誌字型以及“Powered by Gracenote”標誌是 Gracenote, Inc. 在美國和／或其他國家的註冊商標或商標。
- 有關 DTS 專利，請參閱 http://patents.dts.com。由 DTS, Inc. 授權製造。DTS、Digital Surround、以及 DTS 標誌是 DTS, Inc. 在美國和其他國家的註冊商標或商標。© 2020 DTS, Inc. 保留所有權利。
- TUXERA 是 Tuxera Inc. 在美國及其他國家／地區的註冊商標。

Dolby
VISION·ATMOS

gracenote
a nielsen company

dts[®]

TUXERA[®]