

SONY®

# User guide

Style Cover Window  
SCR44

# Contents

<b>Getting started</b> .....	<b>3</b>
Introduction.....	3
Overview.....	3
One-touch setup.....	3
Charging.....	4
<b>Learning the basics</b> .....	<b>5</b>
Interacting with the window.....	5
Dimming and waking up the screen.....	5
Home screen.....	6
<b>Using the Style Cover Window</b> .....	<b>7</b>
Handling incoming calls.....	7
Camera.....	7
Alarm.....	7
Music player.....	8
Widgets.....	8
Disabled smartphone features.....	8
<b>Legal information</b> .....	<b>9</b>
Using your Style Cover Window in wet and dusty conditions.....	9
Declaration of Conformity .....	11

# Getting started

## Introduction

The Style Cover Window is a smart cover for your Xperia™ Z5 Compact smartphone that lets you view and use dedicated functions. When you close the cover, the smart window function becomes active and selected widgets from your smartphone status bar or Home screen appear in the window. You can then interact with these selected widgets and associated functions. For example, you can see and read an incoming message, activate your smartphone camera, control your music, and answer an incoming call – all without opening the cover.

## Overview

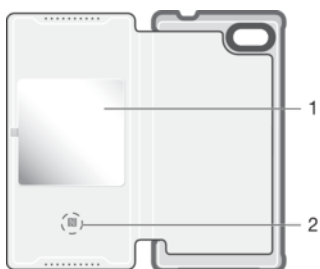

- 1 Window
- 2 NFC™ detection area

## One-touch setup

With one-touch setup, all you have to do is touch the NFC area of your smartphone to the NFC area of the Style Cover Window. The NFC function launches the setup procedure and you can then customise your smart window functions and settings.

### To set up the Style Cover Window for use

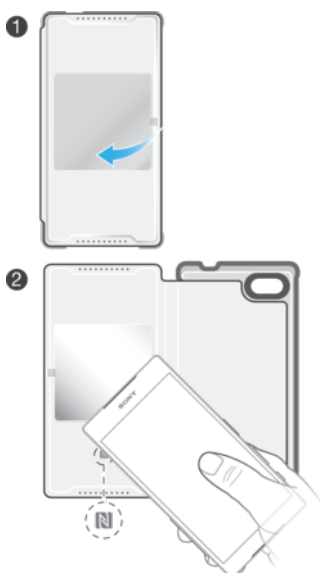

- 1 Open the Style Cover Window accessory.
- 2 Make sure that the NFC function on the phone is turned on and that the screen is active and unlocked, then place the back of the phone over the NFC detection area of the accessory, as indicated in the illustration. The NFC area of each device should touch the other.

## To attach the Style Cover Window to your phone



- 1 Position the back of the phone over the back cover of the accessory so that the camera lens is aligned with the camera lens hole of the accessory.
- 2 Press down firmly on all edges of the phone to make sure it gets properly attached.

## Charging

Before you attach the Style Cover Window and use it for the first time, make sure the smartphone that you want to use with it is fully charged. The Style Cover Window does not work if your smartphone has no power.

## To charge your phone using a DK52 USB Charging Dock

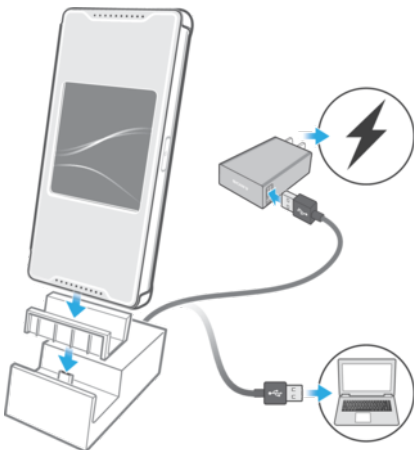

- 1 Make sure that the Style Cover Window is properly attached to your phone and that the cover is closed.
- 2 Insert the attachment into the charging dock.
- 3 Plug one end of the USB charger cable into the charging dock.
- 4 Plug the other end of the charger cable into the USB port of a computer or a phone charger. Make sure the charger or computer is connected to an active power source.
- 5 Place your phone in the dock in such a way that the charging dock connector on the phone makes contact with the connector in the dock.

# Learning the basics

## Interacting with the window

Once the Style Cover Window is set up and attached to your phone, you have to close the cover to activate the smart window function. When the smart window function is active, the display of your phone is shrunk to fit in the window of the cover. This window is similar to a mini version of your phone screen and you can interact with it in the same way. For example, you can swipe on or tap the window screen to navigate your way around.

### Swiping

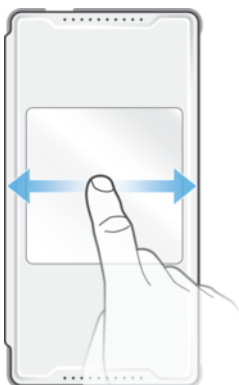

- See more widgets and other actions.

### Tapping



- Open or select an item.

## Dimming and waking up the screen

When the Style Cover Window is attached and left idle for a certain period of time, the window screen dims automatically. You can also dim the window screen manually and wake it up at any time.

### To wake up the window screen

- 1 On your Xperia™ smartphone, make sure that Tap to wake up mode is turned on. To turn it on, tap **Settings** > **Display**, then drag the slider beside **Tap to wake up** to the right.
- 2 Double-tap the window screen or briefly press the power key.

### To dim the window screen manually

- Briefly press the power key.

## Home screen

When the Style Cover Window is attached and the smart window function is active, a Home screen appears in the window. This Home screen is the main screen from which you can navigate to other screens and take various actions. It is similar to the Home screen of your phone. From here, you can, for example, view notifications of missed calls or unread SMS messages and take pictures.

# Using the Style Cover Window

## Handling incoming calls

When a call comes in on your smartphone, you can see who is calling on the screen of the Style Cover Window. You can then interact with the window screen to accept or reject the call.

### To answer an incoming call

- To accept the incoming call, slide from left to right on the window screen.

### To decline an incoming call

- Slide from right to left on the window screen.

## Answering a video call

When a video call comes in while the Style Cover Window is attached, you are prompted to open the cover to launch the front camera on your phone.



### To answer a video call

- Open the cover of the Style Cover Window and look into the front camera on your phone.

## Camera

From the Home screen of the Style Cover Window, you can launch the camera application and take pictures in portrait or landscape orientation.



### To take a photo from the Home screen of the Style Cover Window

- 1 To activate the window screen, briefly press the power key .
- 2 To activate the camera, touch and hold , then drag upwards.
- 3 After the camera opens, locate your subject in the viewfinder.
- 4 Once you are ready to take the photo, tap .

## Alarm

You can view an activated alarm from the Home screen of the Style Cover Window. To set an alarm, you must first access the smartphone, that is, when the cover is open or not attached.

### To set an alarm

- 1 Open the front cover of your accessory so that you can access the Home screen of your phone directly.
- 2 From the Home screen of your phone, tap .
- 3 Find and tap **Alarm & clock**.
- 4 Tap .
- 5 Tap **Time** and adjust the time by scrolling up and down.
- 6 Tap **Set**.
- 7 If desired, edit other alarm settings.
- 8 Tap **Done**. This alarm is now displayed on the Home screen of the Style Cover Window.

### To snooze an alarm when it sounds

- Tap **Snooze** when it appears on the window screen.

### To turn off an alarm when it sounds

- On the window screen, drag  to the right.

### To turn off a snoozed alarm

- 1 Open the Style Cover Window.
- 2 From the Home screen of your phone, drag down the status bar to open the Notification panel, then tap .

## Music player

You can access the music player application directly from the Home screen of the Style Cover Window.



### To access the music player

- Swipe from right to left on the Home screen of the Style Cover Window.

## Widgets

Widgets are small applications that you can use directly on the window screen. They also function as shortcuts. For example, the Calendar widget allows you to see basic calendar information directly on the window screen. You can download additional widgets from Google Play™.

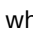

### To add a widget to the window screen

- 1 To activate the window screen, briefly press the power key .
  - 2 Swipe to the right until  appears, then tap it. You are then prompted to open the cover to add a widget directly on your phone.
  - 3 If required, enter your PIN code, pattern or password to unlock the screen of your phone.
  - 4 Find and tap the widget that you want to add.
- ! The items that appear when you tap  are available by default and cannot be modified.

### To move a widget on the window screen

- 1 To activate the window screen, briefly press the power key .
- 2 Touch and hold the widget that you want to move, then drag it to the new location.

### To remove a widget from the window screen

- 1 To activate the window screen, briefly press the power key .
  - 2 Touch and hold the widget that you want to remove, then drag it to .
- 💡 The camera icon and the music player appear on the screen by default and cannot be removed.

## Disabled smartphone features

- ! The Smart call handling and Glove mode features get disabled when the cover of your accessory is closed. For more information about these features, refer to the User guide for your phone.



# Legal information

## Using your Style Cover Window in wet and dusty conditions

Your Style Cover Window is waterproof in compliance with the Ingress Protection (IP) ratings IPX5 and IPX8, as explained in the table below.

These specific IP ratings mean that your Style Cover Window is protected against low pressure water stream as well as against the effects of immersion for 30 minutes in fresh (non-saline) water up to 1.5 metres deep.

Even if your Style Cover Window is resistant to water, you should avoid using it unnecessarily in or under water and should avoid exposing it to moist environments with extreme high or low temperatures and high humidity.

Never immerse your Style Cover Window in hot water, non-fresh water (for example, spring water, chlorinated pool water and sea water) or other kinds of water that could damage it. Also, never expose the Style Cover Window to any liquid chemicals, for example, detergent, alcohol and other abrasive liquids such as juice, vinegar and ketchup. After exposure to non-fresh water, rinse your Style Cover Window using fresh water.

If your Style Cover Window gets exposed to water, make sure it is completely dry before using it again. For example, if the Style Cover Window has not completely dried, it may not respond when you tap the window, or functions such as data transfer and calling might be negatively impacted.

Do not attach the Style Cover Window to or remove it from your Xperia™ device using excessive force or a method not described in this User guide.

Use a soft, dry cloth for cleaning all areas of your Style Cover Window. To prevent colour fading, do not wipe the accessory with alcohol, thinner, benzene or any kind of detergent.

Do not expose the Style Cover Window unnecessarily to environments with excessive dust, sand and mud.

If sand, mud or dust gets stuck between the front cover of the Style Cover Window and your Xperia™ device, wipe it off with a soft cloth. Otherwise, there is a risk that your Xperia™ device and the Style Cover Window might incur scratch damage.

There is a possibility of discolouration or colour migration due to friction, sweating and exposure to non-fresh water. Be mindful of this if you are using the Style Cover Window in close proximity to fabrics and other materials.

- ! These instructions for use in wet and dusty conditions apply only to use of the Style Cover Window. Your Xperia™ device may have its own instructions and restrictions on use in wet and dusty conditions. Please ensure you check these too before exposing the device to such conditions.

Your warranty does not cover damage or defects caused by abuse or improper use of your Style Cover Window (including use in environments where the relevant IP rating limitations are exceeded). If you have any further questions about the use of your accessory, refer to our Customer support service for help.

## Ingress Protection Rating

Your Style Cover Window has an IP rating in accordance with IEC Standard 60529, which means it has undergone certified tests to measure its resistance levels to both dust and water. The first digit in the two-digit IP rating indicates the level of protection against solid objects, including dust. The second digit indicates how resistant the device is to water.

Resistance to solid objects and dust	Resistance to water
IP0X: No special protection	IPX0. No special protection

IP1X. Protected against solid objects > 50 mm in diameter	IPX1. Protected against dripping water
IP2X. Protected against solid objects > 12.5 mm in diameter	IPX2. Protected against dripping water when tilted up to 15 degrees from normal position
IP3X. Protected against solid objects > 2.5 mm in diameter	IPX3. Protected against spraying water
IP4X. Protected against solid objects > 1 mm in diameter	IPX4. Protected against splashing water
IP5X. Protected against dust; limited ingress (no harmful deposit)	IPX5. Protected against water jet spray for at least 3 minutes
IP6X. Dust tight	IPX6. Protected against heavy jet spray for at least 3 minutes
	IPX7. Protected against the effects of immersion in up to 1 metre of water for 30 minutes
	IPX8. Protected against the effects of continued immersion in water depths greater than 1 metre. The exact conditions are specified for each device by the manufacturer.

## Sony SCR44

Prior to use, please read the *Important information* leaflet separately provided.

This User guide is published by Sony Mobile Communications Inc. or its local affiliated company, without any warranty. Improvements and changes to this User guide necessitated by typographical errors, inaccuracies of current information, or improvements to programs and/or equipment, may be made by Sony Mobile Communications Inc. at any time and without notice. Such changes will, however, be incorporated into new editions of this User guide.

All rights reserved.

©2015 Sony Mobile Communications Inc.

Sony is the trademark or registered trademark of Sony Corporation.

All product and company names mentioned herein are the trademarks or registered trademarks of their respective owners. Any rights not expressly granted herein are reserved. All other trademarks are property of their respective owners.

Visit [www.sonymobile.com](http://www.sonymobile.com) for more information.

All illustrations are for illustration only and may not accurately depict the actual accessory.

## Declaration of Conformity

We, **Sony Mobile Communications AB** of  
Nya Vattentorget  
SE-221 88 Lund, Sweden,  
declare under our sole responsibility that our product

### **Sony type AI-0094**

and in combination with our accessories, to which this declaration relates is in conformity with the appropriate standards

Spectrum	EMC	Safety
EN 302 291-2:V1.1.1	EN 301 489-7:V1.3.1	EN 60950-1:2006 +A11:2009+A1:2010+A12:2011+A2:2013
	EN 301 489-3:V1.6.1	

following the provisions of, Radio Equipment and Telecommunication Terminal Equipment directive **1999/5/EC**.

**Lund, July 2015**

**CE 0682**



Fredrik Björk  
*Head of Product Compliance Lund*

## FCC Statement

This device complies with Part 15 of the FCC rules. Operation is subject to the following two conditions: (1) This device may not cause harmful interference, and (2) This device must accept any interference received, including interference that may cause undesired operation.

Any change or modification not expressly approved by Sony may void the user's authority to operate the equipment.

This equipment has been tested and found to comply with the limits for a Class B digital device, pursuant to Part 15 of the FCC Rules. These limits are designed to provide reasonable protection against harmful interference in a residential installation. This equipment generates, uses and can radiate radio frequency energy and, if not installed and used in accordance with the instructions, may cause harmful interference to radio communications. However, there is no guarantee that interference will not occur in a particular installation.

If this equipment does cause harmful interference to radio or television reception, which can be determined by turning the equipment off and on, the user is encouraged to try to correct the interference by one or more of the following measures:

- Reorient or relocate the receiving antenna.
- Increase the separation between the equipment and receiver.
- Connect the equipment into an outlet on a circuit different from that to which the receiver is connected.
- Consult the dealer or an experienced radio/TV technician for help.

## Industry Canada Statement

This device complies with RSS-210 of Industry Canada.

Operation is subject to the following two conditions: (1) this device may not cause interference, and (2) this device must accept any interference, including interference that may cause undesired operation of the device.

This Class B digital apparatus complies with Canadian ICES-003.

## Avis d'industrie Canada

Le présent appareil est conforme aux CNR d'Industrie Canada applicables aux appareils radio exempts de licence.

L'exploitation est autorisée aux deux conditions suivantes: (1) l'appareil ne doit pas produire de brouillage, et, and (2) l'utilisateur de l'appareil doit accepter tout brouillage radioélectrique subi, même si le brouillage est susceptible d'en compromettre le fonctionnement.

Cet appareil numérique de la classe B est conforme à la norme NMB-003 du Canada.