

**SONY**<sup>®</sup>

# User guide

Dual USB Car Charger  
AN430

# Contents

|                                   |          |
|-----------------------------------|----------|
| <b>Introduction.....</b>          | <b>3</b> |
| Charging made easy.....           | 3        |
| <b>Using the Car Charger.....</b> | <b>4</b> |
| Charging your devices.....        | 4        |
| <b>Legal information.....</b>     | <b>5</b> |

# Introduction

## Charging made easy

The Car Charger AN430 lets you charge up to two devices at the same time from the cigarette lighter socket of a car. You can use the supplied **USB Type-C™** cable to charge a range of Xperia™ devices, Bluetooth® headsets, tablets and more. You can also connect a USB cable to the USB ports on the charger to charge other compatible devices.

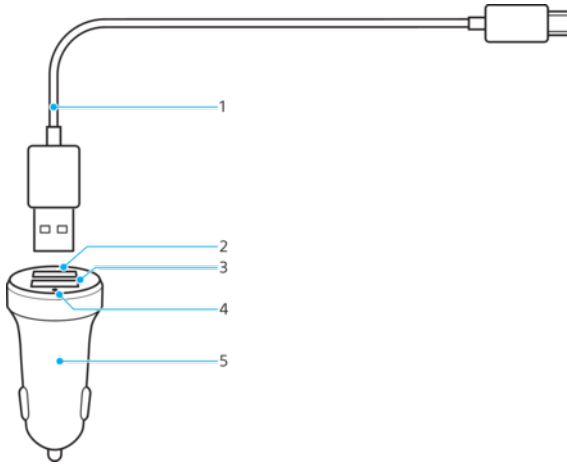

- |   |                          |
|---|--------------------------|
| 1 | <b>USB Type-C™</b> cable |
| 2 | USB port                 |
| 3 | USB port                 |
| 4 | Notification light       |
| 5 | Power plug               |

# Using the Car Charger

## Charging your devices

To charge a device using the Car Charger

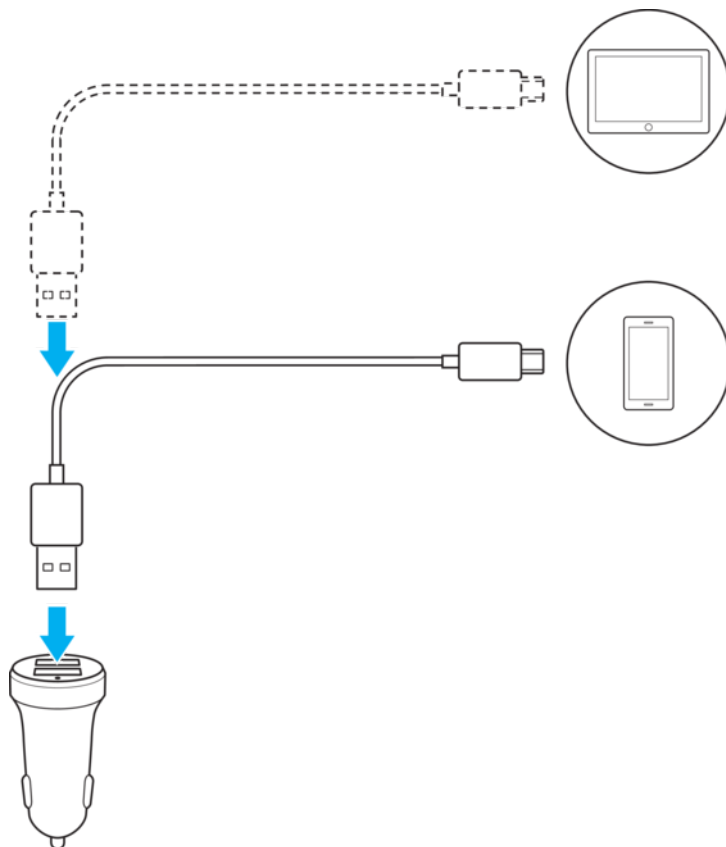

- 1 Connect the **USB Type-C™** connector to the device that you want to charge.
  - 2 Connect the USB Type-A connector to the USB port of the Car Charger.
  - 3 Connect the Car Charger power plug to the cigarette lighter socket of a car. The notification light illuminates and remains lit when power is available.
  - 4 To charge a second device, connect a USB cable to the available USB port of the Car Charger. Connect the other end of the cable to the second device.
- ! For the Car Charger to function properly, it must be fully inserted into the cigarette lighter socket and in full contact with the anode and cathode connectors.
- 💡 In some cars, the ignition must be turned on before power becomes available to the cigarette lighter.

# Legal information

## Sony AN430

Prior to use, please read the *Important information* leaflet separately provided.

This User guide is published by Sony Mobile Communications Inc. or its local affiliated company, without any warranty. Improvements and changes to this User guide necessitated by typographical errors, inaccuracies of current information, or improvements to programs and/or equipment, may be made by Sony Mobile Communications Inc. at any time and without notice. Such changes will, however, be incorporated into new editions of this User guide.

All rights reserved.

©2017 Sony Mobile Communications Inc.

Sony is the trademark or registered trademark of Sony Corporation.

All product and company names mentioned herein are the trademarks or registered trademarks of their respective owners. Any rights not expressly granted herein are reserved. All other trademarks are property of their respective owners.

Visit [www.sonymobile.com](http://www.sonymobile.com) for more information.

All illustrations are for illustration only and may not accurately depict the actual accessory.