

IMPORTANT! **PLEASE READ BEFORE YOU START**

These easy instructions are intended to guide you through the replacement process.

- ✓ To avoid electric shock please make sure product is turned off and disconnected from the power source. Remove jewelry before you begin work to avoid scratching the surface of your desktop computer.*
- ✓ Place your desktop computer on a clean, stable and covered surface to avoid damage to the computer's case.*
- ✓ Follow the ESD (Electrostatic Discharge) damage prevention instructions:
 - Hold parts by the edges, away from exposed circuitry when possible.
 - Do not walk around excessively as this promotes static build-up.
- ✓ The appearance of the electronic components shown in the illustrations may be different from the components shipped. This slight difference does not affect the accuracy of these instructions.

* Sony is not responsible for any loss of data associated with your computer or any damage caused by incorrect handling of the computer under these procedures. The terms of your Sony Limited Warranty continue to apply.



Step 1. CAUTION! ⚠
Disconnect the power cord.
Failure to do so can result in
unit damage or personal
injury.

Place your PC on a solid
surface with the left side panel
facing towards you.



Step 2. To remove the side panel, locate
the release tab and press it down as
shown. Lift up the panel and place it aside.

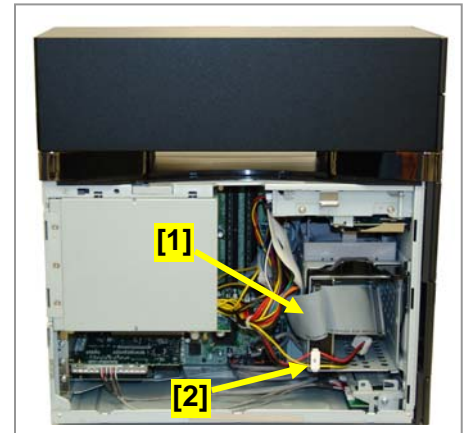

Step 3. The PC should be with
its inside facing to you. Identify
the location of the hard drive's
connections as shown: the IDE
cable is [1] and power cable [2].

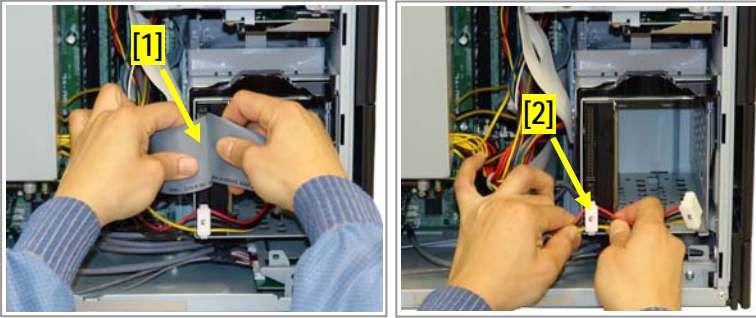

Step 4. Proceed to disconnect the IDE cable [1] and power cable [2] from the hard drive. **IMPORTANT! Some force may be required to initiate the removal of the cables. Take caution not to damage the cables.** Pull with equal force on both sides of each cable to remove them as shown above.

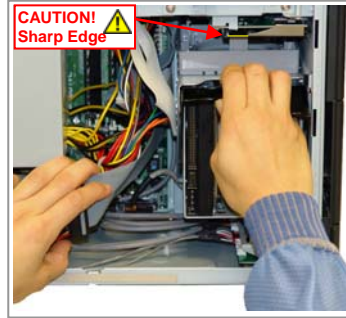

Step 5. Release the HDD bracket enclosure by pulling the black handle as shown. Some force may be required to unlock the handle. Slide the complete HDD bracket enclosure out of the unit.

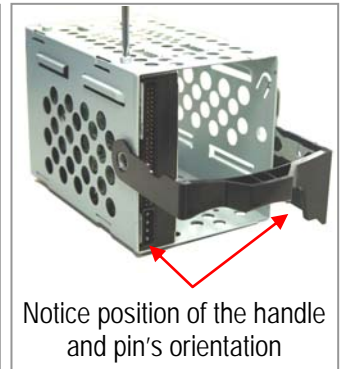
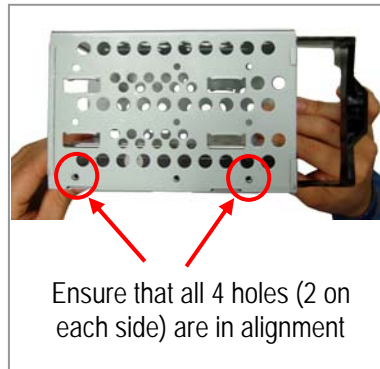
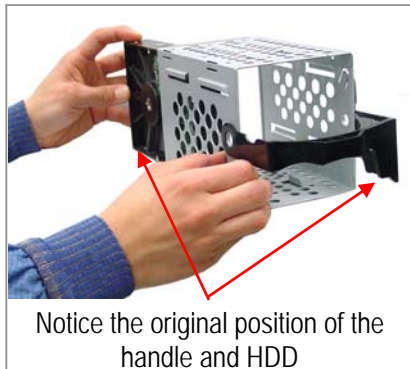
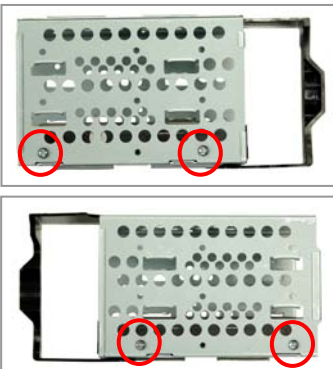

Step 6. Using the enclosed magnetic screwdriver, remove the four (4) screws that secure the hard drive into the bracket enclosure. **IMPORTANT! Before proceeding, take note of original position of the drive inside the bracket.** Slide out the original drive.

Step 7. Slide new hard drive inside the bracket enclosure with all holes in alignment. Reinstall the four (4) screws previously removed, securing new drive into the bracket.

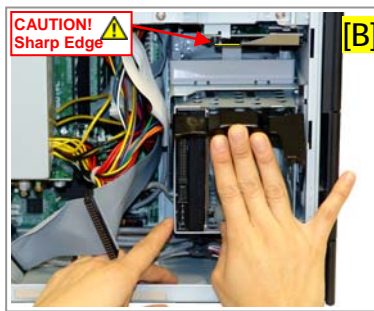

Step 8. [A] Reinstall the HDD bracket enclosure being careful to align the guides. Some force may be required to slide the HDD bracket enclosure into the unit. [B] Lock the black handle in place.

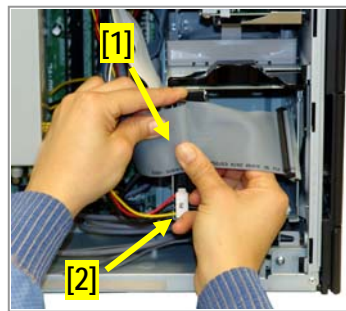

Step 9. Reconnect the IDE cable [1] and power cable [2] to the hard drive. Reinstall side panel removed in step 2. Connect your PC and continue with the recovery instructions. Return the old hard drive to Sony following the included shipping instructions.