

## AC Adaptor/Charger

### Operating Instructions

### Manual de instrucciones

### Mode d'emploi

### 使用说明书

### Owner's Record

The model and serial numbers are located on the bottom of the unit. Record the serial number in the space provided below. Refer to these numbers whenever you call upon your Sony dealer regarding this product.

Model No. AC-VQ50 Serial No.



## AC-VQ50

Sony Corporation © 2003 Printed in Japan

### WARNING

To prevent fire or shock hazard, do not expose the unit to rain or moisture.

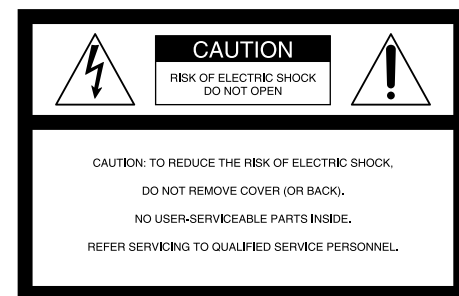

This symbol is intended to alert the user to the presence of uninsulated "Dangerous voltage" within the product's enclosure that may be of sufficient magnitude to constitute a risk of electric shock to persons.

This symbol is intended to alert the user to the presence of important operating and maintenance (servicing) instructions in the literature accompanying the appliance.

### CAUTION

You are cautioned that any changes or modifications not expressly approved in this manual could void your authority to operate this equipment.

### NOTICE FOR THE CUSTOMERS IN THE USA AND CANADA

The Graphical Symbols with Supplemental Marking is located on the bottom of the unit.

### Note:

This equipment has been tested and found to comply with the limits for a Class B digital device, pursuant to Part 15 of the FCC Rules. These limits are designed to provide reasonable protection against harmful interference in a residential installation. This equipment generates, uses, and can radiate radio frequency energy and, if not installed and used in accordance with the instructions, may cause harmful interference to radio communications. However, there is no guarantee that interference will not occur in a particular installation. If this equipment does cause harmful interference to radio or television reception, which can be determined by turning the equipment off and on, the user is encouraged to try to correct the interference by one or more of the following measures:

- Reorient or relocate the receiving antenna.
- Increase the separation between the equipment and receiver.
- Connect the equipment into an outlet on a circuit different from that to which the receiver is connected.
- Consult the dealer or an experienced radio/TV technician for help.

### NOTICE FOR THE CUSTOMERS IN THE UNITED KINGDOM

A moulded plug complying with BS 1363 is fitted to this equipment for your safety and convenience.

Should the fuse in the plug supplied need to be replaced, a fuse of the same rating as the supplied one and approved by ASTA or BSI to BS1362 (i.e., marked with ☉ or ⚡ mark) must be used.

If the plug supplied with this equipment has a detachable fuse cover, be sure to attach the fuse cover after you change the fuse. Never use the plug without the fuse cover. If you should lose the fuse cover, please contact your nearest Sony service station.

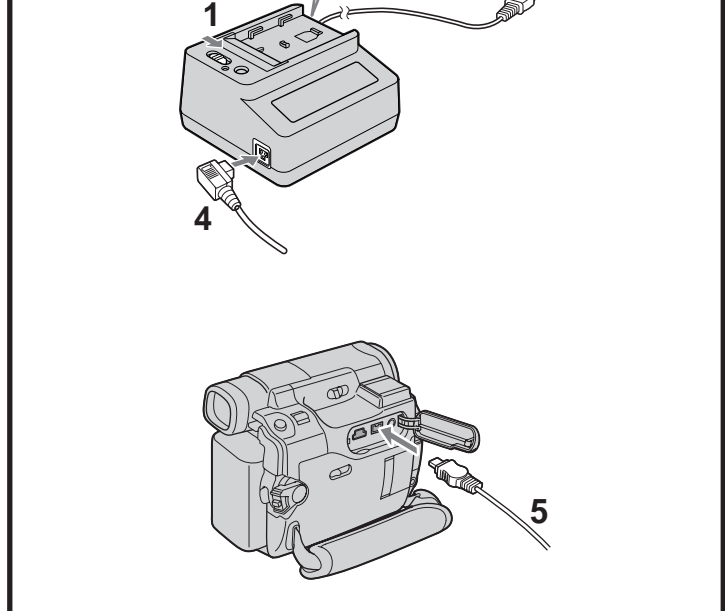
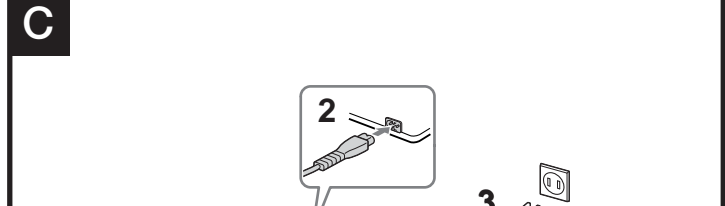
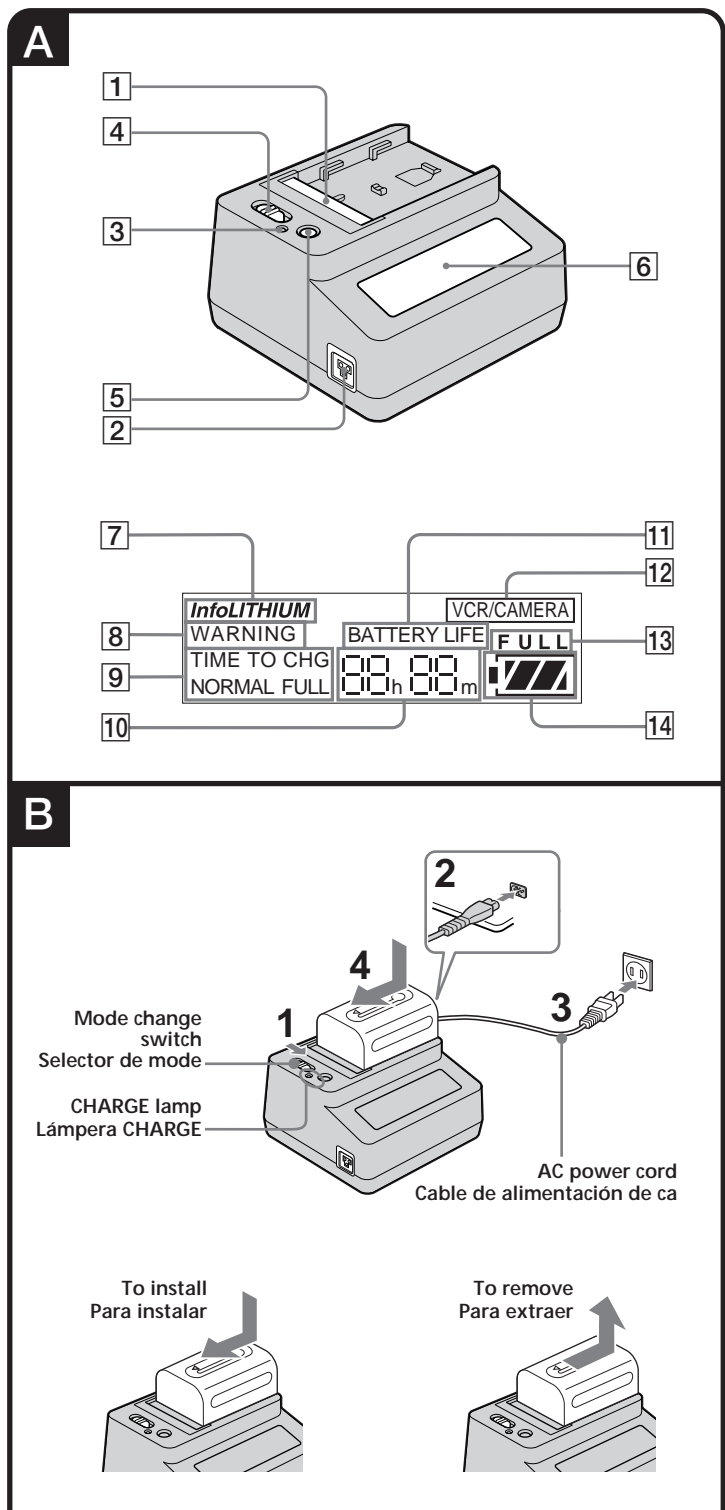

Thank you for purchasing the Sony AC adaptor/charger.

Before operating the unit, please read this manual thoroughly and retain it for future reference.

The AC-VQ50 AC adaptor/charger can be used as follows:

- To charge a lithium ion type battery pack. Ni-Cd/Ni-MH type batteries are not rechargeable.
- The following functions are available with the "InfoLITHIUM" battery pack:
  - Quickly charging
  - Remaining charge time display
  - To enable the power supply to the video equipment with the house current, connection cords are included with this unit.

### What is the "InfoLITHIUM" ?

The "InfoLITHIUM" is a lithium ion battery pack which can exchange data with compatible electronic equipment about its battery consumption. Sony recommends that you use the "InfoLITHIUM" battery pack (M series) with electronic equipment having the mark.

"InfoLITHIUM" is a trademark of Sony Corporation.

## WARNING

To prevent fire or shock hazard, do not expose the unit to rain or moisture. To avoid electrical shock, do not open the cabinet. Refer servicing to qualified personnel only.

AC power cord must be changed only at the qualified service shop.

### For the customers in Canada

### CAUTION

TO PREVENT ELECTRIC SHOCK, MATCH WIDE BLADE OF PLUG TO WIDE SLOT, FULLY INSERT.

## Notes on Use

### About the AC power cord plug

The AC-VQ50 comes in two models, differentiated by the shape of the AC power cord plug.

Model	Shape of the plug
Model for USA/Canada	Polarized
Model for other countries/regions	Non polarized

The model for USA and Canada: One blade of the plug is wider than the other for the purpose of safety and will fit into the wall outlet only one way. If you are unable to insert the plug fully into the outlet, contact your dealer.

### About the remaining battery time

While charging the battery pack, this unit will show the remaining battery time with your video equipment, etc. on the following conditions.

- Using the "InfoLITHIUM" battery pack
  - Using the electronic equipment having the mark
  - Make sure that you use the battery pack having the mark.
- Consult the operating instructions supplied with your video equipment if it is applied to "InfoLITHIUM".

If you use this battery pack with electronic equipment not having the mark, the remaining battery capacity will not be indicated in minutes.

\*The indication may not be accurate depending on the condition and environment which the equipment is used under

### Warranty for Recorded Content

Contents of the recording cannot be compensated if recording or playback is not made due to a malfunction of the battery pack, AC adaptor, AC adaptor/charger, etc.

## We cannot provide compensation for image content

We cannot provide compensation for recorded content such as images and sound, if images are not recorded or played back due to a malfunction in the AC adapter/charger, etc.

## Charging

Use only a lithium ion type battery pack. This unit cannot be used to charge a Ni-Cd/Ni-MH type battery pack.

- Attach the battery pack firmly.
- Charge the battery pack on a flat surface without vibration.

### Charging temperature

- To provide maximum battery efficiency, the recommended temperature range when charging is +10°C to +30°C (+50°F to +86°F).
- This unit complies with quick charging, but charging outside the recommended temperature range will lead to longer charging times in order to protect the battery pack. Once the charging time has been extended, it will not return to quick charging even if the temperature is brought within the recommended temperature range. Reattach the battery and then recharge it.

### Others

- The nameplate indicating operating voltage, power consumption, etc. is located on the bottom.
- The negligible amount of electric current will flow into the AC adaptor/charger as long as the AC adaptor/charger is plugged into the wall outlet.
- Unplug the unit from the wall outlet if it will not be used for extended period of time. To disconnect the cord, pull it out by the plug. Never pull the cord itself.
- Do not operate the unit with a damaged cord or if it has been dropped or damaged.
- Use this unit near to a wall outlet. This is to ensure that the power plug can be immediately unplugged from the wall outlet to turn the power off if some abnormality occurs during use.
- Be sure that nothing metallic comes into contact with the metal parts of the unit or connecting plate. If it does, a short may occur and the unit may be damaged.
- Always keep the metal contacts clean.
- Do not disassemble or convert the unit.
- Do not apply mechanical shock or drop the unit.
- While the unit is in use, it gets warm. But this is normal.
- Keep the unit away from AM receivers, because it will disturb AM reception.
- Do not place the unit in a location where it is:
  - Extremely hot or cold
  - Dusty or dirty
  - Very humid
  - Vibrating
- Placing this unit in locations near hearing apparatus may cause this unit to deform or malfunction.

If any difficulty should arise, unplug the unit and contact your nearest Sony dealer.

## Troubleshooting

### Video equipmet does not work.

- The power plug is disconnected from the wall outlet.
- Insert into the wall outlet.
- The connector cable is not properly connected.
- Connect properly.
- The mode change switch is set to CHARGE.
- Set the mode change switch to VCR/CAMERA.

The battery is not charged.

- The mode change switch is set to VCR/CAMERA.
- Set the mode change switch to CHARGE.

Power immediately turns off even though there is sufficient remaining battery power, or the displayed remaining time differs from the actual time.

- Fully charge again.
- The remaining battery power will be correctly displayed.

The display is not switched.

- Read "About the remaining battery time".

The CHARGE lamp blinks, and "WARNING" is displayed in the display window.

- Check through the following chart.

Remove the battery pack from this unit, then install the same battery pack again.

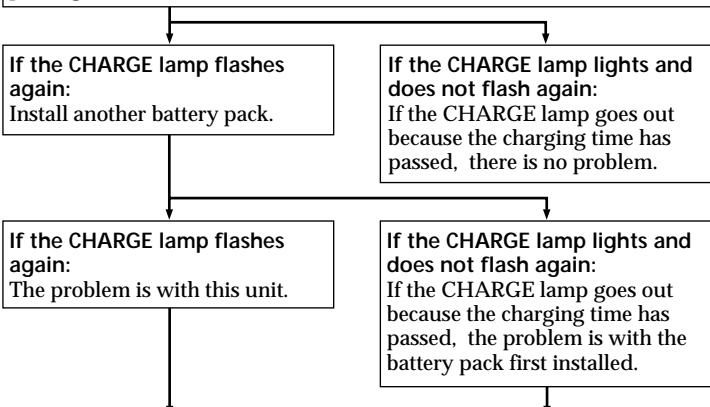

Please contact your nearest Sony dealer in connection with the product with the problem.

## Specifications

Input rating	100 - 240 V AC, 50/60 Hz 25 W, 0.40 A (VCR), 0.35 A (BATT) DC OUT: 8.4 V, 2.0 A (VCR) 8.4 V, 1.1 A (BATT)
Output rating	0°C to +40°C (+32°F to +104°F) +20°C to +60°C (+68°F to +140°F) Approx. 88 × 47 × 80 mm (w/h/d) (3 1/2 × 1 7/8 × 3 1/4 inches)
Operating temperature	Approx. 180 g (6.4oz)
Storage temperature	Connecting cord DK-215 (I), AC power cord (I)
Dimensions	
Mass	
Supplied accessories	

Design and specifications are subject to change without notice.

Use a commercially available AC plug adaptor. If necessary, depending on the design of the wall outlet.

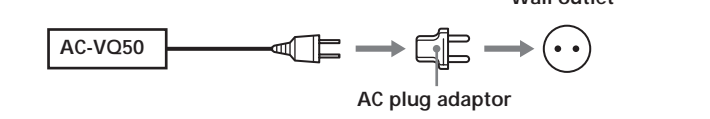

Do not connect the battery charger to a voltage adaptor (travel converter) for overseas travel. This may result in overheating or other malfunction.

## Identifying the parts

- 1 Terminal shutter
- 2 DC OUT connector
- 3 CHARGE lamp
- 4 Mode change switch
- 5 DISPLAY change button
- 6 Display window
- 7 "InfoLITHIUM" indicator
- 8 WARNING indicator
- 9 TIME TO CHG (charge) indicator
- 10 Time indicator
- 11 BATTERY LIFE (battery remaining time) indicator
- 12 VCR/CAMERA indicator
- 13 Full charge indicator
- 14 Remaining battery indicator

See illustration A.

## To Charge the Battery Pack

See illustration B.

- 1 Set the mode change switch to CHARGE.
- 2 Connect the power cord to this unit.
- 3 Connect the power cord to a wall outlet. The beep sounds and the display window lights up.
- 4 Install the battery pack. Charging begins. When the remaining battery indicator becomes and the CHARGE lamp lights up, normal charge is completed. For full charge, which allows you to use the battery slightly longer than "normal charge", leave the battery pack attached until the CHARGE lamp goes out.

### Removing battery indicator

Normal charge	Full charge

## To Install the battery pack

- 1 Place the battery pack on this unit with the ◀ mark facing the terminal shutter.
- 2 Slide the battery pack in the direction of the arrow. Press the battery pack until the terminal shutter enters completely into this unit.

## To remove the battery pack

Slide it in the direction opposite to the operation when you attach it to this unit, and lift the battery pack above.

### Notes

- Do not lift the unit by gripping the battery pack.
- Do not apply shock to the terminal shutter. When you install the battery pack, be sure not to strike it to the terminal shutter.
- Be careful not to pinch your fingers during attachment and removal of the battery pack.

## Charging time

The following table shows the charging time for the battery pack which is discharged completely.

battery pack	NP-FM30	NP-FM50	NP-FM70/QM70	NP-QM71/QM7D	NP-FM80	NP-FM81/QM81/QM8D
full charging time	100	105	150	175	195	205
normal charging time	(40)	(45)	(90)	(115)	(135)	(145)

### Quick charge

- Approximate minutes at +25°C (+77°F) to charge an empty battery pack used with this unit.
- Approximate minutes to charge an empty battery pack fully (Full charge) (Normal charge).
- Numbers in parentheses indicate the time when you charge normally.
- To ascertain the battery life, refer to the instruction manual of the video equipment which you use.
- The charging time may differ depending on the condition of the battery pack or the temperature of the environment.

### To use the battery pack quickly

You can remove the battery pack from this unit to use even though the charging is not completed yet. However, the time that the battery pack can be used differs depending on the charging time.

### Notes

- When the mode change switch is set to VCR/CAMERA during charging, charging stops.
- If the CHARGE lamp does not light or flash, check that the battery pack is correctly attached to the AC adaptor/charger. If it is not attached it will not be charged.

## To Check Charging

While charging, you can check the charging time on the display. After starting charging in a minute, BATTERY LIFE lights up on the display. The displayed remaining time is the approximate time when taking photographs with the viewfinder. The remaining time is shorter when the LCD display is used.

The remaining battery time may not be displayed depending on using conditions and circumstances of your video camera recorder and of the battery. See "About the remaining battery time" for more details.

### Press DISPLAY while charging is underway.

Each time you press DISPLAY, the display changes as follows.

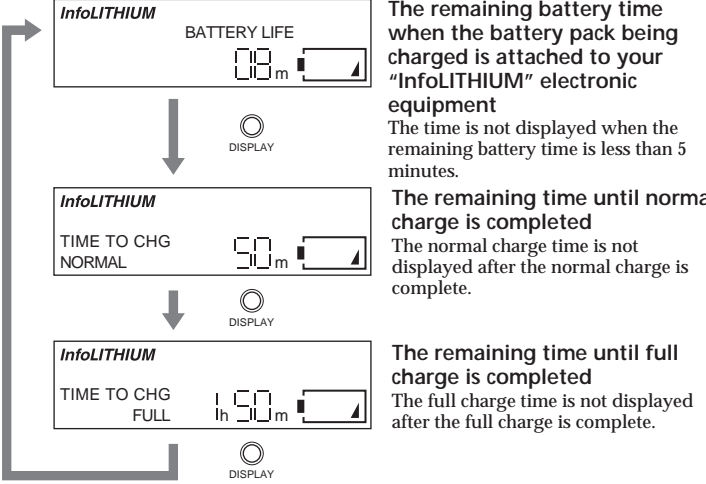

### Notes

- To display the remaining battery time of a new battery, attach it to your video camera recorder and use it for about 20 seconds. Then, charge the battery with this unit and start charging, and the remaining battery time will be displayed.
- The time display shows the approximate time when charging at +25°C. The time display may differ from the actual charging time depending on using conditions and circumstances.
- The time display may show "----" in the following cases. However, the unit is not malfunctioning.
  - The remaining battery time is less than 5 minutes.
  - There is a difference between the displayed time and actual charging time. Even if this happens, continue charging.
- Full charge requires about 1 hour after normal charge is completed. If you remove the battery pack between normal charge and full charge, the charging time may not be displayed properly in the next charging.
- When a battery that has not been used for a long time is charged, the displayed remaining time and full charge time sometimes differ from the actual times. This is not a malfunction. If this happens, charge the battery pack until it is fully charged. The correct times can be displayed.
- When you attach a fully charged battery pack to this unit, "TIME TO CHG FULL 1h" may appear on the display. However, this is not a malfunction.
- You may wait for a while after pressing DISPLAY until the display shows the time indication.

## To Operate Video Equipment

See illustration C.

The AC adaptor/charger can supply power from a wall outlet. For details of the connection, refer to the instruction manual of the video equipment.

- 1 Set the mode change switch to VCR/CAMERA.
- 2 Connect the power cord to this unit.
- 3 Connect the power cord to a wall outlet.
- 4 Connect the connecting cord to DC OUT connector of this unit.
- 5 Open the DC IN terminal cover of the video equipment, connect the connecting cord to the DC IN terminal.

For details of the direction of the connecting cord, refer to the instruction manual of the video equipment.

### Notes

- If you set the mode change switch to CHARGE while operating the video equipment, the power supply to the video equipment stops.
- You cannot charge the battery pack attached to AC adaptor/charger while operating the power to the video equipment.
- Keep AC adaptor/charger away from the video equipment if the picture is disturbed.

Gracias por adquirir el adaptador/cargador de ca de Sony.

Antes de utilizar la unidad, lea detenidamente este manual, y consérvelo para futuras referencias.

El adaptador/cargador de ca AC-VQ50 podrá utilizarse de la forma siguiente:

- Para cargar una batería de tipo iones de litio. Las pilas de tipo Ni-Cd/Ni-MH no podrán recargarse.
- Cuando utilice una batería "InfoLITHIUM", estarán disponibles las funciones siguientes:
  - Carga rápida
  - Visualización del tiempo de carga restante
- Con esta unidad se incluyen cables de conexión para poder alimentar equipos de video con la corriente de la red.

### Descripción del paquete de batería "InfoLITHIUM"

"InfoLITHIUM" es una batería de iones de litio que puede intercambiar información con equipos electrónicos compatibles sobre su consumo de batería. Sony recomienda utilizar la batería "InfoLITHIUM" (serie M) con equipos electrónicos que posean la marca .

"InfoLITHIUM" es una marca comercial de Sony Corporation.

## ADVERTENCIA

Para evitar incendios o el riesgo de electrocución, no exponga la unidad a la lluvia ni a la humedad.

Para evitar descargas eléctricas, no abra la unidad. En caso de avería, solicite los servicios de personal cualificado solamente.

El cable de alimentación de ca solamente deberá ser cambiado en un taller de reparaciones cualificado.

## Notas sobre la utilización

### Sobre el enchufe del cable de alimentación de ca

Existen dos modelos de AC-VQ50, que se diferencian por la forma del enchufe del cable de alimentación de ca

Modelo	Forma del enchufe
Modelo para EE.UU./Canadá	Polarizado
Modelo para otros países/regiones	No polarizado

Modelo para EE.UU. y Canadá: Por motivos de seguridad, una cuchilla del enchufe es más ancha que la otra, y solamente encajará en el tomacorriente de una sola forma. Si no puede insertar firmemente el enchufe en el tomacorriente, póngase en contacto con su proveedor.

### Sobre el tiempo restante de la batería

Durante la carga de la batería, esta unidad mostrará el tiempo restante de la batería con su equipo de video, etc., en las condiciones siguientes.

- Utilización de una batería "InfoLITHIUM"
  - Empleo del equipo electrónico que posea la marca
  - Ceréiese de utilizar una batería que posea la marca
- Si su equipo de video puede utilizar baterías "InfoLITHIUM", consulte el manual de instrucciones del mismo.

\*Si utiliza esta batería con un equipo electrónico que no posea la marca , la capacidad de batería restante no se indicará en minutos.\*

\*La indicación puede no ser precisa en función de la condición y el entorno en los que se emplee el equipo

### Garantía del contenido grabado

El contenido de la grabación no podrá compensarse si la grabación o la reproducción no se realiza debido a un mal funcionamiento de la batería, el adaptador de ca el adaptador cargador de ca, etc.

## No habrá ninguna compensación por el contenido de las imágenes

Nosotros no ofreceremos ninguna compensación por el contenido grabado, como imágenes y sonido, si no se graban o reproducen debido al mal funcionamiento del adaptador de ca/cargador, etc.

## Carga

Utilice solamente una batería de tipo de iones de litio. Esta unidad no podrá utilizarse para cargar una batería de tipo Ni-Cd/Ni-MH.

- Fíjele firmemente la batería.
- Cargue la batería sobre una superficie plana exenta de vibraciones.

### Temperatura de carga

- La gama de temperaturas para la carga recomendada para obtener el máximo rendimiento de la batería es de +10°C a +30°C
- Esta unidad es compatible con la carga rápida, pero la carga fuera de la gama de temperaturas recomendada aumentará el tiempo de carga para proteger la batería. Después de haberse sobrepasado el tiempo de carga, ésta no volverá a la carga rápida aunque la temperatura entre dentro de la gama de temperaturas recomendada. Reinstale la batería y después carguela.

### Otros

- La placa de características en la que se indica la tensión de alimentación, el consumo, etc., se encuentra en la parte inferior.
- Mientras el adaptador/cargador de ca está enchufado en un tomacorriente, a través del adaptador/cargador circulará cierta cantidad de corriente.
- Cuando no vaya a utilizar la unidad durante mucho tiempo, desconchufe el tomacorriente. Para desconectar el cable de alimentación, tire del enchufe. No tire nunca del cable de alimentación.
- No utilice la unidad con un cable dañado, cuando se haya caído, ni cuando esté dañada.
- Utilice esta unidad cerca de un tomacorriente de la red. Esto es para poder desconectar inmediatamente el enchufe de alimentación del tomacorriente de la red, a fin de desconectar la alimentación, en caso de producirse cualquier anomalía durante la utilización.
- Cerciórese de que ningún objeto metálico entre en contacto con las partes metálicas de la unidad ni con la placa conectora. En caso contrario podría producirse un cortocircuito y la unidad se dañaría.
- Mantenga siempre limpios los contactos metálicos.
- No desarme ni modifique la unidad.
- No golpee ni deje caer la unidad.
- Cuando utilice la unidad, se calentará. Sin embargo, esto es normal.
- Mantenga la unidad alejada de receptores de AM, porque podría perturbarse la recepción de AM.
- No coloque la unidad en un lugar:
  - Extremadamente cálido o frío
  - Polvoriento o sucio
  - Muy húmedo
  - Sometido a vibraciones
- Si coloca la unidad en lugares sometidos a aparatos de calefacción, es posible que se deforme o funcione mal.
- Si tiene alguna dificultad, desenchufe la unidad y póngase en contacto con su proveedor Sony.

## Solución de problemas

El equipo de video no funciona.

- El enchufe de alimentación está desconectado del tomacorriente de la red.
- Insértelo en el tomacorriente de la red.

- El cable conector no está no está adecuadamente conectado.
- Conéctelo adecuadamente.

-



