

# ***Micro Hi-Fi Component System***

---

## Operating Instructions

### Owner's Record

The model and serial numbers are located on the rear of the unit. Record the serial number in the space provided below. Refer to them whenever you call upon your Sony dealer regarding this product.

Model No. \_\_\_\_\_

Serial No. \_\_\_\_\_



***CMT-HPX10W  
CMT-HPX9  
CMT-HPX7***

## WARNING

### To prevent fire or shock hazard, do not expose the unit to rain or moisture.

To prevent fire, do not cover the ventilation of the apparatus with news papers, table-cloths, curtains, etc. And don't place lighted candles on the apparatus.

To prevent fire or shock hazard, do not place objects filled with liquids, such as vases, on the apparatus.

Do not install the appliance in a confined space, such as a bookcase or built-in cabinet.

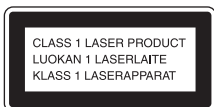

This appliance is classified as a CLASS 1 LASER product. This marking is located on the rear exterior.



Don't throw away the battery with general house waste, dispose of it correctly as chemical waste.

## NOTICE FOR THE CUSTOMERS IN THE U.S.A.

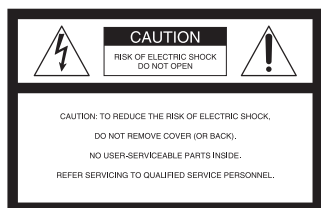

This symbol is intended to alert the user to the presence of uninsulated "dangerous voltage" within the product's enclosure that may be of sufficient magnitude to constitute a risk of electric shock to persons.

This symbol is intended to alert the user to the presence of important operating and maintenance (servicing) instructions in the literature accompanying the appliance.



## CAUTION

The use of optical instruments with this product will increase eye hazard.

## WARNING

This equipment has been tested and found to comply with the limits for a Class B digital device, pursuant to Part 15 of the FCC Rules. These limits are designed to provide reasonable protection against harmful interference in a residential installation. This equipment generates, uses, and can radiate radio frequency energy and, if not installed and used in accordance with the instructions, may cause harmful interference to radio communications. However, there is no guarantee that interference will not occur in a particular installation. If this equipment does cause harmful interference to radio or television reception, which can be determined by turning the equipment off and on, the user is encouraged to try to correct the interference by one or more of the following measures:

- Reorient or relocate the receiving antenna.
- Increase the separation between the equipment and receiver.
- Connect the equipment into an outlet on a circuit different from that to which the receiver is connected.
- Consult the dealer or an experienced radio/TV technician for help.

## CAUTION

You are cautioned that any changes or modification not expressly approved in this manual could void your authority to operate this equipment.

### Note to CATV system installer:

This reminder is provided to call the CATV system installer's attention to Article 820-40 of the NEC that provides guidelines for proper grounding and, in particular, specifies that the cable ground shall be connected to the grounding system of the building, as close to the point of cable entry as practical.

## NOTICE FOR THE CUSTOMERS IN CANADA

### CAUTION

TO PREVENT ELECTRIC SHOCK, MATCH WIDE BLADE OF PLUG TO WIDE SLOT, FULLY INSERT.

### CAUTION

The use of optical instruments with this product will increase eye hazard.

**CMT-HPX10W only**

**NOTICE FOR THE CUSTOMERS IN THE U.S.A.**

If you have any questions about this product, you may call; sony customer Information Service Center  
1-800-222-7669 or <http://www.sony.com/>

The Number below is for the FCC related matters only.

**Regulatory Information**

**Declaration of Conformity**

Trade Name: SONY  
Model No.: HCD-HPX10W  
Responsible Party: Sony Electronics Inc.  
Address: 16450 W. Bernardo Dr,  
San Diego, CA 92127 U.S.A.  
Telephone No.: 858-942-2230

This device complies with Part 15 of the FCC Rules. Operation is subject to the following two conditions: (1) This device may not cause harmful interference, and (2) this device must accept any interference received, including interference that may cause undesired operation.

**NOTICE FOR THE CUSTOMERS IN CANADA**

Operation is subject to the following two conditions: (1) this device may not cause interference, and (2) this device must accept any interference, including interference that may cause undesired operation of the device.

**NOTICE FOR THE CUSTOMERS IN EUROPE**



Hereby, Sony Corp., declares that this equipment is in compliance with the essential requirements and other relevant provisions of Directive 1999/5/EC.

This product is intended to be used in the following countries. United Kingdom, Germany, France, Italy, Netherlands, Austria, Belgium, Portugal, Switzerland, Norway, Sweden, Denmark, Finland

**NOTICE FOR THE CUSTOMERS IN THE U.S.A. AND CANADA**

Replace the AC power adaptor with model AC-GSX100 only, if replacement is necessary.

**Except for European model**



ENERGY STAR® is a U.S. registered mark. As an ENERGY STAR® partner, Sony Corporation has determined that this product meets the ENERGY STAR® guidelines for energy efficiency.

# Table of Contents

How to use this manual.....	5
Playable discs.....	5

---

## Getting Started

Hooking up the system.....	7
Setting the clock.....	9

---

## CD/MP3 – Play

Loading a disc.....	10
Playing a disc.....	11
— Normal Play/Shuffle Play	
Playing repeatedly.....	12
— Repeat Play	
Creating your own program.....	13
— Program Play	

---

## Tuner

Presetting radio stations.....	14
Listening to the radio.....	15
— Preset Tuning	
— Manual Tuning	
Using the Radio Data System (RDS)....	16
(European model only)	

---

## Tape – Play

Loading a tape.....	17
Playing a tape.....	17

---

## Tape – Recording

Recording your favorite CD tracks on a tape.....	18
— CD-TAPE Synchro Recording	
Recording on a tape manually.....	18
— Manual Recording	

---

## Sound Adjustment

Adjusting the sound.....	19
--------------------------	----

---

## Timer

Falling asleep to music.....	19
— Sleep Timer	
Waking up to music.....	20
— Play Timer	
Timer recording radio programs.....	21
— Rec Timer	

---

## Display

Turning off the display.....	22
— Power Saving Mode	
Viewing information about the disc in the display.....	22

---

## Optional Components

Hooking up optional components.....	23
Transmitter.....	24
(CMT-HPX10W only)	

---

## Troubleshooting

Problems and remedies.....	26
Messages.....	29

---

## Additional Information

Precautions.....	30
Specifications.....	31
List of button locations and reference pages.....	34





## How to use this manual

- The instructions in this manual are for model CMT-HPX10W, CMT-HPX9 and CMT-HPX7. Check your model number by looking at the top of the unit. In this manual, CMT-HPX7 is used for illustration purposes unless stated otherwise. Any difference in operation is clearly indicated in the text, for example, “CMT-HPX10W only”.
- This manual mainly explains operations using the remote, but the same operations can also be performed using the buttons on the system having the same or similar names.

## Playable discs

You can play back the following discs on this system. Other discs cannot be played back.

### List of playable discs

Format of discs	Disc logo
Audio CDs	
CD-R/CD-RW (audio data/MP3 files)	
	
	
	

## Discs that this system cannot play

- CD-ROMs
- CD-Rs/CD-RWs other than those recorded in the following formats:
  - music CD format
  - MP3 format that conforms to ISO 9660\*  
Level 1/Level 2, Joliet, Romeo or Multi Session\*\*
- A disc that has a non-standard shape (e.g., card, heart).
- A disc with paper or stickers on it.
- A disc that has the adhesive, cellophane tape, or a sticker still left on it.

\* ISO 9660 Format

The most common international standard for the logical format of files and folders on a CD-ROM. There are several specification levels. In Level 1, file names must be in the 8.3 format (no more than 8 characters in the name, no more than 3 characters in the extension “.MP3”) and in capital letters. Folder names can be no longer than 8 characters. There can be no more than 8 nested folder levels. Level 2 specifications allow file names and folder names up to 31 characters long. Each folder can have up to 8 trees.

For Joliet or Romeo in the expansion format make sure of the contents of the writing software, etc.

\*\* Multi Session

This is a recording method that enables adding of data using the Track-At-Once method. Conventional CDs begin at a CD control area called the Lead-in and end at an area called Lead-out. A Multi Session CD is a CD having multiple sessions, with each segment from Lead-in to Lead-out regarded as a single session.

CD-Extra: This format records audio (audio CD data) on the tracks in session 1 and data on the tracks in session 2.

Mixed CD: This format records data on the first track and audio (audio CD data) on the second and subsequent tracks of a session.

---

## Notes on CD-R and CD-RW

- Some CD-Rs or CD-RWs cannot be played on this system depending upon the recording quality or physical condition of the disc, or the characteristics of the recording device. Furthermore, the disc will not play if it has not been correctly finalized. For more information, see the operating instructions for the recording device.
- Discs recorded on CD-R/CD-RW drives may not be played back because of scratches, dirt, recording condition or the driver's characteristics.
- CD-R and CD-RW discs recorded in multi-session that have not ended by "closing the session" are not supported.
- The system may be unable to play MP3 format files that do not have the extension ".MP3".
- Attempting to play non-MP3 format files that have the extension ".MP3" may result in noise or malfunction.
- With formats other than ISO 9660 Level 1 and 2, folder names or file names may not be displayed correctly.
- The following discs take a longer time to start playback.
  - a disc recorded with complicated tree structure.
  - a disc recorded in Multi Session.
  - a disc to which data can be added (non-finalized disc).

---

## Music discs encoded with copyright protection technologies

This product is designed to playback discs that conform to the Compact Disc (CD) standard. Recently, various music discs encoded with copyright protection technologies are marketed by some record companies. Please be aware that among those discs, there are some that do not conform to the CD standard and may not be playable by this product.

---

## Cautions when playing a disc that is recorded in Multi Session

- If the disc begins with a CD-DA session, it is recognized as a CD-DA (audio) disc, and MP3 sessions are played back without sound.
- If the disc begins with an MP3 session, it is recognized as an MP3 disc, and CD-DA sessions are played back without sound.
- The playback range of an MP3 disc is determined by the tree structure of files produced by analyzing of the disc.
- A disc with a mixed CD format will be recognized as a CD-DA (audio) disc.

## Hooking up the system

Perform the following procedures **1** to **4** to hook up your system using the supplied cords and accessories.

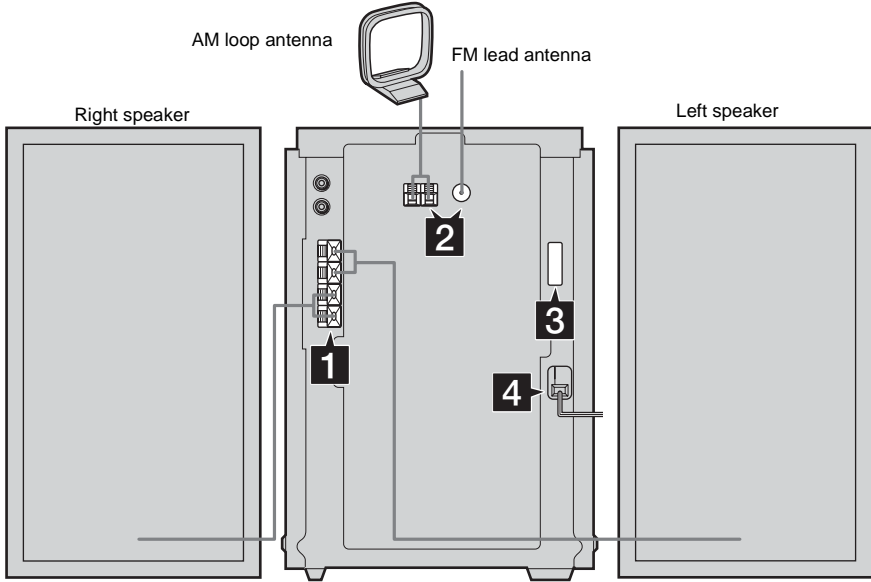

### 1 Connect the speakers.

Connect the right and left speaker cords to the SPEAKER terminals as shown below.

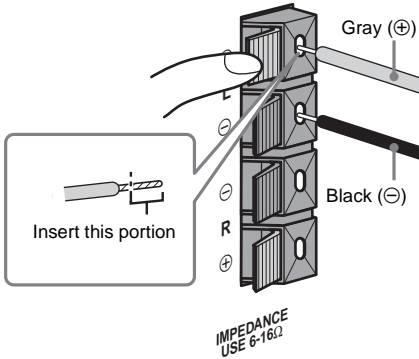

### 2 Connect the FM and AM antennas.

Set up the AM loop antenna, then connect it.

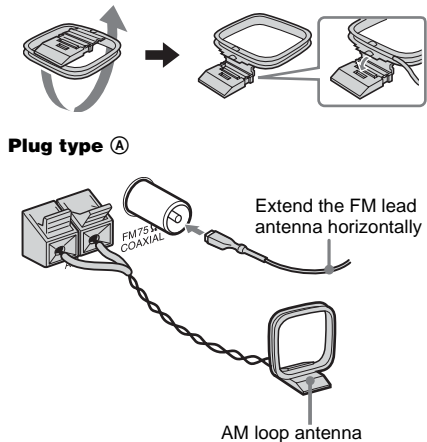

continued

### Plug type ②

Extend the FM lead antenna horizontally

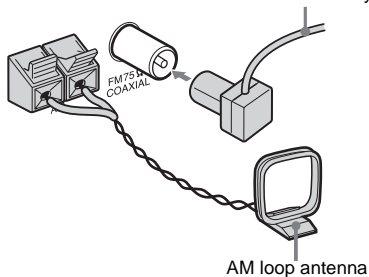

### Plug type ③

North American models:  
Connect using the white side  
Other models:  
Connect using the brown side

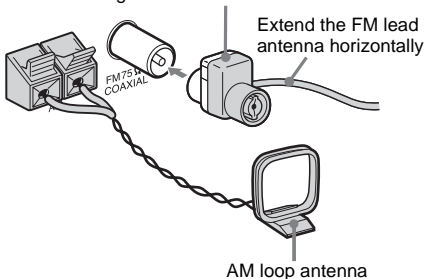

### Note

To prevent noise pickup, keep the antennas away from the system and other components.

### 3 For models with a voltage selector, set VOLTAGE SELECTOR to the local power line voltage.

Refer to the print on your system's VOLTAGE SELECTOR for available settings.

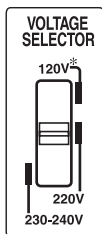

\* Saudi Arabian Model: 120 – 127 V

### 4 Connect the power cord to a wall outlet.

If the plug does not fit the wall socket, detach the supplied plug adaptor (only for models equipped with an adaptor).

To turn on the system, press I/⏻.

## Inserting two R6 (size AA) batteries into the remote

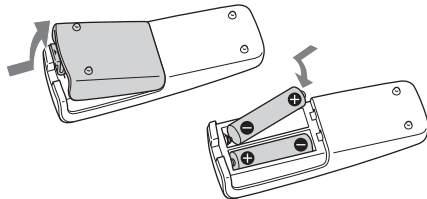

### Note

If you do not use the remote for a long period of time, remove the batteries to avoid possible damage from battery leakage and corrosion.

### Tip

When the remote no longer operates the system, replace both batteries with new ones.

## When carrying this system

Perform the following procedure to protect the CD mechanism.

- 1 Switch the function to CD.
- 2 Make sure that all discs are removed from the system.
- 3 While holding down EX-CHANGE, press I/⏻.  
Check that "PLEASE WAIT" then "LOCK" is displayed.
- 4 Unplug the power cord.



## Setting the clock

Use buttons on the remote for the operation.

- 1** Press I/⏻ to turn on the system.
- 2** Press CLOCK/TIMER SET.
- 3** Press ◀/▶ repeatedly to set the hour.
- 4** Press ENTER.
- 5** Press ◀/▶ repeatedly to set the minute.
- 6** Press ENTER.

The clock starts working.

### To adjust the clock

- 1** Press CLOCK/TIMER SET.
- 2** Press ◀/▶ until "CLOCK SET" appears, then press ENTER.
- 3** Do the same procedures as step 3 to 6 above.

#### Note

The clock is not displayed in Power Saving Mode (page 22).

## Loading a disc

Use buttons on the unit for the operation.

- 1** Press **⏮**.
- 2** Insert discs with the label side facing forward.

Check that the lever on the left side of the respective slot raises.

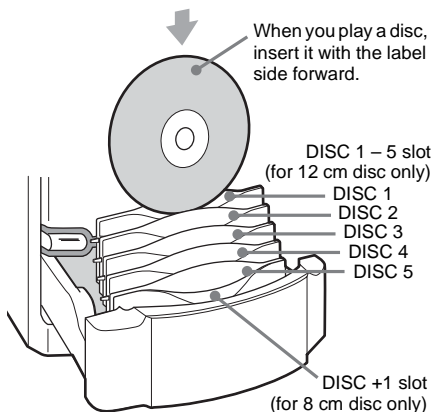

To load an 8 cm disc, insert only DISC +1 slot. You cannot store an 8 cm disc in any of DISC 1 – 5 slot.

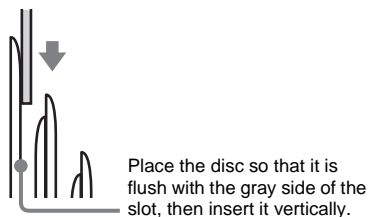

- 3** Press **⏮**.

## To remove discs

- 1** Press **⏮**.
- 2** Hold down the lever on the left side of the respective slot to elevate the disc, then lift it out with your other hand.

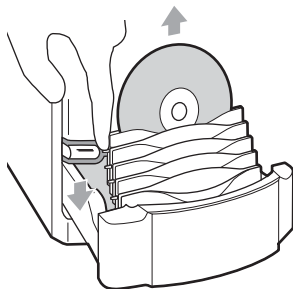

## To exchange discs during playback

- 1** Press **EX-CHANGE** during playback.
- 2** Remove and insert discs in any slot except that of the currently playing disc.

### Notes

- Do not place anything (such as the remote or cords) in front of the disc tray. When opening the disc tray, it may catch and cause malfunction.
- You cannot store 8 cm discs in the DISC 1 – 5 slots. For instructions on how to remove these discs, see page 27.
- Do not use a disc with tape, seals or paste on it as this may cause malfunction.
- Do not use a non-standard shape disc.
- Do not load an 8 cm disc with an adaptor. Doing so may cause the system to malfunction.
- When you eject a disc, handle the disc by its edge. Do not touch the surface.
- When using the EX-CHANGE function, be sure that you do not insert a disc in the slot of the current playing disc. If you do, “CHECK” and the respective disc number will be displayed alternately. This may cause malfunction.

# Playing a disc

## — Normal Play/Shuffle Play

You can play audio CDs and discs with MP3 audio tracks.

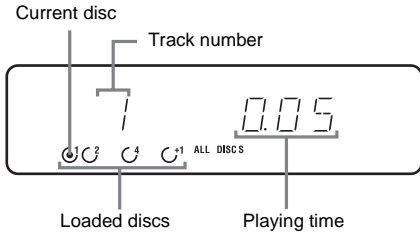

- 1 Press CD (or FUNCTION repeatedly) until “CD” appears.**
- 2 Press PLAY MODE in stop mode repeatedly until the mode you want appears in the display.**

Select	To play
ALL DISCS (Normal Play)	All discs in the system continuously.
1 DISC (Normal Play)	The tracks on the disc you have selected in original order.
ALBM (Normal Play)	All MP3 audio tracks in the album on the disc you have selected in original order. When playing a non-MP3 disc, Album Play becomes 1 DISC Play.
ALL DISCS SHUF (Shuffle Play)	The tracks on all discs in random order.
1 DISC SHUF (Shuffle Play)	The tracks on the disc you have selected in random order.
ALBM SHUF (Shuffle Play)	The MP3 audio tracks in the album on the disc you have selected in random order. When playing a non-MP3 disc, Album Shuffle Play becomes 1 DISC SHUF Play.
PGM (Program Play)	The tracks on all discs in the order you want them to be played (see “Creating your own program” on page 13).

- 3 Press on the remote (or CD/ on the unit).**

## Other operations

To	Do this
Stop play	Press .
Pause	Press . Press again to resume play.
Select a track	Press / repeatedly.
Select an album of MP3 <sup>1)</sup>	Press ALBUM +/- repeatedly after step 2.
Find a point in a track <sup>2)</sup>	Keep pressing / during playback and release it at the desired point.
Select a disc in stop mode	Press DISC SKIP repeatedly (or any one of the buttons (DISC 1 – 5 and DISC +1 <sup>3)</sup> on the unit)).
Switch to CD function from another source	Press any one of the buttons (DISC 1 – 5 and DISC +1 on the unit) (Automatic Source Selection).
Exchange discs	Press EX-CHANGE on the unit.
Remove a disc	Press  on the unit.

- 1) You may not be able to search between multiple files. Also, the time may not be displayed correctly for some files.
- 2) except for MP3 audio tracks
- 3) DISC 1 – 5 and DISC +1 on the unit are not available when “ALL DISCS SHUF” is selected.

## Notes

- You cannot change the play mode during playback.
- Some time may be needed to start playback of discs recorded in complex configurations such as many layers.
- When the disc is inserted, the player reads all the audio tracks on that disc. If there are many albums or non-MP3 audio tracks on the disc, it may take a long time for play to begin or for the next MP3 audio track to start play.
- Do not save unnecessary albums or audio tracks other than MP3 ones in the disc to be used for MP3 listening. We recommend that you do not save other types of audio tracks or unnecessary albums on a disc that has MP3 audio tracks.
- An album that does not include an MP3 audio track is skipped.
- Maximum album number: 150 (including root album and empty albums)
- The maximum number of MP3 audio tracks and albums that can be contained on a single disc is 300.
- Playback is possible up to 8 trees.
- Depending on the encoding/writing software, recording device or the recording media used at the time an MP3 audio track is recorded, you may encounter such problems as disabled playback, sound interruptions and noise.
- When playing back an MP3 audio track, the playback elapsed time indication may differ from the actual time in the following cases.
  - When you play back a VBR (variable bit rate) MP3 audio track
  - When you perform Fast Forward or Rewind (Manual Search)

## Tip

When disc access takes a long time, set “CD POWER” and “ON” by CD power manage function (page 15).

## Playing repeatedly

### — Repeat Play

You can play all the tracks or a single track on a disc repeatedly.

**Press REPEAT repeatedly during playback until “REP” or “REP 1” appears.**

REP: For all tracks on the disc(s) up to five times.

REP 1: For a single track only.

### To cancel Repeat Play

Press REPEAT repeatedly until both “REP” and “REP 1” disappear.

### Note

- You cannot select “REPEAT” and “ALL DISCS SHUF” at the same time.
- When you select “REPEAT 1”, that track is repeated endlessly until “REPEAT 1” is canceled.

# Creating your own program

## — Program Play

You can make a program of up to 25 steps from all the discs in the order you want to play them. You can synchro record the programed tracks onto a cassette tape (page 18).

Use buttons on the remote for the operation.

- 1 Press CD (or FUNCTION repeatedly) until “CD” appears.**
- 2 Press PLAY MODE in stop mode repeatedly until “PGM” appears.**
- 3 Press DISC SKIP repeatedly (or press one of the disc buttons (DISC 1 – 5 and DISC +1) on the unit) to select a disc.**
- 4 Press ◀◀/▶▶ repeatedly until the desired track number appears.**

To program all the tracks on a disc at once, proceed to step 5 with “AL” displayed.

When programing an MP3, press ALBUM +/- to select an album, then press ◀◀/▶▶ repeatedly until the desired track number appears.

Selected track number

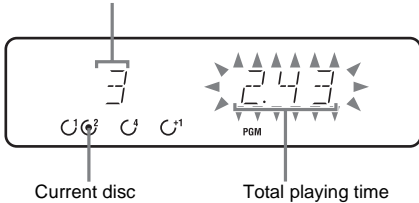

- 5 Press ENTER (or PLAY MODE on the unit).**

The track is programed.

The program step number appears, followed by the total playing time.

- 6 Program additional discs or tracks.**

To program	Repeat steps
Other discs	3 and 5
Other tracks on the same disc	4 and 5
Other tracks on other discs	3 to 5

- 7 Press ▶ (or CD/▶▶ on the unit).**

Program Play starts.

## Other operations

To	Do this
Cancel Program Play	Press PLAY MODE in stop mode repeatedly until “PGM” disappears.
Clear a track from the end	Press CLEAR in stop mode.

## Tips

- The program you made remains after Program Play finishes. To play the same program again, press CD (or FUNCTION on the unit repeatedly) until “CD” appears, then press ▶ (or CD/▶▶ on the unit). However, the program is cleared when you press ▲ on the unit.
- “-- --” appears when the total CD program time exceeds 100 minutes, or when you select a disc with 20 tracks or more, or when you select an MP3 audio track.

## Tuner

### Presetting radio stations

You can preset up to 20 FM stations and 10 AM stations. You can then tune in any of those stations simply by selecting the corresponding preset number.

#### Automatic tuning preset

You can automatically tune in all of the stations that can be received in your area and then store the radio frequency of the desired stations.

- 1 Press TUNER/BAND repeatedly to select “FM” or “AM”.**
- 2 Press TUNING MODE repeatedly until “AUTO” appears in the display.**
- 3 Press +/- (or TUNING +/- on the unit).**  
The frequency changes as the system scans for a station. Scanning stops automatically when a station is tuned in. At that time, “TUNED” and “STEREO” (for stereo program only) appear.

#### If “TUNED” does not appear and the scanning does not stop

Set the frequency of the desired radio station as described in steps 2 and 3 of “Manual tuning preset” (page 14).

- 4 Press TUNER MEMORY.**  
A preset number flashes. Perform steps 5 and 6 while the preset number flashes.

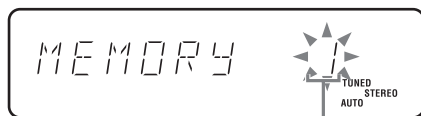

Preset number

- 5 Press +/- (or TUNING +/- on the unit) repeatedly to select the desired preset number.**
- 6 Press TUNER MEMORY.**
- 7 Repeat steps 3 through 6 to preset other stations.**

#### Tip

Press TUNING MODE to stop scanning.

#### Manual tuning preset

You can manually tune in and store the radio frequency of the desired stations.

- 1 Press TUNER/BAND repeatedly to select “FM” or “AM”.**
- 2 Press TUNING MODE repeatedly until “AUTO” and “PRESET” disappear from the display.**
- 3 Press +/- (or TUNING +/- on the unit) repeatedly to tune in the desired station.**
- 4 Press TUNER MEMORY.**
- 5 Press +/- (or TUNING +/- on the unit) repeatedly to select the desired preset number.**
- 6 Press TUNER MEMORY.**
- 7 Repeat steps 3 through 6 to preset other stations.**

#### Other operations

To	Do this
Tune in a station with a weak signal	Follow the procedure described in “Manual tuning preset” (page 14).
Set another station to the existing preset number	After step 4, press +/- (or TUNING +/- on the unit) repeatedly to select the preset number you want to store the station.

## To improve tuner reception

When tuner reception is poor, set CD player power off by the CD power manage function. CD power is factory set to on.

- 1 Press **FUNCTION** repeatedly to switch the function to CD.
- 2 Press **I/⏻** to turn off the system.
- 3 Press **I/⏻** on the unit while holding **■** on the unit.  
“CD POWER” and “OFF” appear.

## To set the CD power on

Repeat the procedure above, and “CD POWER” and “ON” appear.

### Notes

- When “CD POWER” and “OFF” are selected, CD access time is increased.
- You cannot change the setting in Power Saving Mode (page 22).

## To change the AM tuning interval (Except for European model)

The AM tuning interval is factory-preset to 9 kHz (or 10 kHz for some areas). To change the AM tuning interval, tune into any AM station first, then turn off the power by pressing **I/⏻** on the unit. While holding **TUNING +**, press **I/⏻** on the unit. When you change the interval, all AM preset stations are erased. To reset the interval, repeat the above procedure.

### Note

You cannot change the AM tuning interval in the Power Saving Mode (page 22).

### Tips

- The preset stations are retained for about half a day even if you disconnect the power cord or if a power failure occurs.
- To improve the reception, adjust the supplied antennas or connect an external antenna.

## Listening to the radio

You can listen to a radio station either by selecting a preset station, or by manually tuning in the station.

## Listening to a preset station

### — Preset Tuning

Preset radio stations in the tuner’s memory first (see “Presetting radio stations” on page 14).

- 1 Press **TUNER/BAND** repeatedly to select “FM” or “AM”.
- 2 Press **TUNING MODE** repeatedly until “PRESET” appears in the display.
- 3 Press **+/-** (or **TUNING +/-** on the unit) repeatedly to select the desired preset station.

## Listening to non-preset radio station

### — Manual Tuning

- 1 Press **TUNER/BAND** repeatedly to select “FM” or “AM”.
- 2 Press **TUNING MODE** repeatedly until “AUTO” and “PRESET” disappear from the display.
- 3 Press **+/-** (or **TUNING +/-** on the unit) repeatedly to tune in the desired station.

### Tips

- To improve broadcast reception, adjust the supplied antennas, or connect a commercially available external antenna.
- When an FM stereo program has static noise, press FM MODE until “MONO” appears. There will be no stereo effect, but the reception will improve.
- Press TUNING MODE repeatedly until “AUTO” appears in step 2 above, then press +/- (or TUNING +/- on the unit). The frequency indication changes and scanning stops when the system tunes in a station (Automatic Tuning).
- To record the radio programs, use manual recording (page 18).

## Using the Radio Data System (RDS)

*(European model only)*

---

### What is the Radio Data System?

Radio Data System (RDS) is a broadcasting service that allows radio stations to send additional information along with the regular program signal. RDS is available only on FM stations.\*

#### Note

RDS may not work properly if the station you are tuned in is not transmitting the RDS signal properly or if the signal is weak.

\* Not all FM stations provide RDS service, nor do they provide the same types of services. If you are not familiar with the RDS system, check with your local radio stations for details on RDS services in your area.

---

### Receiving RDS broadcasts

#### Simply select a station from the FM band.

When you tune in a station that provides RDS services, the station name appears in the display.

#### To check the RDS information

Each time you press DISPLAY the display changes cyclically as follows:  
Station name\* → Frequency → Clock display  
→ Bass level → Treble level

\* If the RDS broadcast is not properly received, the station name may not appear in the display.



## Loading a tape

- 1 Slide the lid open with your hand.
- 2 Insert a tape.

With the side you want to play/record facing up

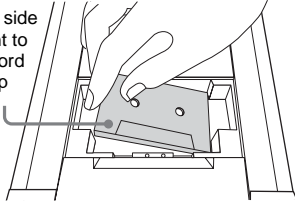

To remove the tape, lift up the tape from the side as shown in the illustration.

- 3 Slide the lid close with your hand.

## Playing a tape

You can use TYPE I (normal).

- 1 Press **TAPE** (or **FUNCTION** repeatedly) until “**TAPE**” appears.
- 2 Press **▶** (or **TAPE/▶** on the unit).

### Other operations

To	Do this
Stop play	Press <b>■</b> .
Pause	Press <b>  </b> . Press again to resume play.
Fast-forward or rewind	Press <b>◀/▶</b> .
Remove a tape	Slide the lid open on the unit in stop mode.

## Tape – Recording

### Recording your favorite CD tracks on a tape

#### — CD-TAPE Synchro Recording

You can record a whole CD on a tape. You can use TYPE I (normal). Use buttons on the unit for the operation.

#### **1** Load a recordable tape.

#### **2** Load a CD you want to record.

When you want to record an album from an MP3 disc, be sure to press PLAY MODE to select ALBM, then use ALBUM +/- to select the desired album before proceeding.

#### **3** Press CD SYNC.

“SYNC” and “REC” appear.

The tape deck stands by for recording and the CD player pauses for playback.

#### **4** Press II TAPE.

Recording starts.

When the recording is completed, the CD player and the tape deck stop automatically.

#### To stop recording

Press ■.

#### To record a disc by specifying track order

You can record only your favorite CD tracks using Program Play. Between steps 2 and 3, perform steps 1 to 4 of “Creating your own program” (page 13).

## Recording on a tape manually

#### — Manual Recording

You can record just the portions you like from a CD on a tape. You can also record a radio program.

Use buttons on the unit for the operation.

#### **1** Load a recordable tape.

#### **2** Select the desired source to record.

- TUNER: To record from this system’s tuner.
- CD: To record from this system’s CD player.
- MD/VIDEO: To record from the optional component connected to the MD/VIDEO jacks.
- WIRELESS (CMT-HPX10W only): To record from the optional component connected to the transmitter.

#### **3** Press ● REC.

“REC” appears and the tape deck stands by for recording.

#### **4** Press II TAPE, then start playing the desired source to record.

Recording starts.

#### Other operations

To	Do this
Stop recording	Press ■.
Pause recording	Press II TAPE.

#### Tip

For recording from a CD, you can press ◀◀/▶▶ to select tracks during recording pause mode (after step 3 and before step 4).

## Sound Adjustment

### Adjusting the sound

You can adjust the bass and treble to enjoy more powerful sound.

---

#### Generating a more dynamic sound (Dynamic Sound Generator X-tra)

Press DSGX on the unit.

To cancel the DSGX, press DSGX on the unit again.

---

#### Adjusting the bass and treble

You can adjust the bass and treble.

**1** Press EQ to select “BASS” or “TREBLE”.

Each time you press the button, the display changes cyclically as follows:

BASS ↔ TREBLE

**2** Press ◀◀/▶▶ repeatedly to adjust the level while “BASS” or “TREBLE” appears.

## Timer

### Falling asleep to music

#### — Sleep Timer

You can set the system to turn off after a certain time, so that you can fall asleep to music.

Use buttons on the remote for the operation.

Press SLEEP repeatedly.

Each time you press the button, the minute display (the turn-off time) changes cyclically as follows:

AUTO\* → 90MIN → 80MIN → ... → 10MIN → SLEEP OFF

\* The system automatically turns off in 100 minutes or after the current CD or tape finishes playing.

#### Other operations

To	Press
Check the remaining time**	SLEEP once.
Change the time to turn off	SLEEP repeatedly to select the time you want.
Cancel the Sleep Timer function	SLEEP repeatedly until “SLEEP OFF” appears.

\*\* You cannot check the remaining time if you select “AUTO”.

#### Tip

You can use Sleep Timer, even if you have not set the clock.

# Waking up to music

## — Play Timer

You can wake up to music at a preset time. Make sure you have set the clock (see “Setting the clock” on page 9).

Use buttons on the remote for the operation.

### 1 Prepare the sound source you want to play.

- CD: Load a disc. To start from a specific track, make a program (see “Creating your own program” on page 13).
- TAPE: Load a tape (see “Playing a tape” on page 17).
- TUNER: Tune in a radio station (see “Listening to the radio” on page 15).

### 2 Adjust the volume.

### 3 Press CLOCK/TIMER SET.

### 4 Press **◀◀/▶▶** repeatedly until “PLAY SET” appears, then press ENTER.

“ON” appears and the hour indication flashes.

### 5 Set the time to start playing.

Press **◀◀/▶▶** repeatedly to set the hour, then press ENTER.

The minute indication flashes.

Press **◀◀/▶▶** repeatedly to set the minute, then press ENTER.

### 6 Set the time to stop playing following the same procedure as step 5.

### 7 Press **◀◀/▶▶** repeatedly until the desired sound source appears.

Each time you press the button, the display changes cyclically as follows:



### 8 Press ENTER.

The start time, the stop time, and the sound source appear in turn, then the original display returns.

### 9 Press **I/⏻** to turn off the system.

## Other operations

To	Do this
Check the setting	<ol style="list-style-type: none"><li>1 Press CLOCK/TIMER SELECT.</li><li>2 Press <b>◀◀/▶▶</b> repeatedly until “PLAY SEL” appears, then press ENTER.</li></ol>
Change the setting	Start over from step 1.
Cancel the timer	<ol style="list-style-type: none"><li>1 Press CLOCK/TIMER SELECT.</li><li>2 Press <b>◀◀/▶▶</b> repeatedly until “TIMER OFF” appears, then press ENTER.</li></ol>

### Notes

- If you use Play Timer and Sleep Timer at the same time, Sleep Timer has priority.
- Do not operate the system from the time the system turns on until the play starts (about 15 seconds before the preset time).
- If the system is on about 15 seconds before the preset time, Play Timer will not be activated.
- You cannot use the optional component connected to the MD/VIDEO jacks or the transmitter (CMT-HPX10W only) as sound sources for Play Timer.
- You cannot activate Play Timer and Rec Timer simultaneously.

# Timer recording radio programs

## — Rec Timer

To timer record, you must first preset the radio station (see “Presetting radio stations” on page 14) and set the clock (see “Setting the clock” on page 9).

Use buttons on the remote for the operation.

- 1 Tune in the preset radio station (see “Listening to a preset station” on page 15).**
- 2 Press CLOCK/TIMER SET.**
- 3 Press ◀◀/▶▶ repeatedly until “REC” appears, then press ENTER.**  
“ON” appears with a flashing hour indication.
- 4 Set the time to start recording.**  
Press ◀◀/▶▶ repeatedly to set the hour, then press ENTER.  
The minute indication flashes.  
Press ◀◀/▶▶ repeatedly to set the minute, then press ENTER.
- 5 Set the time to stop recording following the same procedure as step 4.**  
Rec Timer settings and the desired station appear, then the original display returns.
- 6 Load a recordable tape.**
- 7 Press I/⏻ to turn off the system.**

## Other operations

To	Do this
Check the setting	<ol style="list-style-type: none"><li>1 Press CLOCK/TIMER SELECT.</li><li>2 Press ◀◀/▶▶ repeatedly until “REC SEL” appears, then press ENTER.</li></ol>
Change the setting	Start over from step 1.
Cancel the timer	<ol style="list-style-type: none"><li>1 Press CLOCK/TIMER SELECT.</li><li>2 Press ◀◀/▶▶ repeatedly until “TIMER OFF” appears, then press ENTER.</li></ol>

### Notes

- If you use Rec Timer and Sleep Timer at the same time, Sleep Timer has priority.
- Do not operate the system from the time the system turns on until the recording starts (about 15 seconds before the preset time).
- If the system is on about 15 seconds before the preset time, Rec Timer will not be activated.
- The volume is reduced to minimum during recording.
- You cannot activate Play Timer and Rec Timer simultaneously.

## Display

### Turning off the display

#### — Power Saving Mode

The clock display can be turned off to minimize the amount of power consumed during standby (Power Saving Mode).

**Press DISPLAY repeatedly while the system is off until the clock display disappears.**

#### To cancel Power Saving Mode

Press DISPLAY while the system is off. Each time you press the button, the display switches as follows:

Clock display\* ↔ No display (Power Saving Mode)

\* The clock is displayed only if you set the clock.

#### Tips

- The I/⏻ indicator lights up even in Power Saving Mode.
- The timer continues to operate in Power Saving Mode.

#### Note

You cannot perform the following operations in Power Saving Mode.

- setting the clock
- switching the MD/VIDEO function
- switching the CD power on or off using the CD power manage function
- changing the AM tuning interval

## Viewing information about the disc in the display

You can check the playing time and remaining time of the current track or that of the disc. When a disc with MP3 audio tracks is loaded, you can also check the information recorded on disc, such as the titles.

### Checking the remaining time and titles (CD/MP3)

**Press DISPLAY repeatedly during playback.**

Each time you press the button, the display changes cyclically as follows:

Current track number and elapsed playing time

→ Current track number and remaining time or

“\_ \_ \_ \_”\* → Remaining time of the disc or

“\_ \_ \_ \_”\* → Track title (disc with MP3 audio tracks\*\* only) → Album name\* → Clock display

→ Bass level → Treble level

\* For discs with MP3 audio tracks

\*\* When you play back a track with an ID3 tag, the ID3 tag appears. The ID3 tag displays only the track title information.

### Checking the total playing time and titles (CD/MP3)

**Press DISPLAY repeatedly in stop mode.**

Each time you press the button, the display changes cyclically as follows:

TOC display\* or total number of albums on the disc\*\* or total track number of the current

album\*\* → Disc name\*\* → Clock display →

Bass level → Treble level

\* TOC = Table of Contents; displays total number of tracks on the disc and total playing time of the disc.

\*\* For discs with MP3 audio tracks, album titles may not be displayed depending on the play mode.

## Optional Components

### Hooking up optional components

To enhance your system, you can connect optional components. Refer to the operating instructions provided with each component.

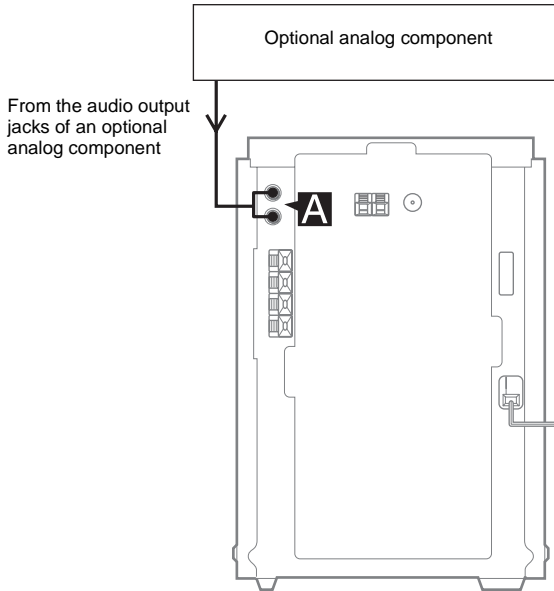

#### **A** MD/VIDEO jacks

Use audio cords (not supplied) to connect an optional analog component (MD deck, etc.) to these jacks. You can then listen to the sound from the component.

#### Listening to audio from a connected component

- 1** Connect audio cords.  
See the illustration above.
- 2** Press FUNCTION repeatedly until "MD" or "VIDEO" appears.  
Start playing the connected component.

#### Tip

If you cannot select "VIDEO" by pressing FUNCTION repeatedly, turn off the system and then press **I/⏻** on the unit while holding down FUNCTION on the unit. The function will change from "MD" to "VIDEO", and "VIDEO" will appear in the display. To change back to "MD", repeat the same procedure. However, you cannot switch the MD/VIDEO function in Power Saving Mode.

# Transmitter

(CMT-HPX10W only)

## Hooking up the transmitter

### 1 Set the transmitter by the following procedures.

Select either AUDIO IN A or AUDIO IN B hook up depending on the jack type of the optional component you want to connect the transmitter to.

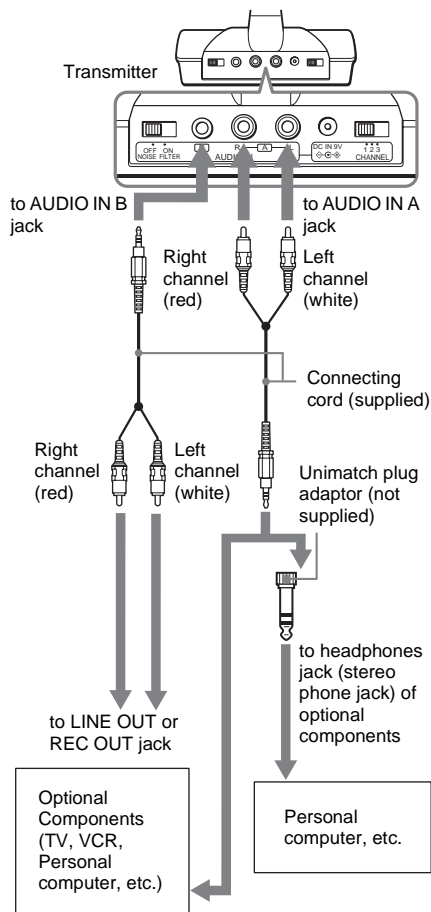

### 2 Connect the transmitter to a wall outlet using the supplied AC power adaptor.

The transmitter automatically turns on.

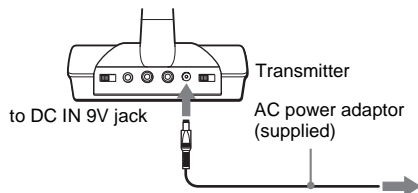

### Notes

- The NOISE FILTER effects the sound only when you connect an optional component to the AUDIO IN A jacks of the transmitter. Connecting to the AUDIO IN B jack, the switch has no effect.
- When you connect the transmitter to the analog out jacks, do not set the NOISE FILTER to ON. Otherwise, the volume will be limited.
- If stereo mini jack is connected to LINE OUT and the NOISE FILTER is set to ON, audio output will be reduced and audio signal may be intermittent or auto muting will activate. In this case, set the NOISE FILTER to OFF.
- While WIRELESS is selected as the function, bumping the transmitter or the unit may produce noise.
- Use only the supplied AC power adaptor. Do not use any other AC power adaptor.



Polarity of the plug

- If the connected component has the AVLS (Automatic Volume Limiter System) function, be sure to turn off the function when using the transmitter. Otherwise, you will have to turn up the volume of the speaker, and that may cause distortion.
- If the connected component has the BASS BOOST or MEGA BASS function, be sure to turn off the function when using the transmitter. Otherwise, the sound from the speaker may be distorted.



---

## Placing the transmitter

Placing it up off the floor, such as on a desk, is recommended.

The transmitter has a signal reception area of 1 to 46 m. However, this distance may be reduced depending on the surroundings and environment, such as obstacles (wall, etc.).

### Notes

- Do not place the transmitter on or near the following objects. Doing so may cause noise.
  - Main unit, TV, speaker, fluorescent lamp, floor.
  - Radio waves generated such as cell phones and cordless phone systems or metal instruments are placed on the unit.
  - Inside a building with walls containing steel beams.
  - Area with many steel file cabinets, etc.
  - Area with many electrical appliances capable of generating electromagnetic noise.
  - Area facing roadways.
  - Radio transceivers in trucks, etc.
  - Wireless communication systems installed along roadways.
- Even within the signal reception area, there are some spots (dead spot) where the RF signal cannot be received. This is a characteristic inherent to RF signals, and does not indicate a malfunction. By slightly moving the transmitter, the location of the dead spot can be changed.

---

## Listening to audio using a wireless system

- 1** Start playing the connected component.
- 2** Press **FUNCTION** repeatedly to switch the function to **WIRELESS**.
- 3** Press **+/-** (or **TUNING +/-** on the unit). “**AUTO SCAN**” appears.

### If the system picks up some noise or “**AUTO SCAN**” does not disappear

- Reduce the distance between the transmitter unit and the main unit.
- Select another channel using **CHANNEL 1–3** on the transmitter, then press **+/-** (or **TUNING +/-** on the unit). “**AUTO SCAN**” appears.

### Notes

- You may not hear the beginning of the sound from the main unit until the transmitter starts sending the RF signals after detecting an audio signal.
- If the transmitter is connected to the headphones jack of the source component, set the volume of that component as high as possible without distorting the audio signal.
- If you hold the antenna of the transmitter with your hand, noise may occur. However this is not a malfunction.
- When the transmitter is not to be used for a long period of time, disconnect the AC power adaptor from the wall outlet holding the plug. Do not pull on the cord.

## Troubleshooting

### Problems and remedies

Should you encounter a problem with your system, do the following:

- 1 Make sure the power cord and speaker cords are correctly and firmly connected.
- 2 Find your problem in the troubleshooting checklist below and take the indicated corrective action.

If the problem persists after doing all of the above, consult your nearest Sony dealer.

#### When the I/⏻ indicator flashes

Immediately unplug the power cord and check the following items.

- If your system has a voltage selector, is the voltage selector set to the correct voltage? Check the voltage for your region, then make sure the voltage selector is set correctly.
- Are the + and – speaker cords short-circuited?
- Are you using the supplied speakers?
- Is anything blocking the ventilation holes on the rear of the system?

Check all the above items and fix any problems found. After I/⏻ indicator stops flashing, reconnect the power cord and turn on the system. If the indicator still flashes, or if the cause of the problem cannot be found even after checking all the above items, consult your nearest Sony dealer.

#### General

##### “CANT LOCK” appears.

- Turn the power off and then on again by pressing I/⏻ on the system, then perform “When carrying this system” (page 8). If “CANT LOCK” still appears, contact your Sony dealer or local authorized Sony service facility.

##### “-- --” appears in the display.

- A power interruption has occurred. Set the clock (page 9) and timer settings (pages 20 and 21) again.

##### There is no sound.

- Press VOLUME + on the remote repeatedly (or turn VOLUME on the unit clockwise).
- Make sure the headphones are not connected.
- Check the speaker connections (page 7).

##### Sound comes from one channel, or unbalanced left and right volume.

- Place the speakers as symmetrically as possible.
- Connect the supplied speakers.

##### There is severe hum or noise.

- Move the system away from the source of noise.
- Connect the system to a different wall outlet.
- Install a noise filter (commercially available) to the power line.

##### The timer cannot be set.

- Set the clock again (page 9).

##### The timer does not function.

- Press CLOCK/TIMER SELECT on the remote to set the timer and light up “⏻ PLAY” or “⏻ REC” in the display (pages 20 and 21).
- Check the timer setting and set the correct time (pages 20 and 21).
- Cancel the Sleep Timer function (page 19).
- Make sure the clock is correctly set.

##### The color on the TV screen is irregular.

- Move the speakers farther away from the TV set.

##### The remote does not function.

- Remove the obstacle.
- Move the remote closer to the system.
- Point the remote at the system’s sensor.
- Replace the batteries (R6/size AA).
- Locate the system away from the fluorescent light.

#### Speakers

##### Sound comes from one channel, or the left and right volumes are unbalanced.

- Check the speaker connections and placement.

#### CD/MP3 player

##### “LOCKED” appears.

- Contact your Sony dealer or local authorized Sony service facility.

---

### Play does not start.

- Eject the disc and check whether a disc is loaded.
- Wipe the disc clean (page 30).
- Replace the disc.
- Load the disc that this system can play (page 5).
- Load the disc correctly.
- Load the disc with the label side up.
- Remove the disc and wipe away the moisture on the disc, then leave the system turned on for a few hours until the moisture evaporates.
- Press ► (or CD/►|| on the unit) to start play.

---

### Disc access takes a long time.

- Set “CD POWER” and “ON” by the CD power manage function (page 15).

---

### The sound skips.

- Wipe the disc clean (page 30).
- Replace the disc.
- Try moving the system to a place without vibration (e.g., on top of a stable stand).
- Try moving the speakers away from the system, or placing them on separate stands. When you listen to a track with bass sounds at high volume, the speaker vibration may cause the sound to skip.

---

### Play does not start from the first track.

- Press PLAY MODE repeatedly until both “PGM” and “SHUF” disappear to return to Normal Play.

---

### MP3 audio track cannot be played back.

- Recording was not performed according to the ISO 9660 Level 1 or Level 2 format, or Joliet in the expansion format.
- The MP3 audio track does not have the extension “.MP3”.
- The data is not stored in MP3 format.
- Discs containing tracks other than MPEG1, 2 Audio Layer-3 files cannot be played.

---

### MP3 audio tracks take longer to play back than others.

- After the system reads all tracks on the discs, playback may take more time than usual if:
  - the number of albums or tracks on the disc is very large.
  - the album and track organization structure is very complex.

---

### The album title, track title and ID3 tag do not appear correctly.

- Use a disc that conforms with ISO 9660 Level 1, level 2, or Joliet in the expansion format.

---

### You inserted an 8 cm disc in the DISC 1–5 slots.

- Unplug the power cord. Lift the main unit and remove the disc from underneath the tray. (However, do not lift the tray during this procedure.) Plug in the power cord once more.

---

## Tuner

---

### Severe hum or noise/stations cannot be received.

- Set the proper band and frequency (page 14).
- Connect the antenna properly (page 7).
- Find a place and an orientation that provide good reception, then set up the antenna again. If you cannot obtain good reception, we recommend you connect a commercially available external antenna.
- The supplied FM lead antenna receives signals along its entire length, so make sure you extend it fully.
- Keep the antennas away from the system and other components.
- Consult your nearest Sony dealer if the supplied AM antenna has come off the plastic stand.
- Try turning off surrounding electrical equipment.
- Set “CD POWER” and “OFF” by the CD power manage function (page 15).

---

### A stereo FM program cannot be received in stereo.

- Press FM MODE until “MONO” disappears in the display.

---

## Tape deck

---

### The tape does not record or play, or there is a decrease in sound level.

- The heads are dirty. Clean them (page 31).
- The record/playback heads are magnetized. Demagnetize them (page 31).

---

### The tape does not erase completely.

- The record/playback heads are magnetized. Demagnetize them (page 31).

---

### There is excessive wow or flutter, or the sound drops out.

- The capstans in the tape deck are dirty. Clean them using a cleaning cassette (page 31).

---

**Noise increases or the high frequencies are erased.**

- The record/playback heads are magnetized. Demagnetize them (page 31).

---

**The tape does not record.**

- No cassette is loaded. Load a cassette.
- The tab has been removed from the cassette. Cover the broken tab with adhesive tape (page 31).
- The tape has wound to the end.

---

**Optional components**

---

**There is no sound.**

- Refer to General item “There is no sound.” (page 26) and check the condition of the system.
- Connect the component properly (page 23) while checking if:
  - the cords are connected properly.
  - the cord plugs are firmly inserted all the way.
- Turn on the connected component.
- Refer to the operating instructions supplied with the connected component and start playing.
- Press FUNCTION repeatedly until “MD” or “VIDEO” appears (page 23).

---

**The sound is distorted.**

- Set the volume of the connected component lower.

---

**Transmitter (CMT-HPX10W only)**

---

**There is no sound.**

- Check the connection of the optional component.
- Check that the optional component is turned on.
- Turn up the volume on the connected optional component, if the transmitter is connected to the headphones jack.
- Change the radio frequency using the CHANNEL selector on the transmitter, then press +/- (or TUNING +/- on the unit) again.
- Reduce the distance between the transmitter unit and the main unit.
- If you connect the transmitter to the analog out jacks of an audio reproducer, make sure that the NOISE FILTER switch is set to OFF.
- Make sure that the NOISE FILTER switch is set to either ON or OFF (If the switch gets stuck between ON and OFF, the sound will be cut off).

---

**There is severe hum or noise.**

- If the transmitter is connected to the headphones jack, turn down the volume of the connected optional component. If the connected optional component has the BASS BOOST or MEGA BASS function, set these function to OFF.
- If the connected optional component has a LINE OUT jacks, connect its LINE OUT jacks.
- Change the radio frequency using the CHANNEL selector on the transmitter, then press +/- (or TUNING +/- on the unit) again.
- Reduce the distance between the transmitter unit and the main unit.
- If you connect the transmitter to the analog out jacks of an audio reproducer, make sure that the NOISE FILTER switch is set to OFF.
- Make sure that the transmitter is not placed on a speaker or any place subject to vibration.

---

**If the system still does not operate properly after performing the above measures, reset the system as follows:**

Use buttons on the unit for the operation.

- 1** Disconnect the power cord.
- 2** Reconnect the power cord.
- 3** Press I/⏻ to turn on the system.
- 4** Press ■, PLAY MODE/TUNING MODE and I/⏻ at the same time.

The system is reset to the factory settings. You should set the settings you made, such as the preset stations, clock, and timer.

## Messages

One of the following messages may appear or flash in the display during operation.

---

### CD/MP3

#### NO DISC

There is no disc in the player.

---

#### NO STEP

All of the programmed tracks have been erased.

---

#### CD OVER

You have reached the end of the disc while pressing and holding ►► during playback or pause.

---

#### CHECK DISC

You have inserted a disc in the slot of the currently playing disc.

---

#### STEP FULL

You tried to program 26 or more tracks (steps).

---

#### PUSH STOP

You pressed PLAY MODE during playback.

---

### Tuner

---

#### COMPLETE

The preset operation ended normally.

---

### Tape

---

#### NO TAB

You cannot record the tape because the tab has been removed from the cassette.

---

#### NO TAPE

There is no tape in the tape deck.

---

### Timer

---

#### SET TIMER

You cannot select the timer function when Play Timer or Rec Timer are not set.

---

#### TIME NG

Play Timer or Rec Timer start and end times are set to the same time.

---

#### PUSH SELECT

You tried to set the clock or timer during timer operation.

---

#### SET CLOCK

You tried to select the timer with the clock not set.

---

---

### Wireless (CMT-HPX10W only)

---

#### AUTO SCAN

You can adjust the settings so that you hear clear audio sound.

---

### Other

---

#### NOT IN USE

You pressed an invalid button.

---

## Additional Information

### Precautions

#### On operating voltage

- Before operating the system, check that the operating voltage of your system is identical with the voltage of your local power supply.
- The voltage selector is located at the bottom of the apparatus.

#### On safety

- The unit is not disconnected from the AC power source (mains) as long as it is connected to the wall outlet, even if the unit itself has been turned off.
- Unplug the system from the wall outlet (mains) if it is not to be used for an extended period of time. To disconnect the power cord (mains lead), pull it out by the plug. Never pull the cord itself.
- Should any solid object or liquid fall into the system, unplug the system and have it checked by qualified personnel before operating it any further.
- AC power cord must be changed only at the qualified service shop.

#### On placement

- Do not place the system in an inclined position.
- Do not place the system in locations where it is;
  - Extremely hot or cold
  - Dusty or dirty
  - Very humid
  - Subject to vibrations
  - Subject to direct sunlight
- Use caution when placing the unit or speakers on surfaces that have been specially treated (with wax, oil, polish, etc.) as staining or discoloration of the surface may result.

#### On heat buildup

- Although the system heats up during operation, this is not a malfunction.
- Place the system in a location with adequate ventilation to prevent heat build-up in the system.
- If you continuously use this system at a high volume, the cabinet temperature of the top, side and bottom rises considerably. To avoid burning yourself, do not touch the cabinet.
- To prevent a malfunction, do not cover the ventilation hole.

#### On operation

- If the system is brought directly from a cold to a warm location, or is placed in a very damp room, moisture may condense on the lens inside the CD player. Should this occur, the system will not operate properly. Remove the disc and leave the system turned on for about an hour until the moisture evaporates.
- When you move the system, take out any disc.

If you have any questions or problems concerning your system, please consult your nearest Sony dealer.

#### Notes on discs

- Before playing, clean the disc with a cleaning cloth. Wipe the disc from the center out.
- Do not use solvents such as benzene, thinner, commercially available cleaners or anti-static spray intended for vinyl LPs.
- Do not expose the disc to direct sunlight or heat sources such as hot air ducts, nor leave it in a car parked in direct sunlight.
- Do not use discs encircled with a protection ring. This may cause a malfunction to the system.
- When using discs that have glue or similar tacky substance on the label side of the disc or that used a special ink when the label was printed, there is a chance that the disc or label may become attached to parts inside this unit. When this occurs, it may not be possible to remove the disc, and may also cause this unit to malfunction. Be sure to check that the label side of the disc is not sticky before using.  
The following types of disc should not be used:
  - Rental or used discs with attached seals where the glue extends beyond the seal. The perimeter of the seal on the disc is tacky.
  - Discs that have labels printed using a special ink that feels tacky when touched.
- Discs with non-standard shapes (e.g., heart, square, star) cannot be played on this unit. Attempting to do so may damage the unit. Do not use such discs.

#### Cleaning the cabinet

Clean the cabinet, panel and controls with a soft cloth slightly moistened with mild detergent solution. Do not use any type of abrasive pad, scouring powder or solvent such as thinner, benzene or alcohol.

## To save a tape permanently

To prevent a tape from being accidentally recorded over, break off the cassette tab from side A or B as illustrated.

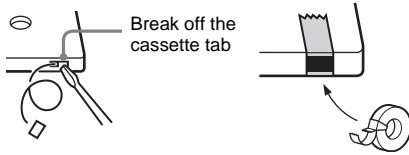

If you later want to reuse the tape for recording, cover the broken tab with adhesive tape.

## Before placing a cassette in the tape deck

Take up any slack in the tape. Otherwise, the tape may get entangled in the parts of the tape deck and become damaged.

## When using a tape longer than 90 minutes

The tape is very elastic. Do not change the tape operations such as play, stop, and fast-winding frequently. The tape may get entangled in the tape deck.

## Cleaning the tape heads

Clean the tape heads after every 10 hours of use. Be sure to clean the tape heads before you start an important recording or after playing an old tape. Use a separately sold dry-type or wet-type cleaning cassette. For details, refer to the instructions of the cleaning cassette.

## Demagnetizing the tape heads

Demagnetize the tape heads and the metal parts that have contact with the tape after every 20 to 30 hours of use with a separately sold demagnetizing cassette. For details, refer to the instructions of the demagnetizing cassette.

# Specifications

## Main unit (HCD-HPX10W/HCD-HPX9/HCD-HPX7)

### Amplifier section

#### For the United States model

### AUDIO POWER SPECIFICATIONS

HCD-HPX10W

#### POWER OUTPUT AND TOTAL HARMONIC DISTORTION:

With 6-ohm loads, both channels driven, from 120 – 10,000 Hz: rated 55 watts per channel minimum RMS power, with no more than 10% total harmonic distortion from 250 milliwatts to rated output.

HCD-HPX9

#### POWER OUTPUT AND TOTAL HARMONIC DISTORTION:

With 6-ohm loads, both channels driven, from 120 – 10,000 Hz: rated 75 watts per channel minimum RMS power, with no more than 10% total harmonic distortion from 250 milliwatts to rated output.

HCD-HPX10W for CMT-HPX10W

DIN power output (rated): 50 + 50 W  
(6 ohms at 1 kHz, DIN)

Continuous RMS power output (reference):  
60 + 60 W  
(6 ohms at 1 kHz, 10% THD)

Music power output (reference):  
100 + 100 W

HCD-HPX9 for CMT-HPX9

North American model:  
Continuous RMS power output (reference):  
80 + 80 W  
(6 ohms at 1 kHz, 10% THD)

Other models:

The following measured at AC 240 V, AC 220 V or AC 120 V

DIN power output (rated): 53 + 53 W  
(6 ohms at 1 kHz, DIN)

Continuous RMS power output (reference):  
70 + 70 W  
(6 ohms at 1 kHz, 10% THD)

continued

## HCD-HPX7 for CMT-HPX7

European model:

DIN power output (rated): 50 + 50 W  
(6 ohms at 1 kHz, DIN)

Continuous RMS power output (reference):  
60 + 60 W  
(6 ohms at 1 kHz, 10% THD)

Music power output (reference):  
100 + 100 W

Other models:

The following measured at AC 240 V, AC 220 V or AC 120 V

DIN power output (rated): 45 + 45 W  
(6 ohms at 1 kHz, DIN)

Continuous RMS power output (reference):  
50 + 50 W  
(6 ohms at 1 kHz, 10% THD)

Inputs

MD/VIDEO: Sensitivity 450/250 mV,  
impedance 47 kilohms

Outputs

PHONES: Accepts headphones with  
an impedance of 8 ohms or  
more.

SPEAKER: Accepts impedance of 6 to  
16 ohms.

## CD player section

Laser Semiconductor laser  
( $\lambda=780$  nm)  
Emission duration:  
continuous

Frequency response 20 Hz – 20 kHz

## Tape deck section

Recording system 4-track 2-channel, stereo  
Frequency response 50 – 13,000 Hz ( $\pm 3$  dB),  
using Sony TYPE I  
cassettes

Wow and flutter  $\pm 0.15\%$  W. Peak (IEC)  
 $0.1\%$  W. RMS (NAB)  
 $\pm 0.2\%$  W. Peak (DIN)

## Tuner section

FM stereo, FM/AM superheterodyne tuner

FM tuner section

Tuning range 87.5 – 108.0 MHz  
Antenna FM lead antenna  
Antenna terminals 75 ohms unbalanced  
Intermediate frequency 10.7 MHz

AM tuner section

Tuning range

Pan-American model: 530 – 1,710 kHz  
(with the tuning interval  
set at 10 kHz)  
531 – 1,710 kHz  
(with the tuning interval  
set at 9 kHz)

European model: 531 – 1,602 kHz  
(with the tuning interval  
set at 9 kHz)

Other models: 530 – 1,710 kHz  
(with the tuning interval  
set at 10 kHz)  
531 – 1,602 kHz  
(with the tuning interval  
set at 9 kHz)

Antenna AM loop antenna, external  
antenna terminal

Intermediate frequency 450 kHz

## Speaker (SS-CHPX10W/SS-CHPX9/SS-CHPX7)

SS-CHPX10W for CMT-HPX10W

Speaker system 3-way, bass-reflex type  
Speaker units  
Super tweeter: 2 cm dia., cone type  
Woofer: 12 cm dia., cone type  
Tweeter: 4 cm dia., cone type  
Nominal impedance 6 ohms  
Dimensions (w/h/d) Approx. 170 × 300 × 208  
mm  
Mass Approx. 2.7 kg net per  
speaker

SS-CHPX9 for CMT-HPX9

Speaker system 3-way, bass-reflex type  
Speaker units  
Super tweeter: 2 cm dia., cone type  
Woofer: 12 cm dia., cone type  
Tweeter: 4 cm dia., cone type  
Nominal impedance 6 ohms  
Dimensions (w/h/d) Approx. 170 × 300 × 208  
mm  
Mass Approx. 2.7 kg net per  
speaker

SS-CHPX7 for CMT-HPX7

Speaker system 2-way, bass-reflex type  
Speaker units  
Woofer: 10 cm dia., cone type  
Tweeter: 4 cm dia., cone type  
Nominal impedance 6 ohms  
Dimensions (w/h/d) Approx. 155 × 270 × 182  
mm



Mass Approx. 2.2 kg net per speaker

## Transmitter

TMR-HT1 for CMT-HPX10W

North American model:

Carrier frequency 913.6 – 914.4 MHz

Channel

CHANNEL 1: 913.6 MHz

CHANNEL 2: 914.0 MHz

CHANNEL 3: 914.4 MHz

European model:

Carrier frequency 863.6 – 864.4 MHz

Channel

CHANNEL 1: 863.6 MHz

CHANNEL 2: 864.0 MHz

CHANNEL 3: 864.4 MHz

Modulation FM stereo

Power source

North American model: DC 9 V: supplied AC power adaptor (AC-GSX100)

UK model: DC 9 V: supplied AC power adaptor (AC-S901)

Other models: DC 9 V: supplied AC power adaptor (AC-S9010)

Audio input phono jacks/stereo mini jack

Dimensions (w/h/d) Approx. 137 × 106 × 103 mm

Mass Approx. 166 g

## General

Power requirements

North American model: 120 V AC, 60 Hz

European model: 230 V AC, 50/60 Hz

Korean model: 220 V AC, 60 Hz

Australian model: 230 – 240 V AC, 50/60 Hz

Taiwanese model: 120 V AC, 50/60 Hz

Argentine model: 220 V AC, 50/60 Hz

Mexican model: 120 V AC, 60 Hz

Saudi Arabian model: 120 – 127/220 or 230 – 240 V AC, 50/60 Hz

Adjustable with voltage selector

Other models: 120 V, 220 V or 230 – 240

V AC, 50/60 Hz

Adjustable with voltage selector

Power consumption

CMT-HPX10W

North American model: 110 W

Other models: 115 W

CMT-HPX9

North American model: 120 W

Other models: 105 W

CMT-HPX7

European model: 115 W

Other models: 90 W

For European model: 0.25 W (in Power Saving Mode)

Dimensions (w/h/d) Approx. 196 × 270 × 407 mm incl. projecting parts and controls

Mass

CMT-HPX10W: Approx. 7.8 kg

CMT-HPX9: Approx. 8.1 kg

CMT-HPX7: Approx. 7.8 kg

Supplied accessories Remote Commander (1)  
R6 (size AA) batteries (2)  
AM loop antenna (1)  
FM lead antenna (1)  
Transmitter (CMT-HPX10W only) (1)  
AC adapter (CMT-HPX10W only) (1)  
Connecting cord phono plug-stereo mini plug (1 m)  
(CMT-HPX10W only) (1)

Design and specifications are subject to change without notice.



# Remote control

## ALPHABETICAL ORDER

### A - O

- ALBUM +/- **12** (11, 13)
- CD **17** (11, 13, 15)
- CLEAR **14** (13)
- CLOCK/TIMER SELECT **2** (20, 21, 26)
- CLOCK/TIMER SET **3** (9, 20, 21)
- DISC SKIP **10** (11, 13)
- DISPLAY **20** (16, 22)
- ENTER **9** (9, 13, 20, 21)
- EQ **13** (19)
- FM MODE **4** (16, 27)
- FUNCTION **6** (11, 13, 15, 17, 23)

### P - Z

- PLAY MODE **19** (11, 13, 18)
- REPEAT **4** (12)
- SLEEP **21** (19)
- TAPE **16** (17)
- TUNER/BAND **5** (14, 15)
- TUNER MEMORY **18** (14)
- TUNING MODE **19** (14, 15)
- VOLUME +/- **11** (20, 26)

## BUTTON DESCRIPTIONS

- I/⏻ (power) **1** (8, 15, 20, 21, 28)
- ◀▶ (rewind/fast forward) **7** (11, 17)
- ◀◀/▶▶ (skip back/skip forward) **15** (9, 11, 13, 19, 20, 21)
- (stop) **8** (11, 15, 17, 18, 28)
- ⏸ (pause) **8** (11, 17)
- ▶ (play) **8** (11, 13, 17, 27)
- +/- (tuning) **15** (14, 15)

