

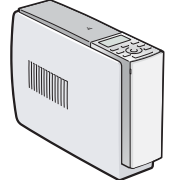

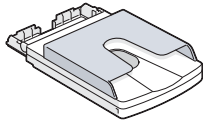



Follow the procedures in steps 1 through 6 to make a print.  
For details, see the Operating Instructions.

## 1 Check the contents of the package.

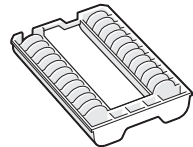
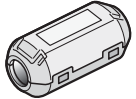
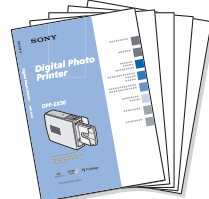
<p>Printer (1)</p> 	<p>Paper tray (1)</p> 	<p>Video connecting cable (1)</p> 
<p>CD-ROM(1)</p>  <ul style="list-style-type: none"> <li>• Sony DPP-EX50 Printer Driver Software for Windows® 98SE/Me/2000 Professional/XP Home Edition/XP Professional</li> <li>• PictureGear Studio V.2.0</li> </ul>		
<p>Cleaning cartridge (1)</p> 	<p>Clamp filter (1)</p> 	
 <ul style="list-style-type: none"> <li>• Operating Instructions (1)</li> <li>• Quick Start Guide (this leaflet, 1)</li> <li>• Warranty (1)</li> <li>• Owner registration card (1)</li> <li>• Sony End User Software License Agreement (1)</li> </ul>		

## 2 Prepare the printing pack (not supplied).

<p><b>For post card size printing:</b></p>  <p><b>SVM-25LS</b></p> <ul style="list-style-type: none"> <li>• Post card (4 x 6 inch) size print paper (25 sheets)</li> <li>• Print cartridge (1)</li> </ul>	<p><b>For 3.5 x 5 inch size printing:</b></p>  <p><b>SVM-30MS</b></p> <ul style="list-style-type: none"> <li>• 3.5 x 5 inch size print paper (30 sheets)</li> <li>• Print cartridge (1)</li> </ul>	<p><b>For Small size printing:</b></p>  <p><b>SVM-30SS</b></p> <ul style="list-style-type: none"> <li>• Small (3.5 x 4 inch) size print paper (30 sheets)</li> <li>• Print cartridge (1)</li> </ul>
--	---	--

For the details, see page 12 of Operating Instructions.

## 3 Load the print cartridge.

- Slide open the cartridge compartment cover.
- Insert the print cartridge.   
 (Note: "Sony" logo is visible on the cartridge.)
- Close the cover.

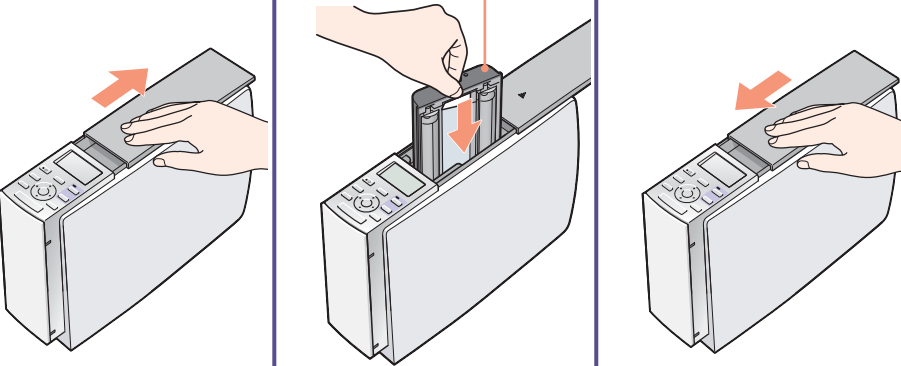

## 4 Insert the print paper.

- Open the paper tray cover, and then adjust the spacer to fit the paper size.   
 (Diagram shows the spacer being moved.)
- Insert the print paper.   
 (Diagram shows paper being inserted with the arrow on the protective sheet facing backwards.)
- Remove the protective sheet, and then close the paper tray cover.   
 (Diagram shows the protective sheet being removed.)
- Push and open the printer's paper tray compartment cover and insert the paper tray into the printer.   
 (Diagram shows the paper tray being inserted.)

You can use the protective sheet as cleaning sheet. Keep it together with the cleaning cartridge.

Insert it firmly until it clicks into place.

## 5 Connect to the AC outlet.

Connect the AC power cord to the AC outlet.

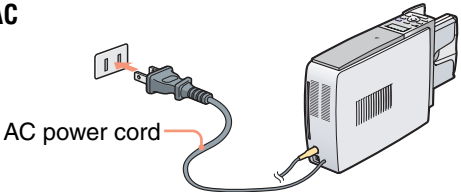

# 6 Print an image.

Depending on the memory card or device you use, the printing procedures differ:

## Printing an image stored on a "Memory Stick" or a CompactFlash card

"Memory Stick"

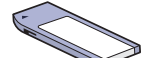

CompactFlash card

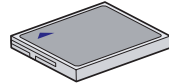

## Printing using a connected TV monitor



## Printing an image from a PictBridge-compliant digital camera

See page 81 of the Operating Instructions.

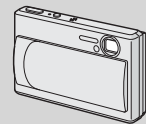

## Printing an image from a PC

See page 85 of the Operating Instructions.



## Printing using the printer's LCD display

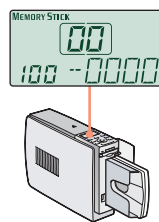

### Preparations

**1** Connect the printer to a TV monitor and turn on the TV monitor.

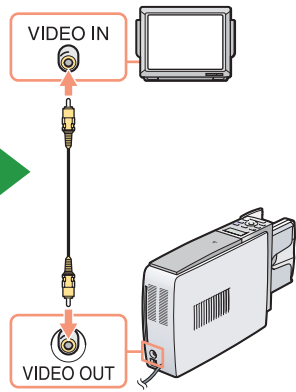

Set the TV monitor in the video mode.

**2** Insert a "Memory Stick" or a CompactFlash card.

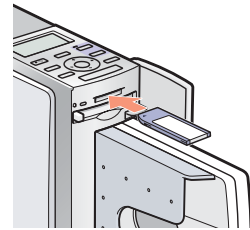

CompactFlash card

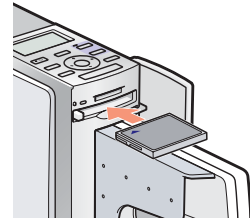

**3** Press ON/STANDBY to turn on the printer.

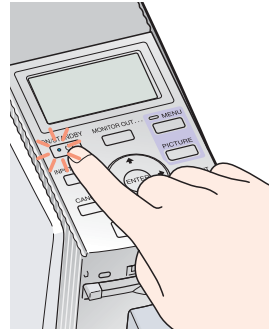

### Displaying images

**4** Display the images on the TV monitor.

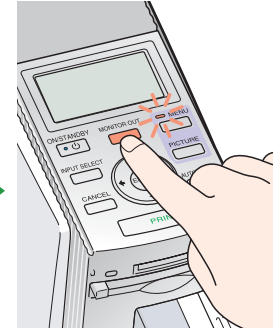

Press MONITOR OUT to turn on the indicator.

**5** Press INPUT SELECT to display "Memory Stick" or "CompactFlash" on the TV monitor.

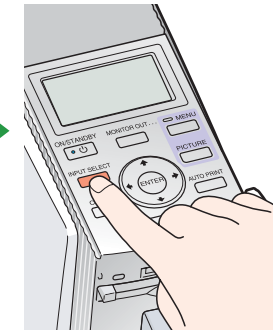

### Selecting an image

**6** Select an image for printing.

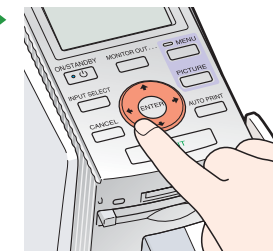

Press (←/→/↑/↓) to move the yellow frame (cursor) to the image you want to print.

### Printing

**7** Press PRINT.

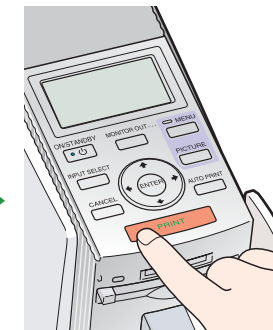

To print multiple copies  
See page 24 on the operating instructions.

### Preparations

**1** Insert a "Memory Stick" or a CompactFlash card.

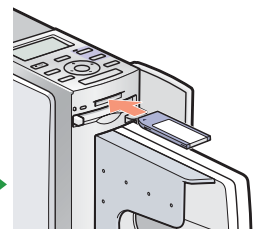

CompactFlash card

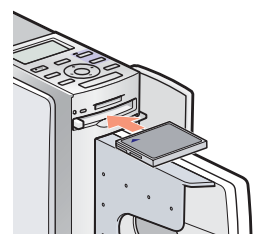

**2** Press ON/STANDBY to turn on the printer.

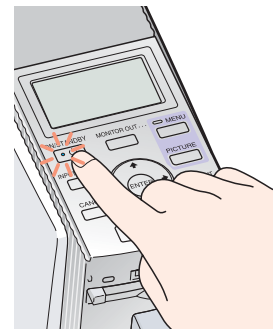

### Displaying images

**3** Press MONITOR OUT to turn off the indicator.

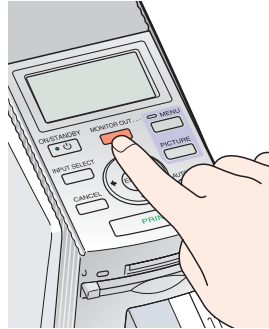

**4** Press INPUT SELECT to display "Memory Stick" or "CompactFlash" on the LCD display.

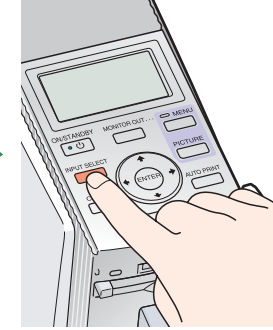

**5** Press AUTO PRINT to display "INDEX."

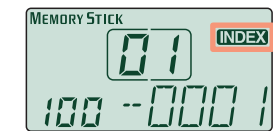
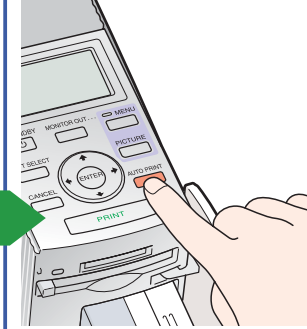

**6** Press PRINT.

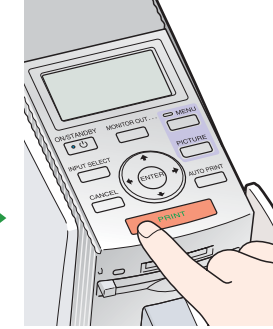

The index of the images in the memory card is printed, allowing you to check the image numbers.

### Selecting an image

**7** Select an image for printing.

Press the arrow (←/→) button to display the desired image number.

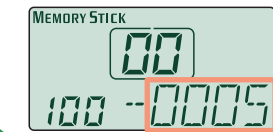

To print multiple copies  
Press ENTER repeatedly to display the desired number.

### Printing

**8** Press PRINT.