

IC Recorder

Operating Instructions

Owner's Record
 The model number is located at the rear and the serial number is located inside the battery compartment. Record the serial number in the space provided below. Refer to these numbers whenever you call upon your Sony dealer regarding this product.

Model No. ICD-B510F Serial No. _____

IC RECORDER ICD-B510F

©2007 Sony Corporation Printed in China

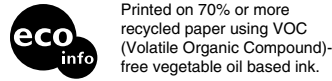

Printed on 70% or more recycled paper using VOC (Volatile Organic Compound)-free vegetable oil based ink.

<http://www.sony.net/>

Information

IN NO EVENT SHALL SELLER BE LIABLE FOR ANY DIRECT, INCIDENTAL OR CONSEQUENTIAL DAMAGES OF ANY NATURE, OR LOSSES OR EXPENSES RESULTING FROM ANY DEFECTIVE PRODUCT OR THE USE OF ANY PRODUCT.

For the customers in the U.S.A.

The following FCC statement applies only to the version of this model manufactured for sale in the USA. Other versions may not comply with FCC technical regulations.

INFORMATION

This equipment has been tested and found to comply with the limits for a Class B digital device, pursuant to Part 15 of the FCC Rules. These limits are designed to provide reasonable protection against harmful interference in a residential installation. This equipment generates, uses, and can radiate radio frequency energy and, if not installed and used in accordance with the instructions, may cause harmful interference to radio communications.

However, there is no guarantee that interference will not occur in a particular installation. If this equipment does cause harmful interference to radio or television reception, which can be determined by turning the equipment off and on, the user is encouraged to try to correct the interference by one or more of the following measures:

- Reorient or relocate the receiving antenna.
- Increase the separation between the equipment and receiver.
- Connect the equipment into an outlet on a circuit different from that to which the receiver is connected.
- Consult the dealer or an experienced radio/TV technician for help.

You are cautioned that any changes or modifications not expressly approved in this manual could void your authority to operate this equipment.

This device complies with part 15 of the FCC Rules. Operation is subject to the following two conditions: (1) This device may not cause harmful interference, and (2) this device must accept any interference received, including interference that may cause undesired operation.

If you have any questions about this product, you may call: Sony Customer Information Services Center 1-800-222-7669 or <http://www.sony.com/>

Disposal of Old Electrical & Electronic Equipment (Applicable in the European Union and other European countries with separate collection systems)

This symbol on the product or on its packaging indicates that this product shall not be treated as household waste. Instead it shall be handed over to the applicable collection point for the recycling of electrical and electronic equipment. By ensuring this product is disposed of correctly, you will help prevent potential negative consequences for the environment and human health, which could otherwise be caused by inappropriate waste handling of this product. The recycling of materials will help to conserve natural resources. For more detailed information about recycling of this product, please contact your local Civic Office, your household waste disposal service or the shop where you purchased the product.

The picture of your TV becomes unstable.
 If you are listening to an FM program near the TV with an indoor antenna, move the unit away from the TV.

The unit does not operate correctly.
 Take out the batteries and insert them again.

Please note that recorded messages may be erased during service or repair work.

Troubleshooting

Before taking the unit for repair, check the following sections. Should any problem persist after you have made these checks, consult your nearest Sony dealer.

- The unit does not operate.**
- The batteries have been inserted with incorrect polarity.
 - The batteries are weak.
 - The buttons are locked with the HOLD switch. (If you press any button, "HOLD" will flash three times.)
- No sound comes from the speaker.**
- The ear receiver or headphones are plugged in.
 - The volume is turned down completely.

"FULL" is displayed and you cannot start recording.

- The memory is full. Erase some of the messages.
- 99 messages have been recorded in the selected folder.
- Select another folder or erase some of the messages.

Getting started

Step 1: Installing the Batteries

1 Slide and lift the battery compartment lid.

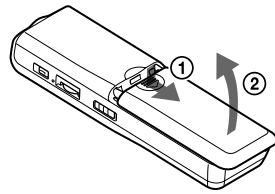

2 Insert two LR03 (size AAA) alkaline batteries with correct polarity, and close the lid.

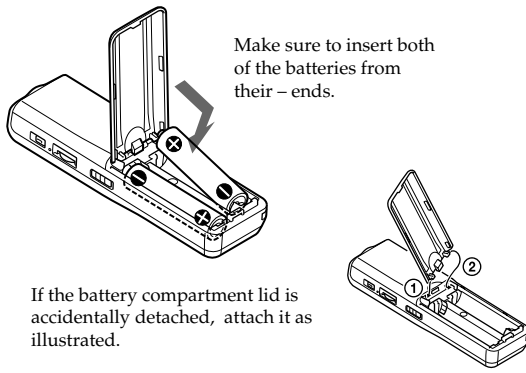

Clock setting display appears when you insert batteries for the first time, or when you replace the batteries with new ones. Please refer to Steps 2 to 3 in "Step 2: Setting the Clock" to set the date and time.

Replacing the batteries

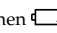
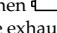
The battery indicator in the display window shows the battery condition. When  flashes, replace the batteries with new ones. When  flashes, the batteries are exhausted and the unit will stop operation.

Battery life* (With continuous use)

In the HQ mode
 Recording: Approx. 11hr.
 Playback: Approx. 7.5 hr.
 FM recording: Approx. 5 hr.
 FM reception: Approx. 13 hr.

In the SP and LP modes
 Recording: Approx. 22 hr.
 Playback: Approx. 11 hr.
 FM recording: Approx. 7 hr.
 FM reception: Approx. 13 hr.

(hr.: hours)
 * Using Sony alkaline batteries LR03 (size AAA)
 * When playing back through the internal speaker with the medium volume level
 The battery life may shorten depending on the operation of the unit.

- Notes**
- Do not use manganese batteries for this unit.
 - When you replace the batteries with new ones, the clock setting display appears. In this case, set the date and time again. The recorded messages and alarm setting, however, will remain.
 - When replacing the batteries, be sure to replace both batteries with new ones.
 - Do not charge dry batteries.
 - When you are not going to use the unit for a long time, remove the batteries to prevent damage from battery leakage and corrosion.
 - The unit is accessing data while "ACCESS" appears in the display window or the OPR indicator flashes in orange. While accessing, do not remove the batteries. Doing so may damage the data.

Step 2: Setting the Clock

Clock setting display appears when you insert batteries for the first time, or when you replace the batteries with new ones. In this case, proceed from step 2.

1 Display the clock setting display.

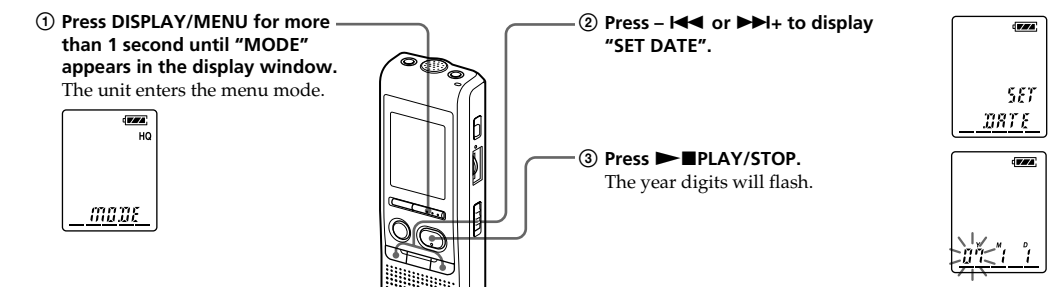

2 Set the date.

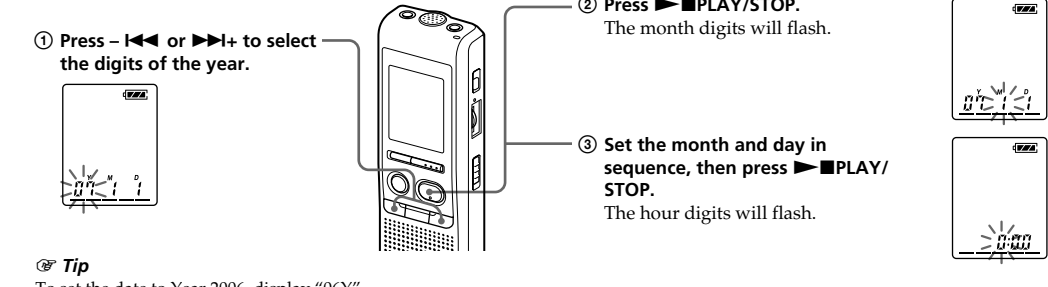

3 Set the time.

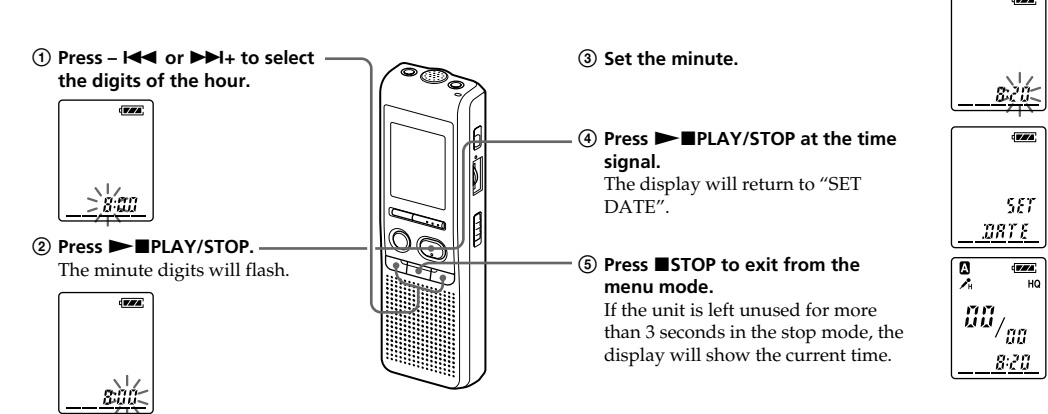

Tip
 This unit does not have a power on/off switch. The display is shown at all times.

Basic Operations

Recording Messages

You can record up to 99 messages in each of the four folders (A, B, C, and D). Since a newly recorded message is automatically added behind the last recorded message, you can start recording quickly without searching for the end of the last recording.

e.g. Message 1 Message 2 Newly recorded message Blank space

Note

Before making a long recording, be sure to insert new batteries and check the battery indicator.

1 Select the recording mode.

See "Changing the Recording Mode" on the reverse side.

2 Select the folder.

See "Selecting the Folder".

3 Start recording.

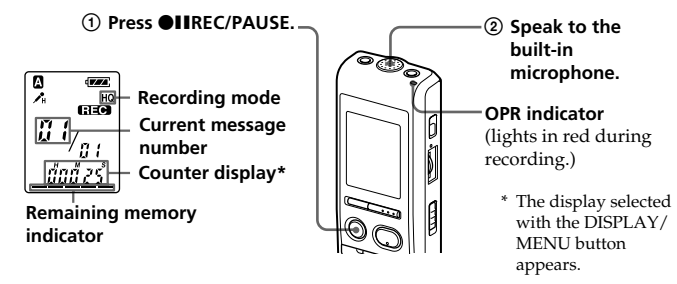

You do not need to keep pressing I/REC/PAUSE while recording.

4 Stop recording.

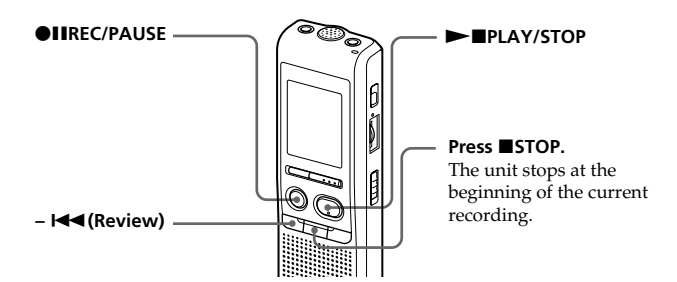

If you do not change the folder after you stop recording, the next time you record you will record in the same folder.

To	Do this
pause recording*	Press I/REC/PAUSE. During recording, pause, the OPR indicator flashes in red and "PAUSE" flashes in the display window.
release pause and resume recording	Press I/REC/PAUSE. Recording resumes from that point. (To stop recording after pausing recording, press STOP.)
listen to the current recording	Press STOP to stop recording, then press PLAY/STOP.
review the current recording instantly	Press I/REC/PAUSE during recording.
search backward during recording (Review)	Hold down ← during recording or recording pause. Recording mode will be released, and reviewing of the current recording starts. If you release the button, playback starts from that point.
select the microphone sensitivity	You can select the microphone sensitivity using the menu. See "Selecting the Microphone Sensitivity". H (high): To record at meeting or in a quiet and/or spacious place. L (low): To record for dictation or in a noisy place.

* About one hour after you pause recording, recording pause is automatically released and the unit goes into the stop mode.

Selecting the Folder

- Press DISPLAY/MENU for more than 1 second until "MODE" appears in the display window.
- Press ← or → to select "FOLDER" and press PLAY/STOP.
- Press ← or → to select the folder you want and press PLAY/STOP.
- Press STOP to exit the menu mode.

Note on recording

Noise may be recorded if an object, such as your finger, etc., accidentally rubs or scratches the unit during recording.

Maximum recording time
 The maximum recording time of all the folders is as follows. You can record messages for the maximum recording time in a single folder.

HQ* 30 h. 25 min.
 SP** 81 h. 15 min.
 LP*** 150 h. 15 min.

(h.: hours/min.: minutes)
 * HQ: High quality recording mode (monaural sound)
 ** SP: Standard play recording mode (monaural sound)
 ***LP: Long play recording mode (monaural sound)

Notes

- To record in better sound quality, select the HQ mode. For switching the recording mode, see "Changing the Recording Mode" on the reverse side.
- Before making a long recording, be sure to check the battery indicator.
- The maximum recording time and the number of messages you can make vary depending on the conditions of use.
- When you record messages in the mixture of HQ, SP and LP mode, the maximum recording time will be between those for the HQ and LP modes.
- Due to the limitation of the IC recording system, this unit records in the minimum recording unit of approx. 2 seconds at most, therefore the following symptoms may occur:
 - When a message is shorter than the minimum recording unit, it is still counted as approx. 2 seconds at most so the remaining recording time will decrease by more than the actual length of the message.
 - When the message is longer than the minimum recording unit, the remaining recording time will decrease by more than the actual length of the message if it cannot be divided by the minimum recording unit without a remainder.
 - The sum of the number on the counter (elapsed recording time) and the remaining recording time may be less than the unit's maximum recording time.

Remaining memory indication
 During recording, the remaining memory indicator decreases one by one.

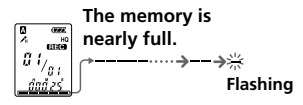

When the remaining time of recording reaches 5 minutes, the last one of the indication flashes. If the remaining recording time display mode is selected, the remaining recording time display will also flash when the remaining time reaches 1 minute.

When the memory is full, recording automatically stops and "FULL" will flash in the display window with an alarm sound. To continue recording, first erase some of the messages.

Notes

- If you press I/REC/PAUSE when the memory is full, "FULL" will flash with an alarm sound. Erase some of the messages before you start recording again.
- If you press I/REC/PAUSE after you have recorded 99 messages, "FULL" will flash with an alarm sound. Select another folder or erase some of the messages.

Starting recording automatically in response to the sound — Advanced VOR function

When VOR (voice operated recording) is set to "ON" in the menu, recording starts when the recorder detects sound. ("VOR" is displayed in the display window.)

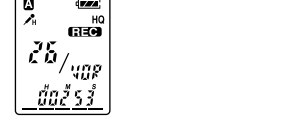

Recording stops when no sound is heard. ("VOR PAUSE" flashes in the display window.)

Note

VOR function is affected by the sound around you. Set the microphone sensitivity to "H (high)" or "L (low)" using the menu. If recording is not satisfactory after you have changed the microphone sensitivity, or for important recording, set VOR to "OFF."

Selecting the Microphone Sensitivity

- Press DISPLAY/MENU for more than 1 second until "MODE" appears in the display window.
- Press ← or → to select "SENS" and press PLAY/STOP.
- Press ← or → to select "H (high sensitivity)" or "L (low sensitivity)" and press PLAY/STOP.
- Press STOP to exit the menu mode.

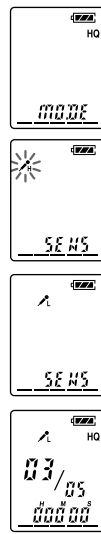

Playing Back Messages

When playing back a previously recorded message, start from Step 1. When playing back a message you have just finished recording, start from Step 3.

1 Select the folder.

See "Selecting the Folder".

2 Select the message number.

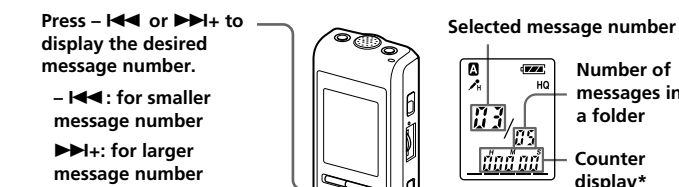

3 Start playback.

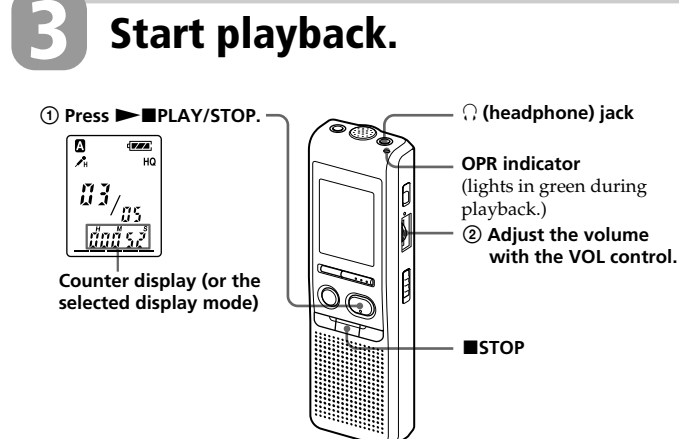

After playing back one message, the unit stops at the beginning of the next message. When the continuous play function is set to "ON" (see the reverse side), the unit stops after playing all messages in a folder. When the last message on a folder has been played back, the unit stops at the beginning of the last message.

For private listening
 Connect an ear receiver or headphones to the (headphone) jack. The built-in speaker will be automatically disconnected. If noise is heard, wipe the headphones plug.

Other operations

To	Do this
stop at the current position	Press PLAY/STOP or STOP. To resume playback from that point, press PLAY/STOP again.
go back to the beginning of the current message	Press ← once.
skip to the next message	Press → once.
go back to previous messages/skip to succeeding messages	Press ← or → repeatedly. (During stop mode, keep the button pressed to skip the messages continuously.)

Erasing Messages

You can erase the recorded messages one by one or all messages in a folder at a time. Note that once a recording has been erased, you cannot retrieve it.

Erasing messages one by one

When a message is erased, the remaining messages will advance and renumbered so that there will be no space between messages.

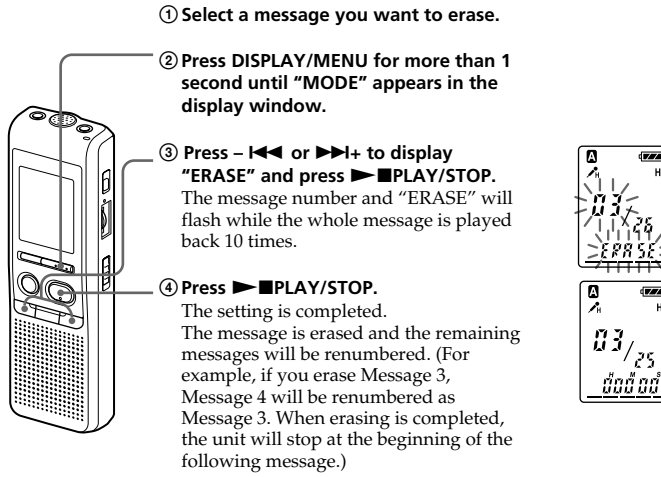
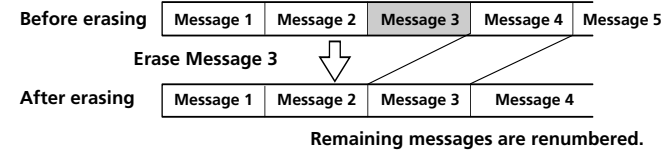

Erasing all messages in a folder

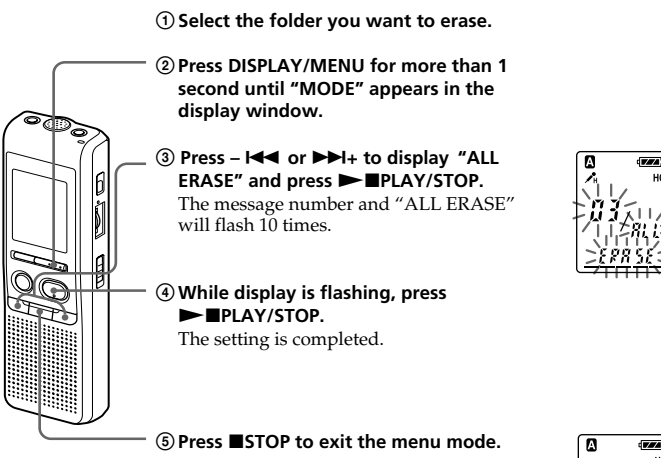
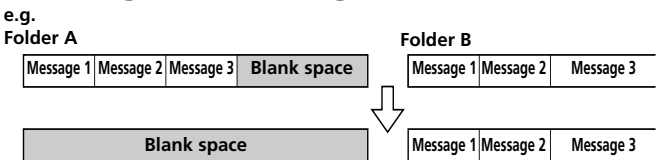

Index to Parts and Controls

Main unit

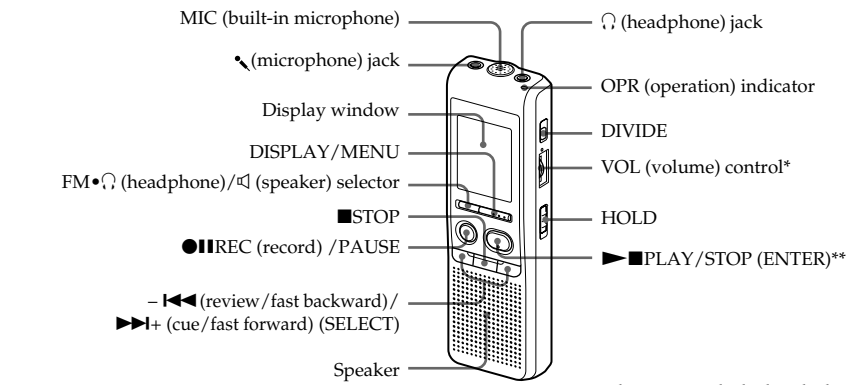

Rear

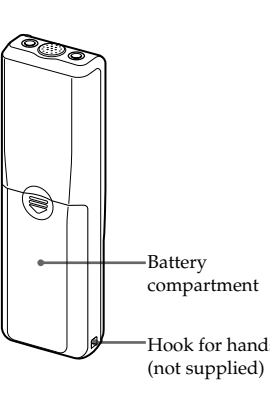

Display window

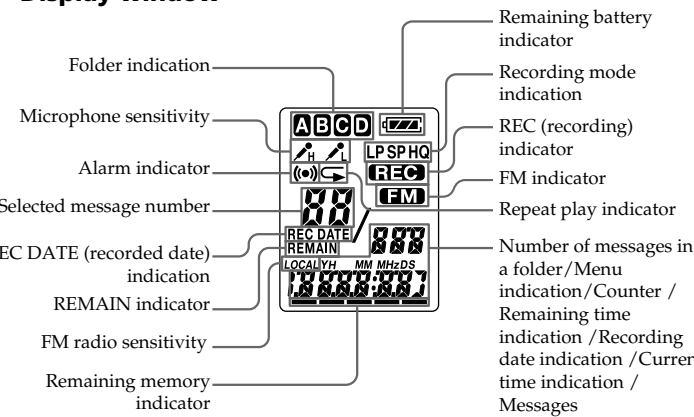

To cancel erasing
 Press STOP before step ②.

To erase other messages
 Repeat steps ① - ②.

To erase a message partially
 First divide the message and then follow the steps to erase the message.

To cancel erasing
 Press STOP before step ②.

* There is a tactile dot beside the control to show the direction to turn up the volume.
 **The button has a tactile dot.

Listening to an FM radio station

The display in the display window may be different from the actual one in some regions.

1 Press FM to enter FM radio mode.

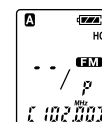

Note

The headphone cord is an FM antenna, therefore, connect the headphone when listening to the radio.

Switching the FM radio output between speaker and headphone

When a headphone is connected during FM reception or FM recording, you can switch between the sound from the speaker and from the headphone by pressing FM for more than 1 second. The sound will be switched between speaker and headphone.

Recording FM broadcasts

- 1 Press FM to enter the FM mode.
2 Tune in the station you want to record.
3 Press HIREC/PAUSE to start recording.
4 Press STOP to stop recording.

Press -<<< or >>> repeatedly to tune in a station or press and hold -<<< or >>> until the frequency digits begin to change on the display.
The IC recorder automatically scans the radio frequencies and stops when it finds a clear station.
If you cannot tune in a station, press -<<< or >>> repeatedly to change the frequency step by step.
When a station you tune in is a preset number, the preset number is displayed, otherwise, "--" appears instead.

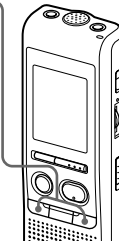

Presetting FM radio stations

The display in the display window may be different from the actual one in some regions. You can preset up to 25 FM radio stations in the IC recorder's memory.

1 Press FM to enter FM radio mode.



2 Tune in the station you want to preset and store on the preset number.

Press and hold PLAY/STOP until a preset number flashes on the display. The station will be stored in memory after 3 seconds.

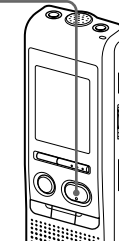
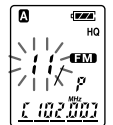

Presetting FM radio stations automatically

The display in the display window may be different from the actual one in some regions. You can preset up to 25 FM radio stations automatically in the preset menu.

1 Press FM to enter FM radio mode.

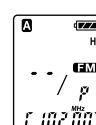

2 Preset stations automatically in the menu.

Press DISPLAY/MENU for more than 1 second until "AUTO-P" appears in the display window.

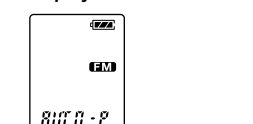

Press PLAY/STOP.

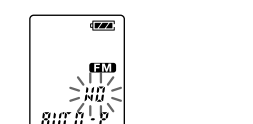

Press -<<< or >>> to select "YES" and press PLAY/STOP. The IC recorder automatically scans the radio frequencies and the stations will be stored in memory from the lower frequencies to the higher ones.

Press STOP to exit from the menu mode. If the unit is left unused for more than 3 seconds in the stop mode, the display will show the current time.

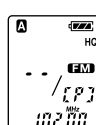
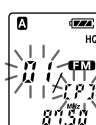

Listening to a preset radio station

The display in the display window may be different from the actual one in some regions.

1 Press FM repeatedly until "[P]" appears.

Tip

If you press FM repeatedly, the radio switches between tuning manually ("P" appears) and tuning by preset number ("[P]" appears).

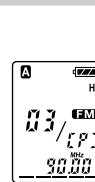

2 Tune in the station.

Press -<<< or >>> repeatedly until the preset number you want is displayed. When you press and hold -<<< or >>>, the preset numbers change rapidly.

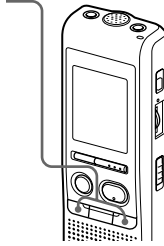

Press STOP to turn the FM radio off.

Erasing preset FM radio stations

The display in the display window may be different from the actual one in some regions.

1 Press FM repeatedly until "[P]" appears.

To cancel erasing

Press STOP before you press PLAY/STOP in step 2.

2 Press -<<< or >>> repeatedly until the preset number you want to erase is displayed.

3 Erase the preset number.

Press PLAY/STOP for more than 1 second. The preset number and "ERASE" flash in the display window.

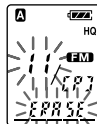

Press PLAY/STOP.

The preset number will be changed to "--".

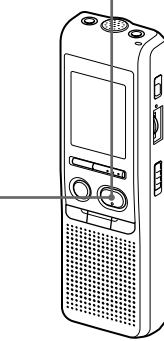
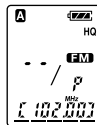

Various Ways of Recording

Adding a Recording to a Previously Recorded Message

You can add a recording to the message being played back. The added recording will be placed after the current message and counted as a part of the message.

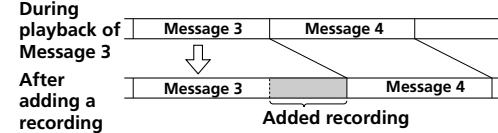

1 During playback, press and hold HIREC/PAUSE.

The "REC" indication appears. "ADD" will flash 3 times. The OPR indicator will light in red. An add or overwrite recording starts.

2 Press STOP to stop the recording.

Notes: You cannot add or overwrite a recording if the remaining memory is not long enough. The added portion of a message will be recorded in the same recording mode (HQ, SP, or LP).

Recording with an External Microphone or from Other Equipment

1 Connect a plug-in-power type microphone or other equipment to the microphone jack.

When recording with an external microphone

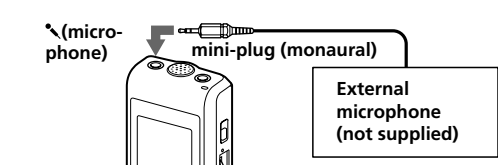

When you connect an external microphone, the built-in microphone is automatically cut off. When a plug in power type microphone is connected, power is automatically supplied to the microphone from the IC recorder.

When recording from other equipment

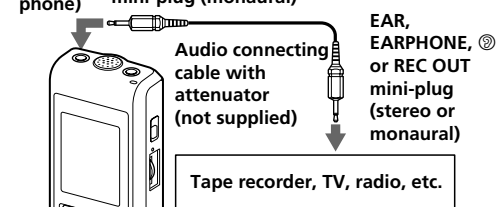

2 Follow the steps in "Recording Messages" on the front side to record messages.

Notes: Make sure that the plugs are connected securely. We recommend you make a trial recording to check the connections and volume control. When connecting equipment other than Sony's, refer to the instruction manual of the equipment.

Other Functions

Dividing a Message

You can divide a message during recording or playback, so that the message is divided into two and the new message number is added to the divided message. By dividing a message, you can easily find the point you want to play back when you make a long recording such as a meeting. You can divide messages until the total number of messages in the folder becomes 99.

While recording or playing back a message, press DIVIDE at the point you want to divide.

When you press DIVIDE during recording: The new message number is added at the point you pressed the button, and the new message number and "DIVIDE" flash three times. The message will be divided into two; however, the messages will be recorded without a break.

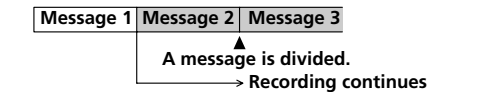

Tip: You can divide a message during recording pause.

When you press DIVIDE during playback: The message is divided into two at the point you pressed the button, and the new message number and "DIVIDE" flash three times. The message numbers of the following messages will increase by one.

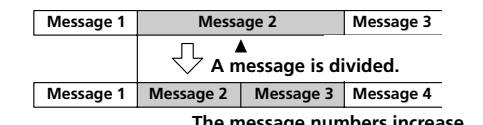

To play the divided message

Press -<<< or >>> to display the message number as the divided messages each have message numbers.

To play the divided messages continuously: Select "ON" for CONT in the menu as described in "Playing Back All Messages in a Folder Continuously".

Notes

- If 99 messages have been recorded in a folder, you cannot divide a message. In that case, reduce the number of messages to 98 or less by erasing unnecessary messages or by moving some of the messages to another folder before dividing a message.
If you divide a message with an alarm setting, the alarm setting remains only with the former message divided.
You cannot divide a message in the first or the last 1 second.
If you divide a message frequently, the unit may become unable to divide a message.
Once a message is divided, you cannot combine the divided messages with the IC recorder.

Moving Messages to a Different Folder — Move Function

You can move the recorded messages to another folder.

Example: Moving Message 3 in Folder A to Folder C

1 While the unit is stopped, select the message you want to move.

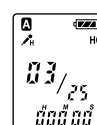

2 Press DISPLAY/MENU for more than 1 second until "MODE" appears in the display window.

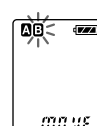

3 Press -<<< or >>> to select "MOVE" and press PLAY/STOP.

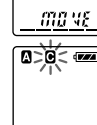

4 Press -<<< or >>> to select the folder to which you want to move the message (C in this case).

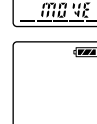

5 Press PLAY/STOP.

The message is moved in the destination folder.

6 Press STOP to exit the menu mode.

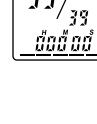

To cancel moving the message(s)

Press STOP before step 5.

Note

The move function does not duplicate a message in another folder. When you move a message to another folder, the one in the previous folder will be deleted.

Playing Back a Message at a Desired Time with an Alarm

You can sound an alarm and start playback of a selected message at a desired time. If you select "B-ONLY" in Step 6, an alarm sounds only and playback will not start.

1 Select the folder (See "Selecting the folder" on the front side) and display the message you want to play back with an alarm.



2 Enter the alarm setting mode. Press DISPLAY/MENU for more than 1 second until "MODE" appears in the display window.



3 Press -<<< or >>> to select "ALARM OFF" (if the alarm has already set to the selected message, "ALARM ON" is displayed. If you do not wish to change the setting, press STOP and exit the menu mode).

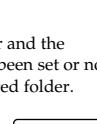

Note: "ALARM OFF (or ON)" will not appear and the alarm cannot be set if the clock has not been set or no message has been recorded in the selected folder.

4 Press PLAY/STOP. "OFF" starts to flash.



5 Press -<<< or >>> to select "ON". "ON" starts to flash.



6 Press PLAY/STOP. "DATE" will flash in the display window.



7 Set the alarm date. To play back on a desired date (the message will be played back at the same time on the same date every year until you erase the message)

8 Press PLAY/STOP while "DATE" is flashing. The year digits will flash.

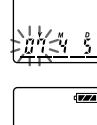

9 Press -<<< or >>> to select the year digits and press PLAY/STOP. The month digits will flash.

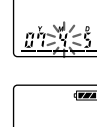

10 Press -<<< or >>> to select the month digits and press PLAY/STOP. The day digits will flash.

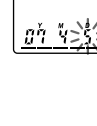

11 Press -<<< or >>> to select the day digits.

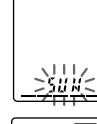

12 To play back once a week Press -<<< or >>> to select the day of the week.



13 To play back at the same time every day Press -<<< or >>> to select "DAILY".



14 Press PLAY/STOP. The hour digits will flash.



15 Set the alarm time. Press -<<< or >>> to select the hour digits and press PLAY/STOP. The minute digits will flash.



16 Press -<<< or >>> to select the minute digits and press PLAY/STOP. "B-PLAY" will be displayed.

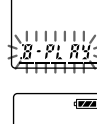

17 Set the alarm sound. Press -<<< or >>> to select the alarm sound either from "B-PLAY" (playing back the message after the alarm) or "B-ONLY" (alarm only)

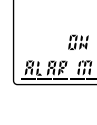

18 Press PLAY/STOP. "ALARM ON" will be displayed.

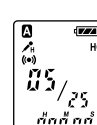

19 Press STOP to exit the menu mode.

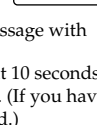

"00" is displayed when the number of the message with alarm setting is selected. At the set time, the alarm will sound for about 10 seconds and the selected message will be played back. (If you have selected "B-ONLY", only the alarm will sound.) During playback, "ALARM" will flash in the display window. When the playback ends, the unit will stop automatically at the beginning of that message.

To listen to the same message again

Press PLAY/STOP. The same message will be played back from the beginning.

To cancel the alarm setting before the playback starts: Press STOP while the alarm sound is heard. You can stop even when the HOLD function is activated.

Notes

- You cannot set the alarm if you have not set the clock or there is no message in the selected folder (the unit will not enter the alarm setting mode when you press DISPLAY/MENU in Step 2).
If you try to set the alarm to play back a message at a previously set time on another message, "PRE SET" will be displayed, preventing new settings.
If the alarm time comes while another message is being played back with an alarm, the playback stops and the new message will be played back.
If the alarm time comes during recording, alarm will sound for 10 seconds after the recording is finished and playback begins. "M" will flash when the alarm time comes.
If more than one alarm time comes during recording, only the first message will be played back.
When the alarm time comes when the unit is in the menu mode, alarm will sound and the menu mode will be canceled.
If you erase the message you set the alarm to play back, the alarm setting will be canceled.
If you divide a message with the playback alarm, playback will stop at the point you divided a message.
You can adjust the playback volume with the VOL control.
If the alarm time comes during erasing, alarm will sound for 10 seconds after the erasing is finished and playback begins.
Alarm setting will not be canceled when the alarm playback finishes. To cancel alarm setting, see below.

To cancel or change the alarm setting

- 1 Select the message you set the alarm to play back, and press DISPLAY/MENU for more than 1 second to enter the menu mode.
2 Press -<<< or >>> to select "ALARM ON".
3 Press PLAY/STOP to flash "ON".
4 To cancel the alarm setting: Press -<<< or >>> to flash "OFF" and press PLAY/STOP. To change the alarm setting: Press PLAY/STOP. When the alarm date is displayed, follow the Steps 3 to 6 of "Playing Back a Message at a Desired Time with an Alarm" to change the alarm setting.
5 Press STOP to exit the menu mode.

Preventing Accidental Operation — HOLD function

Slide the HOLD switch to "ON". "HOLD" will flash three times, indicating that all the functions of the buttons are locked. When the HOLD function is activated during stop, all the display will be turned off after "HOLD" flashes.

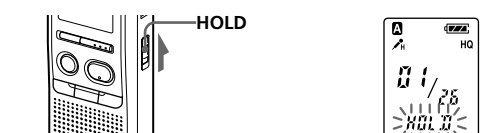

To cancel the HOLD function

Slide the HOLD switch to "OFF". Note: When the HOLD function is activated during recording, cancel the HOLD function first to stop recording.

Tip

Even if the HOLD function is activated, you can stop the alarm playback. To stop the alarm or playback, press STOP.

Selecting the Display Mode

You can select the display mode for the stop, recording and playback modes. Each time you press DISPLAY/MENU, the display mode will change as shown below:

On the current time display

If the unit is left unoperated for more than 3 seconds in the stop mode, the display will show the current time, regardless of the display mode setting.

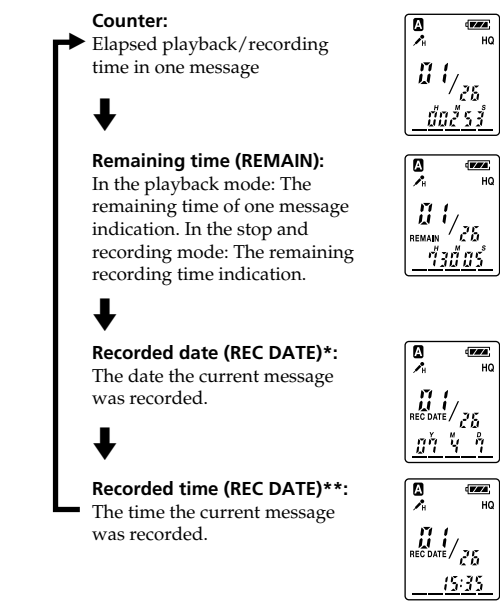

* If the clock has not been set, "--Y--M--D" will be displayed. ** If the clock has not been set, "--" will be displayed.

Turning off the Beep Sound

BEEP ON: A beep will sound to indicate that operation has been accepted. BEEP OFF: No beep sound will be heard except for the alarm and timer.

1 Press DISPLAY/MENU for more than 1 second until "MODE" appears in the display window.

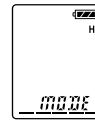

2 Press -<<< or >>> to display "BEEP ON (or OFF)" and press PLAY/STOP. "ON (or OFF)" will flash.

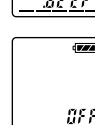

3 Press -<<< or >>> to select "ON" or "OFF" and press PLAY/STOP. The setting is completed.

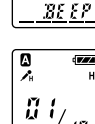

4 Press STOP to exit the menu mode.

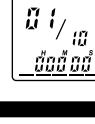

Precautions

On power

- Operate the unit only on 3 V DC. Use two LR03 (size AAA) alkaline batteries.

On safety

- Do not operate the unit while driving, cycling or operating any motorized vehicle.
On handling: Do not leave the unit in a location near heat sources, or in a place subject to direct sunlight, excessive dust or mechanical shock.
Should any battery or liquid or object fall into the unit, remove the batteries and have the unit checked by qualified personnel before operating it any further.

On noise

- Noise may be heard when the unit is placed near an AC power source, a fluorescent lamp or a mobile phone during recording or playback.

On maintenance

- Do not clean the exterior, use a soft cloth slightly moistened in water. Do not use alcohol, benzine or thinner.

If you have any questions or problems concerning your unit, please consult your nearest Sony dealer.

Backup recommendations

To avoid potential risk of data loss caused by accidental operation or malfunction of the IC recorder, we recommend that you save a backup copy of your recorded messages on a tape recorder, etc.

Specifications

IC recorder section

Recording media: Built-in flash memory 256 MB, Monaural recording. Actual usable capacity may be smaller.

Recording time: HQ: 30 hours 25 minutes, SP: 81 hours 15 minutes, LP: 150 hours 15 minutes

Frequency range: HQ: 260 Hz - 6,800 Hz, SP: 220 Hz - 3,400 Hz, LP: 220 Hz - 3,100 Hz

FM radio section

Frequency range: 87.5 - 108 MHz, IF: 225 kHz

Antennas: Headphone cord antenna

General

Speaker: approx. 2.8 cm (1 1/4 in.) dia.

Power output: 250 mW

Input/Output

- Headphone jack (minijack) for 8 - 300 ohms ear receiver/headphones
Microphone jack (minijack, monaural) Plug-in power Minimum input level 0.6 mV 3 kilohms or lower impedance microphone

Power requirements

Two LR03 (size AAA) alkaline batteries: 3 V DC

Dimensions (w/h/d) (not incl. projecting parts and controls): 34.6 x 109.5 x 18.0 mm (1 3/8 x 4 3/8 x 23/32 in.)

Mass (incl. batteries): 68 g (2.4 oz)

Supplied accessories

- Operating instructions (1)
LR03 (size AAA) alkaline batteries (2)
Headphone (1)
Carrying pouch (1) (excluding the U.S.A.)

Optional accessories

- Electret Condenser Microphone ECM-DM5P, ECM-CZ10, ECM-TL1 (for telephone recording)
Audio connecting cable RK-G64HG / RK-G69HG (excluding Europe)
Active speaker SRS-T88, SRS-T80

Your dealer may not handle some of the above listed optional accessories. Please ask the dealer for detailed information.

Design and specifications are subject to change without notice.