

FM/AM CD Clock Radio

Operating Instructions

DREAM MACHINE

Dream Machine is a trademark of Sony Corporation.

ICF-CD830

Sony Corporation © 2001 Printed in Thailand

Owner's Record

The model number and the serial number are located on the bottom.

Record the serial number in the space provided below. Refer to them whenever you call upon your Sony dealer regarding this product.

Model No. ICF-CD830

Serial No. _____

WARNING

To prevent fire or shock hazard, do not expose the unit to rain or moisture.

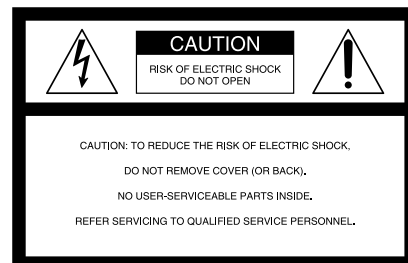

This symbol is intended to alert the user to the presence of uninsulated "dangerous voltage" within the product's enclosure that may be of sufficient magnitude to constitute a risk of electric shock to persons.



This symbol is intended to alert the user to the presence of important operating and maintenance (servicing) instructions in the literature accompanying the appliance.

* The graphical symbols are on the bottom of the enclosure.

INFORMATION

This equipment has been tested and found to comply with the limits for a Class B digital device, pursuant to Part 15 of the FCC Rules. These limits are designed to provide reasonable protection against harmful interference in a residential installation. This equipment generates, uses, and can radiate radio frequency energy and, if not installed and used in accordance with the instructions, may cause harmful interference to radio communications. However, there is no guarantee that interference will not occur in a particular installation. If this equipment does cause harmful interference to radio or television reception, which can be determined by turning the equipment off and on, the user is encouraged to try to correct the interference by one or more of the following measures:

- Reorient or relocate the receiving antenna.
- Increase the separation between the equipment and receiver.
- Connect the equipment into an outlet on a circuit different from that to which the receiver is connected.
- Consult the dealer or an experienced radio/TV technician for help.

You are cautioned that any changes or modifications not expressly approved in this manual could void your authority to operate this equipment.

CAUTION
The use of optical instruments with this product will increase eye hazard.

Before You Begin

Thank you for choosing the Sony CD clock radio! It will give you many hours of reliable service and listening pleasure.

Before operating the unit, please read these instructions thoroughly and retain them for future reference.

Features

- Triple alarm—enables you to wake up with your favorite CD, RADIO Station and/or buzzer.
- Extendable snooze—snooze time can be extended from 10 to 60 minutes in maximum.
- Various CD playmode with Shuffle/Repeat function.
- Wake up to any track of CD.
- Easy-to-see ALARM indicator.
- Summer time (daylight saving time) calculator.

Precautions

- Operate the unit on the power source specified in the "Specifications."
- The nameplate indicating operating voltage, etc. is located on the bottom of the unit.
- To disconnect the power cord (mains lead), pull it out by the plug, not the cord.
- Do not leave the unit in a location near a heat source such as a radiator or airduct, or in a place subject to direct sunlight, excessive dust, mechanical vibration, or shock.
- Allow adequate air circulation to prevent internal heat build-up. Do not place the unit on a surface (a rug, a blanket, etc.) or near materials (a curtain) which might block the ventilation holes.
- Should any solid object or liquid fall into the unit, unplug the unit and have it checked by a qualified personnel before operating it any further.
- When the casing becomes soiled, clean it with a soft cloth dampened with mild detergent solution. Never use abrasive cleansers or chemical solvents, as they may mar the casing.

If you have any questions or problems concerning your unit, please consult your nearest Sony dealer.

Troubleshooting

Should any problem occur with the unit, make the following checks to determine whether or not servicing is required. If the problem persists, consult the nearest Sony dealer.

The clock does not show the correct time.

- Has an electrical power outage lasting more than one minute occurred?

The CD, radio or buzzer alarm does not sound at the preset alarm time.

- Hasn't all ALARM indicator lights gone out?

The radio alarm is activated but no sound comes on at the preset alarm time.

- Is the TUNING dial set to a receivable radio station?
- Has VOLUME been adjusted ?

The CD player does not operate.

- Did you close the CD lid?
- Did you place the disc correctly? The disc should be placed with the labeled side up.
- Dusty or defective disc—Clean the disc with an optional cleaning cloth. Wipe the disc from the center out.
- Take out the CD and leave the CD compartment open for about an hour to get rid of moisture condensation.

Sporadic loss of sound in CD operation.

- Dusty or defective disc—Clean or replace the disc.
- Volume too high—Reduce the volume.
- Strong vibration.

Specifications

CD player section

System: Compact disc digital audio system

Laser diode properties: Material: GaAlAs
Wavelength: 780 nm
Emission duration: Continuous
Laser output: Less than 44.6 μW
(This output is the value measured at a distance of about 200 mm from the objective lens surface on the optical pick-up block with 7mm aperture.)

Frequency response: 20-20 000 Hz ± 1.5 dB

Wow and flutter: Below measurable limit

Radio section

Frequency range:
FM: 87.5-108 MHz
AM: 530-1 710 kHz

General

Time display:

12-hour system

Speaker:

66 mm (2 5/8 inches) dia., 4 Ω

Power outputs:

1.2W + 1.2W (at 10% harmonic distortion)

Power requirements:

120 V AC, 60 Hz

Dimensions:

Approx. 273 × 94.5 × 194.5 mm(w/h/d)
(Approx. 10 3/4 × 3 3/4 × 7 3/4 inches) incl. projecting parts and controls

Mass:

Approx. 1 705 g (3 lb 12 oz)

Design and specifications are subject to change without notice.

IMPORTANT SAFEGUARDS

For your protection, please read these safety instructions completely before operating the appliance, and keep this manual for future reference.

Carefully observe all warnings, precautions and instructions on the appliance and in the operating instructions, and adhere to them.

INSTALLATION

Water and Moisture

Do not use powerline operated appliances near water - for example, near a bathtub, washbowl, kitchen sink, or laundry tub, in a wet basement, or near a swimming pool, etc.

Heat

Do not place the appliance near or over a radiator or heat register, or where it is exposed to direct sunlight.

Ventilation

The slots and openings in the cabinet are provided for necessary ventilation. To ensure reliable operation of the appliance, and to protect it from overheating, these slots and openings must never be blocked or covered.

-Never cover the slots and openings with a cloth or other materials.

-Never block the slots and openings by placing the appliance on a bed, sofa, rug or other similar surface.

-Never place the appliance in a confined space, such as a bookcase, or built-in cabinet, unless proper ventilation is provided.

Accessories

Do not place the appliance on an unstable cart, stand, tripod, bracket, or table. The appliance may fall, causing serious injury to a child or an adult, and serious damage to the appliance. Use only a cart, stand, tripod, bracket, or table recommended by Sony.

-An appliance and cart combination should be moved with care. Quick stops, excessive force, and uneven surfaces may cause the appliance and cart combination to overturn.

Wall or Ceiling Mounting

If your appliance can be mounted to a wall or ceiling, mount it only as recommended by Sony.

USE

Power Source

This appliance should be operated only from the type of power source indicated on the marking label. If you are not sure of the type of electrical power supplied to your home, consult your dealer or local power company. For those appliances designed to operate from battery power, or other sources, refer to the operating instructions.

Grounding or Polarization

This appliance is equipped with a polarized AC power cord plug (a plug having one blade wider than the other), or with a three-wire grounding type plug (a plug having a third pin for grounding). Follow the instructions below:

-For the appliance with a polarized AC power cord plug:

This plug will fit into the power outlet only one way. This is a safety feature. If you are unable to insert the plug fully into the outlet, try reversing the plug. If the plug should still fail to fit, contact your electrician to have a suitable outlet installed. Do not defeat the safety purpose of the polarized plug by forcing it in.

-For the appliance with a three-wire grounding type AC plug:

This plug will only fit into a grounding-type power outlet. This is a safety feature. If you are unable to insert the plug into the outlet, contact your electrician to have a suitable outlet installed. Do not defeat the safety purpose of the grounding plug.

Overloading

Do not overload wall outlets, extension cords or convenience receptacles beyond their capacity, since this can result in fire or electric shock.

When not in use

Unplug the power cord of the appliance from the outlet when left unused for a long period of time. To disconnect the cord, pull it out by grasping the plug. Never pull the plug out by the cord.

Power-Cord Protection

Route the power cord so that it is not likely to be walked on or pinched by items placed upon or against them, paying particular attention to the plugs, receptacles, and the point where the cord exits from the appliance.

Lightning

For added protection for this appliance during a lightning storm, or when it is left unattended and unused for long periods of time, unplug it from the wall outlet and disconnect the antenna or cable system. This will prevent damage to the appliance due to lightning and powerline surges.

Object and Liquid Entry

Never push objects of any kind into the appliance through openings as they may touch dangerous voltage points or short out parts that could result in a fire or electric shock. Never spill liquid of any kind on the appliance.

Cleaning

Unplug the appliance from the wall outlet before cleaning or polishing it. Do not use liquid cleaners or aerosol cleaners. Use a cloth lightly dampened with water for cleaning the exterior of the appliance. Clean the appliance only as recommended by Sony.

Attachments

Do not use attachments not recommended by Sony, as they may cause hazards.

ANTENNAS

Outdoor Antenna Grounding

If an outdoor antenna or cable system is installed, follow the precautions below.

An outdoor antenna system should not be located in the vicinity of overhead power lines or other electric light or power circuits, or where it can come in contact with such power lines or circuits. WHEN INSTALLING AN OUTDOOR ANTENNA SYSTEM, EXTREME CARE SHOULD BE TAKEN TO KEEP FROM CONTACTING SUCH POWER LINES OR CIRCUITS AS CONTACT WITH THEM IS ALMOST INVARIABLY FATAL.

Be sure the antenna system is grounded so as to provide some protection against voltage surges and built-up static charges. Section 810 of the National Electrical Code provides information with respect to proper grounding of the mast and supporting structure, grounding of the lead-in wire to an antenna discharge unit, size of grounding conductors, location of antenna-discharge unit, connection to grounding electrodes, and requirements for the grounding electrode.

Antenna Grounding According to the National Electrical Code

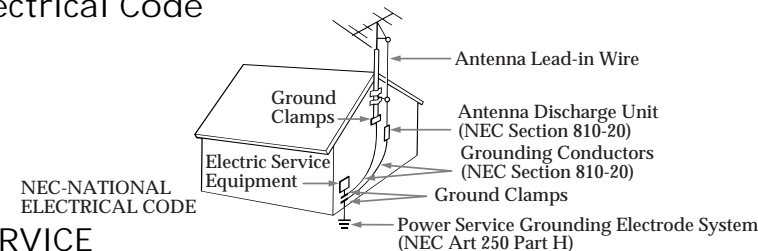

SERVICE

Damage Requiring Service

Unplug the appliance from the wall outlet and refer servicing to qualified service personnel under the following conditions:

- When the power cord or plug is damaged or frayed.
- If liquid has been spilled or objects have fallen into the appliance.
- If the appliance has been exposed to rain or water.
- The appliance does not appear to operate normally or exhibits a marked change in performance.
- This indicates a need for service.
- If the appliance does not operate normally when following the operating instructions, adjust only those controls that are specified in the operating instructions. Improper adjustment of other controls may result in damage and will often require extensive work by a qualified technician to restore the appliance to normal operation.
- If the appliance has been subject to excessive shock by being dropped, or the cabinet has been damaged.

Servicing

Do not attempt to service the appliance yourself as opening or removing covers may expose you to dangerous voltage or other hazards.

Refer all servicing to qualified service personnel.

Replacement parts

When replacement parts are required, be sure the service technician has used replacement parts specified by Sony that have the same characteristics as the original parts.

Unauthorized substitutions may result in fire, electric shock, or other hazards.

Safety Check

Upon completion of any service or repairs to the appliance, ask the service technician to perform routine safety checks (as specified by Sony) to determine that the appliance is in safe operating condition.

LIMITED WARRANTY
(Portable Audio)

FOB 30\$ 以上

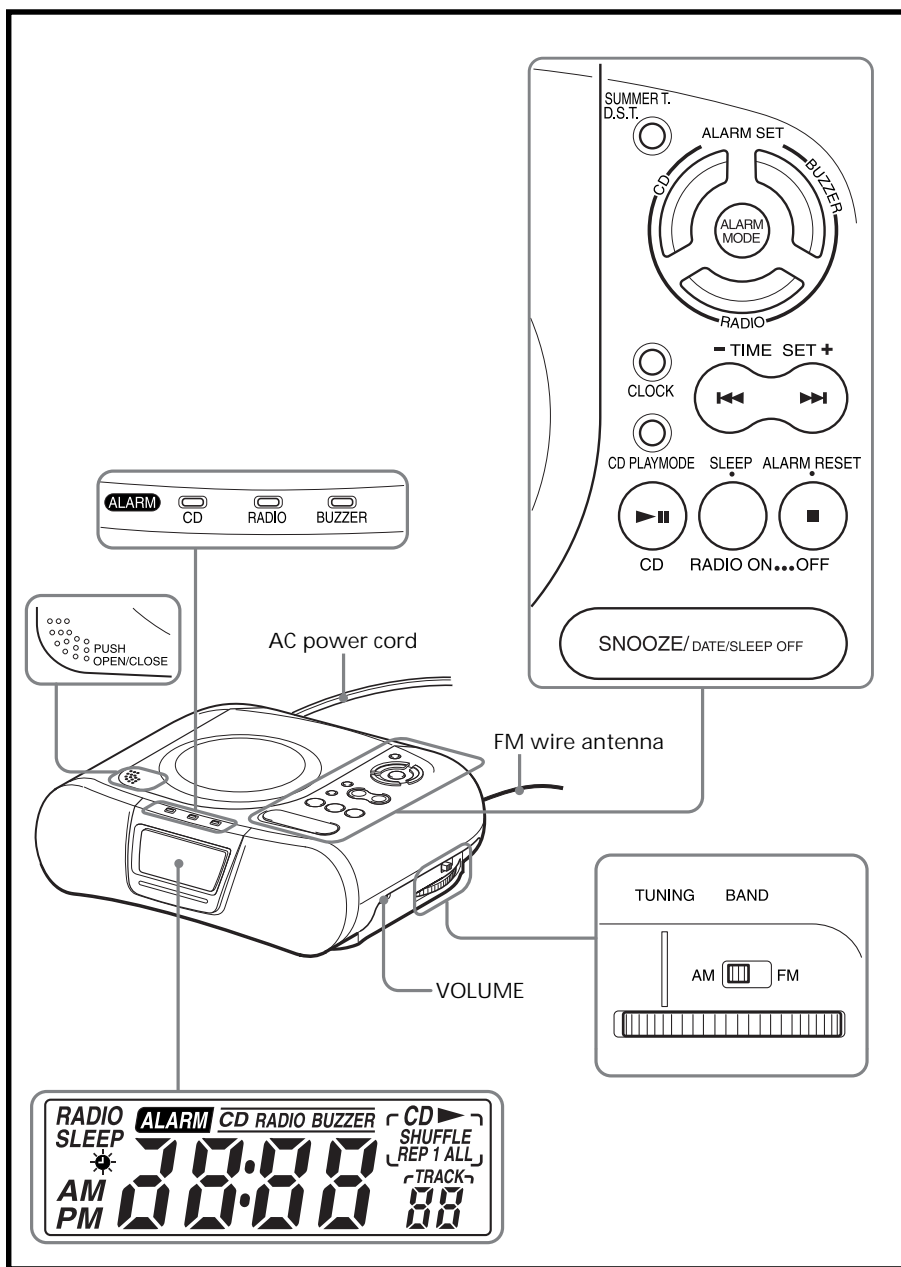

Setting the Clock and Date

- 1 Plug in the clock radio.
The display will flash "AM 12:00".
- 2 Press **CLOCK** for a few seconds.
You will hear a beep and the year will start to flash in the display.
- 3 Press **TIME SET +** or **-** until the correct year appears in the display.
- 4 Press **CLOCK** once.
- 5 Repeat steps 3 and 4 to set the month, day, hour, and minute.
After setting the minute, press **CLOCK** to start the counting of the seconds, and you will hear two short beeps.

- To display the year and date, press **SNOOZE/DATE/SLEEP OFF** once for the date, and within 2 seconds press it again for the year. The display shows the date or year for a few seconds and then changes back to the current time.
- To set the current time rapidly, hold down **TIME SET +** or **-**.
- In step 5, when you press **CLOCK** after the minute setting to activate the clock, the seconds start counting from zero.

To change the display to the daylight saving time (summer time) indication

Press **D.S.T./SUMMER T.**
"☀" is displayed and the time indication changes to summer time.

To deactivate the summer time function, press **D.S.T./SUMMER T.** again.

Playing a CD

An 8 cm (3-inch) CD can be played without an adaptor.

- 1 Push **OPEN/CLOSE** to open the CD compartment lid and place a disc.
- 2 Close the CD compartment lid.

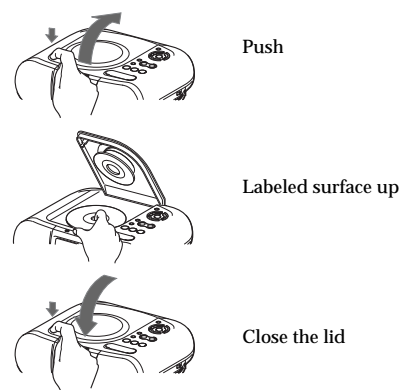

- 3 Press **CD ▶▶**.
"CD ▶▶" and "TRACK 01" appear on the display to indicate that track 1 of the CD is playing.

- 4 Turn **VOLUME** to adjust the volume.

To	Press
Pause	CD ▶▶
Resume play after pause	CD ▶▶ again
Locate the beginning of the current track (AMS*)	◀◀**
Locate the next track (AMS)	▶▶**
Go back at high speed	Hold down ◀◀**
Go forward at high speed	Hold down ▶▶**
Locate the previous track (AMS)	◀◀ repeatedly**
Locate the succeeding track (AMS)	▶▶ repeatedly**
Stop play	■

* AMS = Automatic Music Sensor

**These operations are possible during both play and pause.

- To handle compact discs

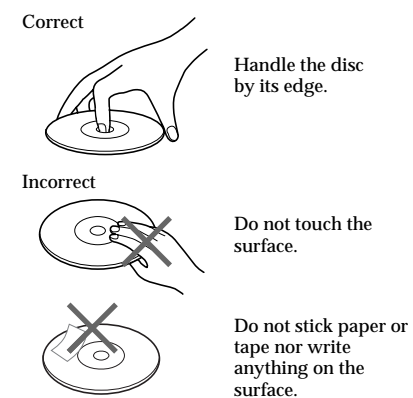

Notes

- Discs with non-standard shapes (e.g., heart, square, star) cannot be played on this unit. Attempting to do so may damage the unit. Do not use such discs.
- If you press **CD ▶▶** when there is no disc in the CD compartment, "00" flashes for about 5 seconds on the display and the unit turns off automatically.

Various Modes of CD Playback

You can play tracks repeatedly or in random order.

Press **CD PLAYMODE**.
Each press changes the play mode as follows:

Display Indication	Play mode
none	(normal play)
"REP 1"	(single repeat)
"REP ALL"	(all repeat)
"SHUFFLE"	(shuffle play)
"SHUFFLE REP"	(shuffle repeat)

Playing the Radio

- 1 Press **RADIO ON** to turn on the radio.
The "RADIO" indication will appear and the "On" indication will appear in the display. After 2 seconds, the indication becomes the current time with the "RADIO" indication.
- 2 Adjust **VOLUME**.
- 3 Select the **BAND**.
- 4 Tune in a station using the **TUNING** dial.

- To turn off the radio, press **RADIO OFF**.
- To improve radio reception
FM: Extend the FM wire antenna to improve FM reception.
AM: Rotate the unit horizontally for optimum reception. A ferrite bar antenna is built into the unit.

Setting the Alarm

This clock radio is equipped with 3 alarm modes—CD, radio and buzzer. Before setting the alarm, make sure to set the clock (see "Setting the Clock and Date").

To Set the Alarm Time

To set the CD alarm:
For the CD alarm, the track you specified as the Wake-up track is played first. (If the CD play mode is set to "SHUFFLE" or "SHUFFLE REP", however, all the tracks are played in random order.)

- 1 With the alarm turned on, adjust the volume to the level you require.
- 2 Press **ALARM SET CD** for a few seconds. "ALARM", "CD" and the wake-up track number appear on the display. After one beep, "ALARM" and the hour will start to flash in the display.
- 3 Press **TIME SET +** or **-** until the desired hour appears.
To set the hour rapidly, hold down **TIME SET +** or **-**.
- 4 Press **ALARM SET CD**.
The minute will flash.
- 5 Repeat step 2 to set the minute and press **ALARM SET CD**.
The wake-up track number flashes on the display.
- 6 Press **TIME SET +** or **-** to select the desired wake-up track number.
The wake-up track number can be set up to 99.
- 7 Press **ALARM SET CD**.
Two short beeps will confirm the setting.

To set the radio alarm:

- 1 Tune in to a station and adjust the volume.
- 2 Press **ALARM SET RADIO** for a few seconds.
"ALARM" and "RADIO" appear on the display. After one beep, "ALARM" and the hour will start to flash in the display.
- 3 Press **TIME SET +** or **-** until the desired hour appears.
To set the hour rapidly, hold down **TIME SET +** or **-**.
- 4 Press **ALARM SET RADIO**.
The minute will flash.
- 5 Repeat step 3 to set the minute and press **ALARM SET RADIO**.
Two short beeps will confirm the setting.

To set the buzzer alarm:

- 1 Press **ALARM SET BUZZER** for a few seconds.
"ALARM" and "BUZZER" appear on the display. After one beep, "ALARM" and the hour will start to flash in the display.
- 2 Press **TIME SET +** or **-** until the desired hour appears.
To set the hour rapidly, hold down **TIME SET +** or **-**.
- 3 Press **ALARM SET BUZZER**.
The minute will flash.
- 4 Repeat step 2 to set the minute and press **ALARM SET BUZZER**.
Two short beeps will confirm the setting.

To Set the Alarm Mode

Before setting the alarm mode, be sure to set the alarm time. (See "To Set the Alarm Time".)

Repeat the pressing of **ALARM MODE** to select the alarm mode you want. Every time you press **ALARM MODE**, **CD/RADIO/BUZZER** indicator and "ALARM" on the display changes in the order as follows:

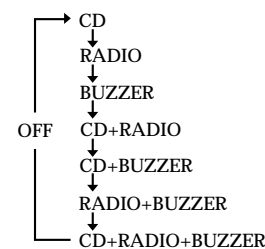

To Check the Alarm Time

Press **ALARM SET CD**, **ALARM SET RADIO** or **ALARM SET BUZZER**.
The display shows the alarm time for a few seconds and then returns to show the current time.

- Alarm time in CD alarm, radio alarm and buzzer alarm is set at AM 12:00 when you purchased the unit.

ALARM ON—

For the CD alarm, the track you specified as the Wake-up track is played first. (If the CD play mode is set to "SHUFFLE" or "SHUFFLE REP", however, all the tracks are played in random order.)

If you set the CD alarm and there is no disc in the CD player, the buzzer alarm will sound in its place at the time set.

For the radio alarm, the station that the tuning dial is set to will be received.

For the buzzer alarm, the beeping of the alarm becomes more rapid after every few seconds in three progressive stages.

Note

When CD, radio and buzzer alarms are set for the same time, the CD alarm takes precedence. If the CD alarm is not set, the radio alarm takes precedence.

To Doze for a Few More Minutes

Press **SNOOZE/DATE/SLEEP OFF**.

The CD, radio or buzzer alarm turns off but will be automatically activated again after about 10 minutes. Every time you press **SNOOZE/DATE/SLEEP OFF**, the snooze time changes as follows:

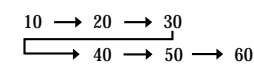

The display shows the snooze time for a few seconds and returns to show the current time. When you press **SNOOZE/DATE/SLEEP OFF** after the current time appeared, the snooze time starts from 10 minutes again.

- The maximum length of the snooze time is 60 minutes.

ALARM OFF—

The alarm is turned off automatically after 60 minutes.

To Stop the Alarm

Press **ALARM RESET** to turn off the alarm.

The alarm will come on again at the same time the next day.

To Cancel the Alarm

Press **ALARM MODE** repeatedly until **CD/RADIO/BUZZER** indicator lights go out.

Setting the Sleep Timer

You can enjoy falling asleep to the radio using the built-in sleep timer that turns off the radio automatically after a preset duration. Press **RADIO ON•SLEEP**.

The radio turns on. You can set the sleep timer to durations of 90, 60, 30, or 15 minutes. Every push changes the display as follows:

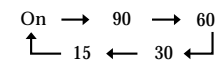

Two short beeps sound when the display returns to "On".
"SLEEP" will appear in the display when the duration time is set.
The radio will play for the time you set, then shut off.

- To turn off the radio before the preset time, press **SNOOZE/DATE/SLEEP OFF**.

To Use Both the Sleep Timer and the Alarm

You can enjoy falling asleep to the radio and be awakened by the CD, radio or buzzer alarm.

- 1 Set the alarm. (See "Setting the Alarm".)
- 2 Set the sleep timer. (See "Setting the Sleep Timer".)