

Thank you for purchasing this Sony product.

After following this step by step guide you will be able to:

- Remove the Rear Cover.
- Connect the Aerial, VCR and AC Cable to your TV.
- Insert Batteries into the Remote.
- Select the Language of the Menu Screens.
- Select the Country in which You Wish to Operate your TV.
- Tune your TV.
- Change the Programme Order of the Broadcast Channels.

Now you are ready for viewing TV programmes.

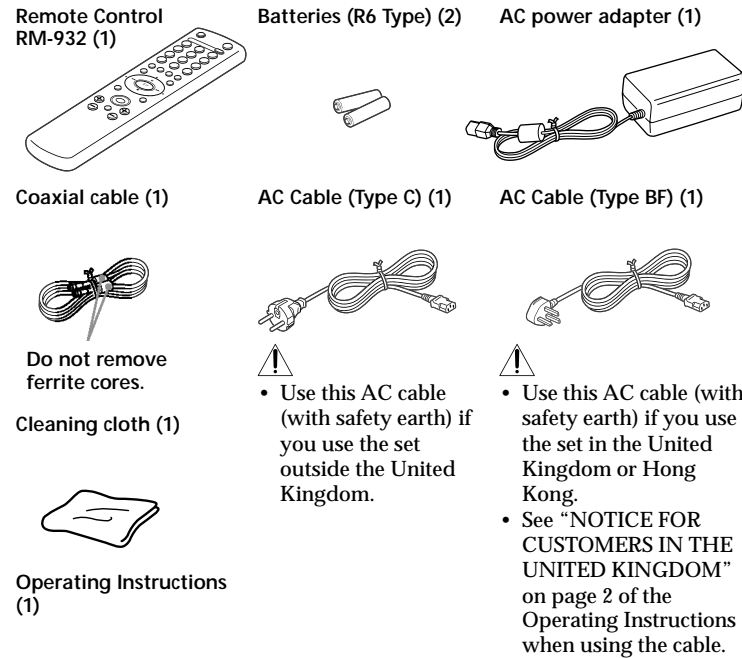

Removing the Rear Cover

Before connecting an aerial and cables, remove the cover at the rear of your TV. Replace the cover after all the connections are complete.

To remove the rear cover

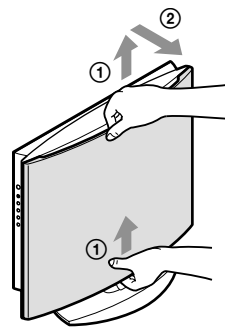

- ① Hold the rear cover as illustrated, and slide it upward by about 10 mm.
- ② Pull the rear cover toward you.

To replace the rear cover

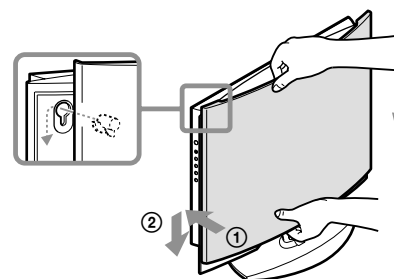

- ① Hold the rear cover as illustrated, and align the four projections on the rear cover with the hook holes on the TV. (The rear cover may protrude from the TV by about 10 mm.)
- ② While pushing the rear cover toward the TV, slide it downward.

Note

- When you carry the TV, do not hold the rear cover only, as the rear cover can easily come off.

Connect the aerial

CAUTION

Do not connect the power cord until all other connections are complete; otherwise, a minimal current leakage through the aerial and/or other terminals to the ground could occur.

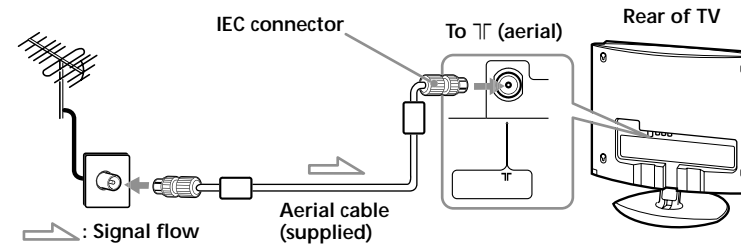

Connect a VCR

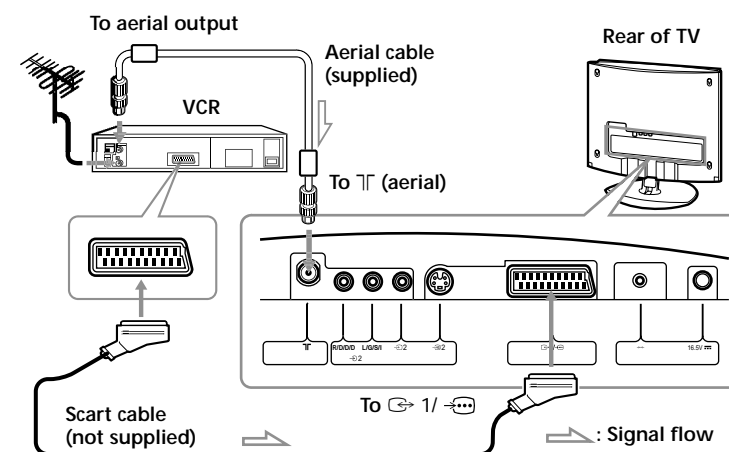

To play a video tape, press on the remote.

Note

- For connecting a VCR to the 2 connectors, see "Connecting optional components" on page 11 of the Operating Instructions.

Connect the AC cable

To connect the TV to the mains, use the supplied AC power adapter and AC cable.

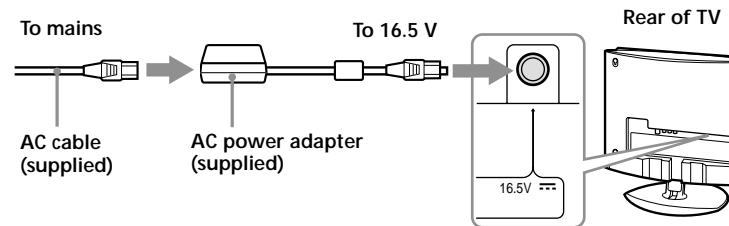

Note

- Do not remove the ferrite core from the AC power adapter.

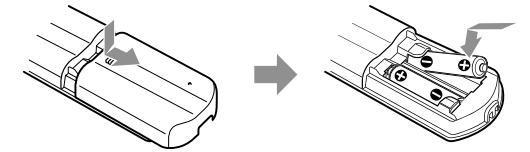

Note

- Do not use old batteries or different types of batteries together.

To put the cables in the stand

You can put the aerial cable, AC power adapter cable and Scart cable in the stand.

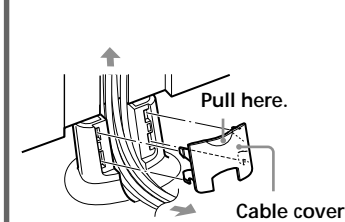

- ① Pull the upper edge of the cable cover toward you and remove it.
- ② Pass the cables into the stand.
- ③ Replace the cable cover while aligning the claws on the cover with the holes on the stand.

Note

- The other cables may not be put in the stand.

To adjust the TV angle

You can adjust the angle of the TV for easy viewing.

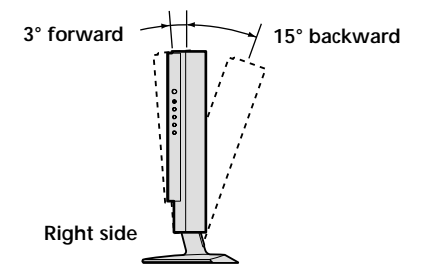

Carrying the TV

- Before carrying the TV, disconnect all the cables from the TV. If it drops, a serious injury may result.
- When you carry the TV for repair or moving, pack it using the original carton and packing material.
- When you carry the TV by hand, hold it at the top and bottom. Do not hold the rear cover only.

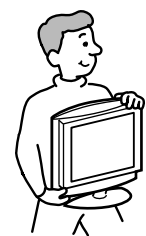

Turning on your TV

5

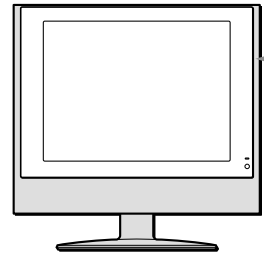

- 1 Connect the TV to the mains socket (220 - 240 V AC, 50 Hz).
- 2 Press I / ⏻ to turn on the TV.

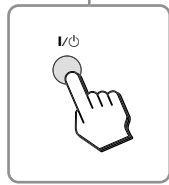

Selecting the Language of the Menu Screens and the Country

When you turned on the TV for the first time, a menu screen sequence appears on the TV enabling you to set up your TV easily (Auto Startup).

6

When you press I / ⏻ for the first time, the "LANGUAGE" menu appears automatically for Auto Startup.

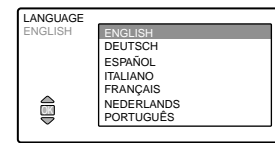

- 1 Press ↓ or ↑ on the remote to select the language, then press OK.

Now, all the menus will appear in the selected language.

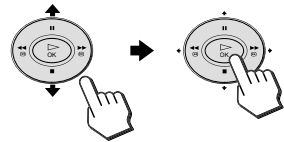

The "COUNTRY" menu appears automatically.

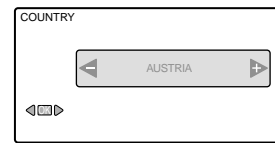

- 2 Press ← or → to select the country in which you will operate the TV, then press OK.

If your country does not appear in the options, select "-."

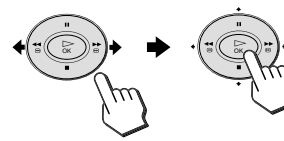

The initial display appears.

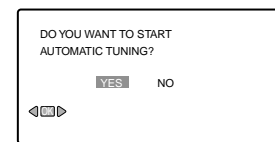

Note

- To perform Auto Startup later, press ⏻ on the rear panel of the TV.

Tuning the TV Automatically

When you changed the country setting, you need to tune the TV to receive channels (TV broadcast). By following the instructions, the TV automatically searches for broadcast channels and stores all available channels.

7

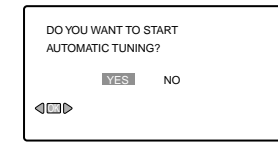

Press ← or → to select "YES," then press OK.

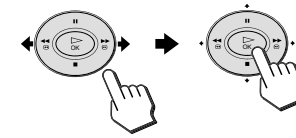

The TV starts searching for broadcast channels and stores all the available channels.

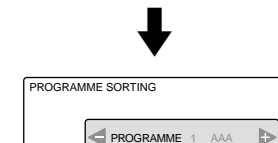
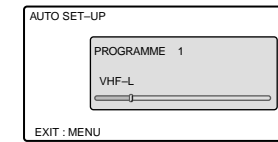

When all the available channels are stored, the "PROGRAMME SORTING" menu appears.

Changing the Programme Order of the Broadcast Channels

You can rearrange the order of the broadcast channels which have been stored automatically.

8

a) If you want to keep the broadcast channels in the tuned order:

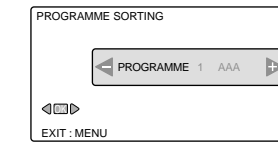

Press MENU to return to the normal screen.



Your TV is now ready for use.

b) If you want to store the broadcast channels in a different order:

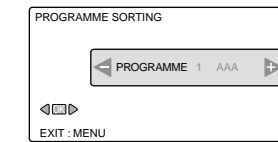

- 1 Press ← or → to select the programme number of the channel whose order you want to rearrange, then press OK.

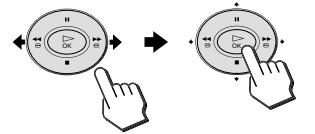

- 2 Press ← or → to select a new programme number for the selected channel, then press OK.

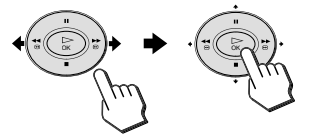

Repeat steps 1 and 2 to change the order of the other channels.

- 3 Press MENU to return to the normal screen.



Your TV is now ready for use.

Supplied Remote Control

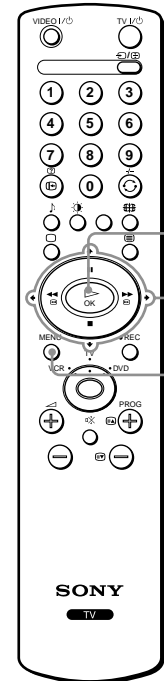

OK

↓ / ↑ / ← / →

MENU

SONY

TV