

Troubleshooting

Should a problem occur, first check the following basic points. If the problem persists after you have made these checks, consult your nearest Sony dealer.

Cause and remedy	
The unit does not operate.	<ul style="list-style-type: none">• Connect the AC power adaptor to a wall outlet.
No sound from the built-in speaker.	<ul style="list-style-type: none">• Turn up the volume.• An earphone is plugged in.
The tape speed is too fast or too slow.	<ul style="list-style-type: none">• Set the SPEED selector correctly.• Adjust the SPEED CONTROL.
The tape stops in the rewind or fast forward mode and the alarm sounds.	<ul style="list-style-type: none">• The entire tape has been wound onto the right or left reel.
Sound drop-outs, loss of high frequency sounds, or excessive noise.	<ul style="list-style-type: none">• The heads are dirty. See "Maintenance".

Specification

Tape	(MICROCASSETTE) TM (normal position type)	Power consumption	600 mA
Track system	2-track 1-channel monaural	Dimensions	Approx. 133 × 61.5 × 230 mm (w/h/d) (5¼ × 2½ × 9¼ inches) not incl. projecting parts and controls
Tape speed	2.4 cm/sec. (15/16 ips), 1.2 cm/sec. (15/32 ips)	Weight	Approx. 0.8 kg (1 lb 12 oz)
Tape speed control	-10% to +50%	Supplied accessories	Earphone (1) Foot control unit (1) AC power adaptor (1)
Auto back space	Approx. 0/1/3 sec.	Design and specifications subject to change without notice.	
Frequency response	250—4,000 Hz (at 2.4 cm position)	Optional Accessories	Microphone ECM-F01, ECM-K7 Micro cassette MC-30, MC-60, 3MC-60 Telephone pickup TP-15 Cassette eraser BE-9H
Speaker	5 cm (2 inches) dia. 300 mW		
Power output	MIC (PLUG IN POWER): minijack, sensitivity 0.3mV for 3 kilohm or lower impedance		
Input	EARPHONE: minijack, for an 8-300 ohm earphone DC IN 9 V jack accepts the supplied AC power adaptor.		
Output			
Power requirements			

SONY

3-750-533 2111

MicrocassetteTM Transcriber

M-2000

Operating Instructions

Before operating the unit, please read this manual thoroughly, and retain it for future reference.

Owner's Record

The model and serial numbers are located at the bottom. Record the serial number in the space provided below. Refer to these numbers whenever you call upon your Sony dealer regarding this product.

Model No. M-2000 Serial No. _____

WARNING

To prevent fire or shock hazard, do not expose the unit to rain or moisture.

To avoid electrical shock, do not open the cabinet. Refer servicing to qualified personnel only.

INFORMATION

This equipment generates and uses radio frequency energy and if not installed and used properly, that is, in strict accordance with the manufacturer's instructions, may cause interference to radio and television reception. It has been type tested and found to comply with the limits for a Class B computing device in accordance with the specifications in Subpart J of Part 15 of FCC Rules, which are designed to provide reasonable protection against such interference in a residential installation. However, there is no guarantee that interference will not occur in a particular installation. If this equipment does cause interference to radio or television reception, which can be determined by turning the equipment off and on, the user is encouraged to try to correct the interference by one or more of the following measures:

Reorient the receiving antenna

Relocate the equipment with respect to the receiver

Move the equipment away from the receiver

Plug the equipment into a different outlet so that equipment and receiver are on different branch circuits.

If necessary, the user should consult the dealer or an experienced radio/television technician for additional suggestions. The user may find the following booklet prepared by the Federal Communications Commission helpful:

"How to Identify and Resolve Radio-TV Interference Problems". This booklet is available from the U.S. Government Printing Office, Washington, DC 20402, Stock No. 004-000-00345-4.

Overview

- Auto backspace function makes transcribing easy by reviewing the last few recorded words each time listening is resumed.
- Adjustable tape speed and tone control.
- Two alarms (End-of-tape, No-cassette) alert you.

Precautions

- Use the supplied AC power adaptor. Do not use any other AC power adaptor as it may cause malfunction.
- The nameplate indicating operating voltage, power consumption, and the caution labels are located at the bottom.
- Unplug the unit from the wall outlet when it is not to be used for an extended period of time. To disconnect the cord, pull it out by grasping the plug. Never pull it by the cord.
- Use only the "MICROCASSETTE"™ with this unit.
- Two tape speeds can be selected for recording with the TAPE SPEED selector: 2.4 cm/sec. or 1.2 cm/sec. Match the playback speed to the recording speed.
- Do not install the unit in a location near heat sources such as radiators or airducts, or in a place subject to direct sunlight, excessive dust, mechanical vibration, or shock.
- Allow adequate air circulation to prevent internal heat build-up. Do not place the unit near materials (curtains, draperies) that may block the ventilation holes.
- Should any solid object or liquid fall into the unit, unplug the unit and have it checked by qualified personnel before operating it any further.

Notes on Cassettes

Slack in the tape

Before inserting, take up any slack in the tape by using a pencil.

To prevent accidental erasure

When a recording is made, the previous recording is automatically erased. To prevent erasure, break the cassette tabs.

To record on a cassette with removed tabs
Cover each slot with a piece of plastic tape.

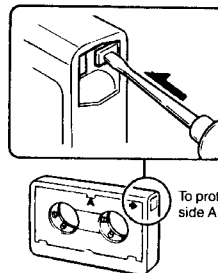

Note on the Microcassette

This unit uses only modern standard Microcassettes. The non-standard Microcassettes cannot be used because their "L" dimension shown in the illustration below is different.

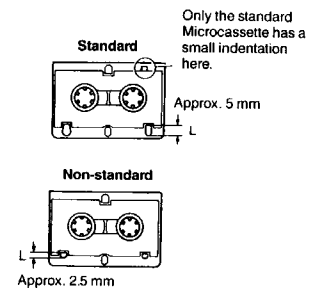

Location and Function of Controls

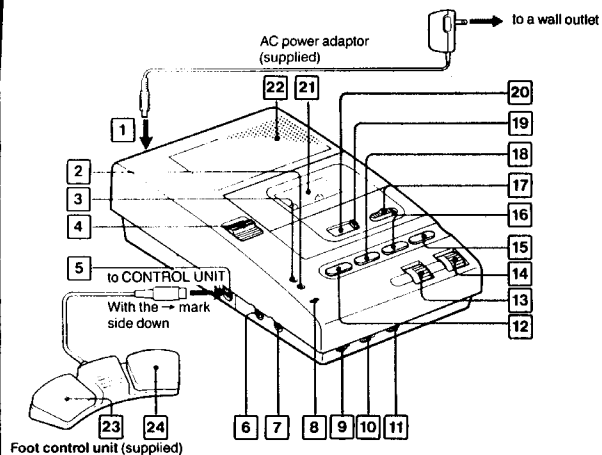

- 1** DC IN 9 V jack (external power input) jack
- 2** OPR (operation) indicator
The indicator illuminates during tape operation.
- 3** REC (record) indicator
The indicator illuminates during recording.
- 4** EJECT (cassette eject) lever
- 5** CONTROL UNIT connector
- 6** MIC (external microphone) (PLUG IN POWER)
- 7** EARPHONE jack (minijack)
- 8** MIC (built-in microphone)
- 9** SPEED selector
2.4 cm: A 60-minute recording can be made using both sides of the MC-60 Microcassette. This setting produces optimum sound and is recommended for normal use.
1.2 cm: A 120-minute recording can be made using both sides of the MC-60.
- 10** REVERSE TIME (0/1/3) (autobackspace time) control

- 11** TONE control
Slide toward H (high) to reinforce treble, and L (low) to weaken it.
- 12** REW (rewind) button
- 13** SPEED CONTROL (tape speed control)
- 14** VOLUME control
- 15** FF (fast forward) button
- 16** PLAY button
- 17** Recording (STOP/REC) switch
- 18** STOP button
- 19** RESET button
Press to reset the counters to zero.
- 20** Tape counter
- 21** Cassette compartment
- 22** Built-in speaker
- 23** Rewind pedal
- 24** Playback pedal

Transcribing

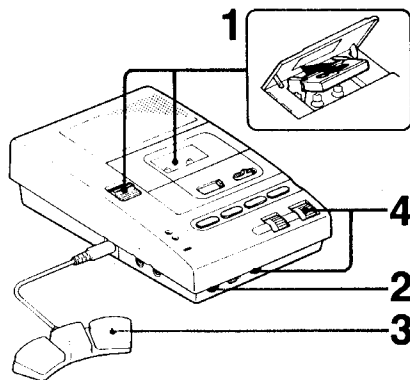

Before operating the unit, connect the AC power adaptor to a wall outlet.

- 1** Slide EJECT and insert a cassette.
- 2** Set SPEED to the same tape speed as that used for recording.
- 3** Keep the right side of the pedal depressed to listen to the tape.
- 4** Adjust VOLUME and TONE.

To stop the tape, release the pedal.
You can control the unit with the buttons on itself as well.

Use of foot control unit

The foot control unit leaves your hands free, enabling you to control this transcriber with your foot.

Auto backspace

The tape rewinds a little each time it is stopped and the last few recorded words can be reviewed when you resume listening. Adjust REVERSE TIME to the desired length (1 position: 1 second, 3 position: 3 seconds). At the 0 position, the tape stops without rewinding at all. This functions only when the foot control unit is used.

Speed control

The tape speed is adjustable with SPEED CONTROL. The tape runs at normal speed with the control set to the center click position.

Recording

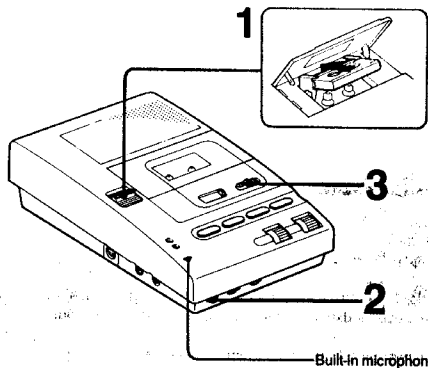

1 Slide EJECT and insert a cassette.

2 Select the tape speed with the SPEED selector.

3 Slide the recording switch to REC and start recording.

The REC indicator and OPR indicator illuminate during recording.

To stop the tape, slide the recording switch to STOP.

No recording level adjustment is necessary.

When monitoring the recording

The recording can be monitored through an earphone (supplied). Adjust VOLUME, if necessary.

What to be recorded

Conference or interview

Use the built-in microphone or Sony optional microphone.

Telephone conversation

Use Sony telephone pickup TP-15.

Indexing the contents

Before recording, press RESET on the unit to reset the counters to zero. Note the tape counter reading at a desired point to locate the point later.

Maintenance

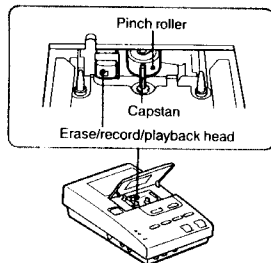

Cleaning the heads

To produce optimum sound, keep the tape heads clean.

Moisten a cotton swab or a soft cloth with alcohol, and wipe the parts shown on the left.

Cleaning the cabinet

Clean the cabinet with a soft cloth slightly moistened with a mild detergent solution. Never use strong solvents, such as thinner or benzene, since they may damage the finish.

Alarm System

A continuous alarm sounds in the following situations.

Unit	Function	Situation and indicator
Main unit	REW	No cassette, or the cassette tabs have been removed.
	LISTEN	
	FF	The end/beginning of the tape.
	REC	
Foot control	PLAY	
	REW	

When the tape reaches its end or beginning, the unit automatically shuts off.

To stop the alarm sound

When you use the main unit, the alarm stops automatically at the end or beginning of the tape. However, when using the foot control, release it to stop the alarm.