

Radio Cassette Player

Operating instructions



WM-FX496ST/FX494

Sony Corporation © 2001 Printed in Malaysia

Sony online <http://www.world.sony.com/>

WALKMAN is a registered trademark of Sony Corporation.

CE The CE mark on the unit is valid only for products marketed in the European Union.

N50 The C-Tick mark on the unit is valid only for the products marketed in Australia.

Owner's Record

The model number is located at the bottom and the serial number is located inside the cassette holder. Record these numbers in the space provided below. Refer to them whenever you call upon your Sony dealer regarding this product.

Model No. _____
Serial No. _____

INFORMATION

This equipment has been tested and found to comply with the limits for a Class B digital device, pursuant to Part 15 of the FCC Rules. These limits are designed to provide reasonable protection against harmful interference in a residential installation. This equipment generates, uses, and can radiate radio frequency energy and, if not installed and used in accordance with the instructions, may cause harmful interference to radio communications. However, there is no guarantee that interference will not occur in a particular installation. If this equipment does cause harmful interference to radio or television reception, which can be determined by turning the equipment off and on, the user is encouraged to try to correct the interference by one or more of the following measures:

- Reorient or relocate the receiving antenna.
- Increase the separation between the equipment and receiver.
- Connect the equipment into an outlet on a circuit different from that to which the receiver is connected.
- Consult the dealer or an experienced radio/TV technician for help.

This device complies with Part 15 of the FCC Rules. Operation is subject to the following two conditions: (1) This device may not cause harmful interference, and (2) this device must accept any interference received, including interference that may cause undesired operation.

You are cautioned that any changes or modifications not expressly approved in this manual could void your authority to operate this equipment.

If you have any questions about this product, you may call: Sony Direct Response Center 1-(800)-222-7669

or write to: Sony Direct Response Center 12451 Gateway Blvd. Fort Myers, FL 33913

Declaration of Conformity

Trade Name: SONY
Model No.: WM-FX494
Responsible Party: Sony Electronics Inc.
Address: 680 Kinderkamack Road, Oradell, NJ 07649 USA
Telephone No.: 201-930-6972

This device complies with Part 15 of the FCC Rules. Operation is subject to the following two conditions: (1) This device may not cause harmful interference, and (2) this device must accept any interference received, including interference that may cause undesired operation.

Other tape operations

To	Press
Fast forward*	FF during stop
Rewind*	REW during stop
Play the same side from the beginning (Auto Play function)	REW during playback
Play the other side from the beginning (Skip Reverse function)	FF during playback

* If ◀▶ on the remote control is pressed during fast forward or rewind, the Walkman switches to playback.

To select playback mode
Press MENU repeatedly to set the cursor to MODE in the display.
Then press SET to select the desired mode.

To play	Select
Both sides repeatedly	↺
Both sides once from the side facing the cassette holder	↻

Using Other Functions

Locking the controls

Set the HOLD switch to the direction of the arrow to lock the controls.

Emphasizing bass sound

Press MENU repeatedly to set the cursor to MB in the display. Then, press SET to turn MB on. With each press, the indications change as follows.
MB (MEGA BASS) : emphasizes bass sound
No message: off (normal)

Notes

- If the sound is distorted with the mode "MB", turn down the volume of the main unit or select normal mode.
- Bass emphasis may not show great effect if the volume is turned up too high.

Protecting your hearing—AVLS (Automatic Volume Limiter System)

Press MENU repeatedly to set the cursor to AVLS in the display. Then press SET to show "AVLS". The maximum volume is kept down to protect your ears.

Note

- The AVLS setting will be canceled when you replace the batteries.

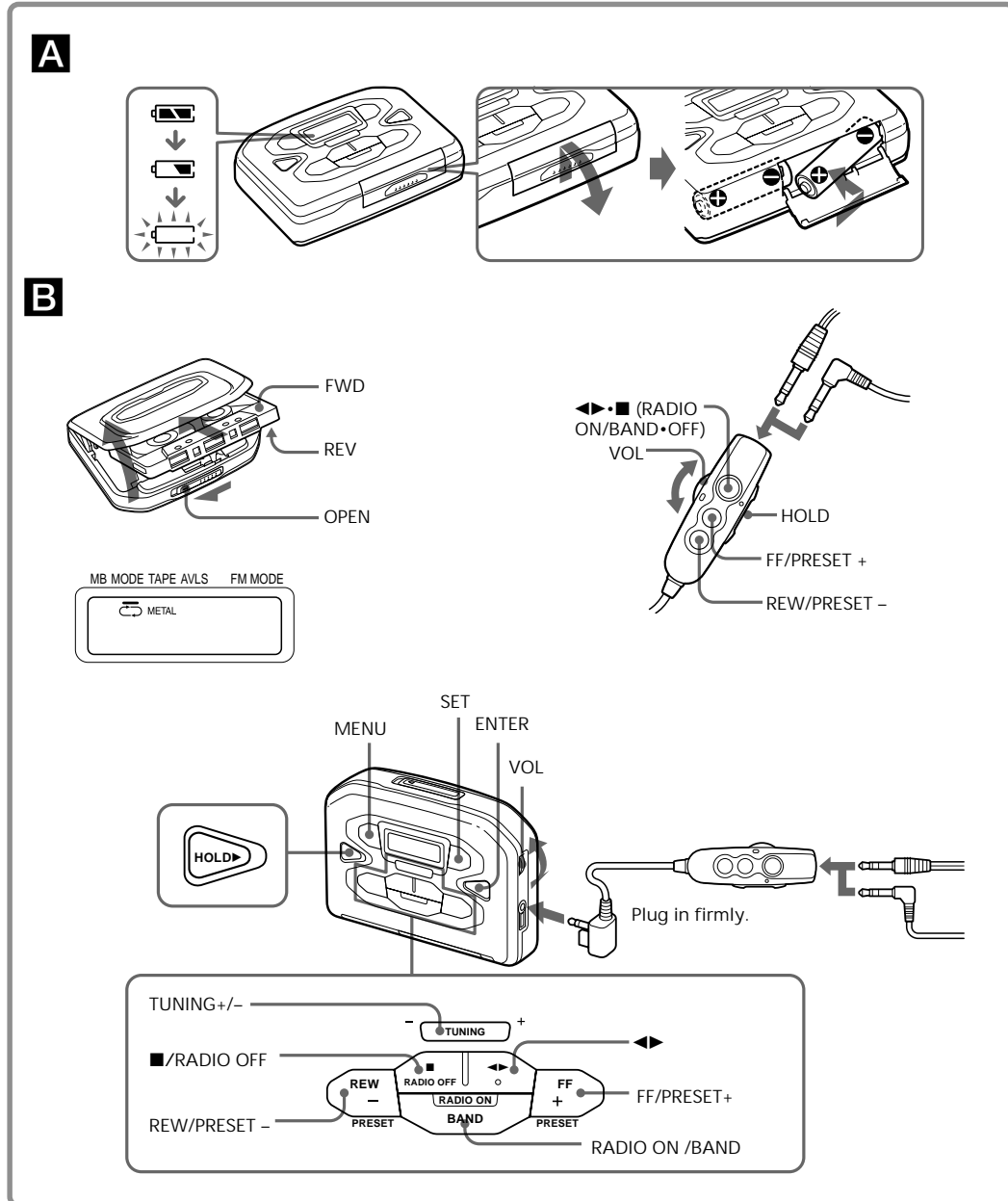

Preparations

To Insert Batteries **A**

- Slide and open the battery compartment lid, and insert two R6 (size AA) dry batteries with correct polarity.

Replace the batteries with new ones when " " flashes in the display.

Playing a Tape **B**

- If the HOLD function is turned on, slide the HOLD switch in the opposite direction of the arrow to unlock the controls.
- Insert a cassette and press MENU repeatedly to set the cursor to TAPE in the display. Then press SET to select the tape type.
No message: normal (TYPE I)
METAL: High-position (TYPE II) or metal (TYPE IV)
- Press ◀▶ on the main unit, or if using the remote control, press ◀▶ (play) •■ (stop).
Adjust the volume with VOL.

When adjusting the volume on the main unit
Set the VOL control on the remote control at maximum.

When adjusting the volume on the remote control
Set the VOL control on the main unit slightly above the appropriate level.

Note on the cassette holder

When opening the cassette holder, press the ■ (stop) button and make sure the tape is stopped by checking through the cassette window, then slide the OPEN switch.

If the cassette holder is opened before the tape is stopped, the tape may loosen and be damaged.

Operation on the main unit

To	Press
Switch playback to the other side	◀▶ (play) during playback
Stop playback	■

Operation on the remote control

To	Press
Switch playback to the other side	◀▶ •■ for 2 seconds or more during playback
Stop playback	◀▶ •■ once during playback

This warranty is valid only in the United States.

SONY

LIMITED WARRANTY Portable Audio

Sony Electronics Inc. ("Sony") warrants this Product (including any accessories) against defects in material or workmanship as follows:

- LABOR:** For a period of 90 days from the date of purchase, if this Product is determined to be defective, Sony will repair or replace the Product, at its option, at no charge, or pay the labor charges to any Sony authorized service facility. After the Warranty Period, you must pay for all labor charges.
- PARTS:** In addition, Sony will supply, at no charge, new or rebuilt replacements in exchange for defective parts for a period of one (1) year. After 90 days from the date of purchase, labor for removal and installation is available from Sony authorized service facilities or a Sony Service Center at your expense.

To obtain warranty service, you must take the Product, or deliver the Product freight prepaid, in either its original packaging or packaging affording an equal degree of protection, to any authorized Sony service facility.

This warranty does not cover customer instruction, installation, set up adjustments or signal reception problems.

This warranty does not cover cosmetic damage or damage due to acts of God, accident, misuse, abuse, negligence, commercial use, or modification of, or to any part of the Product, including the antenna. This warranty does not cover damage due to improper operation or maintenance, connection to improper voltage supply, or attempted repair by anyone other than a facility authorized by Sony to service the Product. This warranty does not cover Products sold AS IS or WITH ALL FAULTS, or consumables (such as fuses or batteries). This warranty is valid only in the United States.

Proof of purchase in the form of a bill of sale or receipted invoice which is evidence that the unit is within the Warranty period must be presented to obtain warranty service.

This warranty is invalid if the factory applied serial number has been altered or removed from the Product.

REPAIR OR REPLACEMENT AS PROVIDED UNDER THIS WARRANTY IS THE EXCLUSIVE REMEDY OF THE CONSUMER. SONY SHALL NOT BE LIABLE FOR ANY INCIDENTAL OR CONSEQUENTIAL DAMAGES FOR BREACH OF ANY EXPRESS OR IMPLIED WARRANTY ON THIS PRODUCT. EXCEPT TO THE EXTENT PROHIBITED BY APPLICABLE LAW, ANY IMPLIED WARRANTY OF MERCHANTABILITY OR FITNESS FOR A PARTICULAR PURPOSE ON THIS PRODUCT IS LIMITED IN DURATION TO THE DURATION OF THIS WARRANTY.

Some states do not allow the exclusion or limitation of incidental or consequential damages, or allow limitations on how long an implied warranty lasts, so the above limitations or exclusions may not apply to you. In addition, if you enter into a service contract with the Sony Partnership within 90 days of the date of sale, the limitation on how long an implied warranty lasts does not apply to you. This warranty gives you specific legal rights, and you may have other rights which vary from state to state.

For your convenience, Sony Electronics Inc. has established telephone numbers for frequently asked questions:

To locate the servicer or dealer nearest you, or for service assistance or resolution of a service problem, or for product information or operation, call:

Sony Direct Response Center
1-(800)-222-7669
or write to:
Sony Direct Response Center
12451 Gateway Blvd.
Fort Myers, FL 33913

For an accessory or part not available from your authorized dealer, call:
1-(800)-488-SONY (7669)

W 455714701 (T1)

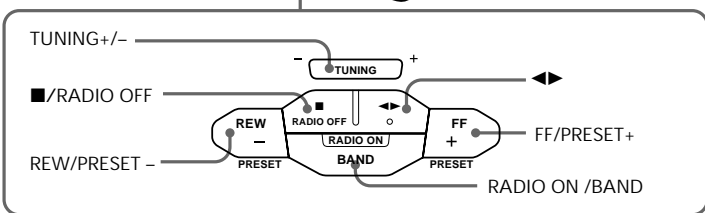
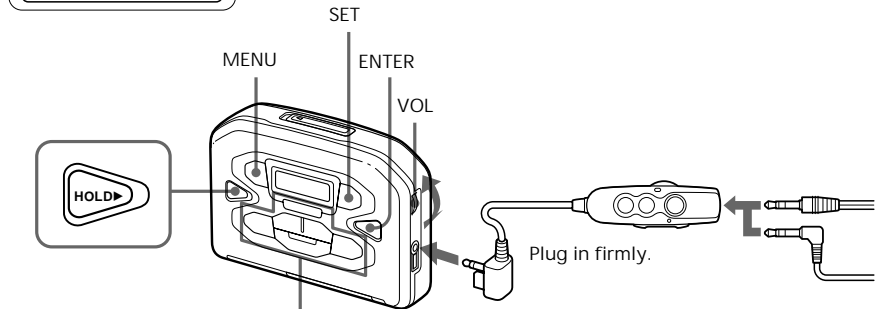
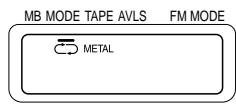
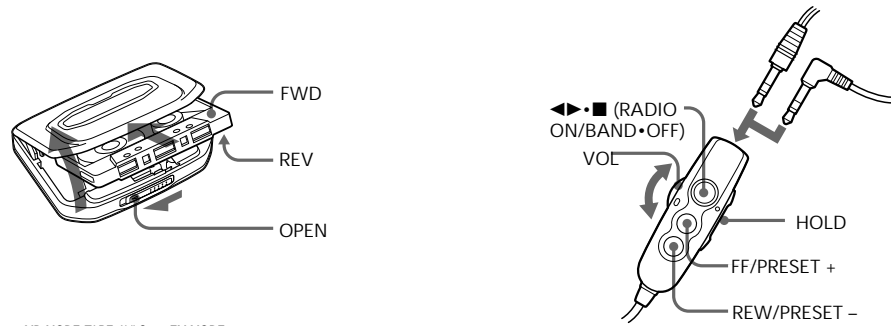
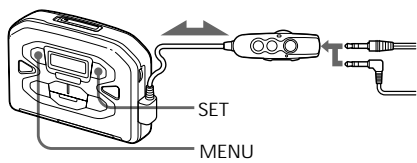
C**D**

Specifications

- Frequency range
TV: 2 - 13 ch
WB (Weather): 1 - 7 ch
FM: 87.5-108 MHz
AM: 530-1,710 kHz (North, Central and South America)
531-1,602 kHz (Other countries)
- Power requirements
3V DC batteries R6 (AA) x 2
- Dimensions (w/h/d)
Approx. 115.2 x 82.4 x 29.0 mm (4 5/8 x 3 1/4 x 1 1/16 in.),
excluding projecting parts and controls
- Mass
Approx. 136 g (4.8 oz) (main unit only)
- Supplied accessories
Stereo headphones or earphones with remote control (1)
Carrying case with belt clip (1)

Battery life (approximate hours)		(JEITA*)
		Sony alkaline LR6 (SG)** Sony R6P (SR)
Tape playback	25	7.5
Radio reception	40	14

* Measured value by the standard of JEITA (Japan Electronics and Information Technology Industries Association). (Using a Sony HF series cassette tape)
**When using Sony LR6 (SG) "STAMINA" alkaline dry batteries (produced in Japan).

Note

- The battery life may be shorter depending on the operating condition, the surrounding temperature and battery type.

Design and specifications are subject to change without notice.

Listening to the Radio **C**

- 1 If the HOLD function is turned on, slide the HOLD switch in the opposite direction of the arrow to unlock the controls.
- 2 Press RADIO ON/BAND to turn on the radio.
- 3 Press RADIO ON/BAND repeatedly to select TV, WB (Weather), FM or AM.
- 4 Press TUNING +/- to tune in to the desired station.
Hold down TUNING +/- for a few seconds to scan for stations.

To turn off the radio
Press ■•RADIO OFF.

To improve the broadcast reception **D**

- For TV/WB (Weather)/FM: Extend the headphones/earphones cord (antenna) or remote control cord (antenna). If the reception is still not good, press MENU repeatedly to set the cursor in the display to FM MODE. Then press SET to switch between "LOCAL" and none (DX) for best reception.
- For AM: Reorient the unit itself.

To operate from the remote control

To turn on the radio, press RADIO ON/BAND•OFF for more than one second (only while the tape is in stop mode).
To select the band, press RADIO ON/BAND•OFF for more than one second while the radio is on.
To tune in or recall a preset station, press PRESET + or -.
To turn off the radio, press RADIO ON/BAND•OFF.

Note

To use preset tuning, preset the stations first (see "Presetting Radio Stations").

Presetting Radio Stations **C**

You can preset up to 40 radio stations (7 for TV, 4 for WB, 24 for FM and 5 for AM).

Presetting Automatically Scanned Stations

- 1 Press RADIO ON/BAND to turn on the radio.
- 2 Press RADIO ON/BAND repeatedly to select TV, WB (Weather), FM or AM.
- 3 Press ENTER for more than 3 seconds.
Preset number 1 will flash in the display and the Walkman starts scanning the stations from the lower frequencies and stops for about 3 seconds when a station is received.
- 4 If you wish to preset the received station, press ENTER while the preset number is flashing.
The received station is preset on preset number 1 and the unit starts scanning for the next receivable station.
- 5 Repeat Step 4 until all receivable stations are preset.

To stop scanning

Press OFF. The radio is turned off at the same time.

Notes

- If stations are already stored, the newly preset stations replace the old ones when the above procedure is completed.
- If stations cannot be preset automatically, preset stations manually.

Presetting Stations Manually

- 1 Press RADIO ON/BAND to turn on the radio.
- 2 Press RADIO ON/BAND repeatedly to select TV, Weather, FM or AM.
- 3 Press ENTER.
The frequency digits and a preset number flash in the display.
- 4 While the frequency digits and the preset number are flashing, tune in a station you wish to store using TUNING +/-, and select a preset number using PRESET +/-.
- 5 While the frequency digits and the preset number are flashing, press ENTER.

Notes

- If you cannot complete step 4 or 5 while the indications are flashing, repeat from step 3.
- If a station is already stored, the newly preset station will replace the old one.

To cancel the stored station

Follow the procedure above and in step 4, instead of tuning in a station, press and hold TUNING +/- until "----" is displayed and select the preset number you want to cancel using PRESET +/-.
Press ENTER while "----" is flashing.

Playing the preset radio stations

- 1 Press RADIO ON/BAND to select the band.
- 2 Press PRESET +/-.

Precautions

On batteries

- Do not carry dry batteries with coins or other metallic objects. It can generate heat if the positive and negative terminals of the batteries are accidentally contacted by a metallic object.
- When you are not going to use your Walkman for a long time, remove the batteries to prevent damage from battery leakage and corrosion.

On handling

- Do not leave the unit in a location near heat sources, or in a place subject to direct sunlight, excessive dust or sand, moisture, rain, mechanical shock, or in a car with its windows closed.
- Do not use cassettes longer than 90 minutes except for long continuous playback.
- The LCD display may become hard to see or slow down when using the unit at high temperatures (above 40°C/104°F) or at low temperatures (below 0°C/32°F). At room temperature, the display will return to its normal operating condition.
- If the unit has not been used for a long time, set it in the playback mode to warm it up for a few minutes before you start using again.

On the remote control

Use the supplied remote control only with this unit.

On headphones/earphones

Road safety

Do not use headphones/earphones while driving, cycling, or operating any motorized vehicle. It may create a traffic hazard and is illegal in some areas. It can also be potentially dangerous to play your headphones/earphones at high volume while walking, especially at pedestrian crossings.
You should exercise extreme caution or discontinue use in potentially hazardous situations.

Preventing hearing damage

Do not use headphones/earphones at high volume. Hearing experts advise against continuous, loud and extended play. If you experience a ringing in your ears, reduce volume or discontinue use.

Caring for others

Keep the volume at a moderate level. This will allow you to hear outside sounds and to be considerate to the people around you.

On maintenance

- To clean the tape head and path, use the cleaning cassette CHK-1W/C-1KW (not supplied) every 10 hours of use. Use only the recommended cleaning cassette.
- To clean the exterior, use a soft cloth slightly moistened in water. Do not use alcohol, benzine or thinner.
- Clean the headphones/earphones and remote control plugs periodically.

Troubleshooting

The display shows incorrect information.

- The batteries are weak. Replace the batteries with new ones.

The display and the operation are not normal.

- Remove the power sources for 15 seconds or more, and then set them again.